

035608

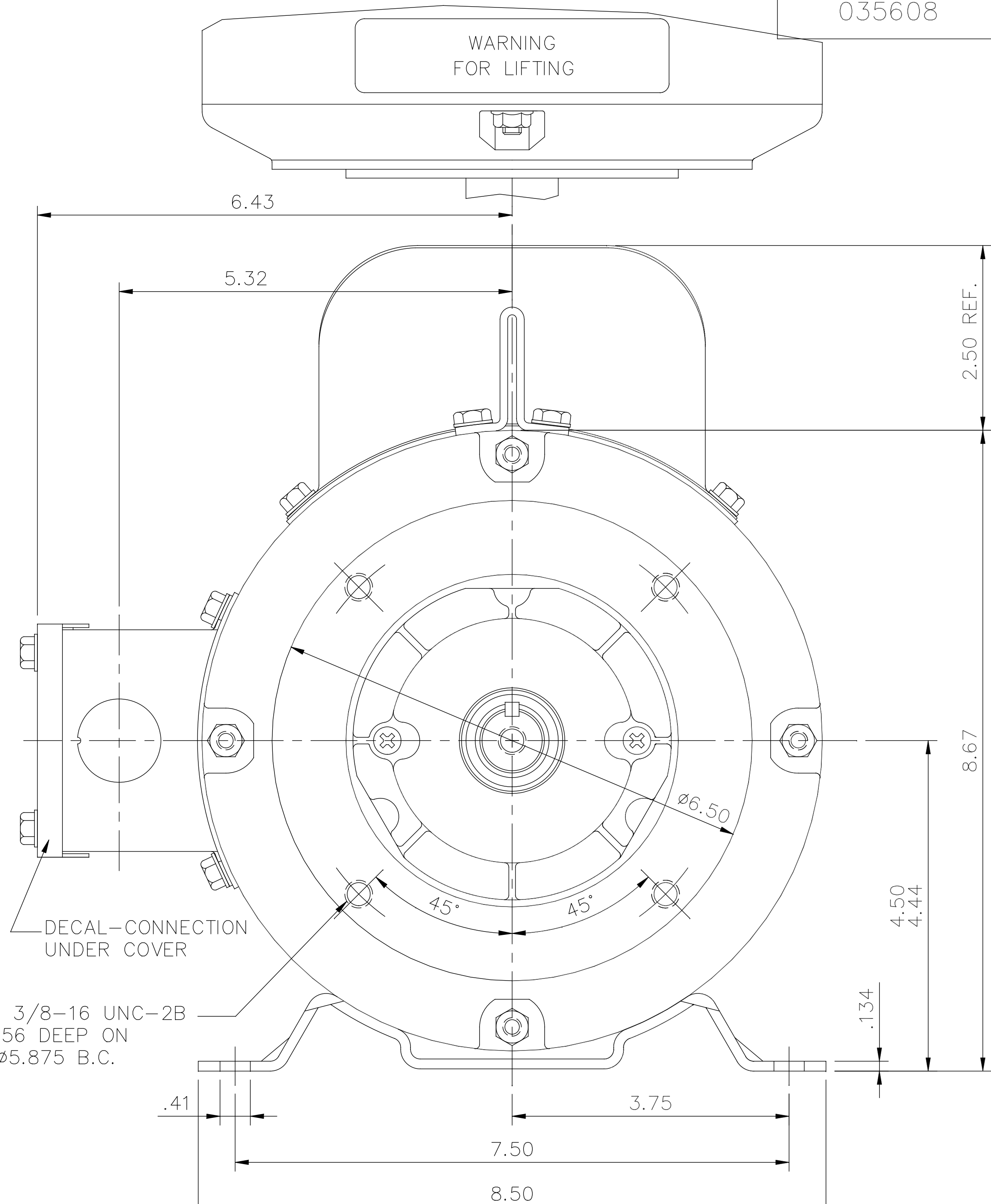

(4) 3/8-16 UNC-2B
X .56 DEEP ON
A φ5.875 B.C.

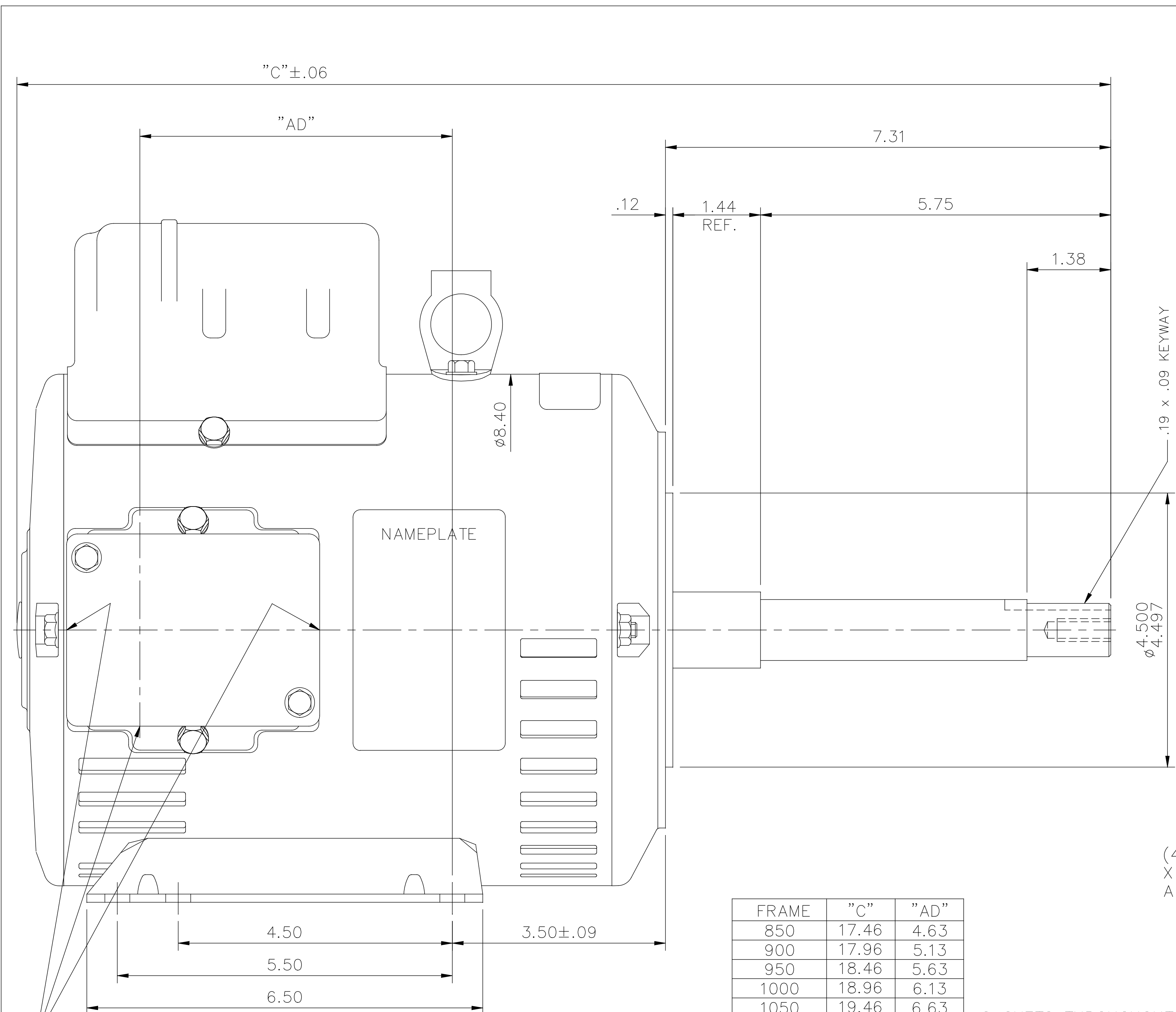
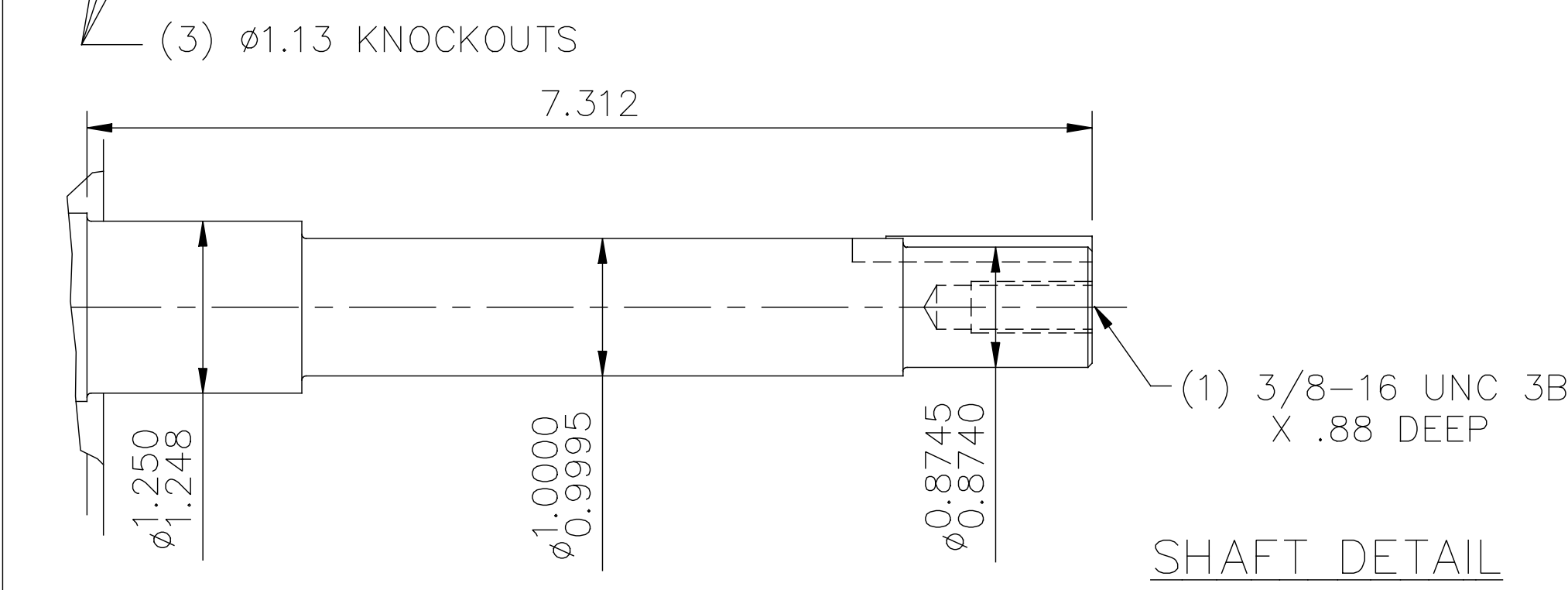

FRAME	"C"	"AD"
850	17.46	4.63
900	17.96	5.13
950	18.46	5.63
1000	18.96	6.13
1050	19.46	6.63
1100	19.96	7.13
1150	20.46	7.63
1200	20.96	8.13

GASKETS THROUGHOUT
MAXIMUM FACE RUNOUT TO BE .004 T.I.R.
MAXIMUM PILOT ECCENTRICITY TO BE .004 T.I.R.
PERMISSIBLE SHAFT RUNOUT TO BE .002 T.I.R.

		TOLERANCES UNLESS SPECIFIED		Regal Beloit America, Inc.	DRAWN YS 04-29-2008	
		DEC.	INCHES		CHK	
		.X	±.1		APPD	
		.XX	±.03		SCALE 1=2	
		.XXX	±.005		REF 035446 & 035557	
		.XXXX	±.0005	MAT'L.	FMF 184TCDW7909	
NO.	REVISION	BY & DATE	CHK	ANG ±1/2'	FINISH	
THIS DRAWING IN DESIGN AND DETAIL IS OUR PROPERTY AND MUST NOT BE USED EXCEPT IN CONNECTION WITH OUR WORK ALL RIGHTS OF DESIGN AND INVENTION ARE RESERVED THIS IS AN ELECTRONICALLY GENERATED DOCUMENT - DO NOT SCALE THIS PRINT		RFP	CAD FILE	035608	SIZE B	DRAWING NO. 035608
		DIST				REV.