

INDEX	MDSL0081-07
REV. LEVEL	2
SHEET	1 OF 1

TOSHIBA/HOUSTON

**DRIP-PROOF
HORIZONTAL FOOT-MOUNTED
2300/4160V STOCK MOTORS**

**Fr. 505-509
4-8 POLE
BELT DRIVE**

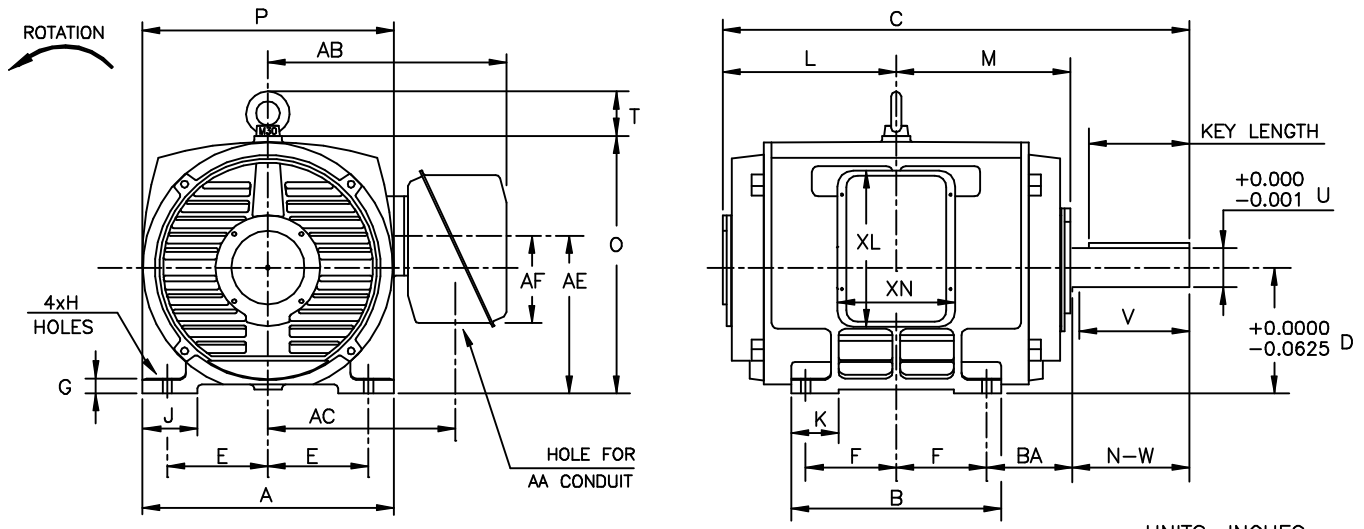

UNITS: INCHES

FRAME SIZE	MOUNTING				CONDUIT BOX						
	E	F	H	BA	AA	AB	AC	AE	AF	XL	XN
505UZ	10.00	9.00	0.94	8.50	4.00	23.75	18.62	15.64	8.66	15.50	11.73
507UZ	10.00	11.00	0.94	8.50	4.00	23.75	18.62	15.64	8.66	15.50	11.73
509UZ	10.00	14.00	0.94	8.50	4.00	22.81	17.68	15.64	8.66	15.50	11.73

FRAME SIZE	MOTOR DIMENSIONS											
	A	B	C	D	G	J	K	L	M	O	P	T
505UZ	25.00	20.87	46.34	12.50	1.48	5.51	4.72	17.22	17.30	25.58	25.00	4.41
507UZ	25.00	24.80	50.34	12.50	1.48	5.51	4.72	19.22	19.30	25.58	25.00	4.41
509UZ	25.00	30.79	56.34	12.50	1.48	5.51	4.72	22.22	22.30	25.58	25.00	4.41

FRAME SIZE	SHAFT EXTENSION			KEYWAY		KEY LENGTH	BEARINGS		APPROX. WEIGHT
	N-W	V	U	WIDTH	DEPTH		LS	OS	
505UZ	11.62	11.38	3.875	1.000	0.500	10.00	NU322	6320	lbs.
507UZ	11.62	11.38	5.250	1.250	0.625	10.00	NU2228	6320	lbs.
509UZ	11.62	11.38	5.250	1.250	0.625	10.00	NU2228	6320	lbs.

ALL DATA SUBJECT TO CHANGE WITHOUT NOTICE.
FOR CONSTRUCTION USE ONLY CERTIFIED DATA.

- NOTES:
1. DIMENSION V REPRESENTS LENGTH OF STRAIGHT PART OF SHAFT
 2. CONDUIT BOX WILL BE MOUNTED ON OPPOSITE SIDE UPON REQUEST. CONDUIT BOX MAY BE ROTATED SO THAT THE OPENING MAY FACE UP, DOWN, OR EITHER SIDE.

FOR REFERENCE PRELIMINARY CERTIFIED

For _____
Your Order No: _____
Toshiba Order No: _____
Frame _____ HP _____ RPM (F.L.) _____
Amp (F.L.) _____ Volts _____ Hz. _____ Ph. _____
Model No: _____ Type _____ Form _____ SF _____
Remarks: _____

Per _____ Date _____