

본 도면은 현대중공업(주) 재산이므로
허가없이 복사할 수 없음 (취급유의)

THIS DRAWING IS PROPRIETARY TO HHI. NO PART OF THIS DRAWING
MAYBE REPRODUCED WITHOUT THE PERMISSION OF HHI.

HYUNDAI HEAVY INDUSTRIES CO., LTD.	<h1>TEFC</h1> THREE PHASE INDUCTION MOTOR	TYPE	XKP, XIP Cast iron frame
--	---	-------------	-----------------------------

FRAME SIZE	OUTPUT(HP)	POLES	Hz	TIME RATING
365TSC			60	CONT

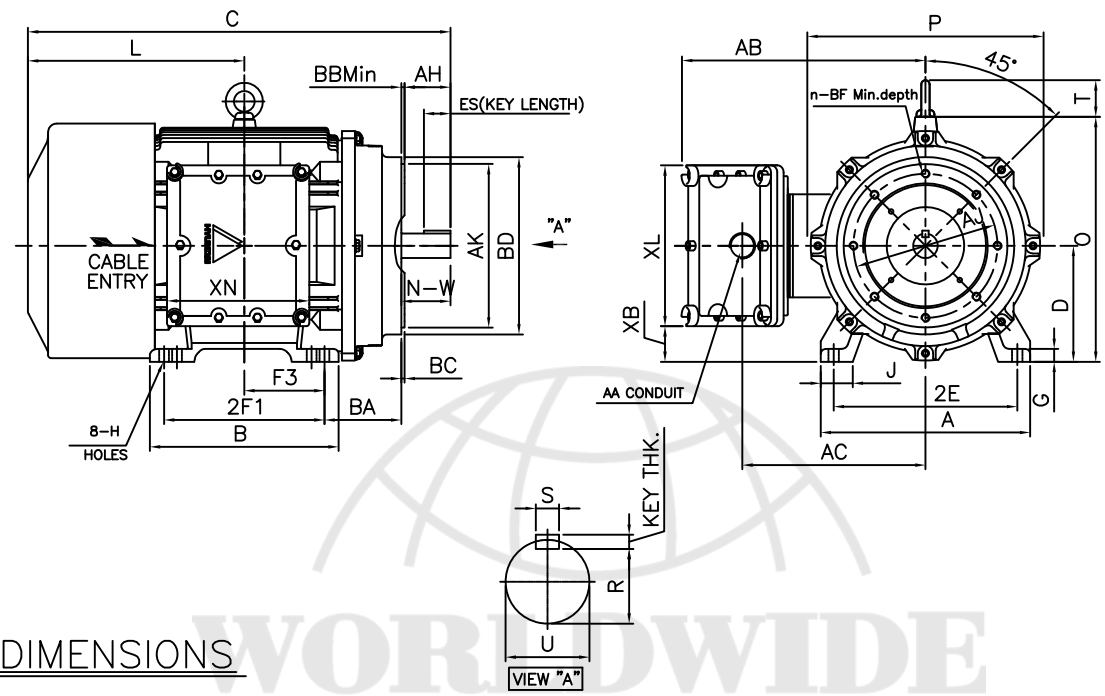

DIMENSIONS

MOUNTING								CONDUIT BOX						APPROX. WGT.(LB)	
A	B	2E	2F1	2F2	F3	G	J	H	AA	AB	AC	XB	XL	XN	
15.98	14.41	14.00	12.25	-	6.122	0.98	2.44	0.66	3.00	18.89	14.37	2.71	12.28	10.86	2P: 1109 or 4P: 1175 6P: 1195

OVERALL							SHAFT				KEY	BEARING		
BA	C	D	L	O	P	T	U	N-W	KEYWAY			THK.	DRIVE END	OPP. DRIVE END
									R	ES	S			
5.88	32.25	9.00	16.51	18.70	18.03	2.80	1.875	3.75	1.591	2.03	0.500	0.500	6213C3	6213C3

C-FACE								
AJ	AK	BBmin	BC	BD	BF	BF Def.	n	AH
11.00	12.50	0.25	0.25	13.54	5/8-11	0.94	8	3.50

- NOTE**
- 1.Dimension "D" tolerance : +0.00inch ~ -0.03inch (143TC-365TC) : +0.000inch ~ -0.06inch (404TC-449TC)
 - 2.Dimension "U" tolerance : +0.000inch ~ -0.0005inch (143TC-215TC): +0.000inch ~ -0.001inch (254TC-449TC)
 - 3.Dimension "R" tolerance : +0.000inch ~ - 0.015inch
 - 4.Dimension "AK" tolerance : +0.000inch ~ -0.003inch (143TC-286TC): +0.000inch ~ -0.005inch (324TC-449TC)

Q'TY	DESCRIPTION	MATERIAL	DIMENSION	WEIGHT	PART NO.	REMARK	NO.
APPD BY	UNIT	mm	SUBJECT	365TSC			DWG SIZE
CHKD BY	SCALE	1/15	TITLE	Outline			A4 (1:15)
CHKD BY	PROJEC'N	3각법 (3rd Angle)					
DSND BY	DATE	2012-06-14					
HYUNDAI HEAVY INDUSTRIES CO., LTD.					REF. NO	Sheet No.	of
					DWG NO	LM-U0365C4TS001	Revision No.
							1