

REV	ECO	REV BY	DATE	APPD	DATE
D	0012956	M.AVILA	06-02-2011	T.REYES	06-02-2011

GRP	TYPE	FRAME	C	(BV)	(BS)	(XA)	(XB)	(XG)	(XH)	(XS)	(XT)	(XL)	(XM)	(XO)	(XP)
-01	CP	T56C	12.69	5.77	—	2.01	2.01	2.26	5.06	2.26	5.06	4.64	4.65	3.10	3.09
	CP	T56J	13.19	5.77	—	2.01	2.01	2.26	5.06	2.26	5.06	4.64	4.65	3.10	3.09
-02	CP	X56C	13.69	6.77	4.15	2.01	2.01	3.26	5.06	3.26	5.06	4.64	4.65	3.10	3.09
	CP	X56J	14.19	6.77	—	2.01	2.01	3.26	5.06	3.26	5.06	4.64	4.65	3.10	3.09
-03	CP	P56C	14.19	7.27	—	2.01	2.27	3.44	5.30	3.69	5.06	4.64	4.92	3.32	3.09
	CP	P56J	14.69	7.27	—	2.01	2.27	3.44	5.30	3.69	5.06	4.64	4.92	3.32	3.09
-04	CP	R56C	14.94	8.02	—	2.01	2.27	4.19	5.30	4.44	5.06	4.64	4.92	3.32	3.09
	CP	R56J	15.44	8.02	—	2.01	2.27	4.19	5.30	4.44	5.06	4.64	4.92	3.32	3.09

ALL DIMENSIONS SHOWN IN PARENTHESIS ARE REFERENCE DIMENSIONS. ALL OTHER DIMENSIONS ARE TOLERANCED PER THE FOLLOWING CHART UNLESS OTHERWISE SPECIFIED.

"C" DIM.	= +/- .055
SHAFT EXT.	= +/- .034
LEAD LENGTHS	= +/- 1.00
EXTENDED THRU-BOLTS	= +/- .050
ANGULAR DIMS.	= +/- 2 DEGS.

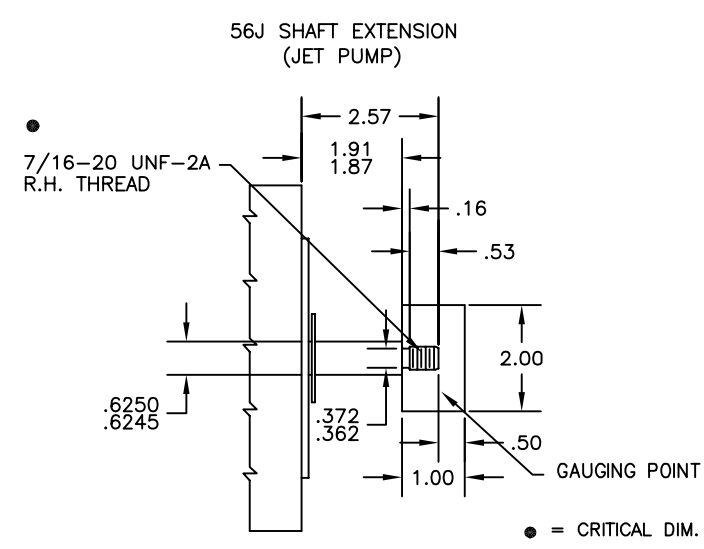
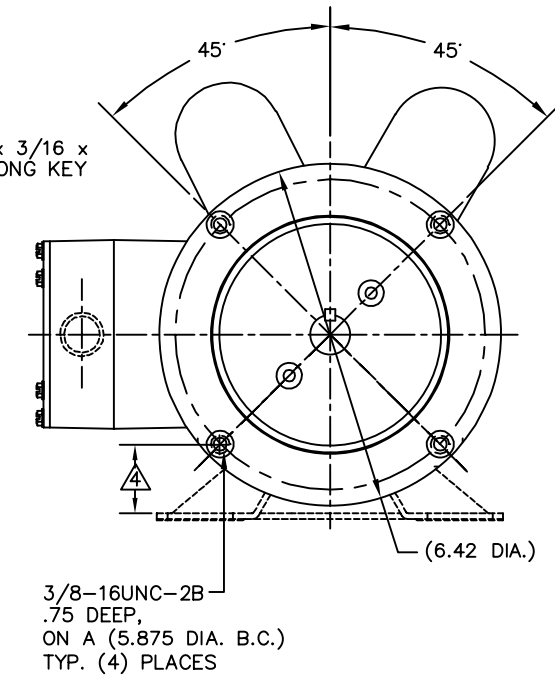
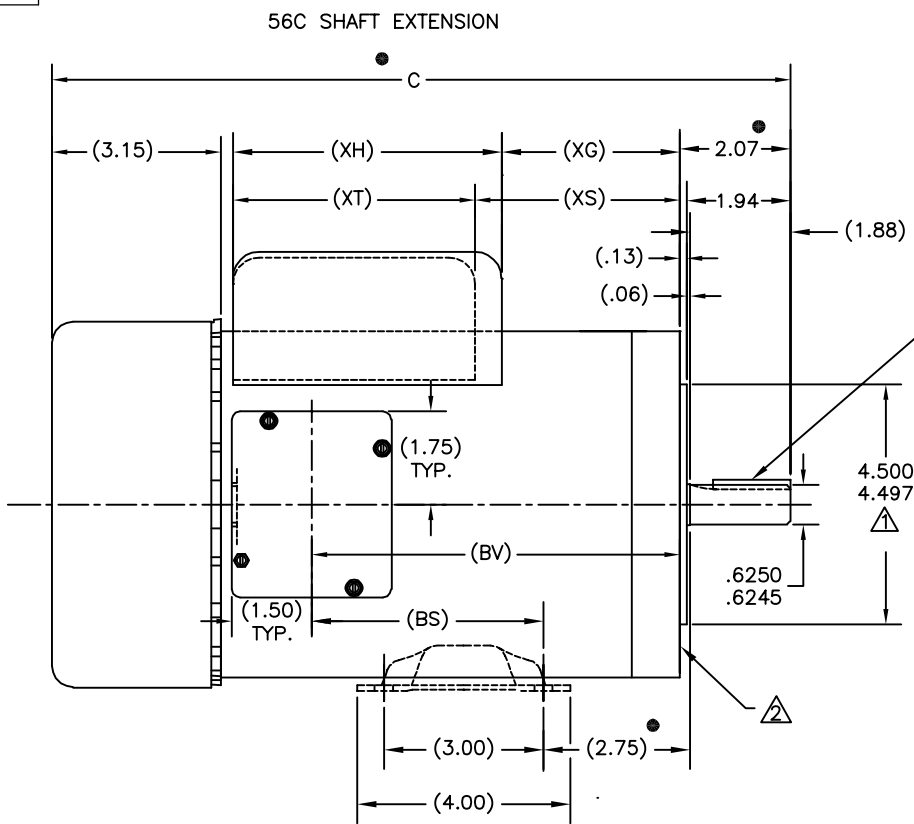
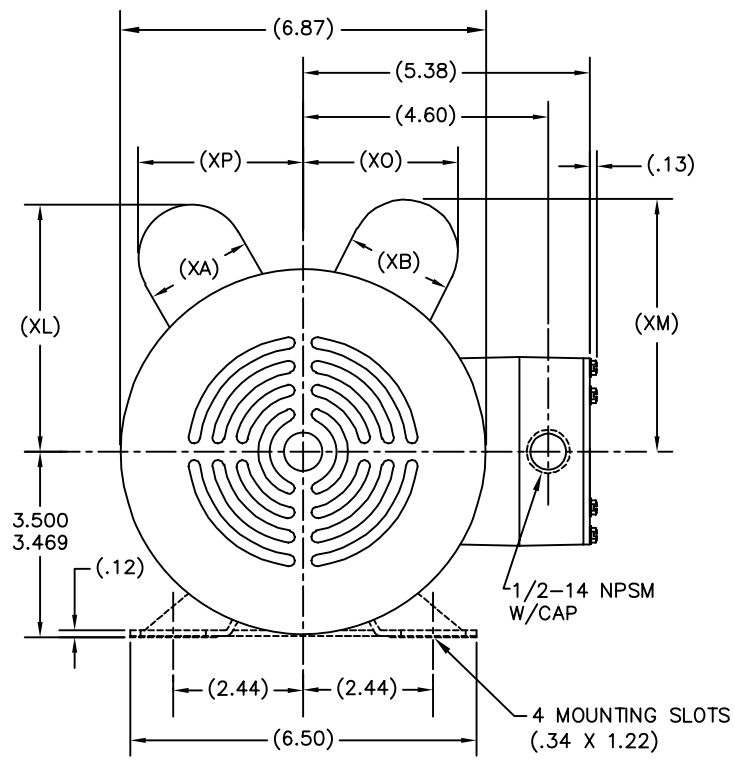

NOTES:

- 1. PILOT DIAMETER IS CONCENTRIC WITH SHAFT CENTERLINE WITHIN .004 T.I.R.
- 2. FACE OF MOUNTING FLANGE IS PERPENDICULAR TO SHAFT CENTERLINE WITHIN .004 T.I.R.
- 3. SHAFT RUNOUT NOT TO EXCEED .002 T.I.R.
- 4. FOR RIGID BASE ONLY: THE 2 BOTTOM HOLES IN THE MOUNTING FLANGE ARE PARALLEL FROM THE BOTTOM OF THE FEET WITHIN .030
- 5. END PLAY NOT TO EXCEED .010 MEASURED WITH NO THRUST

<p>GEOMETRIC CHARACTERISTICS & SYMBOLS</p> <ul style="list-style-type: none"> — FLATNESS — STRAIGHTNESS — ANGULARITY — PERPENDICULARITY (SQUARENESS) — PARALLELISM — ROUNDNESS (CIRCULARITY) — CYLINDRICITY — PROFILE OF ANY SURFACE — RUNOUT — TRUE POSITION — CONCENTRICITY — SYMMETRY 	<p>UNLESS OTHERWISE SPECIFIED DIM. TOLERANCES ARE AS FOLLOWS:</p> <p>INCH ±.1 ±.02 ±.005 ±.0005 mm ±0.5 ±0.13 ±0.013</p> <p>ANG. ±.50 DEG REMOVE BURRS & BREAK SHARP EDGES: CORNER FILLETS TO: INCH .020 mm 0.5</p> <p>MACHINE SURFACES: INCH 125 mm 3.2</p> <p>METRIC DIMS. SHOWN IN [BRACKETS]</p>	<p>DR BY: RSH APPD: TJD</p> <p>EDS DATE: 12-01-1997 EDS DATE: 12-01-1997 FORMAT: F</p>	<p>ACSmith Innovation has a name.</p> <p>ELECTRICAL PRODUCTS COMPANY A DIVISION OF A. O. SMITH CORPORATION</p>	<p>DESCRIPTION: OUTLINE</p> <p>SIZE: D DWG NO: 189033</p> <p>SCALE: NONE SHEET: 1</p>
---	--	--	--	--

D
C
B
A

D
C
B
A

8 7 6 5 4 3 2 1

GRP	TYPE	FRAME	C	(BV)	(BS)	(XA)	(XB)	(XG)	(XH)	(XS)	(XT)	(XL)	(XM)	(XO)	(XP)
-01	CP	T56C	12.69	5.77	—	2.01	2.01	2.26	5.06	2.26	5.06	4.64	4.65	3.10	3.09
	CP	T56J	13.19	5.77	—	2.01	2.01	2.26	5.06	2.26	5.06	4.64	4.65	3.10	3.09
-02	CP	X56C	13.69	6.77	4.15	2.01	2.01	3.26	5.06	3.26	5.06	4.64	4.65	3.10	3.09
	CP	X56J	14.19	6.77	—	2.01	2.01	3.26	5.06	3.26	5.06	4.64	4.65	3.10	3.09
-03	CP	P56C	14.19	7.27	—	2.01	2.27	3.44	5.30	3.69	5.06	4.64	4.92	3.32	3.09
	CP	P56J	14.69	7.27	—	2.01	2.27	3.44	5.30	3.69	5.06	4.64	4.92	3.32	3.09
-04	CP	R56C	14.94	8.02	—	2.01	2.27	4.19	5.30	4.44	5.06	4.64	4.92	3.32	3.09
	CP	R56J	15.44	8.02	—	2.01	2.27	4.19	5.30	4.44	5.06	4.64	4.92	3.32	3.09

REVISION: ECO	REVISADO POR: M.AVILA	FECHA: 06-02-2011	APROBADO POR: T.REYES	FECHA: 06-02-2011
D	0012956			

ALL DIMENSIONS SHOWN IN PARENTHESIS ARE REFERENCE DIMENSIONS. ALL OTHER DIMENSIONS ARE TOLERANCED PER THE FOLLOWING CHART UNLESS OTHERWISE SPECIFIED.

"C" DIM. = +/- .055
 SHAFT EXT. = +/- .034
 LEAD LENGTHS = +/- 1.00
 EXTENDED THRU-BOLTS = +/- .050
 ANGULAR DIMS. = +/- 2 DEGS.

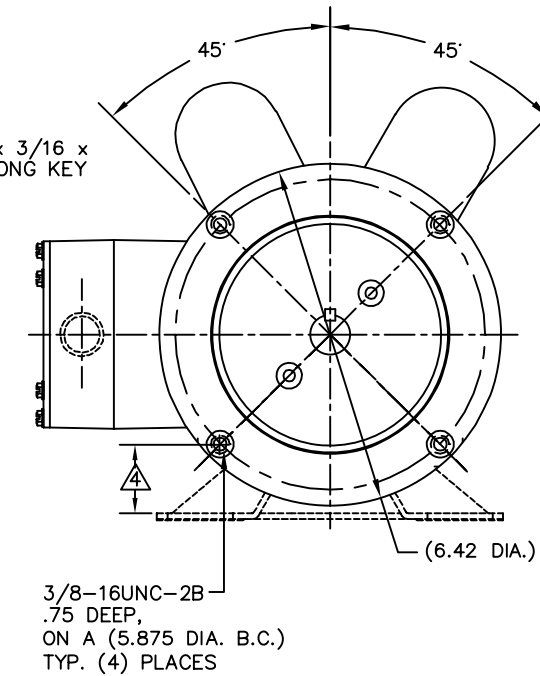
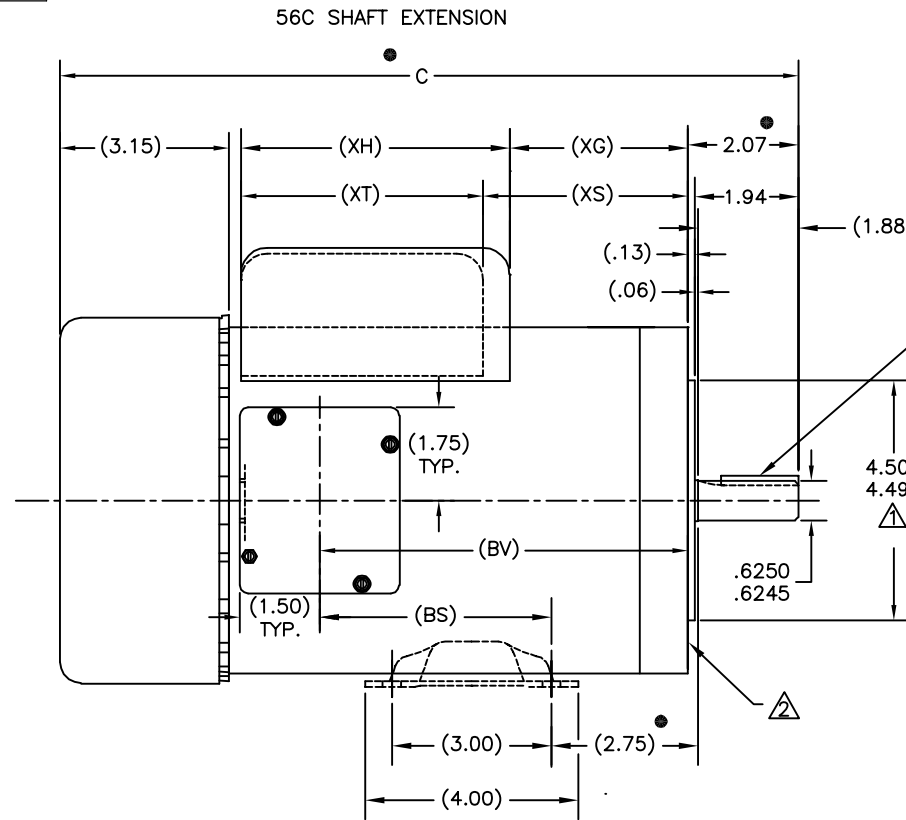
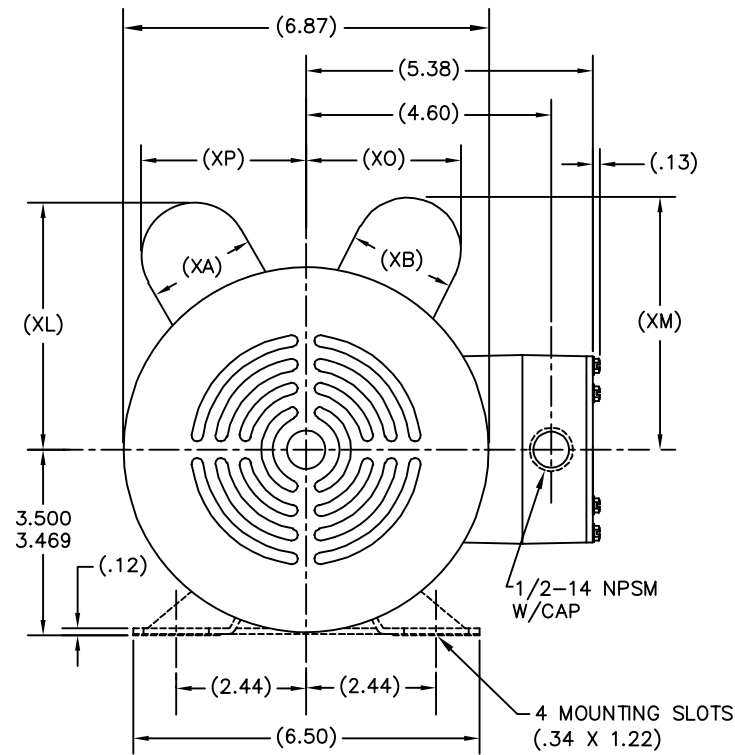

56J SHAFT EXTENSION (JET PUMP)

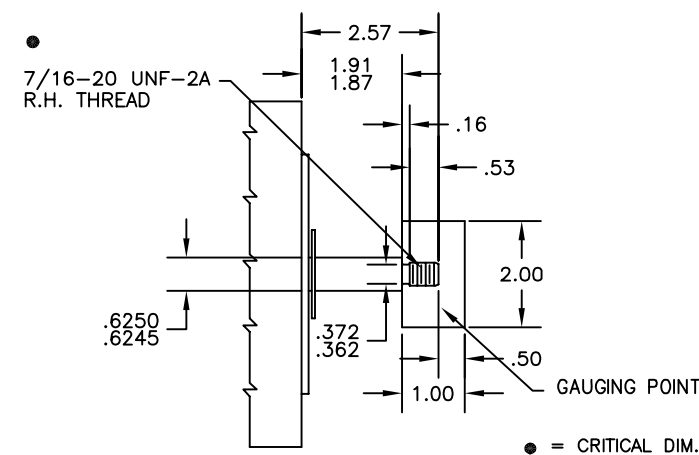

NOTES:

- ⚠️ PILOT DIAMETER IS CONCENTRIC WITH SHAFT CENTERLINE WITHIN .004 T.I.R.
- ⚠️ FACE OF MOUNTING FLANGE IS PERPENDICULAR TO SHAFT CENTERLINE WITHIN .004 T.I.R.
- 3 SHAFT RUNOUT NOT TO EXCEED .002 T.I.R.
- ⚠️ FOR RIGID BASE ONLY: THE 2 BOTTOM HOLES IN THE MOUNTING FLANGE ARE PARALLEL FROM THE BOTTOM OF THE FEET WITHIN .030
- 5 END PLAY NOT TO EXCEED .010 MEASURED WITH NO THRUST

CARACTERISTICAS DE GEOMETRIA Y SIMBOLOS: ▽ PLANICIDAD — RECTITUD ∠ ANGULARIDAD ⊥ PERPENDICULARIDAD (A ESCUADRA) // PARALELISMO ○ REDONDEZ (CIRCULARIDAD) Ⓞ CILINDRICIDAD ≡ PERFIL DE CUALQUIER SUPERFICIE ⤴ PERFIL DE CUALQUIER LINEA ⤵ VARIACION ⊕ POSICION REAL ⊙ CONCENTRICIDAD = SIMETRIA	A MENOS QUE SE ESPECIFIQUE DE OTRA MANERA, LAS TOLERANCIAS DE LAS DIMS, SON LAS SIGUIENTES: PULG ±.1 ±.02 ±.005 ±.0005 mm ±0.5 ±0.13 ±0.013 ANG ±.50 GRADOS ELIMINAR REBABAS Y ORILLAS FILOSAS DEL BORDE. PULG .003-.015 mm 0.1-0.4 FILETEAR ESQUINA: PULG .020 mm 0.5 MAQUINAR SUPERFICIES PULG 125 mm 3.2 DIMS METRICAS MOSTRADAS [PARENTESIS]
--	---

DIBUJADO POR: RSH	12-01-1997
APROBADO POR: TJD	12-01-1997
TERCER ANGULO DE PROYECCION	FECHA EDS: EDS DATE REV. FORMATO: F
CONFIDENCIAL: ESTE DIBUJO Y SU INFORMACION SON PROPIEDAD DE USO EXCLUSIVO Y CONFIDENCIAL DE A.O.SMITH CORP. Y NO DEBERAN SER REVELADOS, DUPLICADOS, DISTRIBUIDOS O USARSE DE OTRA MANERA SIN EL CONSENTIMIENTO ESCRITO DE A.O. SMITH CORP. -TODOS LOS DERECHOS RESERVADOS.ASME Y14.5M 1994	

ELECTRICAL PRODUCTS COMPANY A DIVISION OF A. O. SMITH CORPORATION	
DESCRIPCION:	OUTLINE
TAMANO: D	NUMERO DE DIBUJO: 189033
ESCALA: NONE	HOJA: 1

8 7 6 5 4 3 2 1

GRP	TYPE	FRAME	C	(BV)	(BS)	(XA)	(XB)	(XG)	(XH)	(XS)	(XT)	(XL)	(XM)	(XO)	(XP)
-01	CP	T56C	12.69	5.77	—	2.01	2.01	2.26	5.06	2.26	5.06	4.64	4.65	3.10	3.09
	CP	T56J	13.19	5.77	—	2.01	2.01	2.26	5.06	2.26	5.06	4.64	4.65	3.10	3.09
-02	CP	X56C	13.69	6.77	4.15	2.01	2.01	3.26	5.06	3.26	5.06	4.64	4.65	3.10	3.09
	CP	X56J	14.19	6.77	—	2.01	2.01	3.26	5.06	3.26	5.06	4.64	4.65	3.10	3.09
-03	CP	P56C	14.19	7.27	—	2.01	2.27	3.44	5.30	3.69	5.06	4.64	4.92	3.32	3.09
	CP	P56J	14.69	7.27	—	2.01	2.27	3.44	5.30	3.69	5.06	4.64	4.92	3.32	3.09
-04	CP	R56C	14.94	8.02	—	2.01	2.27	4.19	5.30	4.44	5.06	4.64	4.92	3.32	3.09
	CP	R56J	15.44	8.02	—	2.01	2.27	4.19	5.30	4.44	5.06	4.64	4.92	3.32	3.09

版本	ECO	编制	日期	批准	日期
D	0012956	M.AVILA	06-02-2011	T.REYES	06-02-2011

ALL DIMENSIONS SHOWN IN PARENTHESIS ARE REFERENCE DIMENSIONS. ALL OTHER DIMENSIONS ARE TOLERANCED PER THE FOLLOWING CHART UNLESS OTHERWISE SPECIFIED.

"C" DIM. = +/- .055
 SHAFT EXT. = +/- .034
 LEAD LENGTHS = +/- 1.00
 EXTENDED THRU-BOLTS = +/- .050
 ANGULAR DIMS. = +/- 2 DEGS.

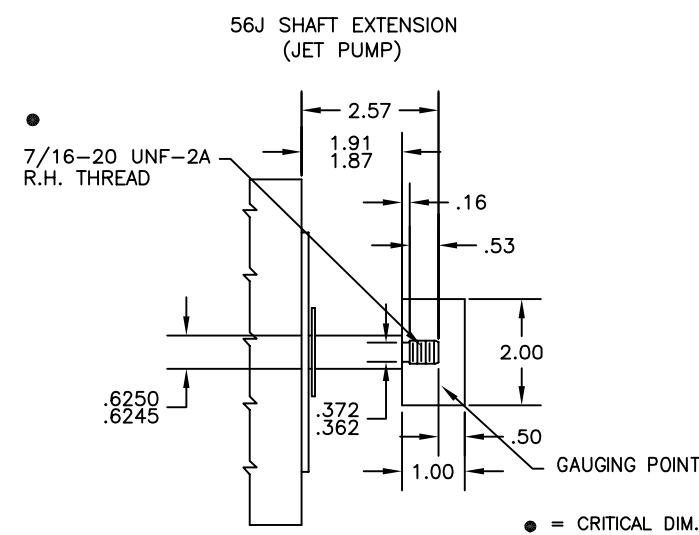
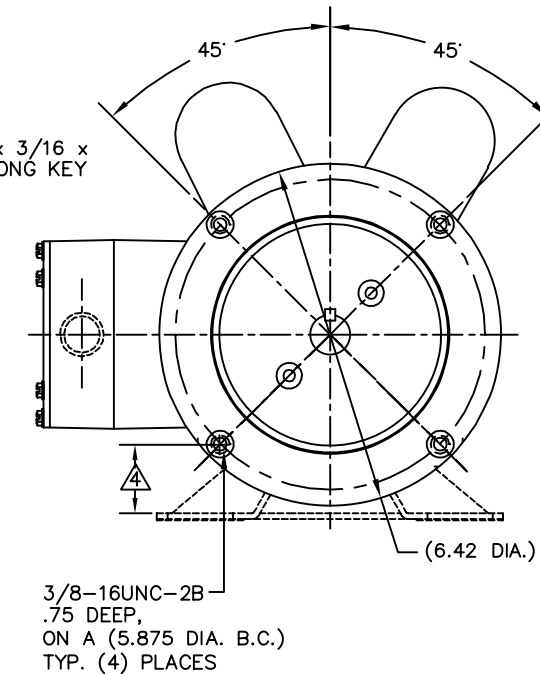
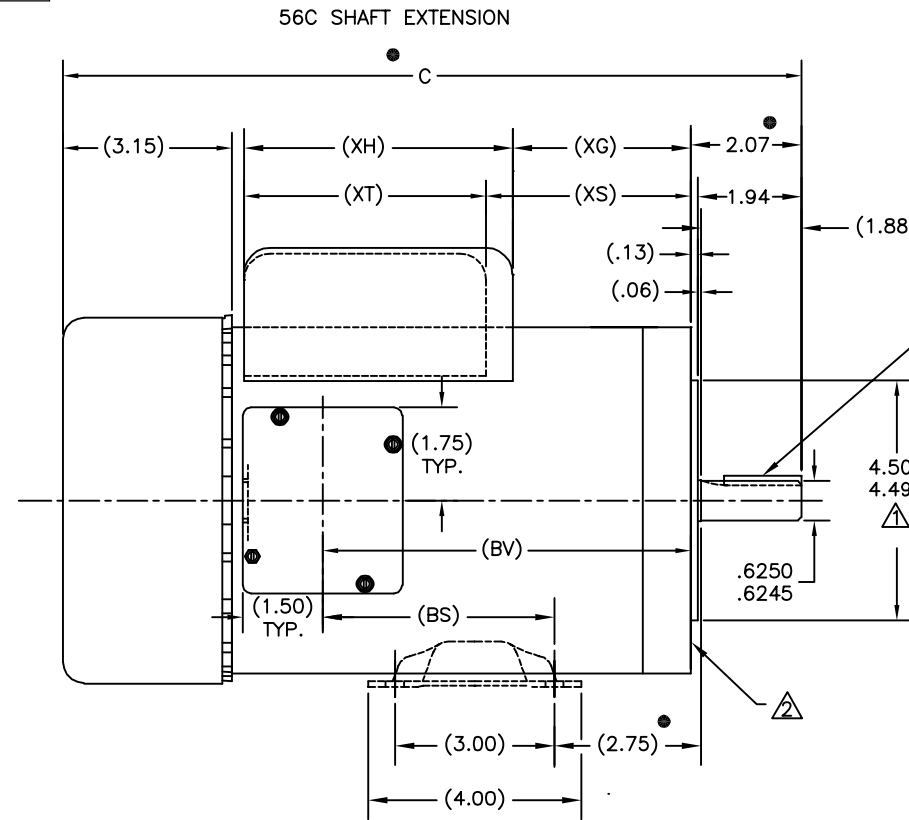
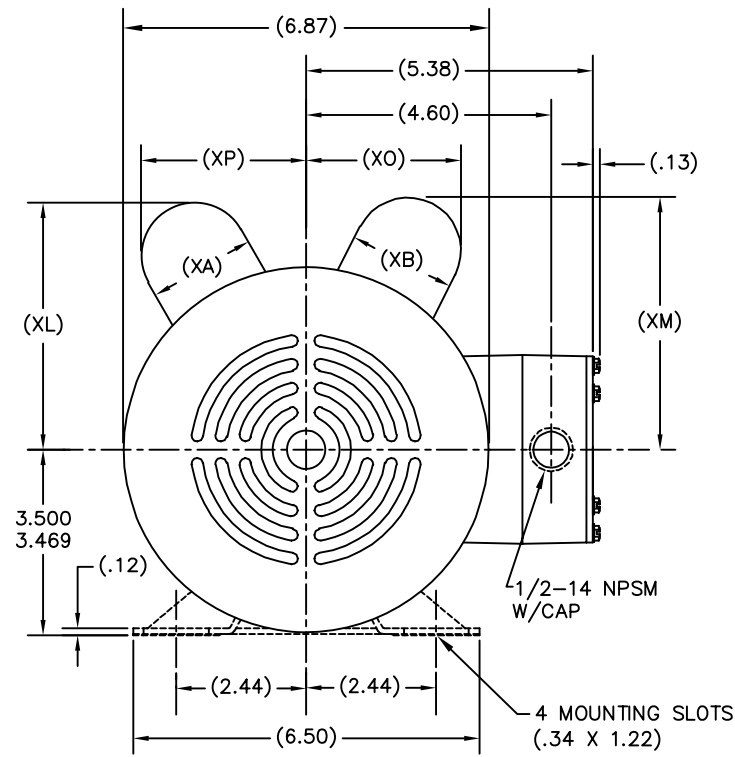

NOTES:

- 1 PILOT DIAMETER IS CONCENTRIC WITH SHAFT CENTERLINE WITHIN .004 T.I.R.
- 2 FACE OF MOUNTING FLANGE IS PERPENDICULAR TO SHAFT CENTERLINE WITHIN .004 T.I.R.
- 3 SHAFT RUNOUT NOT TO EXCEED .002 T.I.R.
- 4 FOR RIGID BASE ONLY: THE 2 BOTTOM HOLES IN THE MOUNTING FLANGE ARE PARALLEL FROM THE BOTTOM OF THE FEET WITHIN .030
- 5 END PLAY NOT TO EXCEED .010 MEASURED WITH NO THRUST

形位公差	符号	说明
平面度	▭	平面度
直线度	—	直线度
倾斜度	∠	倾斜度
垂直度	⊥	垂直度
平行度	∥	平行度
圆度	○	圆度
圆柱度	⊘	圆柱度
面轮廓度	⌒	面轮廓度
线轮廓度	⌒	线轮廓度
表面粗糙度	√	表面粗糙度
圆跳动	↻	圆跳动
位置度	⊕	位置度
同轴度	⊙	同轴度
对称度	≡	对称度

除另有注明	尺寸公差如下:
英寸	±.1 ±.02 ±.005 ±.0005
毫米	±0.5 ±0.13 ±0.013
角度	±.50 度
清理毛刺和尖棱	英寸: .003-.015 毫米: 0.1-0.4
内圆角	英寸: .020 毫米: 0.5
表面粗糙度	英寸: 125 毫米: 3.2
米制尺寸显示在 []	

绘图:	日期:
RSH	12-01-1997
批准:	日期:
TJD	12-01-1997
第三角投影	图框格式发布日期 EDS DATE
	图框格式版本 F
机密: 本图纸及相关信息所有权归A. O. SMITH公司所有。未经A. O. SMITH公司书面授权, 不得泄露、复制、传播或作其他用途。一版权所有	
ASME Y14.5M 1994	

AC Smith		ELECTRICAL PRODUCTS COMPANY	
Innovation has a name. A DIVISION OF A. O. SMITH CORPORATION			
名称	OUTLINE		
图幅	图号	比例	
D	189033	NONE	
页号	1		