

4

3

2

1

REV	ECO	REV BY	DATE	APPD	DATE
G	0025400	J.M.Ramirez	04-16-2012	R.Rascon	04-16-2012

TOP OF WARN LABEL

.500[12.70] PIPE TAP FOR CONDUIT CONN. PLUGGED

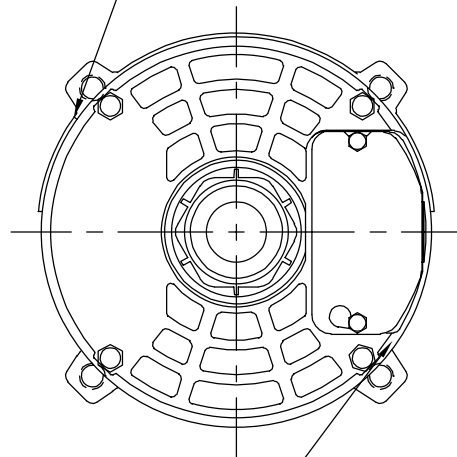

3X LINE LEAD SLOTS

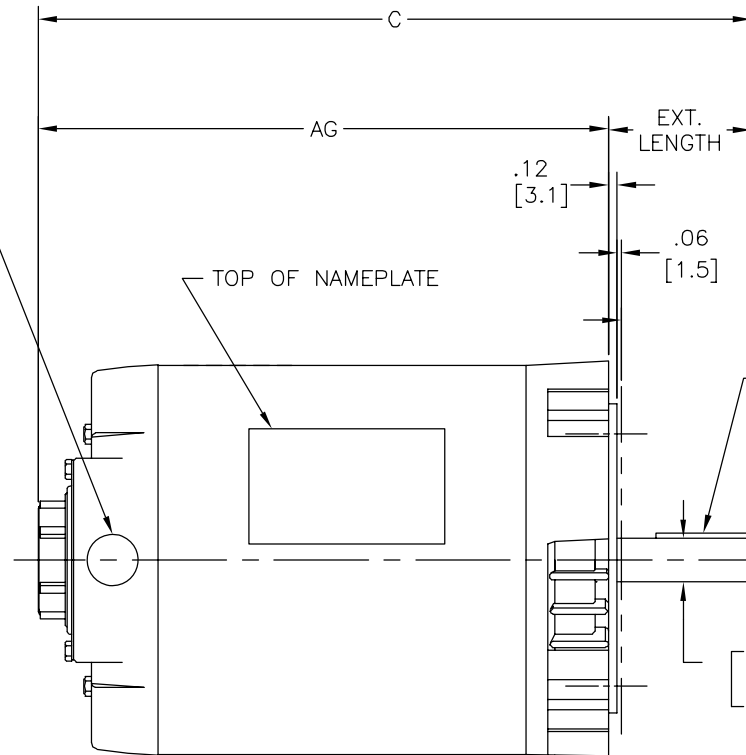

TOP OF NAMEPLATE

EXT. LENGTH

.12 [3.1]

.06 [1.5]

USABLE FLAT

.19[4.8] SQUARE KEY. SEE CHART FOR LENGTH REF.

$\phi .6250^{+.0000}_{-.0005}$
 $\phi 15.874^{+.000}_{-.013}$

THIS FACE MUST BE SQUARE WITH SHAFT WITHIN .004[.10] T.I.R. WITH INDICATOR CONTROL ARM LOCATED AT END OF SHAFT

4X 3/8-16 UNC-2B THDS
.75[19.0] ON A
5.88[149.4] D.B.C.

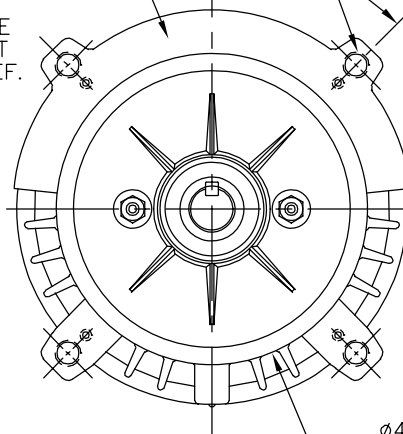

$\phi 4.500^{+.000}_{-.003}$
 $\phi 114.30^{+.00}_{-.08}$

THIS DIA. MUST BE CONCENTRIC WITH SHAFT WITHIN .004[.10] T.I.R. INDICATOR CONTROL ARM LOCATED AT END OF SHAFT

FIRST MOTOR REF	PERFORMANCE CURVE #	MAIN FRAME LENGTH REF	C	AG	EXT. LENGTH	USABLE EXT.	KEY LENGTH	GRAINGER MODEL NO.
K1024L	-----	4.562[115.87]	9.56[242.8]	7.50[190.5]	2.06[52.3]	1.88[47.8]	1.38[35.1]	-----
K1024LD	-----	4.562[115.87]	9.56[242.8]	7.50[190.5]	2.06[52.3]	1.88[47.8]	1.38[35.1]	-----
F392	C26027	4.562[115.87]	9.90[251.5]	7.46[189.5]	2.44[62.0]	2.26[57.4]	1.88[47.8]	4MB68
F394	-----	4.812[122.22]	10.15[257.8]	7.71[195.8]	2.44[62.0]	2.26[57.4]	1.88[47.8]	4MB76

GEOMETRIC CHARACTERISTICS & SYMBOLS
 □ FLATNESS
 - STRAIGHTNESS
 < ANGLARITY
 ⊥ PERPENDICULARITY (SQUARENESS)
 // PARALLELISM
 ○ ROUNDNESS (CIRCULARITY)
 ∅ CYLINDRICITY
 △ PROFILE OF ANY SURFACE
 ∩ PROFILE OF ANY LINE
 ↑ RUNOUT
 ⊕ TRUE POSITION
 ⊙ CONCENTRICITY
 = SYMMETRY
 ASME Y14.5M 1994

UNLESS OTHERWISE SPECIFIED DIM. TOLERANCES ARE AS FOLLOWS:
 INCH X XX XXX XXXX
 ±.1 ±.02 ±.005 ±.0005
 mm ±0.5 ±0.13 ±0.013
 ANG. ±.50 DEG
 REMOVE BURRS & BREAK SHARP EDGES:
 INCH .003-.015 mm 0.1-0.4
 CORNER FILLETS TO:
 INCH .020 mm 0.5
 MACHINE SURFACES:
 INCH 125 mm 3.2
 METRIC DIMS. SHOWN IN [BRACKETS]

DR BY: K.Line 06-25-1997
 APPD:
 THIRD ANGLE PROJECTION
 EDS DATE 11-11-2011
 FORMAT REV G
 CONFIDENTIAL: THIS DRAWING AND ITS INFORMATION ARE THE EXCLUSIVE AND CONFIDENTIAL PROPERTY OF REGAL-BELOIT CORPORATION AND ARE NOT TO BE DISCLOSED, DUPLICATED, DISTRIBUTED OR OTHERWISE USED WITHOUT THE WRITTEN CONSENT OF REGAL-BELOIT CORPORATION. -ALL RIGHTS RESERVED.

REGAL-BELOIT CORPORATION

DESCRIPTION: MODEL-RFHP-48FR OUTLINE

SIZE: C DWG NO: 11762-008

SCALE: NONE SHEET: 1

4

3

2

1

4

3

2

1

REVISION:	ECO	REVISADO POR:	FECHA:	APROBADO POR:	FECHA:
G	0025400	J.M.Ramirez	04-16-2012	R.Rascon	04-16-2012

VISTA SUPERIOR DE LA ETIQUETA DE ADVERTENCIA

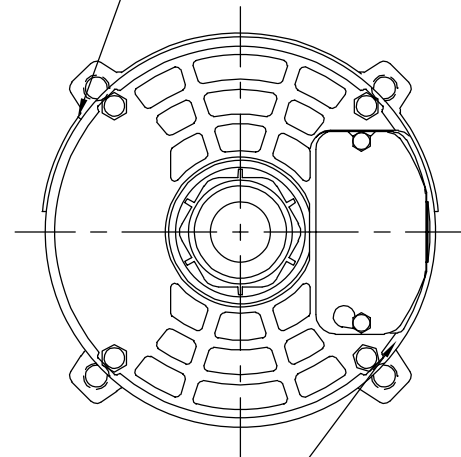

TUBO ROSCADO .500[12.70] PARA EL CONDUCTOR DE CONEXION. TAPADO

VISTA SUPERIOR DE LA ETIQUETA DE DATOS

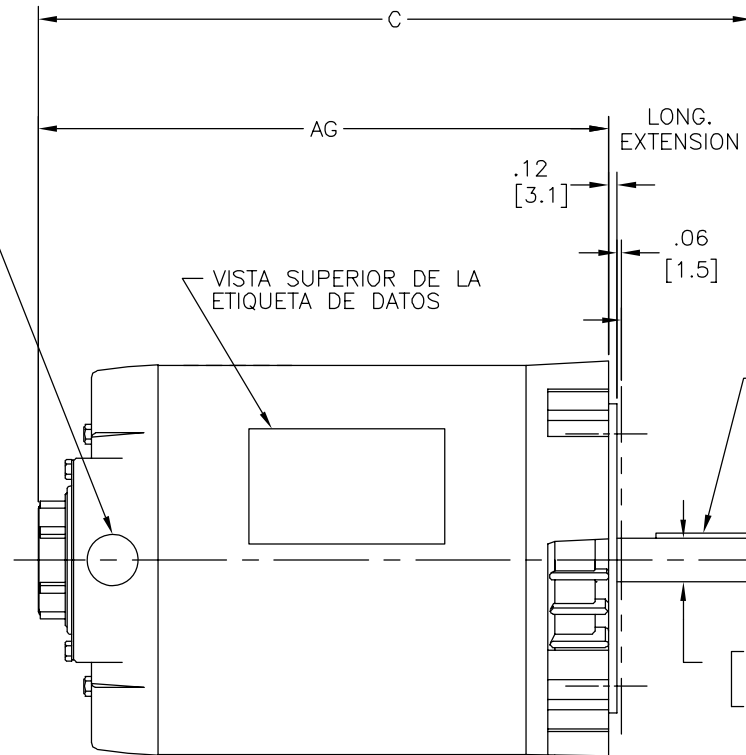

PLANO USABLE

.19[4.8] PERPEND. A LA CUÑA. VER TABLA PARA LA LONG. REF.

$\phi .6250^{+.0000}_{-.0005}$
 $\phi 15.874^{+.000}_{-.013}$

ESTA CARA DEBE ESTAR PERPENDICULAR CON LA FLECHA DENTRO DE .004[.10] L.T.I. CON EL CONTROL DE BRAZO INDICADOR LOCALIZADO AL EXTREMO DE LA FLECHA

ROSCAS 3/8-16 UNC-2B .75[19.0] ON A $\phi 5.88[\phi 149.4]$ ENTRE CENTROS

4X

45°

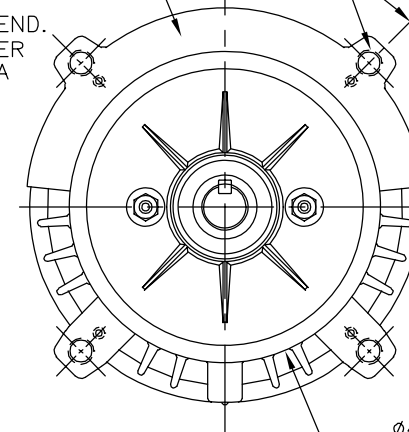

$\phi 4.500^{+.000}_{-.003}$
 $\phi 114.30^{+.00}_{-.08}$

ESTE DIAMETRO DEBE ESTAR CONCENTRICO CON LA FLECHA DENTRO DE .004[.10] L.T.I. CON EL CONTROL DE BRAZO INDICADOR LOCALIZADO AL EXTREMO DE LA FLECHA

3X LINEA DE LA RANURA DEL CABLE

PRIMER MOTOR REF	# CURVA DE FUNC.	LONG. DE LA CARCAZA REF	C	AG	LONGITUD EXTENSION	EXT. USABLE	LONG. CUÑA	NUM. MODELO GRAINGER
K1024L	-----	4.562[115.87]	9.56[242.8]	7.50[190.5]	2.06[52.3]	1.88[47.8]	1.38[35.1]	-----
K1024LD	-----	4.562[115.87]	9.56[242.8]	7.50[190.5]	2.06[52.3]	1.88[47.8]	1.38[35.1]	-----
F392	C26027	4.562[115.87]	9.90[251.5]	7.46[189.5]	2.44[62.0]	2.26[57.4]	1.88[47.8]	4MB68
F394	-----	4.812[122.22]	10.15[257.8]	7.71[195.8]	2.44[62.0]	2.26[57.4]	1.88[47.8]	4MB76

CARACTERISTICAS DE GEOMETRIA Y SIMBOLOS
 □ PLANICIDAD
 — RECTITUD
 < ANGULARIDAD
 ⊥ PERPENDICULARIDAD (A ESCUADRA)
 // PARALELISMO
 ○ REDONDEZ (CIRCULARIDAD)
 ∅ CILINDRICIDAD
 △ PERFIL DE CUALQUIER SUPERFICIE
 ▲ PERFIL DE CUALQUIER LINEA
 ↗ VARIACION
 ⊕ POSICION REAL
 ⊙ CONCENTRICIDAD
 = SIMETRIA

A MENOS QUE SE ESPECIFIQUE DE OTRA MANERA, LAS TOLERANCIAS DE LAS DIMS; SON LAS SIGUIENTES:
 PULG ±.1 ±.02 ±.005 ±.0005
 mm ±0.5 ±0.13 ±0.013
 ANG. ± 50 GRADOS
 ELIMINAR REBABAS Y ORILLAS FILOSAS DEL BORDE.
 PULG .003-.015 mm 0.1-0.4
 FILETEAR ESQUINA: PULG .020 mm 0.5
 MAQUINAR SUPERFICIES
 PULG 125 mm 3.2

DIBUJADO POR: K.Line 06-25-1997
 APROBADO POR:
 TERCER ANGULO DE PROYECCION
 CONFIDENCIAL: ESTE DIBUJO Y SU INFORMACION SON PROPIEDAD DE USO EXCLUSIVO Y CONFIDENCIAL DE REGAL-BELOIT CORPORATION. Y NO DEBERAN SER REVELADOS, DUPLICADOS, DISTRIBUIDOS O USARSE DE OTRA MANERA SIN EL CONSENTIMIENTO ESCRITO DE REGAL-BELOIT CORPORATION. -TODOS LOS DERECHOS RESERVADOS.

REGAL-BELOIT CORPORATION

DESCRIPCION: MODEL-RFHP-48FR OUTLINE

TAMAÑO: C NUMERO DE DIBUJO: 11762-008

ESCALA: NONE HOJA: 1

4

3

2

1

4

3

2

1

版本	ECO	编制	日期	批准	日期
G	0025400	J.M.Ramirez	04-16-2012	R.Rascon	04-16-2012

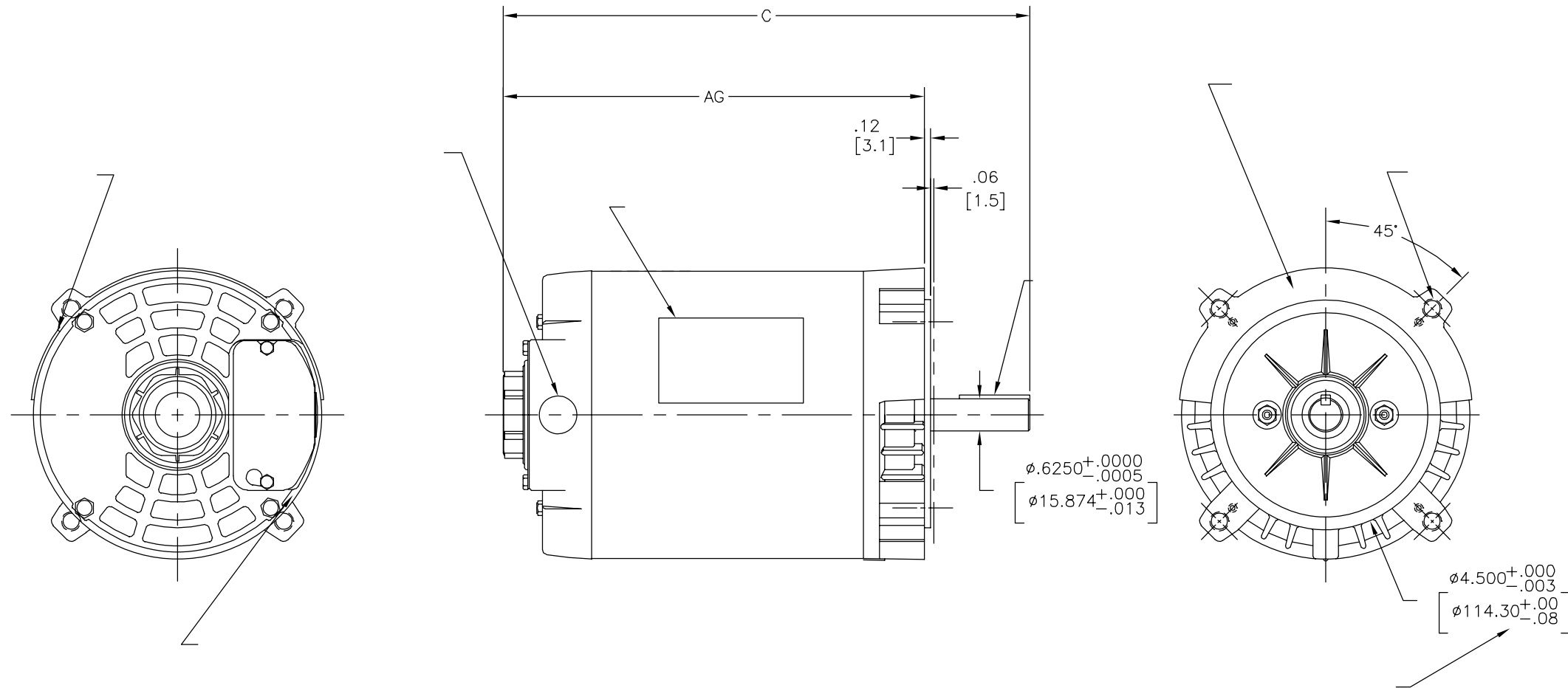

			C	AG				
K1024L	-----	4.562[115.87]	9.56[242.8]	7.50[190.5]	2.06[52.3]	1.88[47.8]	1.38[35.1]	-----
K1024LD	-----	4.562[115.87]	9.56[242.8]	7.50[190.5]	2.06[52.3]	1.88[47.8]	1.38[35.1]	-----
F392	C26027	4.562[115.87]	9.90[251.5]	7.46[189.5]	2.44[62.0]	2.26[57.4]	1.88[47.8]	4MB68
F394	-----	4.812[122.22]	10.15[257.8]	7.71[195.8]	2.44[62.0]	2.26[57.4]	1.88[47.8]	4MB76

- 形位公差
- 平面度
 - 直线度
 - ∠ 倾斜度
 - ⊥ 垂直度
 - ∥ 平行度
 - 圆度
 - ⊘ 圆柱度
 - △ 面轮廓度
 - ⌒ 线轮廓度
 - ↗ 圆跳动
 - ⊕ 位置度
 - ⊙ 同轴度
 - ≡ 对称度

ASME Y14.5M 1994

除另有注明
尺寸公差如下:

英寸	±.1	±.02	±.005	±.0005
毫米	±0.5	±0.13	±0.013	

角度 ±.50 度
清理毛刺和尖棱
英寸 .003-.015 毫米 0.1-0.4
内圆角
英寸 .020 毫米 0.5
表面粗糙度
英制 125 米制 3.2

米制尺寸显示在 []

绘图: K.Line 06-25-1997

批准:

第三角投影

图纸格式发布日期 11-11-2011
图纸格式版本 G

机密: 本图纸及相关信息所有权归REGAL-BELOIT CORPORATION
未经REGAL-BELOIT CORPORATION书面授权, 不得泄露、
复制、传播或作其他用途。—版权所有

REGAL REGAL-BELOIT CORPORATION

名称: MODEL-RFHP-48FR
OUTLINE

图幅: C 图号: 11762-008

比例: NONE 页号: 1

4

3

2

1