



WORLDWIDE ELECTRIC MOTOR DATA SHEET

EP75-12-405TC



HORSEPOWER	75		
RPM / POLES	1200 / 6		
VOLTAGE / PHASE	230 / 460 V / 3		
FRAME	405TC		
ENCLOSURE / DEGREE OF PROTECTION	TEFC / IP55		
FREQUENCY	60 HZ Suitable For 50 HZ Operation With 1.0 SF		
FULL LOAD SPEED	1190 RPM		
SERVICE FACTOR	1.25 SF at 40° C / 1.0 SF at 55° C		
INSULATION CLASS	F		
FULL LOAD AMPS; 230 / 460	181.4 / 90.7 A		
LOCKED ROTOR AMPS (STARTING); 230 / 460	1086 / 543 A		
NO LOAD CURRENT	61.2 / 30.6 A		
NEMA CODE LETTER	G		
EFFICIENCY / POWER FACTOR	<u>LOAD</u>	<u>EFF.</u>	<u>P.F.</u>
	100%	94.5%	0.82
	75%	94.3%	0.81
	50%	92.9%	0.80
DUTY CYCLE	S1 / Continuous		
TORQUE	<u>FULL LOAD</u>	<u>LRT</u>	<u>BDT</u>
	331.13 lb.ft.	210%	250%
SLIP	1.11%		
NEMA DESIGN	B		
MOMENT OF INERTIA	48.9 lb.ft. ²		
NUMBER OF STARTS (Hot / Cold)	2 Hot / 3 Cold		
MAX. AMBIENT TEMPERATURE	40° C at 1.25 SF / 55° C at 1.0 SF		
MAX. ELEVATION	3300 Ft. Above Sea Level		
TEMPERATURE RISE (At Full Load)	80° C		
DE BEARING	6316		
ODE BEARING	6313		
GREASE TYPE	Mobil Polyrex EM		
MOUNTING	F1 (F2 Suitable)		
ROTATION	Bi-Directional		
APPROXIMATE WEIGHT	1180 lbs.		
AREA CLASSIFICATION	Class I, Division 2, Groups A, B, C, D		
INVERTER RATING	10:1 CT / 20:1 VT PWM Type		
SPECIFICATION - In Accordance With	NEMA, CSA		



CC067A



MARCH 10, 2015



WORLDWIDE ELECTRIC MOTOR DRAWING

EP-405TC

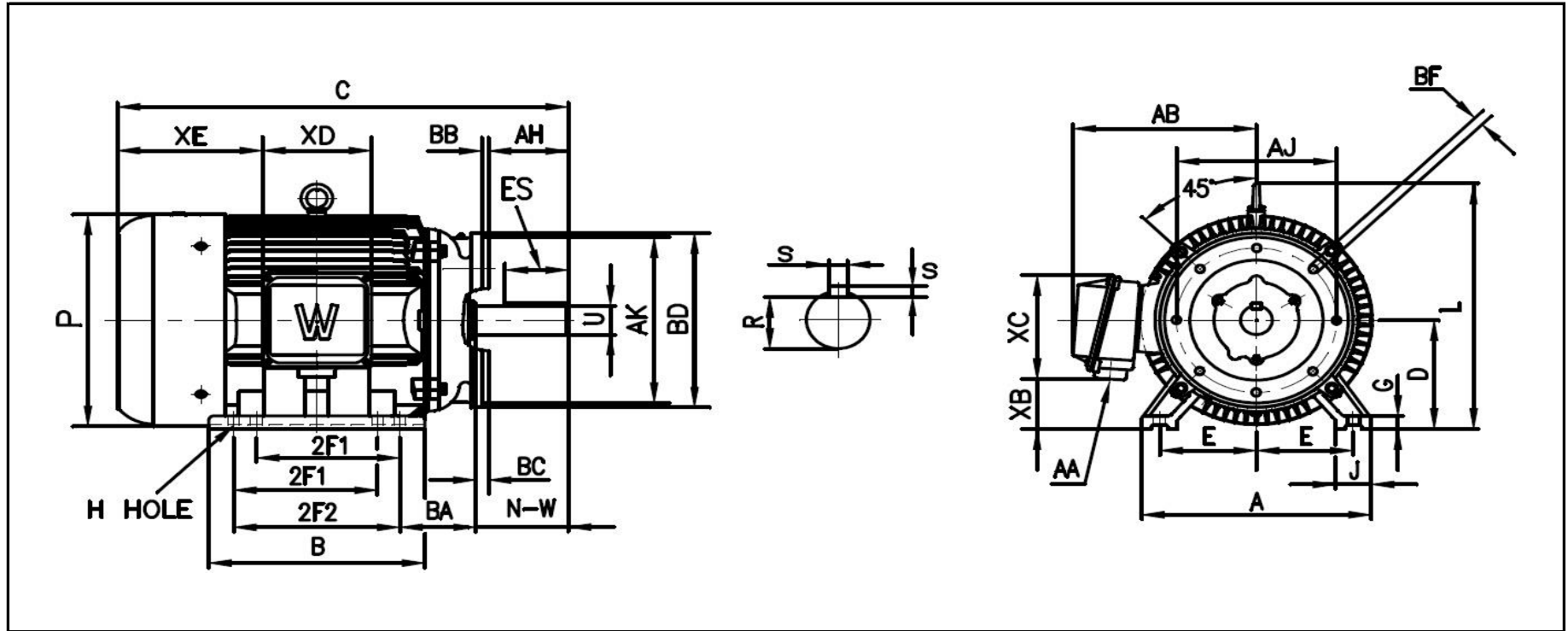

DIMENSIONS - INCHES

MOUNTING					A	B	C	D	G	J	P	L	AB	AH	BC
E	2F1	2F2	H	BA											
8	12.25	13.75	0.81	6.62	19.29	17.8	38.3	10	1.18	3.15	20.53	23.46	18.11	7	0.25

KEY		KEYSET	FLANGE				SHAFT		TERMINAL BOX					
S	ES	R	AK	AJ	BF	BB	BD	N-W	U	AA	XB	XC	XD	XE
0.75	5.65	2.45	12.5	11	5/8-11	0.25	15.5	7.25	2.875	3	4.57	11.73	9.76	12.48