



WORLDWIDE ELECTRIC MOTOR DATA SHEET

EP75-18-365TC



HORSEPOWER	75		
RPM / POLES	1800 / 4		
VOLTAGE / PHASE	230 / 460 V / 3		
FRAME	365TC		
ENCLOSURE / DEGREE OF PROTECTION	TEFC / IP55		
FREQUENCY	60 HZ Suitable For 50 HZ Operation With 1.0 SF		
FULL LOAD SPEED	1785 RPM		
SERVICE FACTOR	1.25 SF at 40° C / 1.0 SF at 55° C		
INSULATION CLASS	F		
FULL LOAD AMPS; 230 / 460	167.5 / 83.75 A		
LOCKED ROTOR AMPS (STARTING); 230 / 460			
NO LOAD CURRENT	51.0 / 25.5 A		
NEMA CODE LETTER	G		
EFFICIENCY / POWER FACTOR	<u>LOAD</u>	<u>EFF.</u>	<u>P.F.</u>
	100%	95.4%	0.88
	75%	95.3%	0.86
	50%	92.1%	0.78
DUTY CYCLE	S1 / Continuous		
TORQUE	<u>FULL LOAD</u>	<u>LRT</u>	<u>BDT</u>
	221.0 lb.ft.	210%	250%
SLIP	0.80%		
NEMA DESIGN	B		
MOMENT OF INERTIA	16.9 lb.ft. ²		
NUMBER OF STARTS (Hot / Cold)	2 Hot / 3 Cold		
MAX. AMBIENT TEMPERATURE	40° C at 1.25 SF / 55° C at 1.0 SF		
MAX. ELEVATION	3300 Ft. Above Sea Level		
TEMPERATURE RISE (At Full Load)	80° C		
DE BEARING	6313		
ODE BEARING	6312		
GREASE TYPE	Mobil Polyrex EM		
MOUNTING	F1 (F2 Suitable)		
ROTATION	Bi-Directional		
APPROXIMATE WEIGHT	891 lbs.		
AREA CLASSIFICATION	Class I, Division 2, Groups A, B, C, D		
INVERTER RATING	10:1 CT / 20:1 VT PWM Type		
SPECIFICATION - In Accordance With	NEMA, CSA		



CC067A



MARCH 10, 2015



WORLDWIDE ELECTRIC MOTOR DRAWING

EP-365TC

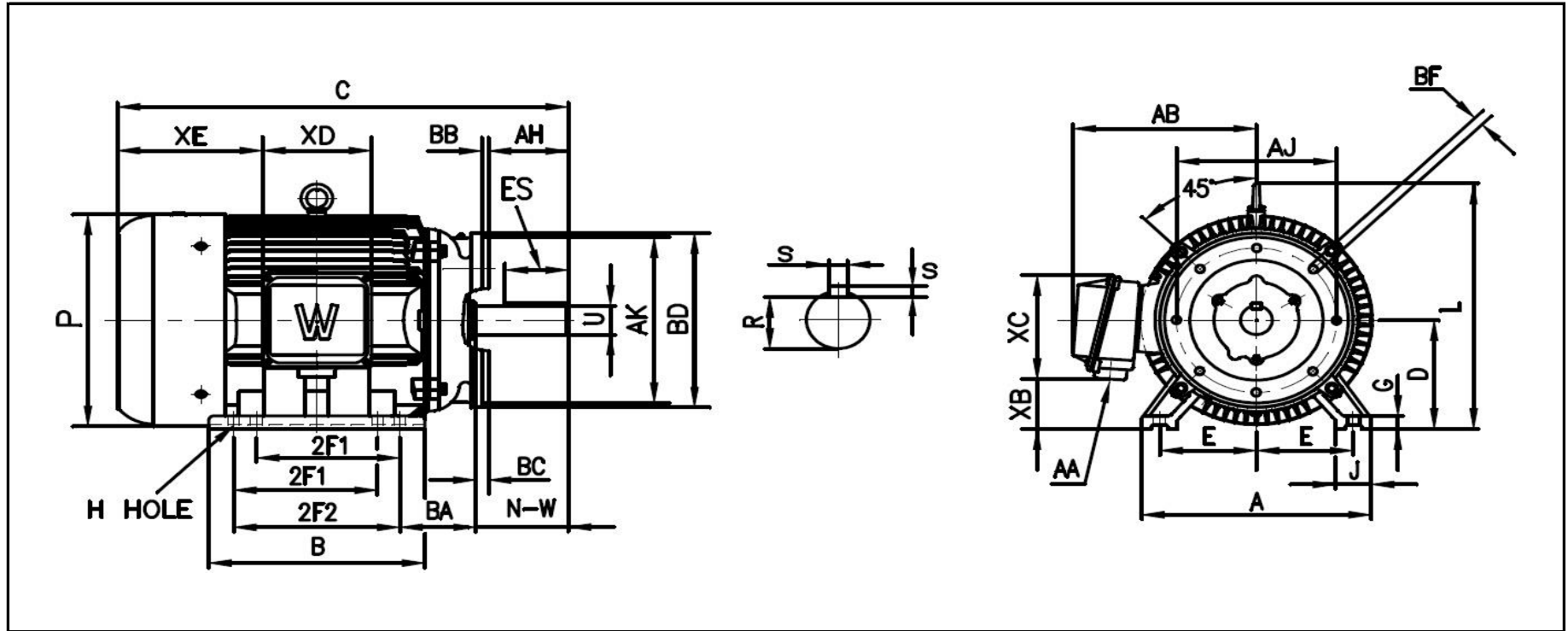

DIMENSIONS - INCHES

MOUNTING					A	B	C	D	G	J	P	L	AB	AH	BC
E	2F1	2F2	H	BA											
7	11.25	12.25	0.66	5.88	17	15.56	34.06	9	1.102	3.15	18.25	21	16.73	5.62	0.25

KEY		KEYSET	FLANGE				SHAFT		TERMINAL BOX					
S	ES	R	AK	AJ	BF	BB	BD	N-W	U	AA	XB	XC	XD	XE
0.625	4.28	2.021	12.5	11	5/8-11	0.25	14	5.88	2.375	3	3.3	11.73	9.76	11.5



Motor Performance Curves

Motor type:	EPIC				
Output rating (HP)	75	FL Speed:	1785		
Full Load Torque :	221	lb.ft	LRT (% FLT):	210	460 volt FLA: 83.8
Rotor Wk ² :	16.9	lb-ft ²	BDT (% FLT):	250	230 volt FLA: 167.5

SPEED VS TORQUE & CURRENT CURVE

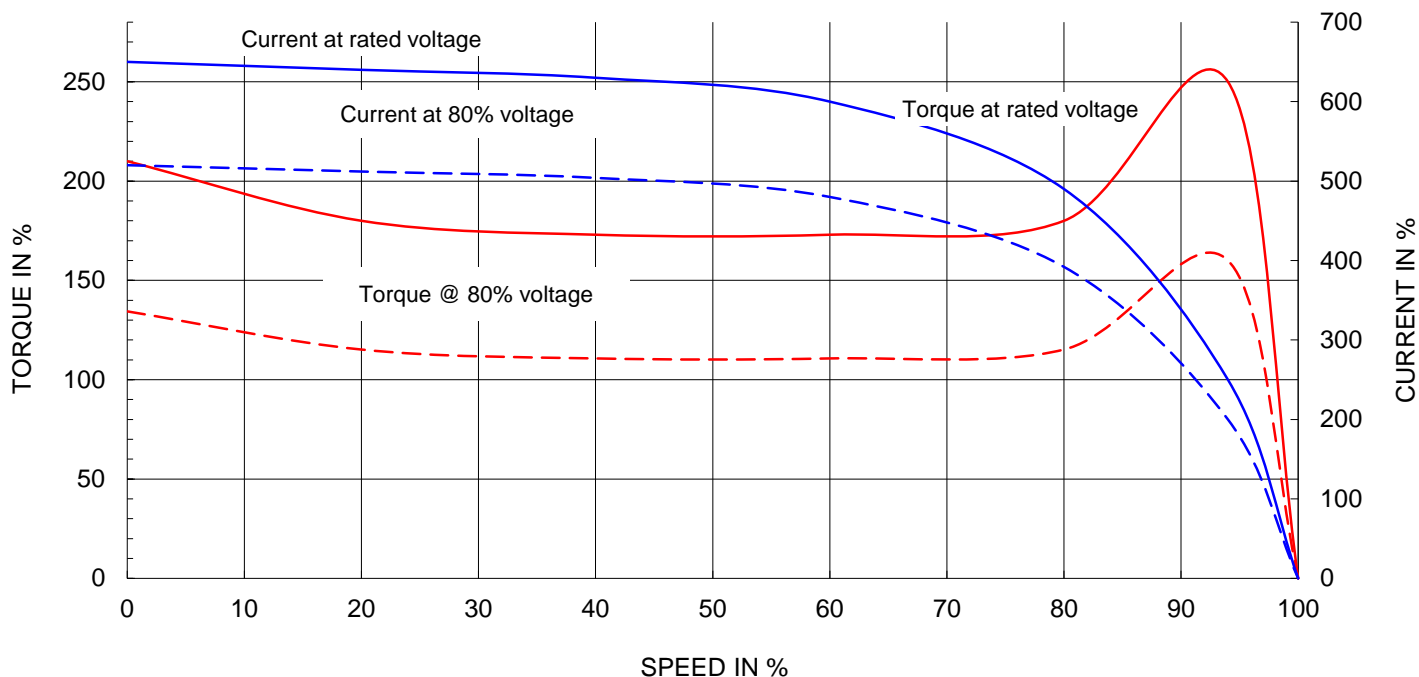

OUTPUT VS EFF., P.F & CURRENT CURVE

