



WORLDWIDE ELECTRIC MOTOR DATA SHEET

EP50-18-326TC



HORSEPOWER	50	50	
RPM / POLES	1800 / 4	1500 / 4	
VOLTAGE / PHASE	230 / 460 V / 3	200 / 400 V / 3	
FRAME	326TC		
ENCLOSURE / DEGREE OF PROTECTION	TEFC / IP55		
FREQUENCY	60 HZ	50 HZ	
FULL LOAD SPEED	1775 RPM	1473 RPM	
SERVICE FACTOR	1.25 SF at 40° C	1.0 SF at 55° C	
INSULATION CLASS	F		
FULL LOAD AMPS	121 / 60.4 A	138.9 / 69.5 A	
LOCKED ROTOR AMPS (STARTING)	725 / 362.5 A	833.8 / 416.9 A	
NO LOAD CURRENT	34.2 / 17.1 A	39.3 / 19.7 A	
NEMA CODE LETTER	G		
EFFICIENCY / POWER FACTOR	<u>LOAD</u>	<u>EFF.</u>	<u>P.F.</u>
	100%	94.5%	0.86
	75%	94.5%	0.82
	50%	92.8%	0.74
DUTY CYCLE	S1 / Continuous		
TORQUE	<u>FULL LOAD</u>	<u>LRT</u>	<u>BDT</u>
	148.0 lb.ft.	200%	230%
SLIP	1.40%		
NEMA DESIGN	B		
MOMENT OF INERTIA	14.1 lb.ft.²		
NUMBER OF STARTS (Hot / Cold)	2 Hot / 3 Cold		
MAX. AMBIENT TEMPERATURE	40° C at 1.25 SF / 55° C at 1.0 SF		
MAX. ELEVATION	3300 Ft. Above Sea Level		
TEMPERATURE RISE (At Full Load)	80° C		
DE BEARING	6312		
ODE BEARING	6312		
GREASE TYPE	Mobil Polyrex EM		
MOUNTING	F1 (F2 Suitable)		
ROTATION	Bi-Directional		
APPROXIMATE WEIGHT	580 lbs.		
AREA CLASSIFICATION	Class I, Division 2, Groups A, B, C, D		
INVERTER RATING	10:1 CT / 20:1 VT PWM Type		
SPECIFICATION - In Accordance With	NEMA, CSA		



CC067A



MARCH 10, 2015



WORLDWIDE ELECTRIC MOTOR DRAWING

EP-326TC

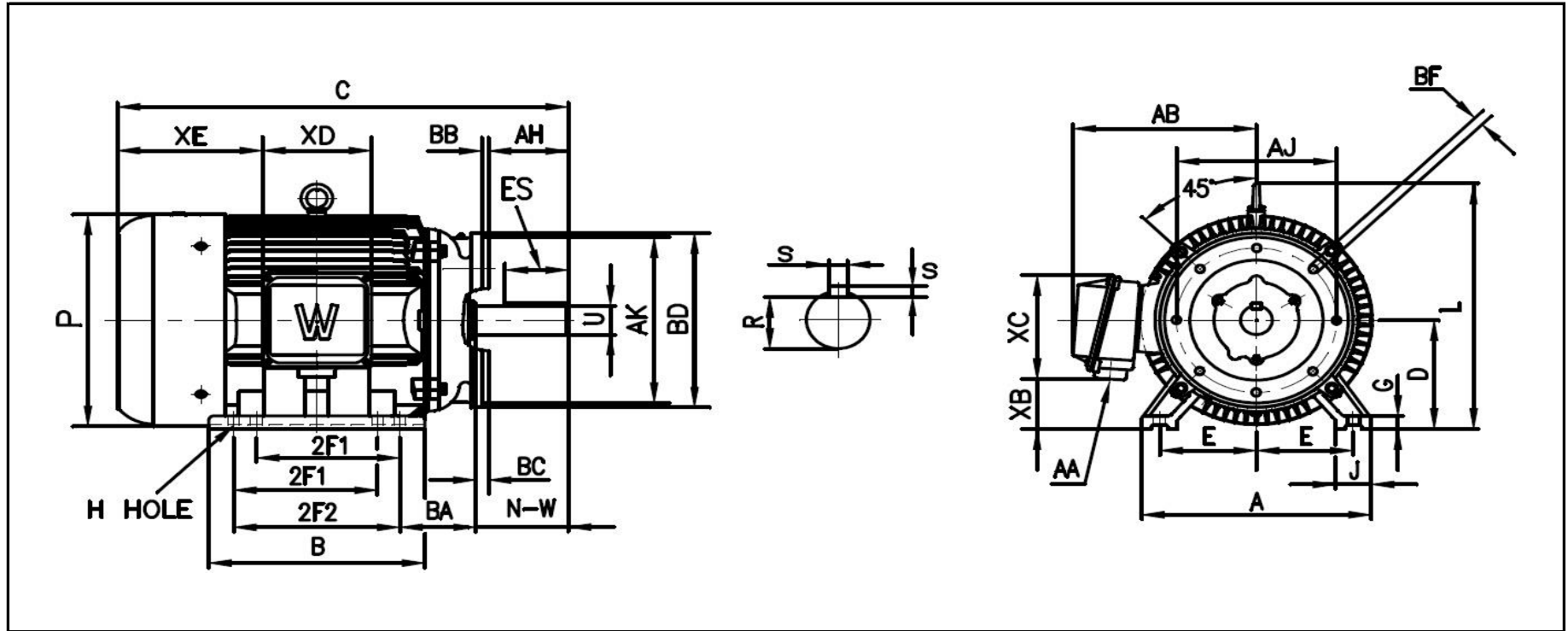

DIMENSIONS - INCHES

MOUNTING					A	B	C	D	G	J	P	L	AB	AH	BC
E	2F1	2F2	H	BA											
6.25	10.5	12	0.66	5.25	15.3	14	30.9	8	0.984	2.76	16.57	18.25	14.17	5	0.25

KEY		KEYSET	FLANGE				SHAFT		TERMINAL BOX					
S	ES	R	AK	AJ	BF	BB	BD	N-W	U	AA	XB	XC	XD	XE
0.5	3.91	1.845	12.5	11	5/8-11	0.25	13.78	5.25	2.125	3	2.64	10.55	8.98	10.47



Motor Performance Curves

Motor type:	EPIC				
Output rating (HP)	50	FL Speed:	1775		
Full Load Torque :	148	lb.ft	LRT (% FLT):	200	460 volt FLA: 60.4
Rotor Wk ² :	14.1	lb-ft ²	BDT (% FLT):	230	230 volt FLA: 120.8

SPEED VS TORQUE & CURRENT CURVE

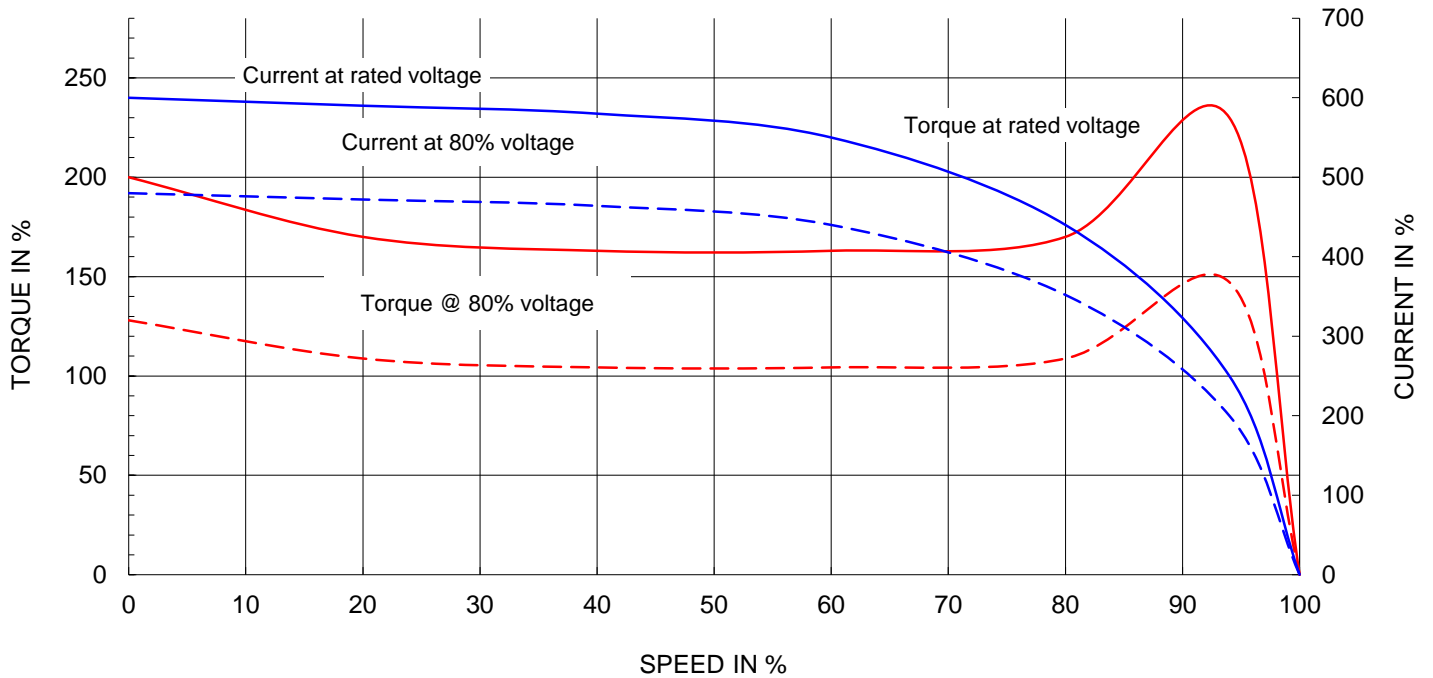

OUTPUT VS EFF., P.F & CURRENT CURVE

