



WORLDWIDE ELECTRIC MOTOR DATA SHEET

EP10-18-215TC



HORSEPOWER	10		
RPM / POLES	1800 / 4		
VOLTAGE / PHASE	230 / 460 V / 3		
FRAME	215TC		
ENCLOSURE / DEGREE OF PROTECTION	TEFC / IP55		
FREQUENCY	60 HZ Suitable For 50 HZ Operation With 1.0 SF		
FULL LOAD SPEED	1750 RPM		
SERVICE FACTOR	1.25 SF at 40° C / 1.0 SF at 55° C		
INSULATION CLASS	F		
FULL LOAD AMPS; 230 / 460	24.9 / 12.45 A		
LOCKED ROTOR AMPS (STARTING); 230 / 460	205 / 102.5 A		
NO LOAD CURRENT	10.54 / 5.27 A		
NEMA CODE LETTER	H		
EFFICIENCY / POWER FACTOR	<u>LOAD</u>	<u>EFF.</u>	<u>P.F.</u>
	100%	91.8%	0.83
	75%	91.7%	0.82
	50%	89.0%	0.76
DUTY CYCLE	S1 / Continuous		
TORQUE	<u>FULL LOAD</u>	<u>LRT</u>	<u>BDT</u>
	30.0 lb.ft.	210%	265%
SLIP	2.80%		
NEMA DESIGN	B		
MOMENT OF INERTIA	1.97 lb.ft.²		
NUMBER OF STARTS (Hot / Cold)	2 Hot / 3 Cold		
MAX. AMBIENT TEMPERATURE	40° C at 1.25 SF / 55° C at 1.0 SF		
MAX. ELEVATION	3300 Ft. Above Sea Level		
TEMPERATURE RISE (At Full Load)	80° C		
DE BEARING	6308ZZ		
ODE BEARING	6306ZZ		
GREASE TYPE	Mobil Polyrex EM		
MOUNTING	F1 (F2 Suitable)		
ROTATION	Bi-Directional		
APPROXIMATE WEIGHT	175 lbs.		
AREA CLASSIFICATION	Class I, Division 2, Groups A, B, C, D		
INVERTER RATING	10:1 CT / 20:1 VT PWM Type		
SPECIFICATION - In Accordance With	NEMA, CSA		



CC067A



MARCH 10, 2015



WORLDWIDE ELECTRIC MOTOR DRAWING

EP-215TC

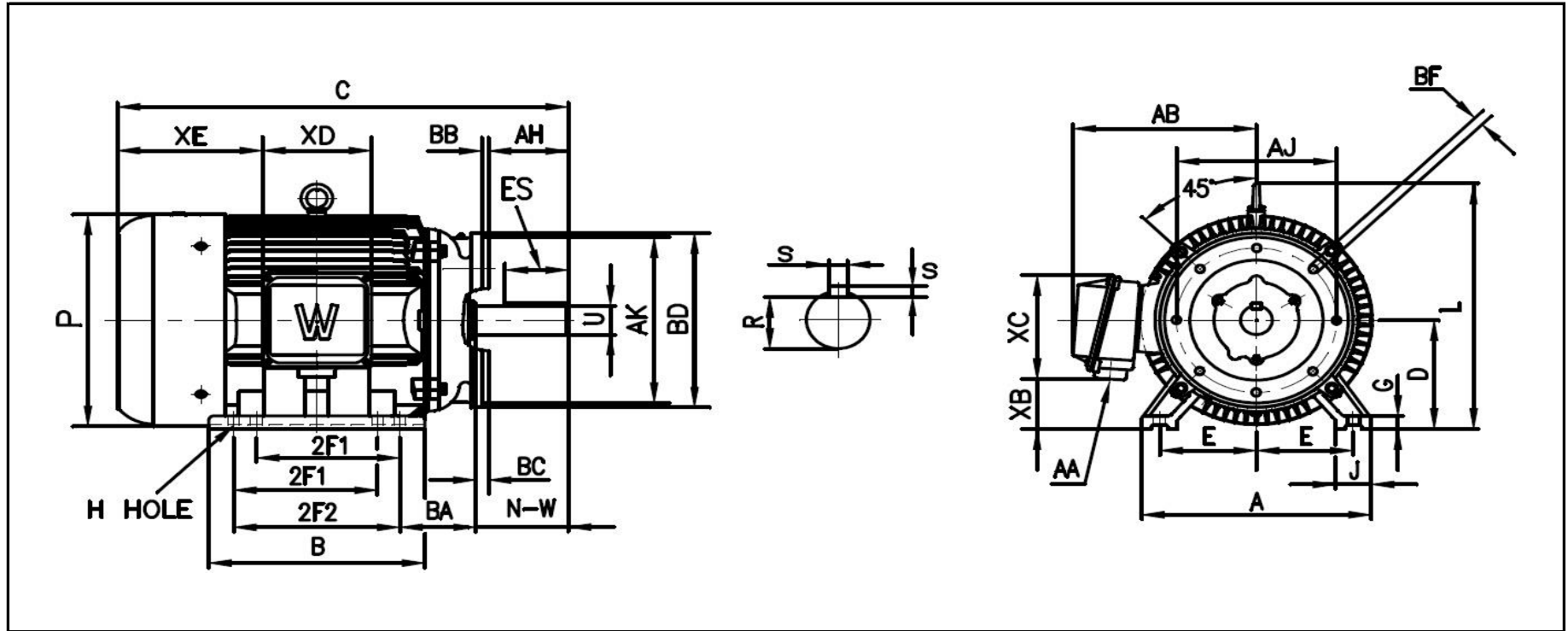

DIMENSIONS - INCHES

MOUNTING					A	B	C	D	G	J	P	L	AB	AH	BC
E	2F1	2F2	H	BA											
4.25	5.5	7	0.41	3.5	10.51	9	20.5	5.25	0.78	2.36	10.75	12.26	8.63	3.12	0.25

KEY		KEYSET	FLANGE				SHAFT		TERMINAL BOX					
S	ES	R	AK	AJ	BF	BB	BD	N-W	U	AA	XB	XC	XD	XE
0.312	2.41	1.201	8.5	7.25	1/2-13	0.25	8.99	3.38	1.375	1	2.95	5	4.57	7.48



Motor Performance Curves

Motor type:	EPIC				
Output rating (HP)	10	FL Speed:	1750		
Full Load Torque :	30 lb.ft	LRT (% FLT):	210	460 volt FLA:	12.5
Rotor Wk ² :	1.97 lb-ft ²	BDT (% FLT):	265	230 volt FLA:	24.9

SPEED VS TORQUE & CURRENT CURVE

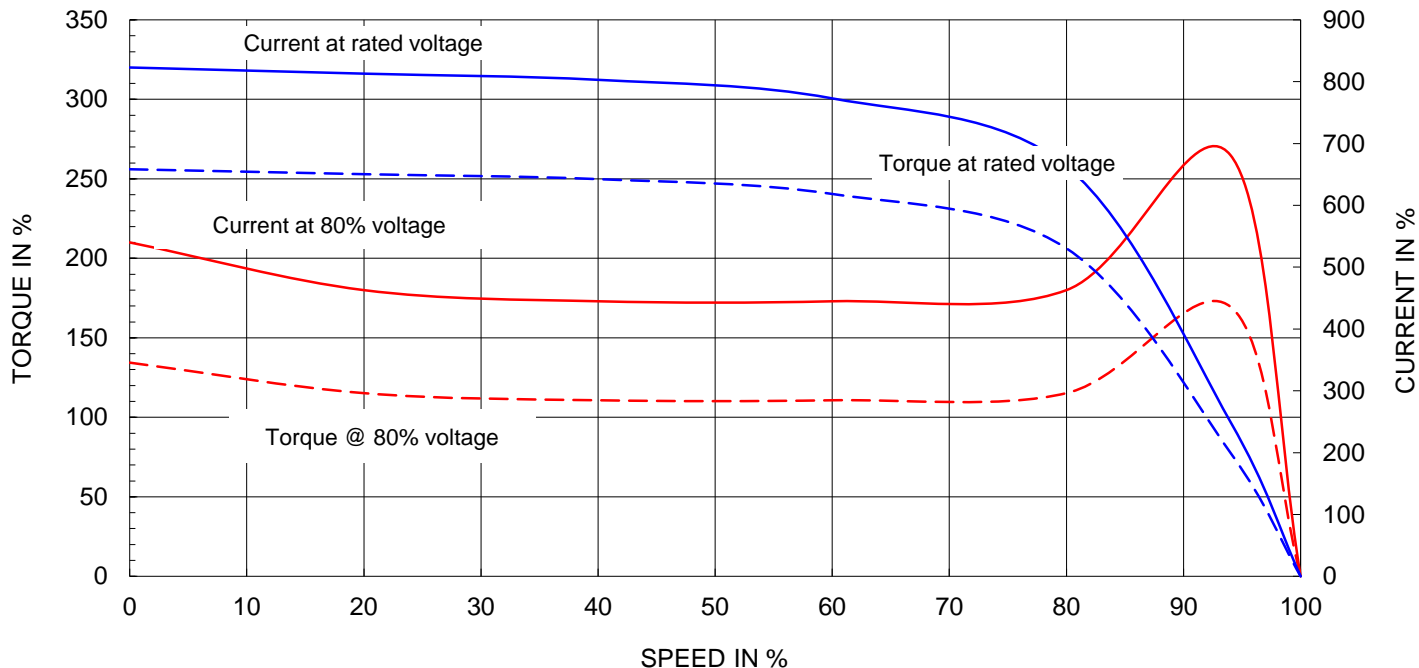

OUTPUT VS EFF., P.F & CURRENT CURVE

