



# WORLDWIDE ELECTRIC MOTOR DATA SHEET

## EP7.5-18-213TC



HORSEPOWER	7.5		
RPM / POLES	1800 / 4		
VOLTAGE / PHASE	230 / 460 V / 3		
FRAME	213TC		
ENCLOSURE / DEGREE OF PROTECTION	TEFC / IP55		
FREQUENCY	60 HZ Suitable For 50 HZ Operation With 1.0 SF		
FULL LOAD SPEED	1760 RPM		
SERVICE FACTOR	1.25 SF at 40° C / 1.0 SF at 55° C		
INSULATION CLASS	F		
FULL LOAD AMPS; 230 / 460	18.68 / 9.34 A		
LOCKED ROTOR AMPS (STARTING); 230 / 460	127 / 63.5 A		
NO LOAD CURRENT	8.44 / 4.22 A		
NEMA CODE LETTER	H		
EFFICIENCY / POWER FACTOR	<u>LOAD</u>	<u>EFF.</u>	<u>P.F.</u>
	100%	91.8%	0.83
	75%	91.7%	0.82
	50%	89.0%	0.76
DUTY CYCLE	S1 / Continuous		
TORQUE	<u>FULL LOAD</u>	<u>LRT</u>	<u>BDT</u>
	22.4 lb.ft.	210%	270%
SLIP	2.20%		
NEMA DESIGN	B		
MOMENT OF INERTIA	1.814 lb.ft. <sup>2</sup>		
NUMBER OF STARTS (Hot / Cold)	2 Hot / 3 Cold		
MAX. AMBIENT TEMPERATURE	40° C at 1.25 SF / 55° C at 1.0 SF		
MAX. ELEVATION	3300 Ft. Above Sea Level		
TEMPERATURE RISE (At Full Load)	80° C		
DE BEARING	6308ZZ		
ODE BEARING	6306ZZ		
GREASE TYPE	Mobil Polyrex EM		
MOUNTING	F1 (F2 Suitable)		
ROTATION	Bi-Directional		
APPROXIMATE WEIGHT	158 lbs.		
AREA CLASSIFICATION	Class I, Division 2, Groups A, B, C, D		
INVERTER RATING	10:1 CT / 20:1 VT PWM Type		
SPECIFICATION - In Accordance With	NEMA, CSA		



CC067A



MARCH 10, 2015



# WORLDWIDE ELECTRIC MOTOR DRAWING

## EP-213TC

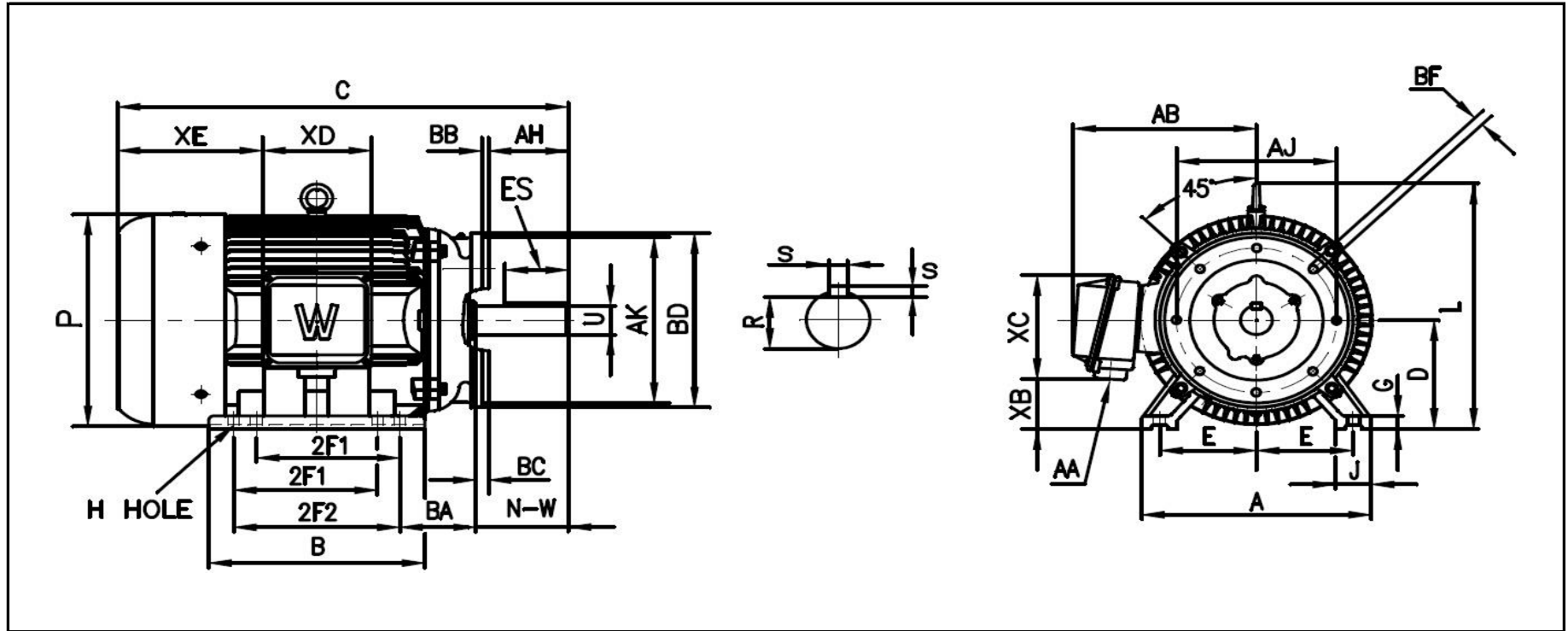

DIMENSIONS - INCHES

MOUNTING					A	B	C	D	G	J	P	L	AB	AH	BC
E	2F1	2F2	H	BA											
4.25	5.5	---	0.41	3.5	10.5	7.5	19	5.25	0.78	2.36	10.74	12.86	8.63	3.12	0.25

KEY		KEYSET	FLANGE				SHAFT		TERMINAL BOX					
S	ES	R	AK	AJ	BF	BB	BD	N-W	U	AA	XB	XC	XD	XE
0.312	2.41	1.201	8.5	7.25	1/2-13	0.25	8.99	3.38	1.375	1	2.95	5	4.57	6.77



# Motor Performance Curves

Motor type:	EPIC			
Output rating (HP)	7.5	FL Speed:	1760	
Full Load Torque :	22.4 lb.ft	LRT (% FLT):	210	460 volt FLA: 9.3
Rotor Wk <sup>2</sup> :	1.81 lb-ft <sup>2</sup>	BDT (% FLT):	270	230 volt FLA: 18.7

SPEED VS TORQUE & CURRENT CURVE

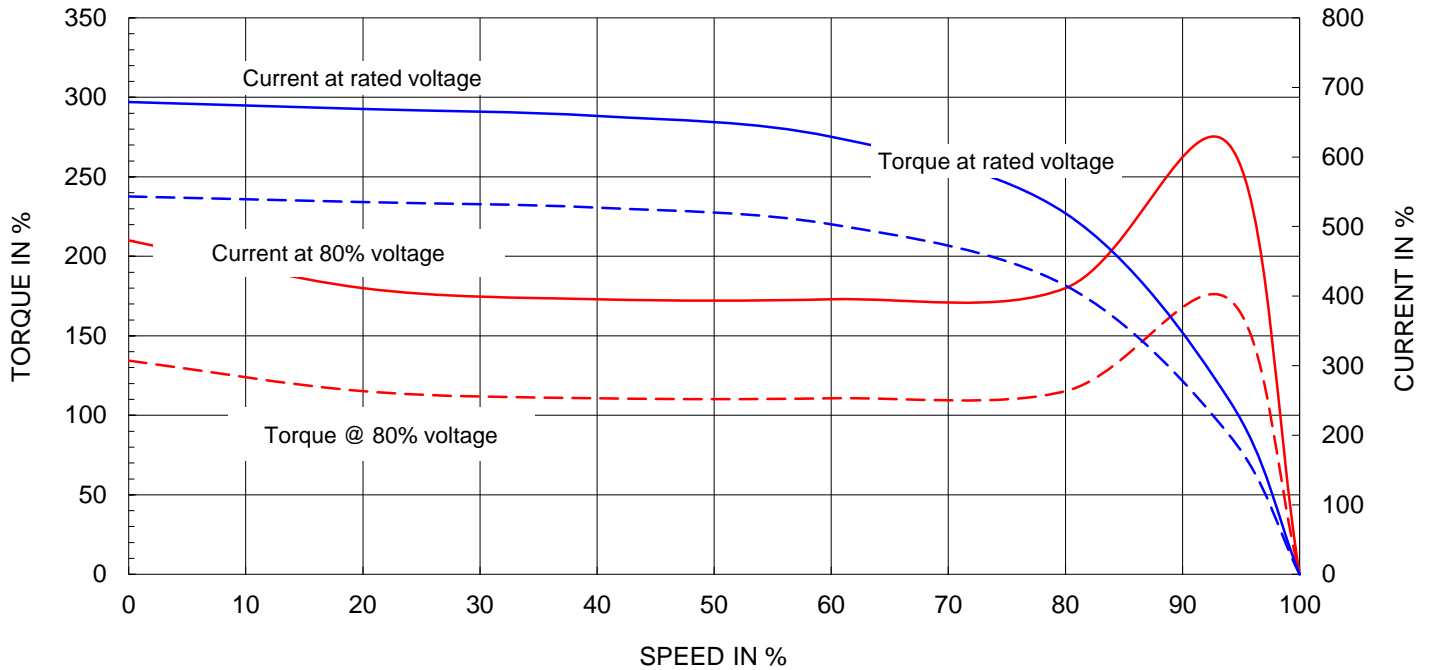

OUTPUT VS EFF., P.F & CURRENT CURVE

