



WORLDWIDE ELECTRIC MOTOR DATA SHEET

EP5-18-184TC



HORSEPOWER	5		
RPM / POLES	1800 / 4	(1500 / 4)	
VOLTAGE / PHASE	230 / 460 V / 3	(190 / 380 V / 3)	
FRAME	184TC		
ENCLOSURE / DEGREE OF PROTECTION	TEFC / IP55		
FREQUENCY	60 HZ	(50 HZ)	
FULL LOAD SPEED	1750 RPM	(1453 RPM)	
SERVICE FACTOR	1.25 SF	(1.0 SF)	
INSULATION CLASS	F		
FULL LOAD AMPS	13.41 / 6.71 A	(16.2 / 8.1 A)	
LOCKED ROTOR AMPS (STARTING)	92.0 / 46.0 A	(111.4 / 55.7 A)	
NO LOAD CURRENT	6.8 / 3.4 A	(8.2 / 4.1 A)	
NEMA CODE LETTER	J		
EFFICIENCY / POWER FACTOR	<u>LOAD</u>	<u>EFF.</u>	<u>P.F.</u>
	100%	90.3%	0.79
	75%	89.5%	0.78
	50%	87.6%	0.75
DUTY CYCLE	S1 / Continuous		
TORQUE	<u>FULL LOAD</u>	<u>LRT</u>	<u>BDT</u>
	15.0 lb.ft.	220%	280%
SLIP	2.80%		
NEMA DESIGN	B		
MOMENT OF INERTIA	0.33 lb.ft. ²		
NUMBER OF STARTS (Hot / Cold)	2 Hot / 3 Cold		
MAX. AMBIENT TEMPERATURE	40° C at 1.25 SF / 55° C at 1.0 SF		
MAX. ELEVATION	3300 Ft. Above Sea Level		
TEMPERATURE RISE (At Full Load)	80° C		
DE BEARING	6306ZZ		
ODE BEARING	6306ZZ		
GREASE TYPE	Mobil Polyrex EM		
MOUNTING	F1 (F2 Suitable)		
ROTATION	Bi-Directional		
APPROXIMATE WEIGHT	115 lbs.		
AREA CLASSIFICATION	Class I, Division 2, Groups A, B, C, D		
INVERTER RATING	10:1 CT / 20:1 VT PWM Type		
SPECIFICATION - In Accordance With	NEMA, CSA		



CC067A





WORLDWIDE ELECTRIC MOTOR DRAWING

EP-184TC

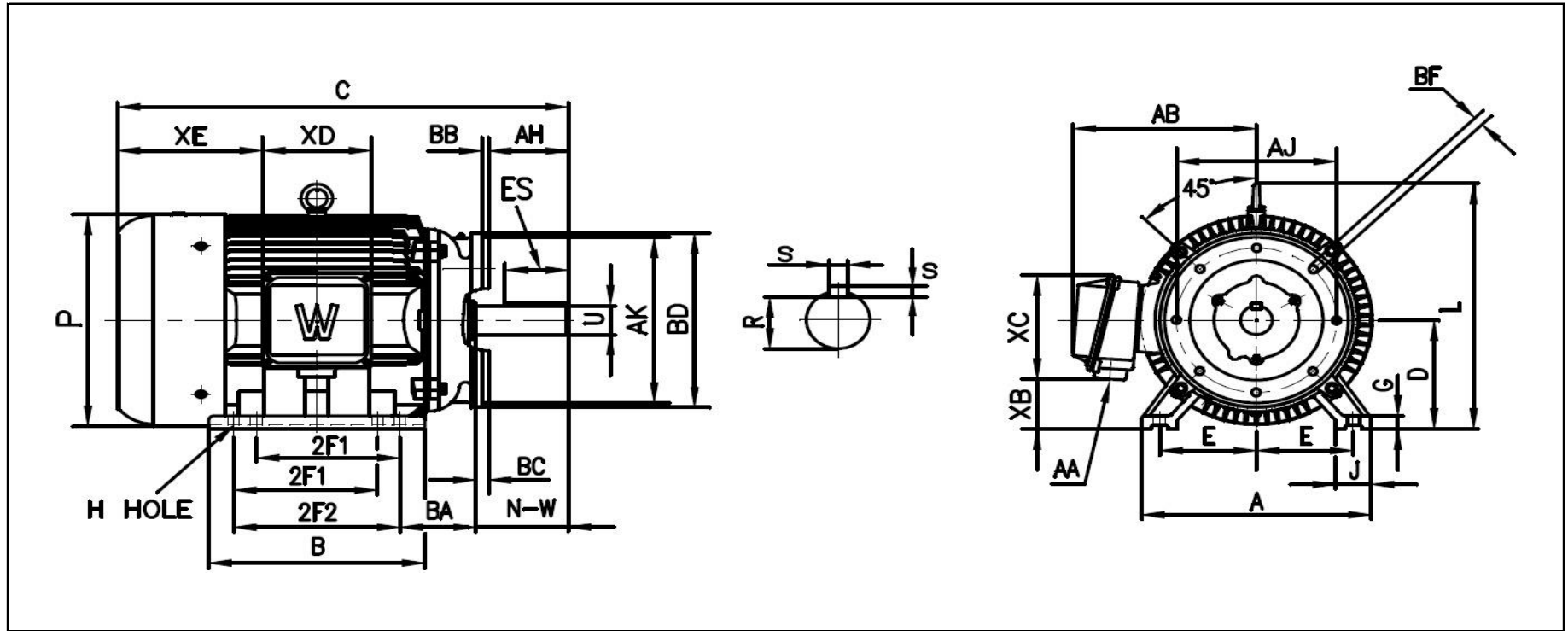

DIMENSIONS - INCHES

MOUNTING					A	B	C	D	G	J	P	L	AB	AH	BC
E	2F1	2F2	H	BA											
3.75	4.5	5.5	0.41	2.75	8.9	7.1	16.2	4.5	0.52	1.97	8.54	10.39	7.32	2.62	0.12

KEY		KEYSET	FLANGE				SHAFT		TERMINAL BOX					
S	ES	R	AK	AJ	BF	BB	BD	N-W	U	AA	XB	XC	XD	XE
0.25	1.78	0.986	8.5	7.25	1/2-13	0.25	8.66	2.75	1.125	1	2.05	5	4.57	5.39



Motor Performance Curves

Motor type:	EPIC				
Output rating (HP)	5	FL Speed:	1750		
Full Load Torque :	15	lb.ft	LRT (% FLT):	220	460 volt FLA: 6.7
Rotor Wk ² :	0.33	lb-ft ²	BDT (% FLT):	280	230 volt FLA: 13.4

SPEED VS TORQUE & CURRENT CURVE

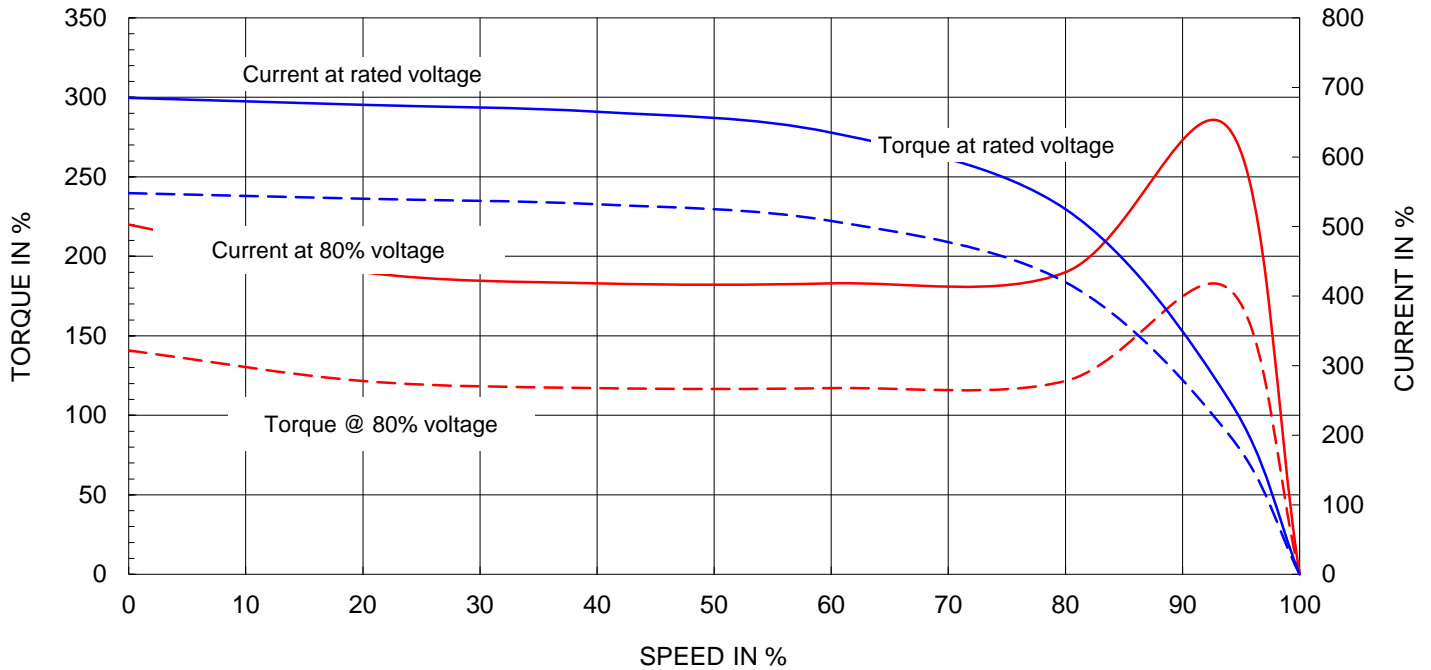

OUTPUT VS EFF., P.F & CURRENT CURVE

