



WORLDWIDE ELECTRIC MOTOR DATA SHEET

EP2-18-145TC



| | | | |
|---|---|--------------|-------------|
| HORSEPOWER | 2 | | |
| RPM / POLES | 1800 / 4 | | |
| VOLTAGE / PHASE | 230 / 460 V / 3 | | |
| FRAME | 145TC | | |
| ENCLOSURE / DEGREE OF PROTECTION | TEFC / IP55 | | |
| FREQUENCY | 60 HZ Suitable For 50 HZ Operation With 1.0 SF | | |
| FULL LOAD SPEED | 1750 RPM | | |
| SERVICE FACTOR | 1.25 SF at 40° C / 1.0 SF at 55° C | | |
| INSULATION CLASS | F | | |
| FULL LOAD AMPS; 230 / 460 | 6.0 / 3.0 A | | |
| LOCKED ROTOR AMPS (STARTING); 230 / 460 | 50.0 / 25.0 A | | |
| NO LOAD CURRENT | 3.6 / 1.81 A | | |
| NEMA CODE LETTER | L | | |
| EFFICIENCY / POWER FACTOR | <u>LOAD</u> | <u>EFF.</u> | <u>P.F.</u> |
| | 100% | 87.3% | 0.73 |
| | 75% | 86.5% | 0.70 |
| | 50% | 84.6% | 0.61 |
| DUTY CYCLE | S1 / Continuous | | |
| TORQUE | <u>FULL LOAD</u> | <u>LRT</u> | <u>BDT</u> |
| | 6.0 lb.ft. | 290% | 320% |
| | | | |
| SLIP | 2.80% | | |
| NEMA DESIGN | B | | |
| MOMENT OF INERTIA | 0.13 lb.ft.² | | |
| NUMBER OF STARTS (Hot / Cold) | 2 Hot / 3 Cold | | |
| MAX. AMBIENT TEMPERATURE | 40° C at 1.25 SF / 55° C at 1.0 SF | | |
| MAX. ELEVATION | 3300 Ft. Above Sea Level | | |
| TEMPERATURE RISE (At Full Load) | 80° C | | |
| DE BEARING | 6205ZZ | | |
| ODE BEARING | 6205ZZ | | |
| GREASE TYPE | Mobil Polyrex EM | | |
| MOUNTING | F1 (F2 Suitable) | | |
| ROTATION | Bi-Directional | | |
| APPROXIMATE WEIGHT | 58 lbs. | | |
| AREA CLASSIFICATION | Class I, Division 2, Groups A, B, C, D | | |
| INVERTER RATING | 10:1 CT / 20:1 VT PWM Type | | |
| SPECIFICATION - In Accordance With | NEMA, CSA | | |



CC067A



MARCH 10, 2015



WORLDWIDE ELECTRIC MOTOR DRAWING

EP-145TC

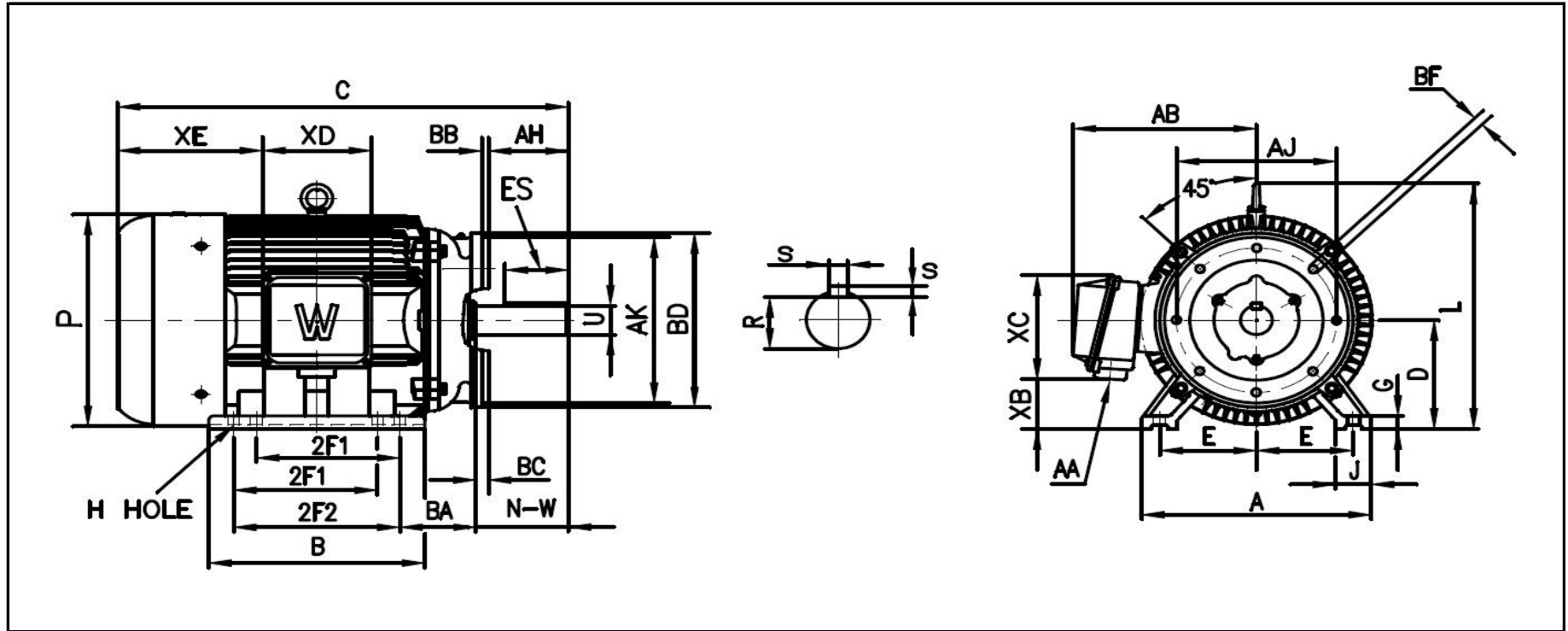

DIMENSIONS - INCHES

| MOUNTING | | | | | A | B | C | D | G | J | P | L | AB | AH | BC |
|----------|-----|-----|------|------|---|-----|------|-----|------|-----|-----|-----|-----|------|------|
| E | 2F1 | 2F2 | H | BA | | | | | | | | | | | |
| 2.75 | 4 | 5 | 0.34 | 2.25 | 7 | 7.5 | 15.2 | 3.5 | 0.55 | 1.5 | 7.1 | 7.1 | 6.3 | 2.12 | 0.12 |

| KEY | | KEYSET | FLANGE | | | | SHAFT | | TERMINAL BOX | | | | | |
|-------|------|--------|--------|-------|--------|------|-------|------|--------------|-----|-----|-----|-----|-----|
| S | ES | R | AK | AJ | BF | BB | BD | N-W | U | AA | XB | XC | XD | XE |
| 0.188 | 1.41 | 0.771 | 4.5 | 5.875 | 3/8-16 | 0.16 | 6.5 | 2.25 | 0.875 | 3/4 | 1.8 | 4.5 | 4.1 | 4.7 |



Motor Performance Curves

| | | | | | |
|--------------------|------|-----------|--------------|-----|-------------------|
| Motor type: | EPIC | | | | |
| Output rating (HP) | 2 | FL Speed: | 1750 | | |
| Full Load Torque : | 6 | lb.ft | LRT (% FLT): | 290 | 460 volt FLA: 3.0 |
| Rotor Wk^2: | 0.13 | lb-ft^2 | BDT (% FLT): | 320 | 230 volt FLA: 6.0 |

SPEED VS TORQUE & CURRENT CURVE

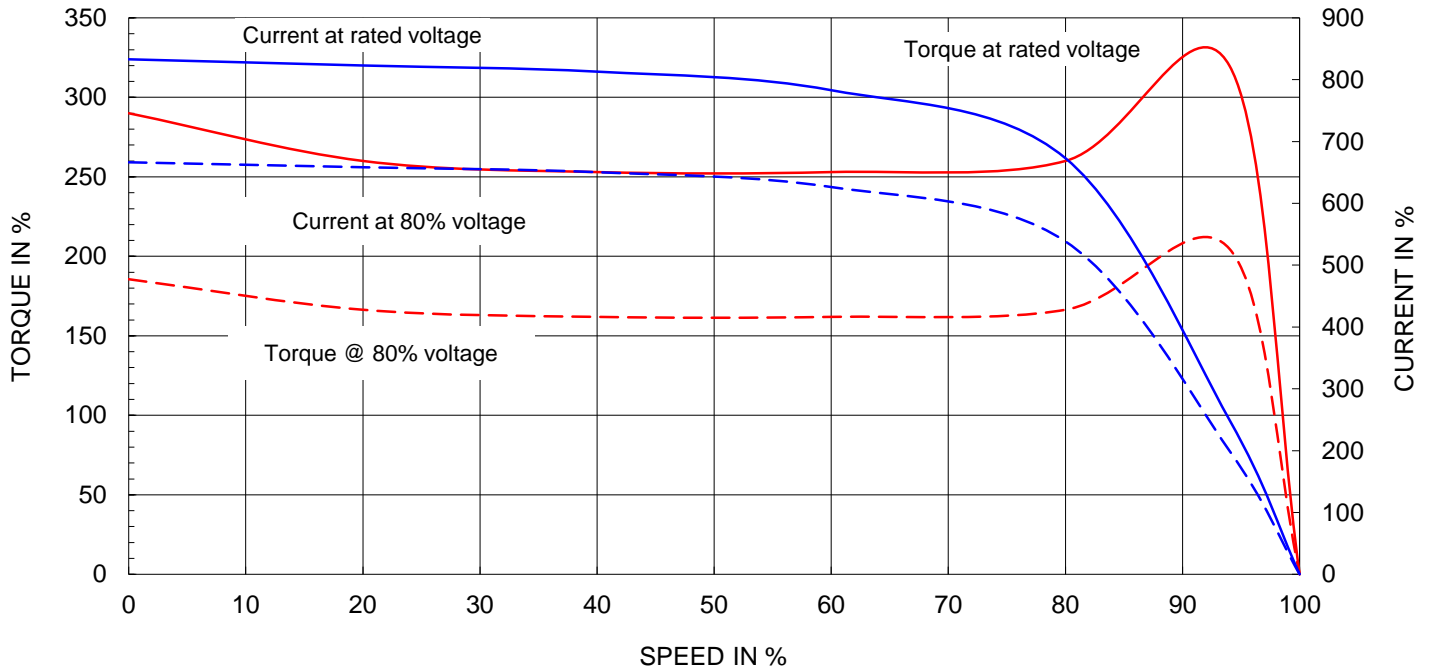

OUTPUT VS EFF., P.F & CURRENT CURVE

