



# WORLDWIDE ELECTRIC MOTOR DATA SHEET



## IOW10-12-256T

HORSEPOWER	10		
RPM / POLES	1200 / 6		
VOLTAGE / PHASE	230 / 460 / 796 V / 3		
FRAME	256T		
ENCLOSURE / DEGREE OF PROTECTION	TEFC / IP54		
FREQUENCY	60 HZ Suitable For 50 HZ Operation With 1.0 SF		
FULL LOAD SPEED	1135 RPM		
SERVICE FACTOR	1.15		
INSULATION CLASS	F		
FULL LOAD AMPS; 230 / 460 / 796	27.2 / 13.6 / 7.85 A		
LOCKED ROTOR AMPS (STARTING); 230 / 460 / 796	162 / 81.0 / 46.8 A		
NO LOAD CURRENT	13.0 / 6.5 / 3.75 A		
NEMA CODE LETTER	H		
EFFICIENCY / POWER FACTOR	<u>LOAD</u>	<u>EFF.</u>	<u>P.F.</u>
	100%	87.0%	0.79
	75%	88.0%	0.74
	50%	87.6%	0.62
DUTY CYCLE	CONTINUOUS		
TORQUE	<u>FULL LOAD</u>	<u>LRT</u>	<u>BDT</u>
	46.3 lb.ft.	310%	270%
	5.40%		
SLIP	5.40%		
NEMA DESIGN	D		
MOMENT OF INERTIA	2.38 lb.ft. <sup>2</sup>		
MAX. TIME LOCKED ROTOR (Hot)	6 Seconds		
MAX. AMBIENT TEMPERATURE	40° C		
MAX. ELEVATION	3300 Ft. Above Sea Level		
TEMPERATURE RISE (At Full Load)	80° C		
DE BEARING	6309		
ODE BEARING	6309		
REGREASING INT. - DE BEARING	13,400 Hours		
REGREASING INT. - ODE BEARING	13,400 Hours		
GREASE TYPE	Mobil Polyrex EM		
MOUNTING	F2		
ROTATION	Bi-Directional		
SHAFT MATERIAL	1045 Carbon Steel		
CONNECTION DIAGRAM	230 / 460 / 796 V - 12 Lead Δ		
APPROXIMATE WEIGHT	340 lbs.		
INVERTER RATING	10:1 CT / 20:1 VT PWM Type		





# WORLDWIDE ELECTRIC MOTOR DRAWING

## IOW-256T

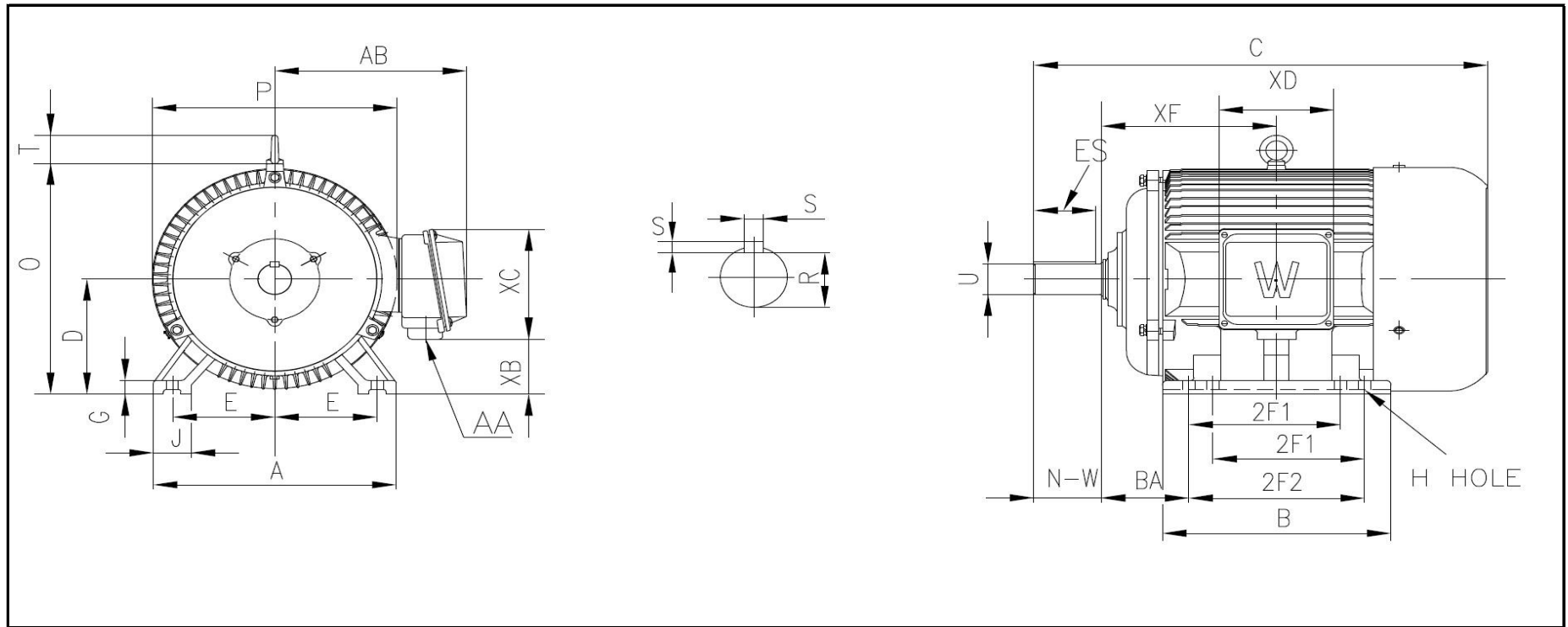

### DIMENSIONS - INCHES

MOUNTING					A	B	C	D	G	J	P	O	T	AB
E	2F1	2F2	H	BA										
5	8.25	10	0.53	4.25	12.5	12.5	25.06	6.25	0.787	2.5	12.6	12.9	2.05	11.2

KEY		KEYSET	SHAFT		TERMINAL BOX				
S	ES	R	N-W	U	AA	XB	XC	XD	XF
0.375	2.91	1.416	4	1.625	1 1/2	3	7.2	6.3	9.25

REVISED - 02/01/16