



# WORLDWIDE ELECTRIC MOTOR DATA SHEET



## ATJ1.5-36-56JB

HP	1.5
RPM / POLES	3600 / 2
VOLTAGE / PHASE	208-230/460 V / 3
FRAME	56J
ENCLOSURE	TEFC
FREQUENCY	60 HZ
RATED SPEED	3450 RPM
FULL LOAD AMPS	5.1-4.6/2.3 A
DUTY CYCLE	CONTINUOUS
SERVICE FACTOR	1.15
INSULATION CLASS	F
BASE TYPE	C-FACE - REMOVABLE
SHAFT	THREADED
DE BEARING	6203
ODE BEARING	6203
MOUNTING	F1
ROTATION	CW
OVERLOAD	---
START CAPACITOR	---
RUN CAPACITOR	---
WIRE TYPE	LOOSE WIRE
WIRE HOUSING	JUNCTION BOX
CONNECTION DIAGRAM	208-230/460 V - 9 LEAD
APPROX. WEIGHT	30 LBS.
FL EFFICIENCY	72.0%



REVISED - 01/01/11



WORLDWIDE ELECTRIC MOTOR DRAWING  
**ATJ1.5-36-56JB**

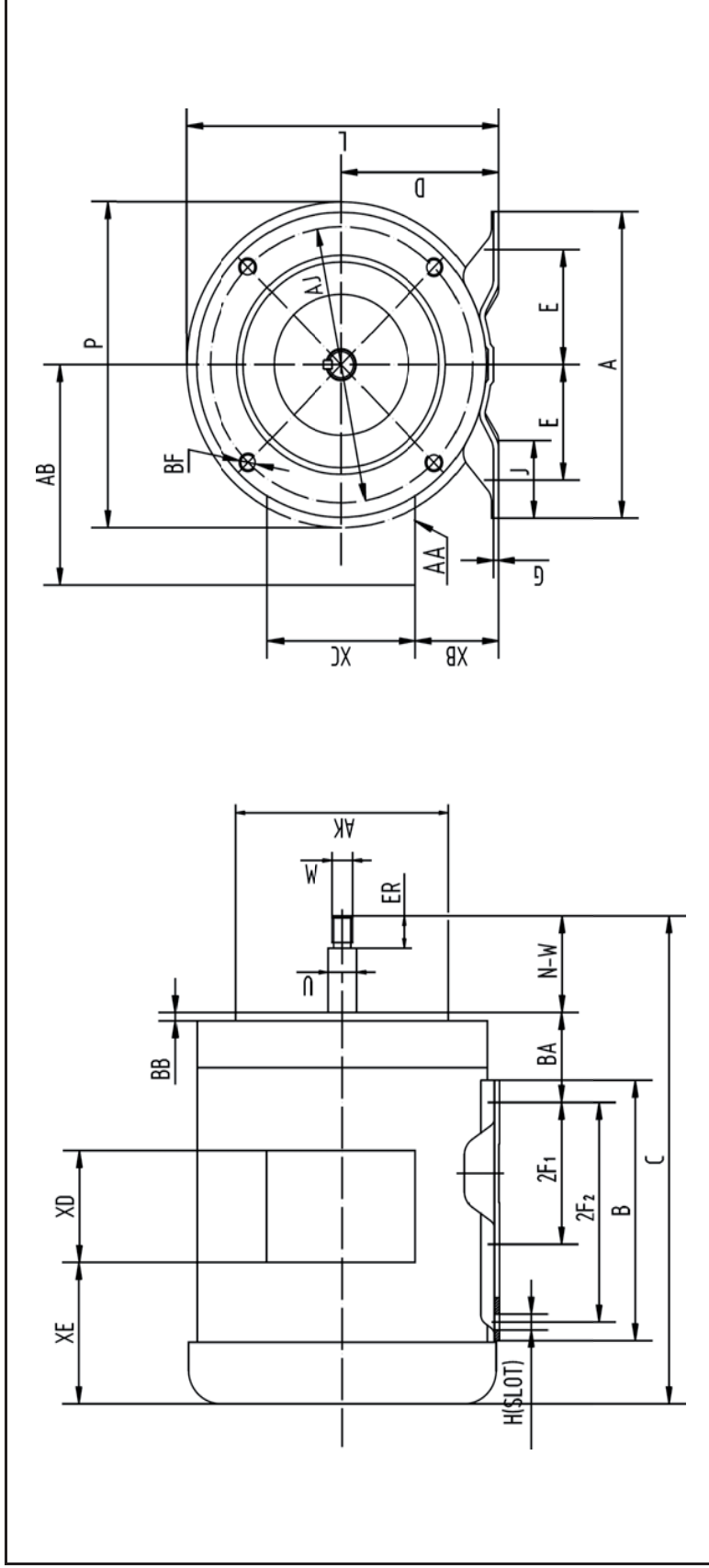

MOUNTING			
E	2F1	2F2	H
2.44	3	5	0.34
			BA
			2.75

A	B	C	D	G	J	L	P	AA
6.5	6.5	12.7	3.5	0.12	1.73	7	6.9	1/2

FLANGE				SHAFT				TERMINAL BOX				
AB	AJ	AK	BB	BF	ER	M	N-W	U	XB	XC	XD	XE
5.35	5.875	4.5	0.16	3/8-16	0.68	7/16-20	2.4	0.625	1.65	3.7	3.23	2.85

ALL DIMENSIONS IN INCHES