

PES145TC2M-4

WASHDOWN DUTY MOTOR
NEMA PREMIUM EFFICIENCY
STAINLESS STEEL CONSTRUCTION - C-FLANGE WITH FEET
TOTALLY ENCLOSED FAN COOLED - IP66 CONSTRUCTION
INVERTER DUTY 10:1 CT; 20:1 VT - NEMA MG1 PART 31

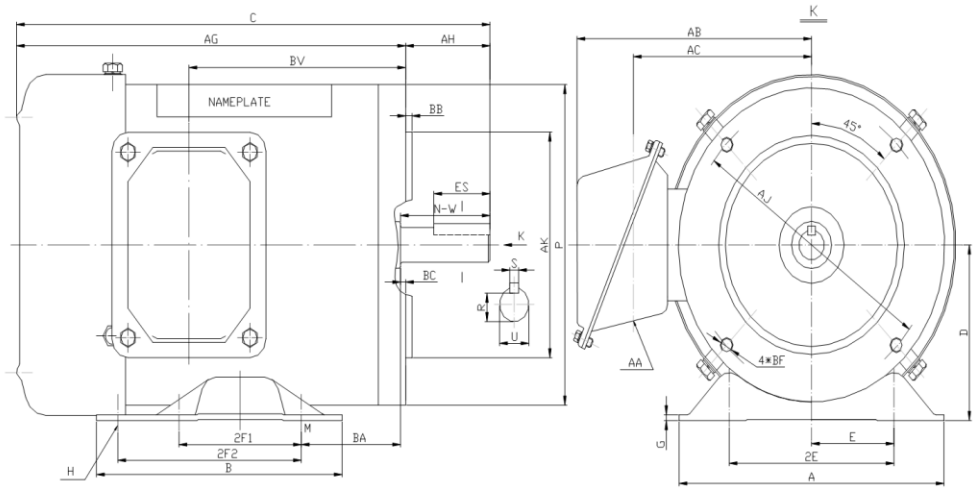

DIMENSIONS

HP	RPM	Frame	Mounting													
			A	B	C	D	G	H	E	2E	2F1	2F2	P	AK	AJ	AH
2	1800	145TC	6.50	6.50	13.81	3.50	0.12	1.22*0.34	2.75	5.50	3.00	5.00	6.50	4.500	5.875	2.12

Mounting			Shaft Extension, Key Set					Conduit Box				Bearings		Mount		
AG	BA	BB	BC	BF	U	R	S	ES	N-W	AA	AB	AC	BV		DE	ODE
11.69	2.75	0.16	0.12	4*3/8-16	0.875	0.771	0.188	1.41	2.25	0.86	5.75	4.25	7.50	6205-2RS	6205-2RS	F1

BEARING LUBRICATION: The bearings come lubricated with Mobil Polyrex EM Polyurea Grease.





PESS145TC2M-4







WASHDOWN DUTY MOTOR
NEMA PREMIUM EFFICIENCY
STAINLESS STEEL CONSTRUCTION - C-FLANGE WITH FEET
TOTALLY ENCLOSED FAN COOLED - IP66 CONSTRUCTION
INVERTER DUTY 10:1 CT; 20:1 VT - NEMA MG1 PART 31

PERFORMANCE DATA

HP	RPM	Frame	Voltage	Frequency (Hz)	Full Load S.F.	Insulation Class	NEMA Design	Slip (%)	NEMA Code	Enclosure Type	IP Rating	Max. Ambient
2	1750	145TC	208-230/460	60	1.15	F	B	2.8	K	TEFC	66	40° C

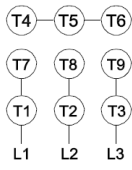
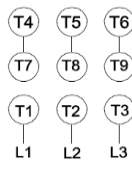
Amps (460V)		Efficiency (%)				Power Factor			Torque (ft-lb)			DE Bearing	ODE Bearing	Connection	Weight (lbs.)
FLA	LRA	100%	75%	50%	Min.	100%	75%	50%	FLT	LRT %	BDT %				
3.0	25.0	86.5	83.0	80.0	84.0	0.75	0.66	0.52	5.9	285	300	6205-2RS	6205-2RS	9 Lead 2Y/Y	52

NAME PLATE

 North American Electric, Inc.															CONNECTION DIAGRAMS 208-230V 		
INVERTER DUTY 20:1 VT; 10:1 CT										WASHDOWN DUTY STAINLESS STEEL MOTORS							
CAT NO: PESS145TC2M-4				FRAME: 145TC				PHASE: 3				460V 					
HZ: 60	S.F.: 1.15	HZ: 50	S.F.: 1.2	ENCL: TEFC	IP: 66	HP: 2	RPM: 1750	HP: 1.5	RPM: 1450	DUTY: CONT	DES: B						
VOLTS: 208-230/460				VOLTS: 190/380				AMB: 40° C				INS: F					
FLA: 6.2 - 6 / 3				FLA: 5.2/2.6				DE BEARING: 6205-2RS				ODE BEARING: 6205-2RS					
CODE: K	P.F.: 0.75	CODE: K	P.F.: 0.78	ODE BEARING: 6205-2RS				LUB: Mobil Polyrex EM									
EFF: 86.5				MIN: 84.0	EFF: 84	MIN: 81.5	MOTOR WEIGHT: 52 LBS				CONNECTION: 9 Lead 2Y/Y						
SPECIAL PURPOSE MOTOR DESIGNED FOR WASHDOWN APPLICATIONS AND EXTREMELY CORROSIVE ENVIRONMENTS.				  				SER NO: CC 082A									
Hernando, Mississippi																	

APPLICATIONS:

Applications include washdown applications, food processing, chemical processing, pharmaceuticals, poultry processing, meat processing, dairy applications, bakeries, snack foods, bottling and extremely corrosive environments.