

VHS1-200S4-W44516A

VERTICAL HOLLOW SHAFT MOTOR

NEMA PREMIUM EFFICIENCY

HIGH THRUST DESIGN

THREE PHASE, OPEN DRIP PROOF (WP1) ENCLOSURE

NON-REVERSE BALL BEARING RATCHET

COUPLING INCLUDED

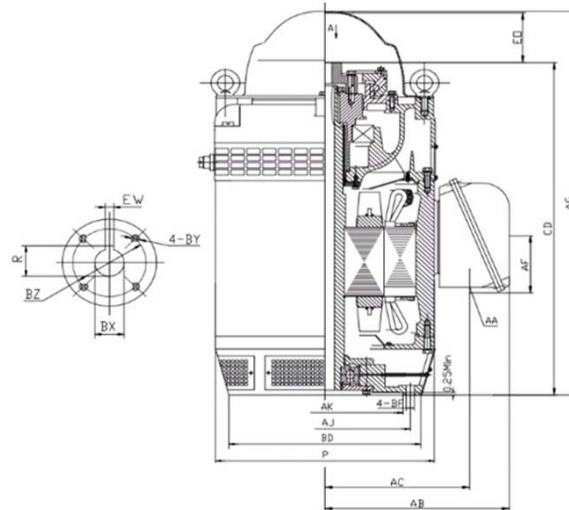

DIMENSIONS

HP	RPM	Frame	MOUNTING DIMENSIONS													
			BD	AJ	AK	BF	BX	BZ	EW	R	BY	CD	E0 >	AC	AA	AF
200	1780	445TP	16.50	14.750	13.50	0.69	1.69	2.50	0.38	1.854	1/4-20	42.66	5.40	16.18	3" NPT	7.56

OVERALL DIMENSIONS			BEARINGS	
P	AB	AG	UPPER	BOTTOM
23.30	20.70	48.03	7232B	6318

COUPLING: Motor comes with a 1.69 coupling. You may select a different size coupling at no extra charge.

BEARING LUBRICATION: The bottom bearing comes lubricated with Mobile Polyrex EM Polyurea Grease.

OIL RESERVOIR: Motor is shipped without oil. The oil capacity is 6 quarts.

STEADY BUSHING: Motor is designed to accept a steady bushing. The bore size is 2.362 inches.







VHS1-200S4-W44516A
VERTICAL HOLLOW SHAFT MOTOR
NEMA PREMIUM EFFICIENCY
HIGH THRUST DESIGN
THREE PHASE, OPEN DRIP PROOF (WP1) ENCLOSURE
NON-REVERSE BALL BEARING RATCHET
PERFORMANCE DATA

HP	RPM	Frame	Voltage	Frequency (Hz)	Full Load S.F.	Insulation Class	NEMA Design	Slip (%)	NEMA Code	Enclosure Type	IP Rating	Max. Ambient	Rating CONT
200	1788	445TP	460	60	1.15	F	B	0.7	F	WP1	23	40° C	S1

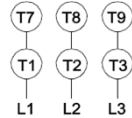
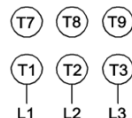
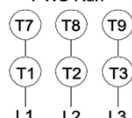
Amps (460V)		Efficiency (%)				Power Factor			Torque (ft-lb)			Down Thrust	Angular Contact Bearing	Radial Ball Bearing	Connection	Weight (lbs.)
FLA	LRA	100%	75%	50%	Min.	100%	75%	50%	FLT	LRT %	BDT %	7200	UPPER	BOTTOM	6 Lead Δ	2115
221.0	1462.0	95.8	94.8	93.7	95.0	0.88	0.88	0.83	584.0	166	220		7200	7232B		

NAME PLATE

 North American Electric, Inc.				VERTICAL HOLLOW SHAFT ELECTRIC MOTOR				CONNECTION DIAGRAMS Across The Line  PWS Start  PWS Run 			
INVERTER DUTY 10:1 VT; 5:1 CT				HIGH THRUST DESIGN							
MODEL	VHS1-200S4-W44516A			PHASE	3	Hz	60				
HP	200	FRAME	445TP	VOLTS	460						
DESIGN	B	CODE	F	AMPS	221						
NOM EFF.	95.8	P.F.	0.88	INSULATION CLASS	F						
RATING CONT	S1	S.F.	1.15	MAX AMB.	40° C	WEIGHT	2115 LBS.				
DOWN THRUST	7200			ENCLOSURE TYPE	WP1						
UPPER BEARING	7232B			BOTTOM BEARING	6318						
OIL CAP.	UPPER BEARING	6	QTS	LUBRICATION	MOBILE POLYREX EM						
NON-REVERSE RATCHET - BALL TYPE				SERIAL NO.							
Specifically designed for use on deep well turbine pump applications. Hernando, Mississippi				   							

APPLICATIONS:

Specifically designed for use on deep well turbine pump applications. The coupling is equipped with a non-reverse ratchet, which prevents motor rotation from backspin at shutdown. These motors are built to NEMA standards and have special bearing arrangements to carry heavy thrust loads.