

VHS1-150S4-W44416A

VERTICAL HOLLOW SHAFT MOTOR

NEMA PREMIUM EFFICIENCY

HIGH THRUST DESIGN

THREE PHASE, OPEN DRIP PROOF (WP1) ENCLOSURE

NON-REVERSE BALL BEARING RATCHET

COUPLING INCLUDED

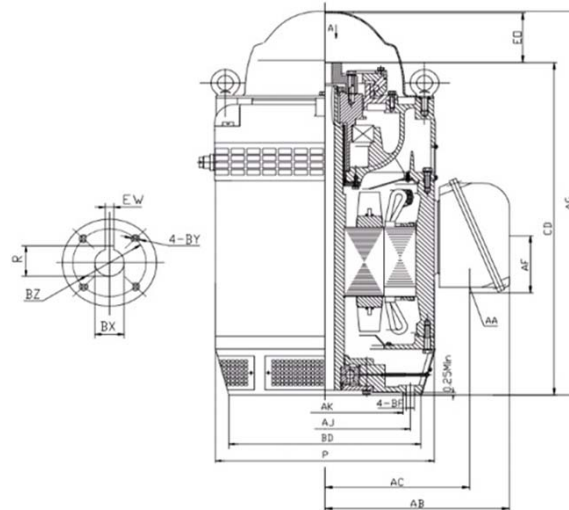

DIMENSIONS

HP	RPM	Frame	MOUNTING DIMENSIONS													
			BD	AJ	AK	BF	BX	BZ	EW	R	BY	CD	E0 >	AC	AA	AF
150	1780	444TP	16.50	14.750	13.50	0.69	1.69	2.50	0.38	1.854	1/4-20	42.66	5.40	16.18	3" NPT	7.56

OVERALL DIMENSIONS			BEARINGS	
P	AB	AG	UPPER	BOTTOM
23.30	20.70	48.03	7232B	6318

COUPLING: Motor comes with a 1.69 coupling. You may select a different size coupling at no extra charge.

BEARING LUBRICATION: The bottom bearing comes lubricated with Mobile Polyrex EM Polyurea Grease.

OIL RESERVOIR: Motor is shipped without oil. The oil capacity is 6 quarts.

STEADY BUSHING: Motor is designed to accept a steady bushing. The bore size is 2.362 inches.



VHS1-150S4-W44416A

VERTICAL HOLLOW SHAFT MOTOR

NEMA PREMIUM EFFICIENCY

HIGH THRUST DESIGN

THREE PHASE, OPEN DRIP PROOF (WP1) ENCLOSURE





NON-REVERSE BALL BEARING RATCHET

PERFORMANCE DATA

HP	RPM	Frame	Voltage	Frequency (Hz)	Full Load S.F.	Insulation Class	NEMA Design	Slip (%)	NEMA Code	Enclosure Type	IP Rating	Max. Ambient	Rating CONT
150	1788	444TP	460	60	1.15	F	B	0.7	G	WP1	23	40° C	S1

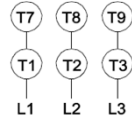
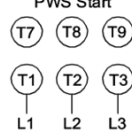
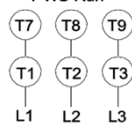
Amps (460V)		Efficiency (%)				Power Factor			Torque (ft-lb)			Down Thrust	Angular Contact Bearing	Radial Ball Bearing	Connection	Weight (lbs.)
FLA	LRA	100%	75%	50%	Min.	100%	75%	50%	FLT	LRT %	BDT %	7200	UPPER	BOTTOM	6 Lead Δ	2004
165.0	1188.0	95.8	93.8	91.8	95.0	0.88	0.88	0.82	438.0	196	220		7200	7232B		

NAME PLATE

 North American Electric, Inc.						VERTICAL HOLLOW SHAFT ELECTRIC MOTOR						CONNECTION DIAGRAMS Across The Line 				
INVERTER DUTY 10:1 VT; 5:1 CT						HIGH THRUST DESIGN										
MODEL		VHS1-150S4-W44416A				PHASE		3		Hz		60		PWS Start 		
HP		150		FRAME		444TP		VOLTS		460						
DESIGN		B		CODE		G		AMPS		165		PWS Run 				
NOM EFF.		95.8		P.F.		0.88		INSULATION CLASS		F						
RATING CONT		S1		S.F.		1.15		MAX AMB.		40° C		WEIGHT		2004 LBS.		
DOWN THRUST				7200				ENCLOSURE TYPE				WP1				
UPPER BEARING				7232B				BOTTOM BEARING				6318				
OIL CAP. UPPER BEARING				6 QTS				LUBRICATION				MOBILE POLYREX EM				
NON-REVERSE RATCHET - BALL TYPE						SERIAL NO.						Specifically designed for use on deep well turbine pump applications. Hernando, Mississippi				
   																

APPLICATIONS:

Specifically designed for use on deep well turbine pump applications. The coupling is equipped with a non-reverse ratchet, which prevents motor rotation from backspin at shutdown. These motors are built to NEMA standards and have special bearing arrangements to carry heavy thrust loads.