

NAE-VHS-40-4

**VERTICAL HOLLOW SHAFT MOTOR
HIGH THRUST DESIGN
THREE PHASE, OPEN DRIP PROOF (WP1) ENCLOSURE
NON-REVERSE BALL BEARING RATCHET
COUPLING INCLUDED**

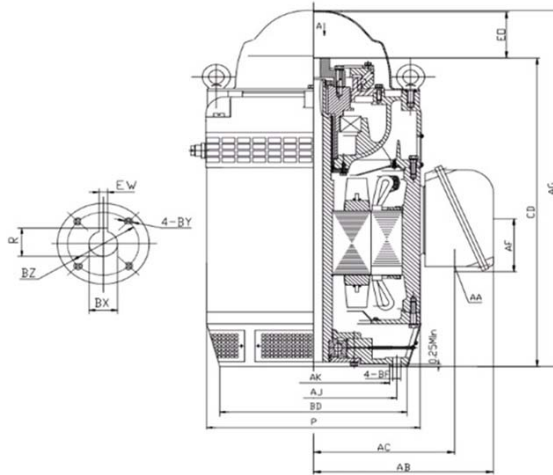

DIMENSIONS																
HP	RPM	Frame	MOUNTING DIMENSIONS													
			BD	AJ	AK	BF	BX	BZ	EW	R	BY	CD	E0 >	AC	AA	AF
40	1770	324TP	16.50	14.750	13.50	0.69	1.25	1.75	0.25	1.367	1/4-20	28.22	4.46	11.65	3.00	5.83

OVERALL DIMENSIONS			BEARINGS	
P	AB	AG	UPPER	BOTTOM
17.30	15.16	32.70	7221B	6213

COUPLING: Motor comes with a 1.25" coupling. You may select a different size coupling at no extra charge.

BEARING LUBRICATION: The bottom bearing comes lubricated with Mobile Polyrex EM Polyurea Grease.

OIL RESERVOIR: Motor is shipped without oil. The oil capacity is 2.82 quarts.

STEADY BUSHING: Motor is designed to accept a steady bushing. The bore size is 1.654 inches.





NAE-VHS-40-4

**VERTICAL HOLLOW SHAFT MOTOR
HIGH THRUST DESIGN
THREE PHASE, OPEN DRIP PROOF (WP1) ENCLOSURE
NON-REVERSE BALL BEARING RATCHET**

PERFORMANCE DATA

HP	RPM	Frame	Voltage	Frequency (Hz)	Full Load S.F.	Insulation Class	NEMA Design	Slip (%)	NEMA Code	Enclosure Type	IP Rating	Max. Ambient	Rating CONT
40	1770	324TP	230/460	60	1.15	F	B	1.7	C	WP1	23	40° C	S1

Amps (460V)		Efficiency (%)				Power Factor			Torque (ft-lb)			Down Thrust	Angular Contact Bearing	Radial Ball Bearing	Connection	Weight (lbs.)
FLA	LRA	100%	75%	50%	Min.	100%	75%	50%	FLT	LRT %	BDT %	5500	UPPER	BOTTOM	12 Lead 2Δ/Δ	650
49.5	299.6	91.2	90.4	89.3	89.1	0.87	0.84	0.78	162.1	240	214		7221B	6213		

NAME PLATE

VERTICAL HOLLOW SHAFT ELECTRIC MOTOR INVERTER DUTY 10:1 VT; 5:1 CT HIGH THRUST DESIGN				CONNECTION DIAGRAMS 208 - 230V 		
MODEL	NAE-VHS-40-4		PHASE	3	Hz	60
HP	40	FRAME	324TP	VOLTS 230/460		
DESIGN	B	CODE	C	AMPS 99 / 49.5		
NOM EFF.	91.2	P.F.	0.87	INSULATION CLASS F		
RATING CONT	S1	S.F.	1.15	MAX AMB.	40° C	WEIGHT 650 LBS.
DOWN THRUST	5500			ENCLOSURE TYPE	WP1	
UPPER BEARING	7221B			BOTTOM BEARING	6213	
OIL CAP. UPPER BEARING	2.82 QTS		LUBRICATION	MOBILE POLYREX EM		
NON-REVERSE RATCHET - BALL TYPE				SERIAL NO.		
Specifically designed for use on deep well turbine pump applications. Hernando, Mississippi						PART WIND START CAPABLE @ 230V

APPLICATIONS:

Specifically designed for use on deep well turbine pump applications. The coupling is equipped with a non-reverse ratchet, which prevents motor rotation from backspin at shutdown. These motors are built to NEMA standards and have special bearing arrangements to carry heavy thrust loads.