

PEXP286T-30-4

**EXPLOSION PROOF ELECTRIC MOTOR
 NEMA PREMIUM EFFICIENCY
 TOTALLY ENCLOSED FAN COOLED; EXPLOSION PROOF ENCLOSURE
 CLASS I DIVISION I GROUP C & D; CLASS II DIVISION I GROUP F & G
 OPERATING TEMP CODE T3C**

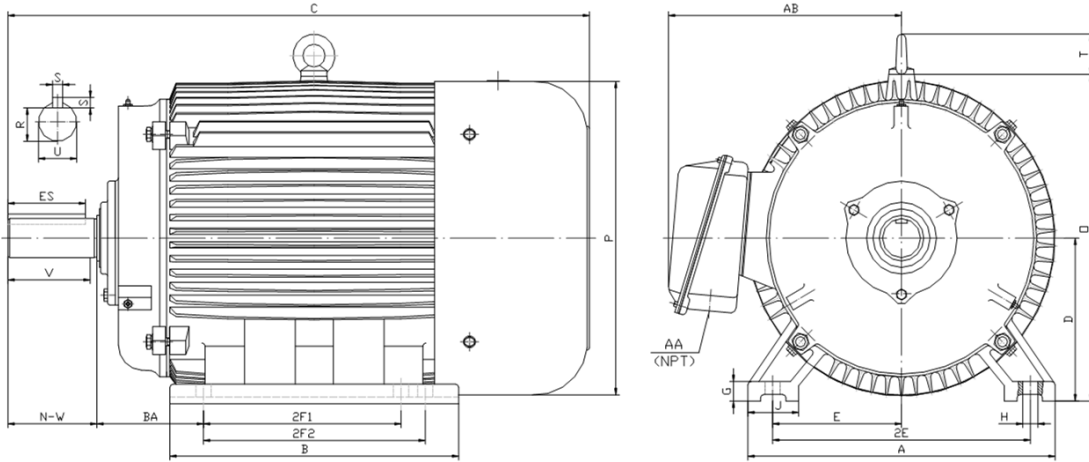

DIMENSIONS

HP	RPM	Frame	MOUNTING														
			A	B	C	D	G	H	J	E	2E	2F1	2F2	O	P	T	BA
30	1800	286T	14.00	13.20	28.10	7.00	0.85	0.53	2.75	5.50	11.00	9.50	11.00	14.50	14.00	2.20	4.75

Shaft Extension, Key Set						Conduit Box		Bearings		Mount
U	V	R	S	ES	N-W	AA	AB	DE	ODE	
1.88	4.38	1.59	0.50	3.28	4.62	1.50	11.30	6310	6310	F1

BEARING LUBRICATION: The bearings come lubricated with Mobil Polyrex EM Polyurea Grease. It is recommended that you add some additional lubrication when the motor is installed.

Three options (brands) for suitable lubrication include, but are not limited to, the following:

- 1.) Mobil Polyrex EM
- 2.) Citco Polyurea MP
- 3.) Conoco Phillips Polytac EP









PEXP286T-30-4
EXPLOSION PROOF ELECTRIC MOTOR
NEMA PREMIUM EFFICIENCY
TOTALLY ENCLOSED FAN COOLED; EXPLOSION PROOF ENCLOSURE
CLASS I DIVISION I GROUP C & D; CLASS II DIVISION I GROUP F & G
OPERATING TEMP CODE T3C
PERFORMANCE DATA

HP	RPM	Frame	Voltage	Frequency (Hz)	Full Load S.F.	Insulation Class	NEMA Design	Slip (%)	NEMA Code	Enclosure Type	IP Rating	Max. Ambient	Oper Temp Code	Max. KVAR
30	1777	286T	208-230/460	60	1.15	F	B	1.3	G	TEXP	55	40° C	T3C	7.6

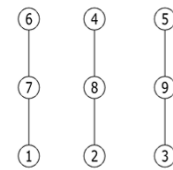
Amps (460V)		Max. Amps (208V)	Efficiency (%)				Power Factor			Torque (ft-lb)			DE Bearing	ODE Bearing	Connection	Weight (lbs.)
FLA	LRA	60HZ	100%	75%	50%	Min.	100%	75%	50%	FLT	LRT %	BDT %				
32.5	217.5	71.9	93.6	93.7	93.1	92.4	0.87	0.86	0.81	88.7	150	200	6310	6310	9 Lead 2Δ/Δ	580

NAME PLATE

 North American Electric, Inc.				PREMIUM EFFICIENT EXPLOSION PROOF MOTOR		CONNECTION DIAGRAMS		
CAT NO: PEXP286T-30-4		FRAME: 286T						PHASE: 3
DE BRG: 6310		ODE BRG: 6310		CONN.: 9 Lead 2Δ/Δ		208V-230V		
MAX AMB.: 40° C		INS. CLASS: F		RATING CONT:		WEIGHT: 580		
USABLE ON 208V 60HZ AT: 71.9		MAX AMPS:		SER:				
DIVISION 1 CLASS I GROUP C D CLASS II GROUP F G				OPER TEMP CODE: T3C				
60 HERTZ DATA	HP: 30		RPM: 1777		HP: 30		RPM: 1481	
	VOLTS: 208-230/460				VOLTS: 190/380			
	F.L. AMPS: 71.9 - 65 / 32.5				F.L. AMPS: 78.7/39.4			
	S.F. AMPS: 37.4				S.F. AMPS: 78.7/39.4			
	S.F.: 1.15 DESIGN B CODE G				S.F.: 1.0 DESIGN B CODE H			
	NEMA NOM.EFF.: 93.6 % P.F. 0.87				NEMA NOM.EFF.: 93.0 % P.F. 0.87			
	NEMA MIN.EFF.: 92.4 %				NEMA MIN.EFF.: 91.6 %			
MAX. KVAR: 7.6		LUB.: Mobil Polyrex EM						
<small>General purpose use on industrial machinery installed in damp, dusty or dirty environments. These motors are designed for use in hazardous locations defined by class and group.</small>								
						CC 041B		
Hernando, Mississippi								

	ELECTRIC MOTORS FOR HAZARDOUS LOCATIONS
	CLASS I DIVISION I GROUP C D, CLASS II DIVISION I GROUP F G
	NO. CCXXXXX E310089

APPLICATIONS:

General purpose use on pumps, fans, blowers, compressors, conveyors, material handling and other industrial machinery installed in damp, dusty or dirty environments. These motors are designed to be used in hazardous locations as defined by class and group.