

**PEXP284TS-25-2**

**EXPLOSION PROOF ELECTRIC MOTOR**

**NEMA PREMIUM EFFICIENCY**

**TOTALLY ENCLOSED FAN COOLED; EXPLOSION PROOF ENCLOSURE**

**CLASS I DIVISION I GROUP C & D; CLASS II DIVISION I GROUP F & G**

**OPERATING TEMP CODE T3C**

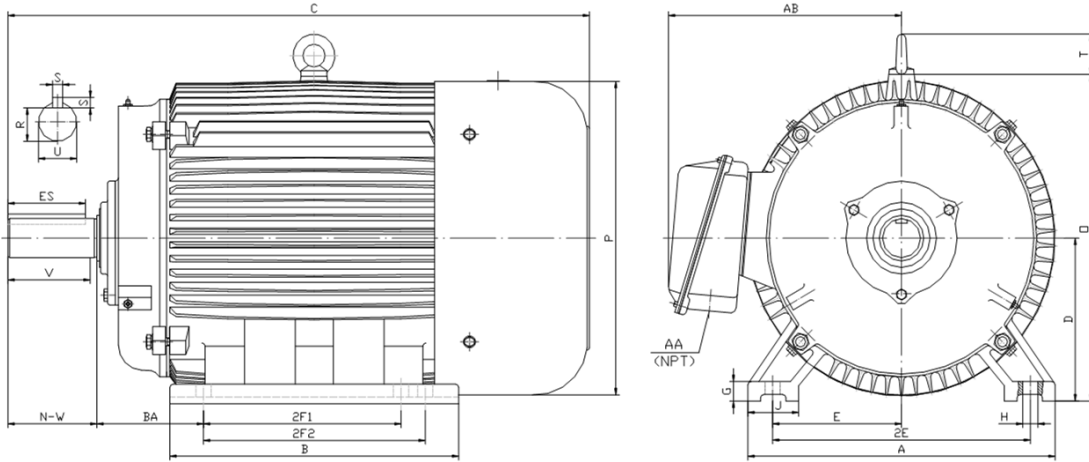

**DIMENSIONS**

HP	RPM	Frame	MOUNTING														
			A	B	C	D	G	H	J	E	2E	2F1	2F2	O	P	T	BA
25	3600	284TS	14.00	13.20	25.20	7.00	0.85	0.53	2.75	5.50	11.00	9.50	0.00	14.50	14.00	2.20	4.75

Shaft Extension, Key Set						Conduit Box		Bearings		Mount
U	V	R	S	ES	N-W	AA	AB	DE	ODE	
1.63	3.00	1.42	0.38	1.91	3.25	1.50	11.30	6310	6310	F1

**BEARING LUBRICATION:** The bearings come lubricated with Mobil Polyrex EM Polyurea Grease. It is recommended that you add some additional lubrication when the motor is installed.

Three options (brands) for suitable lubrication include, but are not limited to, the following:

- 1.) Mobil Polyrex EM
- 2.) Citco Polyurea MP
- 3.) Conoco Phillips Polytac EP









**PEXP284TS-25-2**
**EXPLOSION PROOF ELECTRIC MOTOR**
**NEMA PREMIUM EFFICIENCY**
**TOTALLY ENCLOSED FAN COOLED; EXPLOSION PROOF ENCLOSURE**
**CLASS I DIVISION I GROUP C & D; CLASS II DIVISION I GROUP F & G**
**OPERATING TEMP CODE T3C**
**PERFORMANCE DATA**

HP	RPM	Frame	Voltage	Frequency (Hz)	Full Load S.F.	Insulation Class	NEMA Design	Slip (%)	NEMA Code	Enclosure Type	IP Rating	Max. Ambient	Oper Temp Code	Max. KVAR
25	3560	284TS	208-230/460	60	1.15	F	B	1.1	G	TEXP	55	40° C	T3C	6.1

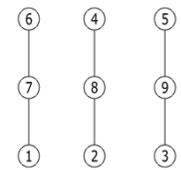
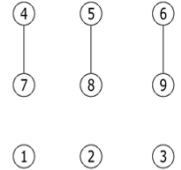
Amps (460V)		Max. Amps (208V)	Efficiency (%)				Power Factor			Torque (ft-lb)			DE Bearing	ODE Bearing	Connection	Weight (lbs.)
FLA	LRA	60HZ	100%	75%	50%	Min.	100%	75%	50%	FLT	LRT %	BDT %				
27.5	182.5	60.8	91.7	91.9	91.5	90.2	0.88	0.89	0.87	63.9	130	200	6310	6310	9 Lead 2Δ/Δ	506

**NAME PLATE**

 <b>North American Electric, Inc.</b>															<b>CONNECTION DIAGRAMS</b>  <b>208V-230V</b> 				
<b>PREMIUM EFFICIENT EXPLOSION PROOF MOTOR</b>																			
CAT NO: PEXP284TS-25-2			FRAME 284TS			PHASE 3													
DE BRG 6310			ODE BRG 6310			CONN. 9 Lead 2Δ/Δ													
MAX AMB. 40° C			INS. CLASS F			RATING CONT		WEIGHT 506											
USABLE ON 208V 60HZ AT 60.8						MAX AMPS		SER											
DIVISION 1 CLASS I GROUP C D CLASS II GROUP F G								OPER TEMP CODE T3C											
60 HERTZ DATA	HP 25		RPM 3560		HP 25		RPM 2967		50 HERTZ DATA										
	VOLTS 208-230/460				VOLTS 190/380														
	F.L. AMPS 60.8 - 55 / 27.5				F.L. AMPS 66.6/33.3														
	S.F. AMPS 31.6				S.F. AMPS 66.6/33.3														
	S.F. 1.15 DESIGN B CODE G				S.F. 1.0 DESIGN B CODE H														
	NEMA NOM.EFF. 91.7 % P.F. 0.88				NEMA NOM.EFF. 92.4 % P.F. 0.88														
	NEMA MIN.EFF. 90.2 %				NEMA MIN.EFF. 90.9 %														
MAX. KVAR 6.1		LUB. Mobil Polyrex EM								<b>460V</b> 									
<small>General purpose use on industrial machinery installed in damp, dusty or dirty environments. These motors are designed for use in hazardous locations defined by class and group.</small>										   <b>CC 041B</b>									
Hernando, Mississippi																			

	<b>ELECTRIC MOTORS FOR HAZARDOUS LOCATIONS</b>
	<small>CLASS I DIVISION I GROUP C D, CLASS II DIVISION I GROUP F G NO. CCXXXXX E310089</small>

**APPLICATIONS:**

General purpose use on pumps, fans, blowers, compressors, conveyors, material handling and other industrial machinery installed in damp, dusty or dirty environments. These motors are designed to be used in hazardous locations as defined by class and group.