

PEXP284T-15-6

EXPLOSION PROOF ELECTRIC MOTOR

NEMA PREMIUM EFFICIENCY

TOTALLY ENCLOSED FAN COOLED; EXPLOSION PROOF ENCLOSURE

CLASS I DIVISION I GROUP C & D; CLASS II DIVISION I GROUP F & G

OPERATING TEMP CODE T3C

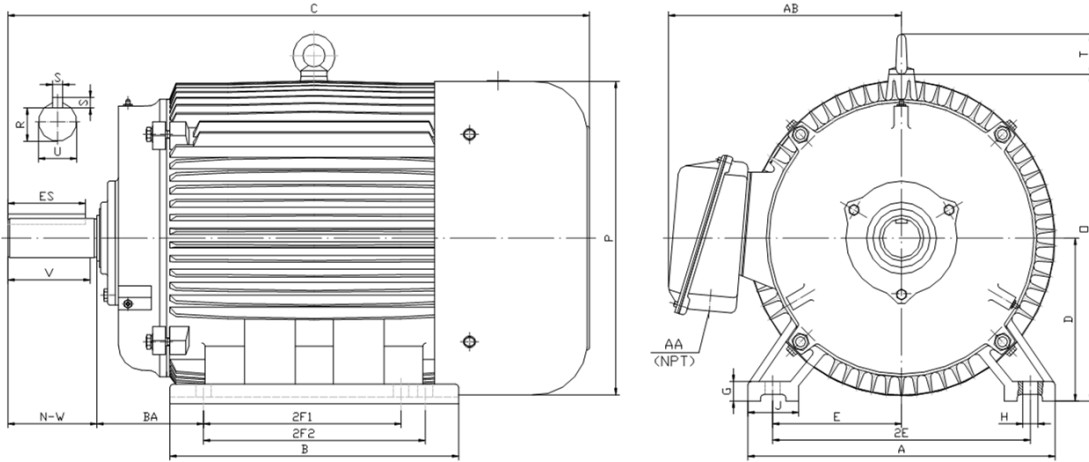

DIMENSIONS

HP	RPM	Frame	MOUNTING														
			A	B	C	D	G	H	J	E	2E	2F1	2F2	O	P	T	BA
15	1200	284T	14.00	13.20	26.60	7.00	0.85	0.53	2.75	5.50	11.00	9.50	0.00	14.50	14.00	2.20	4.75

Shaft Extension, Key Set						Conduit Box		Bearings		Mount
U	V	R	S	ES	N-W	AA	AB	DE	ODE	
1.88	4.38	1.59	0.50	3.28	4.62	1.50	11.30	6310	6310	F1

BEARING LUBRICATION: The bearings come lubricated with Mobil Polyrex EM Polyurea Grease. It is recommended that you add some additional lubrication when the motor is installed.

Three options (brands) for suitable lubrication include, but are not limited to, the following:

- 1.) Mobil Polyrex EM
- 2.) Citco Polyurea MP
- 3.) Conoco Phillips Polytac EP









PEXP284T-15-6
EXPLOSION PROOF ELECTRIC MOTOR
NEMA PREMIUM EFFICIENCY
TOTALLY ENCLOSED FAN COOLED; EXPLOSION PROOF ENCLOSURE
CLASS I DIVISION I GROUP C & D; CLASS II DIVISION I GROUP F & G
OPERATING TEMP CODE T3C
PERFORMANCE DATA

HP	RPM	Frame	Voltage	Frequency (Hz)	Full Load S.F.	Insulation Class	NEMA Design	Slip (%)	NEMA Code	Enclosure Type	IP Rating	Max. Ambient	Oper Temp Code	Max. KVAR
15	1189	284T	208-230/460	60	1.15	F	B	0.9	G	TEXP	55	40° C	T3C	5.3

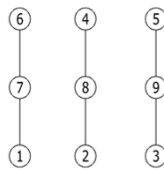
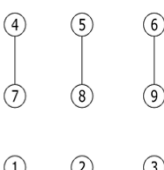
Amps (460V)		Max. Amps (208V)	Efficiency (%)				Power Factor			Torque (ft-lb)			DE Bearing	ODE Bearing	Connection	Weight (lbs.)
FLA	LRA	60HZ	100%	75%	50%	Min.	100%	75%	50%	FLT	LRT %	BDT %				
22.8	116.0	50.4	91.7	92.0	90.0	90.2	0.82	0.80	0.71	66.3	140	200	6310	6310	9 Lead 2Δ/Δ	476

NAME PLATE

 North American Electric, Inc.															CONNECTION DIAGRAMS 208V-230V 					
PREMIUM EFFICIENT EXPLOSION PROOF MOTOR																				
CAT NO: PEXP284T-15-6			FRAME 284T			PHASE 3				460V 										
DE BRG 6310		ODE BRG 6310		CONN. 9 Lead 2Δ/Δ																
MAX AMB. 40° C		INS. CLASS F		RATING CONT		WEIGHT 476														
USABLE ON 208V 60HZ AT 50.4			MAX AMPS		SER															
DIVISION 1 CLASS I GROUP C D CLASS II GROUP F G						OPER TEMP CODE T3C														
60 HERTZ DATA	HP 15		RPM 1189		HP 15		RPM 991		50 HERTZ DATA											
	VOLTS 208-230/460				VOLTS 190/380															
	F.L. AMPS 50.4 - 45.6 / 22.8				F.L. AMPS 55.2/27.6															
	S.F. AMPS 26.2				S.F. AMPS 55.2/27.6															
	S.F. 1.15 DESIGN B CODE G				S.F. 1.0 DESIGN B CODE H															
	NEMA NOM.EFF. 91.7 % P.F. 0.82				NEMA NOM.EFF. 90.3 % P.F. 0.82															
	NEMA MIN.EFF. 90.2 %				NEMA MIN.EFF. 88.4 %															
MAX. KVAR 5.3		LUB. Mobil Polyrex EM																		
<small>General purpose use on industrial machinery installed in damp, dusty or dirty environments. These motors are designed for use in hazardous locations defined by class and group.</small>										   CC 041B										
Hernando, Mississippi																				

	ELECTRIC MOTORS FOR HAZARDOUS LOCATIONS
	<small>CLASS I DIVISION I GROUP C D, CLASS II DIVISION I GROUP F G NO. CCXXXXX E310089</small>

APPLICATIONS:

General purpose use on pumps, fans, blowers, compressors, conveyors, material handling and other industrial machinery installed in damp, dusty or dirty environments. These motors are designed to be used in hazardous locations as defined by class and group.