

PEXP215T-10-2

EXPLOSION PROOF ELECTRIC MOTOR

NEMA PREMIUM EFFICIENCY

TOTALLY ENCLOSED FAN COOLED; EXPLOSION PROOF ENCLOSURE

CLASS I DIVISION I GROUP C & D; CLASS II DIVISION I GROUP F & G

OPERATING TEMP CODE T3C

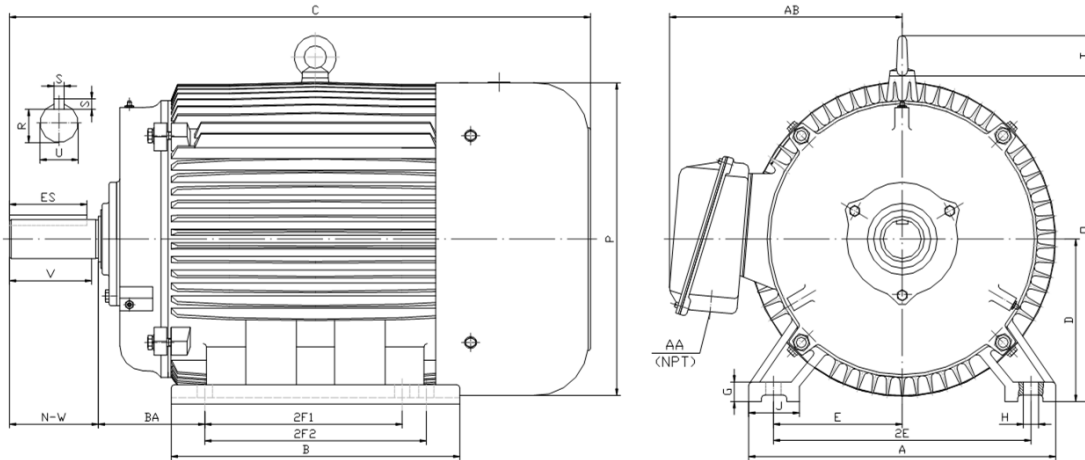

DIMENSIONS

HP	RPM	Frame	MOUNTING														
			A	B	C	D	G	H	J	E	2E	2F1	2F2	O	P	T	BA
10	3600	215T	11.00	9.40	20.40	5.25	0.70	0.41	2.40	4.25	8.50	5.50	7.00	11.20	11.60	1.90	3.50

Shaft Extension, Key Set						Conduit Box		Bearings		Mount
U	V	R	S	ES	N-W	AA	AB	DE	ODE	
1.375	3.120	1.201	0.312	2.410	3.380	1.00	9.00	6308-ZZ	6308-ZZ	F1

BEARING LUBRICATION: The bearings come lubricated with Mobil Polyrex EM Polyurea Grease.









PEXP215T-10-2
EXPLOSION PROOF ELECTRIC MOTOR
NEMA PREMIUM EFFICIENCY
TOTALLY ENCLOSED FAN COOLED; EXPLOSION PROOF ENCLOSURE
CLASS I DIVISION I GROUP C & D; CLASS II DIVISION I GROUP F & G
OPERATING TEMP CODE T3C
PERFORMANCE DATA

HP	RPM	Frame	Voltage	Frequency (Hz)	Full Load S.F.	Insulation Class	NEMA Design	Slip (%)	NEMA Code	Enclosure Type	IP Rating	Max. Ambient	Oper Temp Code	Max. KVAR
10	3540	215T	208-230/460	60	1.15	F	B	1.7	H	TEXP	55	40° C	T3C	2.2

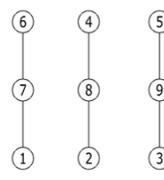
Amps (460V)		Max. Amps (208V)	Efficiency (%)				Power Factor			Torque (ft-lb)			DE Bearing	ODE Bearing	Connection	Weight (lbs.)
FLA	LRA	60HZ	100%	75%	50%	Min.	100%	75%	50%	FLT	LRT %	BDT %	6308-ZZ	6308-ZZ	9 Lead 2Δ/Δ	262
11.5	81.0	25.4	90.2	90.2	89.0	88.5	0.88	0.92	0.87	14.9	135	200				

NAME PLATE

 North American Electric, Inc.															CONNECTION DIAGRAMS 208V-230V 		
PREMIUM EFFICIENT EXPLOSION PROOF MOTOR																	
CAT NO: PEXP215T-10-2			FRAME 215T			PHASE 3											
DE BRG 6308-ZZ		ODE BRG 6308-ZZ		CONN. 9 Lead 2Δ/Δ													
MAX AMB. 40° C		INS. CLASS F		RATING CONT		WEIGHT 262											
USABLE ON 208V 60HZ AT 25.4				MAX AMPS			SER										
DIVISION 1 CLASS I GROUP C D CLASS II GROUP F G							OPER TEMP CODE T3C										
60 HERTZ DATA		HP 10		RPM 3540		HP 10		RPM 2950				50 HERTZ DATA					
		VOLTS 208-230/460				VOLTS 190/380											
		F.L. AMPS 25.4 - 23 / 11.5				F.L. AMPS 27.8/13.9											
		S.F. AMPS 13.2				S.F. AMPS 27.8/13.9											
		S.F. 1.15 DESIGN B CODE H				S.F. 1.0 DESIGN B CODE H											
		NEMA NOM.EFF. 90.2 % P.F. 0.88				NEMA NOM.EFF. 90.1 % P.F. 0.88											
		NEMA MIN.EFF. 88.5 %				NEMA MIN.EFF. 88.1 %											
MAX. KVAR 2.2		LUB. Mobil Polyrex EM															
<small>General purpose use on industrial machinery installed in damp, dusty or dirty environments. These motors are designed for use in hazardous locations defined by class and group.</small>										  							
Hernando, Mississippi										CC 041B							

	ELECTRIC MOTORS FOR HAZARDOUS LOCATIONS CLASS I DIVISION I GROUP C D, CLASS II DIVISION I GROUP F G NO. CCXXXXX E310089

APPLICATIONS:

General purpose use on pumps, fans, blowers, compressors, conveyors, material handling and other industrial machinery installed in damp, dusty or dirty environments. These motors are designed to be used in hazardous locations as defined by class and group.