

PE449TC-300-4

GENERAL PURPOSE ELECTRIC MOTOR

NEMA PREMIUM EFFICIENCY

THREE PHASE, TOTALLY ENCLOSED FAN COOLED - C-FLANGE W/ FEET

INVERTER DUTY 10:1 CT; 20:1 VT - NEMA MG1 PART 31

Factory Certified for T2B Class I, Division II, Groups A,B,C & D and Class II, Division II, Groups F & G

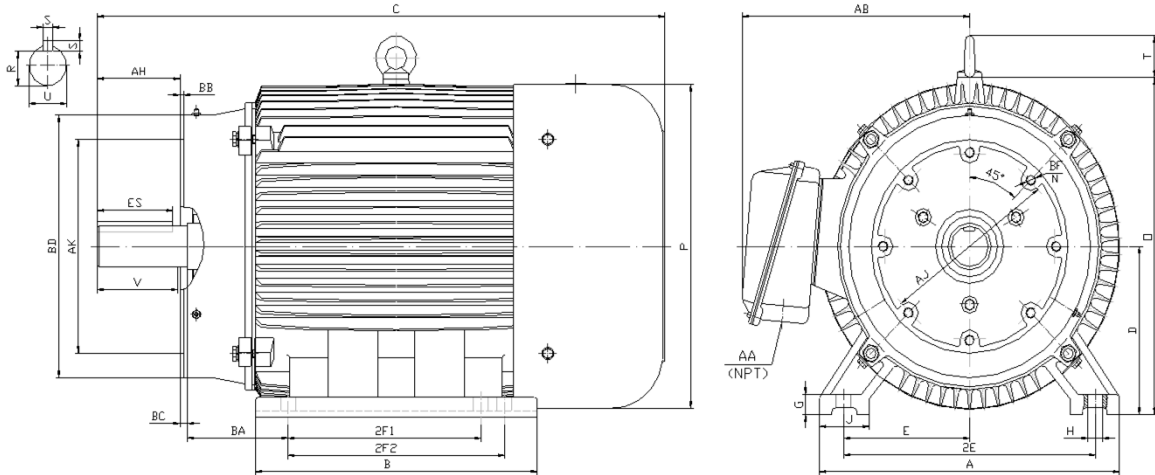

DIMENSIONS

HP	RPM	Frame	MOUNTING														
			A	B	C	D	G	H	J	E	2E	2F1	2F2	O	P	T	BA
300	1800	449TC	21.70	31.40	52.80	11.00	1.35	0.81	3.35	9.00	18.00	20.00	25.00	23.00	23.40	3.00	7.50

FLANGE							Shaft Extension, Key Set						Conduit Box		Bearings		Mount
AH	AJ	AK	BB	BC	BD	BF	U	V	R	S	ES	N-W	AA	AB	DE	ODE	
8.25	14.00	16.00	0.25	0.25	18.00	8*5/8-11	3.38	8.25	2.88	0.88	6.91	8.50	3.00	19.90	6319	6318	F1

BEARING LUBRICATION: The bearings come lubricated with Mobil Polyrex EM Polyurea Grease. It is recommended that you add some additional lubrication when the motor is installed.

Three options (brands) for suitable lubrication include, but are not limited to, the following:

- 1.) Mobil Polyrex EM
- 2.) Citco Polyurea MP
- 3.) Conoco Phillips Polytac EP





PE449TC-300-4

GENERAL PURPOSE ELECTRIC MOTOR

NEMA PREMIUM EFFICIENCY

THREE PHASE, TOTALLY ENCLOSED FAN COOLED - C-FLANGE W/ FEET

INVERTER DUTY 10:1 CT; 20:1 VT - NEMA MG1 PART 31







Factory Certified for T2B Class I, Division II, Groups A,B,C & D and Class II, Division II, Groups F & G

PERFORMANCE DATA

HP	RPM	Frame	Voltage	Frequency (Hz)	Full Load S.F.	Insulation Class	NEMA Design	Slip (%)	NEMA Code	Enclosure Type	IP Rating	Max. Ambient
300	1790	449TC	460	60	1.15	F	B	0.6	G	TEFC	55	40° C

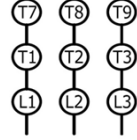
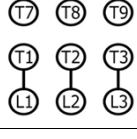
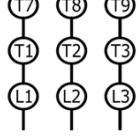
Amps (460V)		Efficiency (%)				Power Factor			Torque (ft-lb)			DE Bearing	ODE Bearing	Connection	Weight (lbs.)
FLA	LRA	100%	75%	50%	Min.	100%	75%	50%	FLT	LRT %	BDT %				
335.0	2200	96.2	96.0	95.6	95.4	0.870	0.860	0.800	885.4	140	245	6319	6318	6 Lead Δ	2220

NAME PLATE

 North American Electric, Inc.													CONNECTION DIAGRAMS (460V)																																																																																																			
INVERTER DUTY 20:1 VT; 10:1 CT										ACROSS THE LINE																																																																																																						
										PWS START																																																																																																						
<table border="1"> <tr> <td>CAT NO:</td> <td colspan="4">PE449TC-300-4</td> <td>FRAME</td> <td colspan="3">449TC</td> <td>PHASE</td> <td colspan="2">3</td> </tr> <tr> <td>HZ</td> <td>60</td> <td>S.F.</td> <td>1.15</td> <td>HZ</td> <td>50</td> <td>S.F.</td> <td>1.0</td> <td>ENCL</td> <td>TEFC</td> <td>IP</td> <td>55</td> </tr> <tr> <td>HP</td> <td>300</td> <td>RPM</td> <td>1790</td> <td>HP</td> <td>300</td> <td>RPM</td> <td>1488</td> <td>DUTY</td> <td>CONT</td> <td>DES</td> <td>B</td> </tr> <tr> <td>VOLTS</td> <td colspan="3">460</td> <td>VOLTS</td> <td colspan="3">380</td> <td>AMB</td> <td colspan="2">40° C</td> <td>INS</td> <td>F</td> </tr> <tr> <td>FLA</td> <td colspan="3">335.0</td> <td>FLA</td> <td colspan="3">411</td> <td>DE BEARING</td> <td colspan="3">6319</td> </tr> <tr> <td>CODE</td> <td>G</td> <td>P.F.</td> <td>0.87</td> <td>CODE</td> <td>D</td> <td>P.F.</td> <td>0.87</td> <td>ODE BEARING</td> <td colspan="3">6318</td> </tr> <tr> <td>EFF</td> <td>96.2</td> <td>MIN</td> <td>95.4</td> <td>EFF</td> <td>95</td> <td>MIN</td> <td>94.1</td> <td>LUB:</td> <td colspan="3">Mobil Polyrex EM</td> </tr> <tr> <td>MOTOR WEIGHT</td> <td>2220</td> <td>LBS</td> <td></td> <td>CONNECTION</td> <td colspan="3">6 Lead Δ</td> <td>SER NO</td> <td colspan="3"></td> </tr> </table>										CAT NO:	PE449TC-300-4				FRAME	449TC			PHASE	3		HZ	60	S.F.	1.15	HZ	50	S.F.	1.0	ENCL	TEFC	IP	55	HP	300	RPM	1790	HP	300	RPM	1488	DUTY	CONT	DES	B	VOLTS	460			VOLTS	380			AMB	40° C		INS	F	FLA	335.0			FLA	411			DE BEARING	6319			CODE	G	P.F.	0.87	CODE	D	P.F.	0.87	ODE BEARING	6318			EFF	96.2	MIN	95.4	EFF	95	MIN	94.1	LUB:	Mobil Polyrex EM			MOTOR WEIGHT	2220	LBS		CONNECTION	6 Lead Δ			SER NO									
CAT NO:	PE449TC-300-4				FRAME	449TC			PHASE	3																																																																																																						
HZ	60	S.F.	1.15	HZ	50	S.F.	1.0	ENCL	TEFC	IP	55																																																																																																					
HP	300	RPM	1790	HP	300	RPM	1488	DUTY	CONT	DES	B																																																																																																					
VOLTS	460			VOLTS	380			AMB	40° C		INS	F																																																																																																				
FLA	335.0			FLA	411			DE BEARING	6319																																																																																																							
CODE	G	P.F.	0.87	CODE	D	P.F.	0.87	ODE BEARING	6318																																																																																																							
EFF	96.2	MIN	95.4	EFF	95	MIN	94.1	LUB:	Mobil Polyrex EM																																																																																																							
MOTOR WEIGHT	2220	LBS		CONNECTION	6 Lead Δ			SER NO																																																																																																								
<p>General purpose use on industrial machinery installed in damp, dusty or dirty environments.</p> <p>Hernando, Mississippi</p>										PWS RUN																																																																																																						
										   																																																																																																						

APPLICATIONS:

General purpose use on pumps, fans, blowers, compressors, conveyors, material handling and other industrial machinery installed in damp, dusty or dirty environments.