

**PE445TC-150-4**

GENERAL PURPOSE ELECTRIC MOTOR

NEMA PREMIUM EFFICIENCY

THREE PHASE, TOTALLY ENCLOSED FAN COOLED - C-FLANGE W/ FEET

INVERTER DUTY 10:1 CT; 20:1 VT - NEMA MG1 PART 31

Factory Certified for T2B Class I, Division II, Groups A,B,C & D and Class II, Division II, Groups F & G

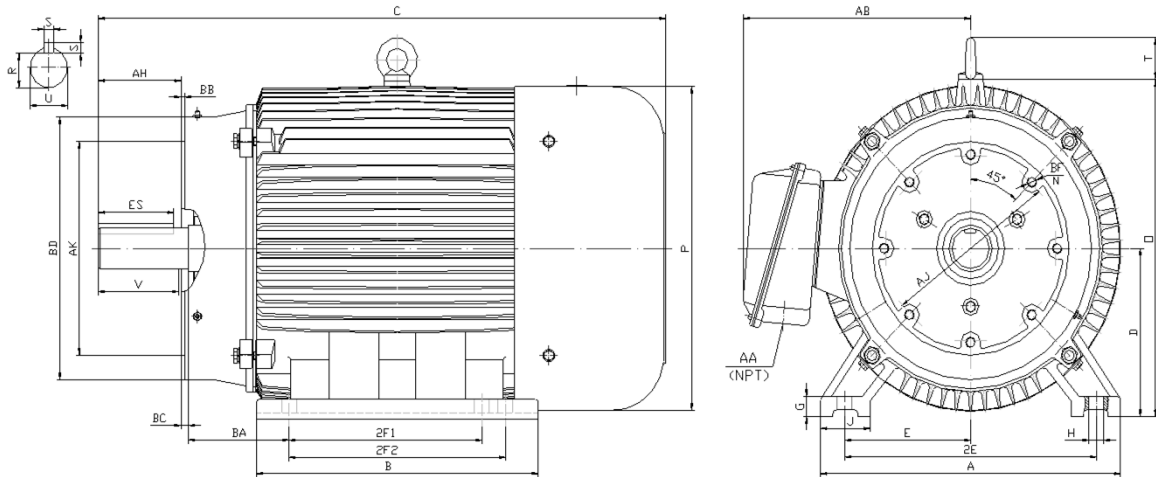

**DIMENSIONS**

HP	RPM	Frame	MOUNTING														
			A	B	C	D	G	H	J	E	2E	2F1	2F2	O	P	T	BA
150	1800	445TC	21.70	22.90	44.30	11.00	1.35	0.81	3.35	9.00	18.00	14.50	16.50	23.00	23.40	3.00	7.50

FLANGE							Shaft Extension, Key Set						Conduit Box		Bearings		Mount
AH	AJ	AK	BB	BC	BD	BF	U	V	R	S	ES	N-W	AA	AB	DE	ODE	
8.25	14.00	16.00	0.25	0.25	18.00	8*5/8-11	3.38	8.25	2.88	0.88	6.91	8.50	3.00	19.90	6319	6318	F1

**BEARING LUBRICATION:** The bearings come lubricated with Mobil Polyrex EM Polyurea Grease. It is recommended that you add some additional lubrication when the motor is installed.

Three options (brands) for suitable lubrication include, but are not limited to, the following:

- 1.) Mobil Polyrex EM
- 2.) Citco Polyurea MP
- 3.) Conoco Phillips Polytac EP





## PE445TC-150-4

**GENERAL PURPOSE ELECTRIC MOTOR**

**NEMA PREMIUM EFFICIENCY**

**THREE PHASE, TOTALLY ENCLOSED FAN COOLED - C-FLANGE W/ FEET**

**INVERTER DUTY 10:1 CT; 20:1 VT - NEMA MG1 PART 31**







Factory Certified for T2B Class I, Division II, Groups A,B,C & D and Class II, Division II, Groups F & G

### PERFORMANCE DATA

HP	RPM	Frame	Voltage	Frequency (Hz)	Full Load S.F.	Insulation Class	NEMA Design	Slip (%)	NEMA Code	Enclosure Type	IP Rating	Max. Ambient
150	1790	445TC	460	60	1.15	F	B	0.6	G	TEFC	55	40° C

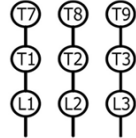
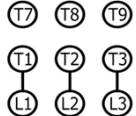
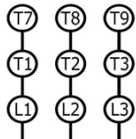
Amps (460V)		Efficiency (%)				Power Factor			Torque (ft-lb)			DE Bearing	ODE Bearing	Connection	Weight (lbs.)
FLA	LRA	100%	75%	50%	Min.	100%	75%	50%	FLT	LRT %	BDT %				
168.0	1085	95.8	95.8	95.0	95.0	0.870	0.860	0.800	442.7	150	250	6319	6318	6 Lead Δ	1672

### NAME PLATE

 <b>North American Electric, Inc.</b>													<b>CONNECTION DIAGRAMS (460V)</b>		
<b>INVERTER DUTY 20:1 VT; 10:1 CT</b>										<b>ACROSS THE LINE</b>					
<b>CAT NO: PE445TC-150-4</b>										<b>FRAME 445TC</b>			<b>PHASE 3</b>		
<b>HZ 60</b>		<b>S.F. 1.15</b>		<b>HZ 50</b>		<b>S.F. 1.0</b>		<b>ENCL TEFC</b>		<b>IP 55</b>					
<b>HP 150</b>		<b>RPM 1790</b>		<b>HP 150</b>		<b>RPM 1488</b>		<b>DUTY CONT</b>		<b>DES B</b>		<b>PWS START</b>			
<b>VOLTS 460</b>			<b>VOLTS 380</b>			<b>AMB 40° C</b>			<b>INS F</b>						
<b>FLA 168.0</b>			<b>FLA 203</b>			<b>DE BEARING 6319</b>			<b>ODE BEARING 6318</b>			<b>PWS RUN</b>			
<b>CODE G</b>		<b>P.F. 0.87</b>		<b>CODE F</b>		<b>P.F. 0.88</b>		<b>ODE BEARING 6318</b>							
<b>EFF 95.8</b>		<b>MIN 95.0</b>		<b>EFF 95</b>		<b>MIN 94.1</b>		<b>LUB: Mobil Polyrex EM</b>							
<b>MOTOR WEIGHT 1672 LBS</b>		<b>CONNECTION 6 Lead Δ</b>			<b>SER NO</b>										
General purpose use on industrial machinery installed in damp, dusty or dirty environments. Hernando, Mississippi										  			<b>CC 082A</b>		

### APPLICATIONS:

General purpose use on pumps, fans, blowers, compressors, conveyors, material handling and other industrial machinery installed in damp, dusty or dirty environments.