

PEXP447TC-200-4

EXPLOSION PROOF ELECTRIC MOTOR

NEMA PREMIUM EFFICIENCY

TOTALLY ENCLOSED FAN COOLED; EXPLOSION PROOF ENCLOSURE

CLASS I DIVISION I GROUP C & D; CLASS II DIVISION I GROUP F & G

OPERATING TEMP CODE T3C

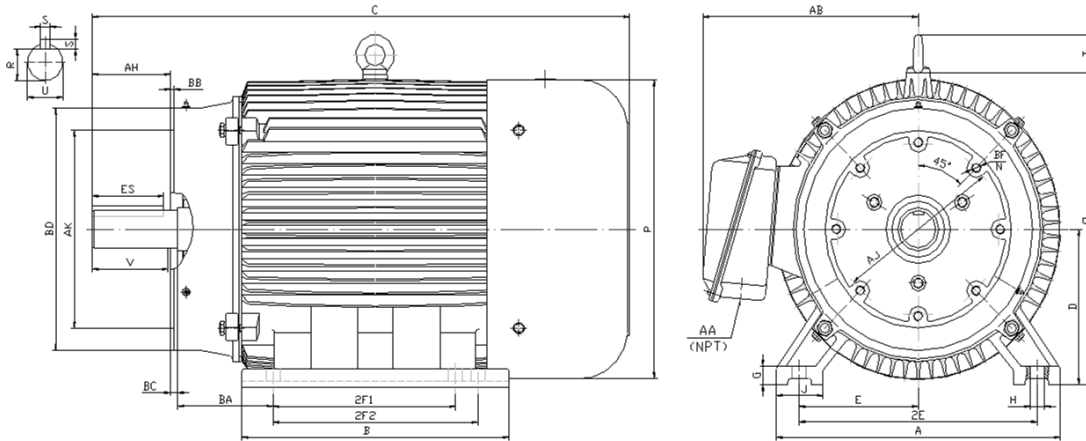

DIMENSIONS

HP	RPM	Frame	MOUNTING														
			A	B	C	D	G	H	J	E	2E	2F1	2F2	O	P	T	BA
200	1800	447TC	21.70	26.40	47.80	11.00	1.35	0.81	3.35	9.00	18.00	16.50	20.00	23.00	23.40	3.00	7.50

FLANGE							Shaft Extension, Key Set						Conduit Box		Bearings		Mount
AH	AJ	AK	BB	BC	BD	BF	U	V	R	S	ES	N-W	AA	AB	DE	ODE	
8.25	14.00	16.00	0.25	0.25	18.00	8*5/8-11	3.38	8.25	2.88	0.88	6.91	8.50	3.00	19.90	6319	6318	F1

BEARING LUBRICATION: The bearings come lubricated with Mobil Polyrex EM Polyurea Grease. It is recommended that you add some additional lubrication when the motor is installed.

Three options (brands) for suitable lubrication include, but are not limited to, the following:

- 1.) Mobil Polyrex EM
- 2.) Citco Polyurea MP
- 3.) Conoco Phillips Polytac EP









PEXP447TC-200-4
EXPLOSION PROOF ELECTRIC MOTOR
NEMA PREMIUM EFFICIENCY
TOTALLY ENCLOSED FAN COOLED; EXPLOSION PROOF ENCLOSURE
CLASS I DIVISION I GROUP C & D; CLASS II DIVISION I GROUP F & G
OPERATING TEMP CODE T3C
PERFORMANCE DATA

HP	RPM	Frame	Voltage	Frequency (Hz)	Full Load S.F.	Insulation Class	NEMA Design	Slip (%)	NEMA Code	Enclosure Type	IP Rating	Max. Ambient	Oper Temp Code	Max. KVAR
200	1789	447TC	460	60	1.15	F	B	0.6	G	TEXP	55	40° C	40° C	45.2

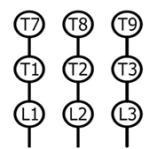
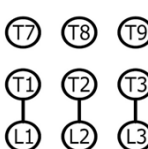
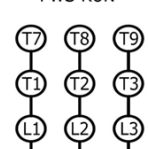
Amps (460V)		Max. Amps (208V)	Efficiency (%)				Power Factor			Torque (ft-lb)			DE Bearing	ODE Bearing	Connection	Weight (lbs.)
FLA	LRA	60HZ	100%	75%	50%	Min.	100%	75%	50%	FLT	LRT %	BDT %	6318	6314	6 Lead Δ	2348
217	1450	479.9	96.2	96.2	95.8	95.4	0.850	0.868	0.842	587	100	200				

NAME PLATE

 North American Electric, Inc.												CONNECTION DIAGRAMS PWS RUN 							
PREMIUM EFFICIENT EXPLOSION PROOF MOTOR																			
CAT NO: PEXP447TC-200-4			FRAME 447TC			PHASE 3			PWS START 										
DE BRG 6318		ODE BRG 6314		CONN. 6 Lead Δ															
MAX AMB. 40° C		INS. CLASS F		RATING CONT		WEIGHT 2348													
USABLE ON 208V 60HZ AT 479.9				MAX AMPS		SER													
DIVISION 1 CLASS I GROUP C D CLASS II GROUP F G						OPER TEMP CODE 40° C													
60 HERTZ DATA						HP 200		RPM 1789		HP 200		RPM 1491		50 HERTZ DATA					
						VOLTS 460				VOLTS 380									
						F.L. AMPS 217				F.L. AMPS 262.7									
						S.F. AMPS 249.6				S.F. AMPS 263									
						S.F. 1.15 DESIGN B CODE G				S.F. 1.0 DESIGN B CODE H									
						NEMA NOM.EFF. 96.2 % P.F. 0.850				NEMA NOM.EFF. 96.2 % P.F. 0.850									
						NEMA MIN.EFF. 95.4 %				NEMA MIN.EFF. 95.0 %									
MAX. KVAR 45.2		LUB. Mobil Polyrex EM				PWS RUN 													
<small>General purpose use on industrial machinery installed in damp, dusty or dirty environments. These motors are designed for use in hazardous locations defined by class and group.</small>																			
  						CC 041B													
Hernando, Mississippi																			

	ELECTRIC MOTORS FOR HAZARDOUS LOCATIONS	
	CLASS I DIVISION I GROUP C D, CLASS II DIVISION I GROUP F G	
	NO. CCXXXXX E310089	

APPLICATIONS:

General purpose use on pumps, fans, blowers, compressors, conveyors, material handling and other industrial machinery installed in damp, dusty or dirty environments. These motors are designed to be used in hazardous locations as defined by class and group.