

PEXP445T-125-6

EXPLOSION PROOF ELECTRIC MOTOR

NEMA PREMIUM EFFICIENCY

TOTALLY ENCLOSED FAN COOLED; EXPLOSION PROOF ENCLOSURE

CLASS I DIVISION I GROUP C & D; CLASS II DIVISION I GROUP F & G

OPERATING TEMP CODE T3C

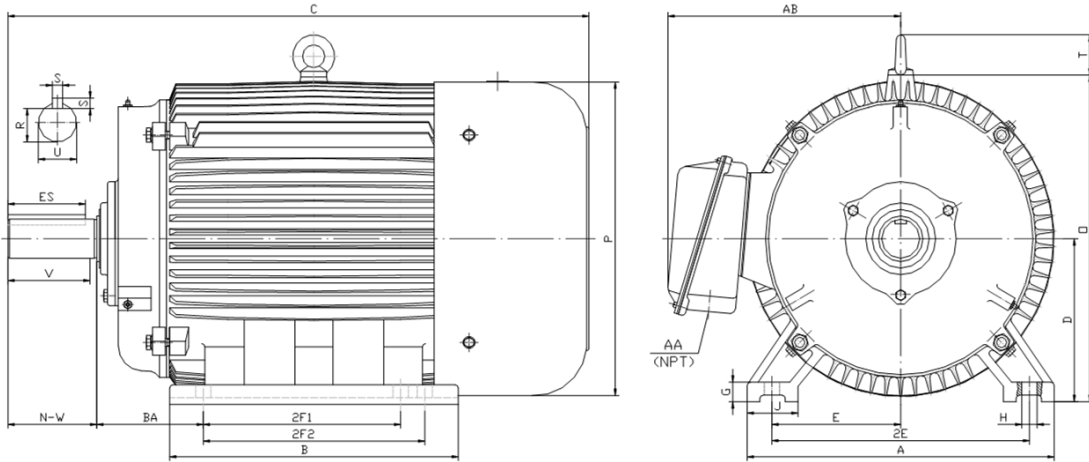

DIMENSIONS

| HP | RPM | Frame | MOUNTING | | | | | | | | | | | | | | |
|-----|------|-------|----------|-------|-------|-------|------|------|------|------|-------|-------|-------|-------|-------|------|------|
| | | | A | B | C | D | G | H | J | E | 2E | 2F1 | 2F2 | O | P | T | BA |
| 125 | 1200 | 445T | 21.70 | 22.90 | 44.30 | 11.00 | 1.35 | 0.81 | 3.35 | 9.00 | 18.00 | 14.50 | 16.50 | 23.00 | 23.40 | 3.00 | 7.50 |

| Shaft Extension, Key Set | | | | | | Conduit Box | | Bearings | | Mount |
|--------------------------|------|------|------|------|------|-------------|-------|----------|------|-------|
| U | V | R | S | ES | N-W | AA | AB | DE | ODE | |
| 3.38 | 8.25 | 2.88 | 0.88 | 6.91 | 8.50 | 3.00 | 19.90 | 6318 | 6314 | F1 |

BEARING LUBRICATION: The bearings come lubricated with Mobil Polyrex EM Polyurea Grease. It is recommended that you add some additional lubrication when the motor is installed.

Three options (brands) for suitable lubrication include, but are not limited to, the following:

- 1.) Mobil Polyrex EM
- 2.) Citco Polyurea MP
- 3.) Conoco Phillips Polytac EP



PEXP445T-125-6







EXPLOSION PROOF ELECTRIC MOTOR
NEMA PREMIUM EFFICIENCY
TOTALLY ENCLOSED FAN COOLED; EXPLOSION PROOF ENCLOSURE
CLASS I DIVISION I GROUP C & D; CLASS II DIVISION I GROUP F & G
OPERATING TEMP CODE T3C

PERFORMANCE DATA

| HP | RPM | Frame | Voltage | Frequency (Hz) | Full Load S.F. | Insulation Class | NEMA Design | Slip (%) | NEMA Code | Enclosure Type | IP Rating | Max. Ambient | Oper Temp Code | Max. KVAR |
|-----|------|-------|---------|----------------|----------------|------------------|-------------|----------|-----------|----------------|-----------|--------------|----------------|-----------|
| 125 | 1191 | 445T | 460 | 60 | 1.15 | F | B | 0.8 | G | TEXP | 55 | 40° C | T3C | 29.4 |

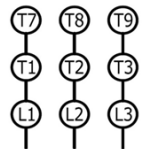
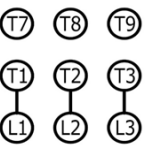
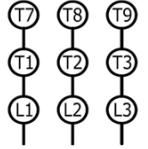
| Amps (460V) | | Max. Amps (208V) | Efficiency (%) | | | | Power Factor | | | Torque (ft-lb) | | | DE Bearing | ODE Bearing | Connection | Weight (lbs.) |
|-------------|-----|------------------|----------------|------|------|------|--------------|------|------|----------------|-------|-------|------------|-------------|------------|---------------|
| FLA | LRA | 60HZ | 100% | 75% | 50% | Min. | 100% | 75% | 50% | FLT | LRT % | BDT % | | | | |
| 135.0 | 908 | 298.6 | 95.0 | 95.1 | 94.7 | 94.1 | 0.84 | 0.84 | 0.80 | 551.2 | 120 | 200 | 6318 | 6314 | 6 Lead Δ | 1779 |

NAME PLATE

| | | | | | | | | | | | | | | | | | | | | | | | |
|---|--|----------------|--|------------|--|---|--|----------|--|--------------------------------|--|---|--|-----------|--|-----|--|-----|--|-----|--|--|--|
|  North American Electric, Inc. | | | | | |  | | | | | | CONNECTION DIAGRAMS ACROSS THE LINE  PWS START  PWS RUN  | | | | | | | | | | | |
| PREMIUM EFFICIENT EXPLOSION PROOF MOTOR | | | | | | | | | | | | | | | | | | | | | | | |
| CAT NO: | | PEXP445T-125-6 | | FRAME | | 445T | | PHASE | | 3 | | | | | | | | | | | | | |
| DE BRG | | 6318 | | ODE BRG | | 6314 | | CONN. | | 6 Lead Δ | | | | | | | | | | | | | |
| MAX AMB. | | 40° C | | INS. CLASS | | F | | RATING | | CONT | | WEIGHT | | 1779 | | | | | | | | | |
| USABLE ON 208V 60HZ AT | | | | | | 298.6 | | MAX AMPS | | SER | | | | | | | | | | | | | |
| DIVISION 1 CLASS I GROUP C D CLASS II GROUP F G | | | | | | OPER TEMP CODE | | | | | | T3C | | | | | | | | | | | |
| 60 HERTZ DATA | | | | | | HP | | 125 | | RPM | | 1191 | | HP | | 125 | | RPM | | 993 | | | |
| | | | | | | VOLTS | | | | 460 | | | | VOLTS | | | | 380 | | | | | |
| | | | | | | F.L. AMPS | | | | 135 | | | | F.L. AMPS | | | | 163 | | | | | |
| | | | | | | S.F. AMPS | | | | 155.3 | | | | S.F. AMPS | | | | 163 | | | | | |
| | | | | | | S.F. 1.15 DESIGN B CODE G | | | | S.F. 1.0 DESIGN B CODE H | | | | | | | | | | | | | |
| | | | | | | NEMA NOM.EFF. 95.0 % P.F. 0.84 | | | | NEMA NOM.EFF. 94.9 % P.F. 0.84 | | | | | | | | | | | | | |
| | | | | | | NEMA MIN.EFF. 94.1 % | | | | NEMA MIN.EFF. 93.9 % | | | | | | | | | | | | | |
| MAX. KVAR | | | | 29.4 | | | | LUB. | | | | Mobil Polyrex EM | | | | | | | | | | | |
| <small>General purpose use on industrial machinery installed in damp, dusty or dirty environments. These motors are designed for use in hazardous locations defined by class and group.</small> | | | | | |    | | | | | | CC 041B | | | | | | | | | | | |
| Hernando, Mississippi | | | | | | | | | | | | | | | | | | | | | | | |

| | |
|---|--|
|  | ELECTRIC MOTORS FOR HAZARDOUS LOCATIONS CLASS I DIVISION I GROUP C D, CLASS II DIVISION I GROUP F G NO. CCXXXXX E310089 |
|---|--|

APPLICATIONS:

General purpose use on pumps, fans, blowers, compressors, conveyors, material handling and other industrial machinery installed in damp, dusty or dirty environments. These motors are designed to be used in hazardous locations as defined by class and group.