

PEXP444T-125-4

EXPLOSION PROOF ELECTRIC MOTOR

NEMA PREMIUM EFFICIENCY

TOTALLY ENCLOSED FAN COOLED; EXPLOSION PROOF ENCLOSURE

CLASS I DIVISION I GROUP C & D; CLASS II DIVISION I GROUP F & G

OPERATING TEMP CODE T3C

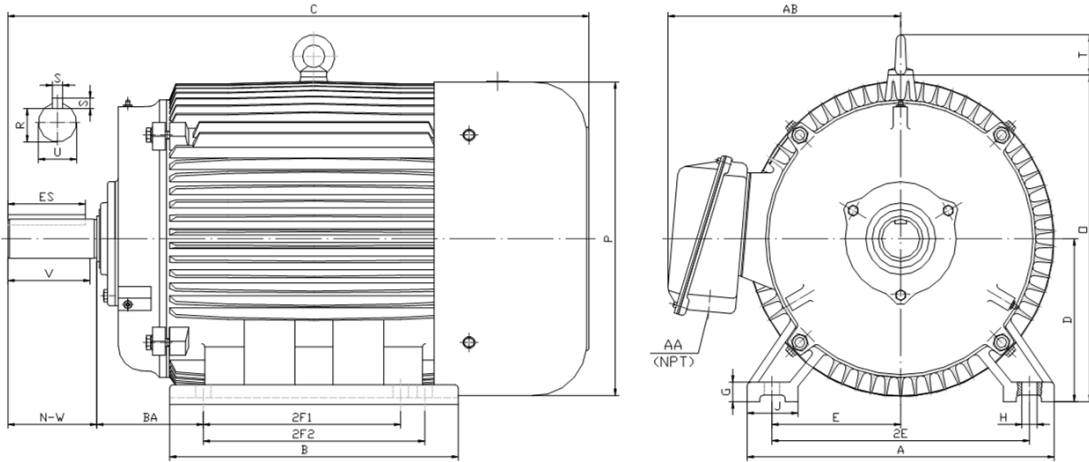

DIMENSIONS

HP	RPM	Frame	MOUNTING														
			A	B	C	D	G	H	J	E	2E	2F1	2F2	O	P	T	BA
125	1800	444T	21.70	22.90	44.30	11.00	1.35	0.81	3.35	9.00	18.00	14.50	16.50	23.00	23.40	3.00	7.50

Shaft Extension, Key Set						Conduit Box		Bearings		Mount
U	V	R	S	ES	N-W	AA	AB	DE	ODE	
3.38	8.25	2.88	0.88	6.91	8.50	3.00	19.90	6318	6314	F1

BEARING LUBRICATION: The bearings come lubricated with Mobil Polyrex EM Polyurea Grease. It is recommended that you add some additional lubrication when the motor is installed.

Three options (brands) for suitable lubrication include, but are not limited to, the following:

- 1.) Mobil Polyrex EM
- 2.) Citco Polyurea MP
- 3.) Conoco Phillips Polytac EP



PEXP444T-125-4







EXPLOSION PROOF ELECTRIC MOTOR
NEMA PREMIUM EFFICIENCY
TOTALLY ENCLOSED FAN COOLED; EXPLOSION PROOF ENCLOSURE
CLASS I DIVISION I GROUP C & D; CLASS II DIVISION I GROUP F & G
OPERATING TEMP CODE T3C

PERFORMANCE DATA

HP	RPM	Frame	Voltage	Frequency (Hz)	Full Load S.F.	Insulation Class	NEMA Design	Slip (%)	NEMA Code	Enclosure Type	IP Rating	Max. Ambient	Oper Temp Code	Max. KVAR
125	1789	444T	460	60	1.15	F	B	0.6	G	TEXP	55	40° C	T3C	25.1

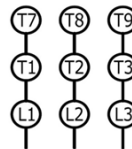
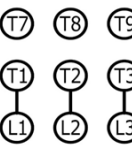
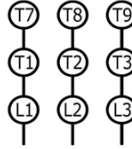
Amps (460V)		Max. Amps (208V)	Efficiency (%)				Power Factor			Torque (ft-lb)			DE Bearing	ODE Bearing	Connection	Weight (lbs.)
FLA	LRA	60HZ	100%	75%	50%	Min.	100%	75%	50%	FLT	LRT %	BDT %				
133.0	908	294.1	95.4	95.4	94.8	94.5	0.85	0.86	0.82	367.0	110	200	6318	6314	6 Lead Δ	1640

NAME PLATE

 North American Electric, Inc.												CONNECTION DIAGRAMS ACROSS THE LINE  PWS START  PWS RUN 											
PREMIUM EFFICIENT EXPLOSION PROOF MOTOR																							
CAT NO:		PEXP444T-125-4		FRAME		444T		PHASE		3													
DE BRG		6318		ODE BRG		6314		CONN.		6 Lead Δ													
MAX AMB.		40° C		INS. CLASS		F		RATING		CONT		WEIGHT		1640									
USABLE ON 208V 60HZ AT						294.1		MAX AMPS		SER													
DIVISION 1 CLASS I GROUP C D CLASS II GROUP F G								OPER TEMP CODE		T3C													
60 HERTZ DATA						HP		125		RPM		1789		HP		125		RPM		1491			
						VOLTS				460				VOLTS				380					
						F.L. AMPS				133				F.L. AMPS				161					
						S.F. AMPS				153.0				S.F. AMPS				161					
						S.F. 1.15 DESIGN B CODE G				S.F. 1.0 DESIGN B CODE H													
						NEMA NOM.EFF. 95.4 % P.F. 0.85				NEMA NOM.EFF. 95.3 % P.F. 0.85													
						NEMA MIN.EFF. 94.5 %				NEMA MIN.EFF. 94.4 %													
MAX. KVAR				25.1				LUB.				Mobil Polyrex EM											
<small>General purpose use on industrial machinery installed in damp, dusty or dirty environments. These motors are designed for use in hazardous locations defined by class and group.</small>						  						CC 041B											
Hernando, Mississippi																							

	ELECTRIC MOTORS FOR HAZARDOUS LOCATIONS
	CLASS I DIVISION I GROUP C D, CLASS II DIVISION I GROUP F G
	NO. CCXXXXX E310089

APPLICATIONS:

General purpose use on pumps, fans, blowers, compressors, conveyors, material handling and other industrial machinery installed in damp, dusty or dirty environments. These motors are designed to be used in hazardous locations as defined by class and group.