

**PEXP444TS-125-2**

EXPLOSION PROOF ELECTRIC MOTOR

NEMA PREMIUM EFFICIENCY

TOTALLY ENCLOSED FAN COOLED; EXPLOSION PROOF ENCLOSURE

CLASS I DIVISION I GROUP C & D; CLASS II DIVISION I GROUP F & G

OPERATING TEMP CODE T3C

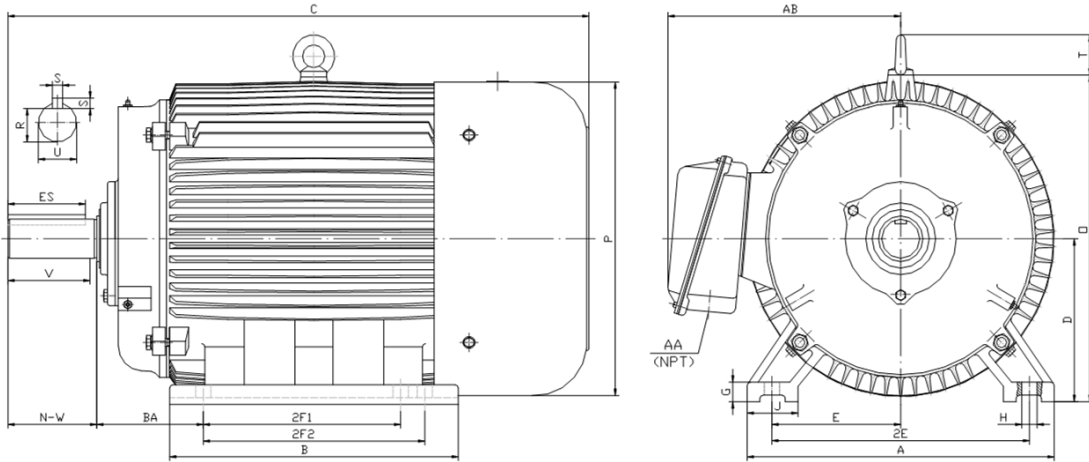

**DIMENSIONS**

HP	RPM	Frame	MOUNTING														
			A	B	C	D	G	H	J	E	2E	2F1	2F2	O	P	T	BA
125	3600	444TS	21.70	22.90	40.60	11.00	1.35	0.81	3.35	9.00	18.00	14.50	16.50	23.00	23.40	3.00	7.50

Shaft Extension, Key Set						Conduit Box		Bearings		Mount
U	V	R	S	ES	N-W	AA	AB	DE	ODE	
2.38	4.50	2.02	0.63	3.03	4.75	3.00	19.90	6314	6314	F1

**BEARING LUBRICATION:** The bearings come lubricated with Mobil Polyrex EM Polyurea Grease. It is recommended that you add some additional lubrication when the motor is installed.

Three options (brands) for suitable lubrication include, but are not limited to, the following:

- 1.) Mobil Polyrex EM
- 2.) Citco Polyurea MP
- 3.) Conoco Phillips Polytac EP



**PEXP444TS-125-2**







**EXPLOSION PROOF ELECTRIC MOTOR**  
**NEMA PREMIUM EFFICIENCY**  
**TOTALLY ENCLOSED FAN COOLED; EXPLOSION PROOF ENCLOSURE**  
**CLASS I DIVISION I GROUP C & D; CLASS II DIVISION I GROUP F & G**  
**OPERATING TEMP CODE T3C**

**PERFORMANCE DATA**

HP	RPM	Frame	Voltage	Frequency (Hz)	Full Load S.F.	Insulation Class	NEMA Design	Slip (%)	NEMA Code	Enclosure Type	IP Rating	Max. Ambient	Oper Temp Code	Max. KVAR
125	3586	444TS	460	60	1.15	F	B	0.4	G	TEXP	55	40° C	T3C	24.9

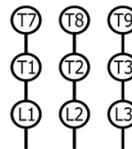
Amps (460V)		Max. Amps (208V)	Efficiency (%)				Power Factor			Torque (ft-lb)			DE Bearing	ODE Bearing	Connection	Weight (lbs.)
FLA	LRA	60HZ	100%	75%	50%	Min.	100%	75%	50%	FLT	LRT %	BDT %				
130.0	908	287.5	95.0	94.8	94.2	94.1	0.89	0.87	0.88	184.1	100	200	6314	6314	6 Lead Δ	1638

**NAME PLATE**

 <b>North American Electric, Inc.</b>															<b>CONNECTION DIAGRAMS</b> <b>ACROSS THE LINE</b> 				
<b>PREMIUM EFFICIENT EXPLOSION PROOF MOTOR</b>																			
CAT NO: PEXP444TS-125-2			FRAME 444TS			PHASE 3													
DE BRG 6314		ODE BRG 6314		CONN. 6 Lead Δ															
MAX AMB. 40° C		INS. CLASS F		RATING CONT		WEIGHT 1638													
USABLE ON 208V 60HZ AT 287.5						MAX AMPS		SER											
DIVISION 1 CLASS I GROUP C D CLASS II GROUP F G								OPER TEMP CODE T3C											
60 HERTZ DATA	HP 125		RPM 3586		HP 125		RPM 2988		50 HERTZ DATA										
	VOLTS 460				VOLTS 380														
	F.L. AMPS 130				F.L. AMPS 157														
	S.F. AMPS 149.5				S.F. AMPS 157														
	S.F. 1.15 DESIGN B CODE G				S.F. 1.0 DESIGN B CODE H														
	NEMA NOM.EFF. 95.0 % P.F. 0.89				NEMA NOM.EFF. 95.0 % P.F. 0.89														
	NEMA MIN.EFF. 94.1 %				NEMA MIN.EFF. 94.0 %														
MAX. KVAR 24.9		LUB. Mobil Polyrex EM																	
<small>General purpose use on industrial machinery installed in damp, dusty or dirty environments. These motors are designed for use in hazardous locations defined by class and group.</small>																			
  										CC 041B									
Hernando, Mississippi																			

	<b>ELECTRIC MOTORS FOR HAZARDOUS LOCATIONS</b>
	<b>CLASS I DIVISION I GROUP C D, CLASS II DIVISION I GROUP F G</b>
	<b>NO. CCXXXXX E310089</b>

**APPLICATIONS:**

General purpose use on pumps, fans, blowers, compressors, conveyors, material handling and other industrial machinery installed in damp, dusty or dirty environments. These motors are designed to be used in hazardous locations as defined by class and group.