

PEXP254T-15-4

EXPLOSION PROOF ELECTRIC MOTOR

NEMA PREMIUM EFFICIENCY

TOTALLY ENCLOSED FAN COOLED; EXPLOSION PROOF ENCLOSURE

CLASS I DIVISION I GROUP C & D; CLASS II DIVISION I GROUP F & G

OPERATING TEMP CODE T3C

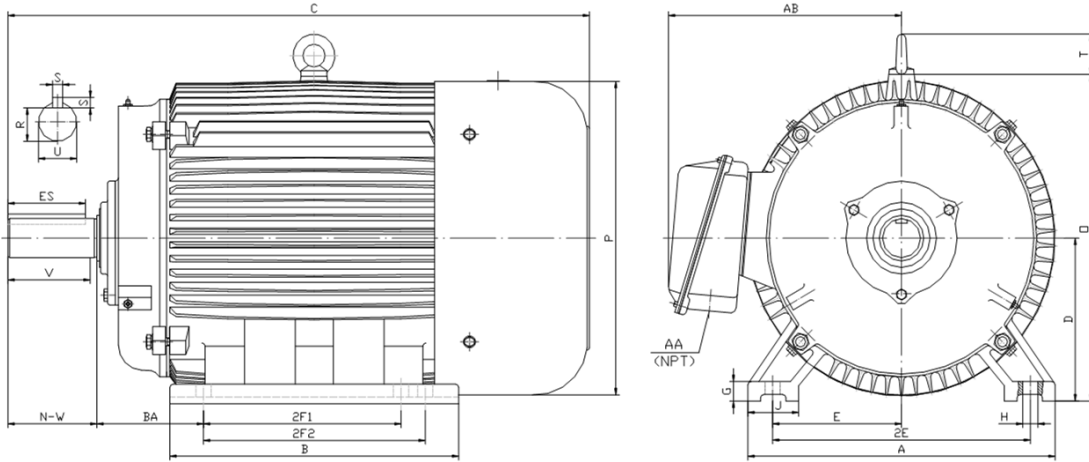

DIMENSIONS

HP	RPM	Frame	MOUNTING														
			A	B	C	D	G	H	J	E	2E	2F1	2F2	O	P	T	BA
15	1800	254T	13.00	12.20	23.20	6.25	0.70	0.53	2.75	5.00	10.00	8.25	0.00	13.20	12.80	2.20	4.25

Shaft Extension, Key Set						Conduit Box		Bearings		Mount
U	V	R	S	ES	N-W	AA	AB	DE	ODE	
1.63	3.75	1.42	0.38	2.91	4.00	1.25	10.30	6309	6309	F1

BEARING LUBRICATION: The bearings come lubricated with Mobil Polyrex EM Polyurea Grease. It is recommended that you add some additional lubrication when the motor is installed.

Three options (brands) for suitable lubrication include, but are not limited to, the following:

- 1.) Mobil Polyrex EM
- 2.) Citco Polyurea MP
- 3.) Conoco Phillips Polytac EP









PEXP254T-15-4
EXPLOSION PROOF ELECTRIC MOTOR
NEMA PREMIUM EFFICIENCY
TOTALLY ENCLOSED FAN COOLED; EXPLOSION PROOF ENCLOSURE
CLASS I DIVISION I GROUP C & D; CLASS II DIVISION I GROUP F & G
OPERATING TEMP CODE T3C
PERFORMANCE DATA

HP	RPM	Frame	Voltage	Frequency (Hz)	Full Load S.F.	Insulation Class	NEMA Design	Slip (%)	NEMA Code	Enclosure Type	IP Rating	Max. Ambient	Oper Temp Code	Max. KVAR
15	1778	254T	208-230/460	60	1.15	F	B	1.2	G	TEXP	55	40° C	T3C	1.2

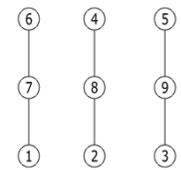
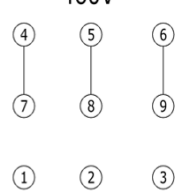
Amps (460V)		Max. Amps (208V)	Efficiency (%)				Power Factor			Torque (ft-lb)			DE Bearing	ODE Bearing	Connection	Weight (lbs.)
FLA	LRA	60HZ	100%	75%	50%	Min.	100%	75%	50%	FLT	LRT %	BDT %				
17.5	116.0	38.7	92.4	90.0	89.0	91.0	0.87	0.86	0.78	44.6	160	200	6309	6309	9 Lead 2Δ/Δ	403

NAME PLATE

 North American Electric, Inc.												CONNECTION DIAGRAMS 208V-230V 									
PREMIUM EFFICIENT EXPLOSION PROOF MOTOR																					
CAT NO: PEXP254T-15-4				FRAME 254T				PHASE 3				460V 									
DE BRG 6309		ODE BRG 6309		CONN. 9 Lead 2Δ/Δ																	
MAX AMB. 40° C		INS. CLASS F		RATING CONT		WEIGHT 403				60 HERTZ DATA											
USABLE ON 208V 60HZ AT 38.7 MAX AMPS				SER				OPER TEMP CODE T3C													
DIVISION 1 CLASS I GROUP C D CLASS II GROUP F G																					
HP 15		RPM 1778		HP 15		RPM 1482										50 HERTZ DATA					
VOLTS 208-230/460				VOLTS 190/380																	
F.L. AMPS 38.7 - 35 / 17.5				F.L. AMPS 42.4/21.2																	
S.F. AMPS 20.1				S.F. AMPS 42.4/21.2																	
S.F. 1.15 DESIGN B CODE G				S.F. 1.0 DESIGN B CODE H																	
NEMA NOM.EFF. 92.4 % P.F. 0.87				NEMA NOM.EFF. 91.5 % P.F. 0.87																	
NEMA MIN.EFF. 91.0 %				NEMA MIN.EFF. 89.8 %																	
MAX. KVAR 1.2		LUB. Mobil Polyrex EM																			
<small>General purpose use on industrial machinery installed in damp, dusty or dirty environments. These motors are designed for use in hazardous locations defined by class and group.</small>												   CC 041B									
Hernando, Mississippi																					

	ELECTRIC MOTORS FOR HAZARDOUS LOCATIONS CLASS I DIVISION I GROUP C D, CLASS II DIVISION I GROUP F G NO. CCXXXXX E310089
---	--

APPLICATIONS:

General purpose use on pumps, fans, blowers, compressors, conveyors, material handling and other industrial machinery installed in damp, dusty or dirty environments. These motors are designed to be used in hazardous locations as defined by class and group.