

**PEXP215T-10-4**

EXPLOSION PROOF ELECTRIC MOTOR

NEMA PREMIUM EFFICIENCY

TOTALLY ENCLOSED FAN COOLED; EXPLOSION PROOF ENCLOSURE

CLASS I DIVISION I GROUP C & D; CLASS II DIVISION I GROUP F & G

OPERATING TEMP CODE T3C

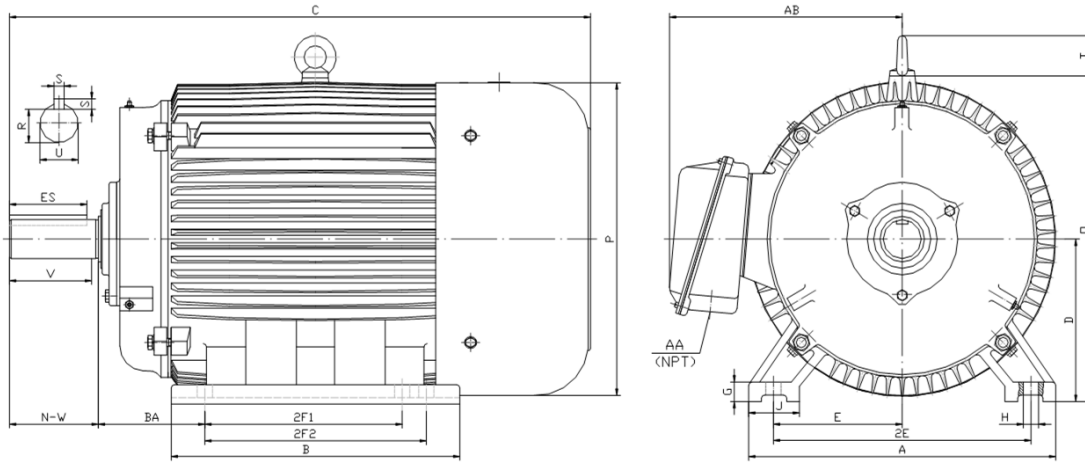

**DIMENSIONS**

HP	RPM	Frame	MOUNTING														
			A	B	C	D	G	H	J	E	2E	2F1	2F2	O	P	T	BA
10	1770	215T	11.00	9.40	20.40	5.25	0.70	0.41	2.40	4.25	8.50	5.50	7.00	11.20	11.60	1.90	3.50

Shaft Extension, Key Set						Conduit Box		Bearings		Mount
U	V	R	S	ES	N-W	AA	AB	DE	ODE	
1.375	3.120	1.201	0.312	2.410	3.380	1.00	9.00	6308-ZZ	6308-ZZ	F1

**BEARING LUBRICATION:** The bearings come lubricated with Mobil Polyrex EM Polyurea Grease.









**PEXP215T-10-4**
**EXPLOSION PROOF ELECTRIC MOTOR**
**NEMA PREMIUM EFFICIENCY**
**TOTALLY ENCLOSED FAN COOLED; EXPLOSION PROOF ENCLOSURE**
**CLASS I DIVISION I GROUP C & D; CLASS II DIVISION I GROUP F & G**
**OPERATING TEMP CODE T3C**
**PERFORMANCE DATA**

HP	RPM	Frame	Voltage	Frequency (Hz)	Full Load S.F.	Insulation Class	NEMA Design	Slip (%)	NEMA Code	Enclosure Type	IP Rating	Max. Ambient	Oper Temp Code	Max. KVAR
10	1772	215T	208-230/460	60	1.15	F	B	1.6	H	TEXP	55	40° C	T3C	3

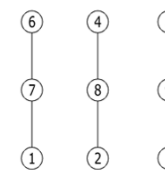
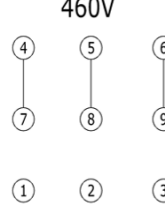
Amps (460V)		Max. Amps (208V)	Efficiency (%)				Power Factor			Torque (ft-lb)			DE Bearing	ODE Bearing	Connection	Weight (lbs.)
FLA	LRA	60HZ	100%	75%	50%	Min.	100%	75%	50%	FLT	LRT %	BDT %	6308-ZZ	6308-ZZ	9 Lead 2Δ/Δ	262
12.2	81.0	27.0	91.7	92.0	90.0	90.2	0.86	0.86	0.78	29.8	165	200				

**NAME PLATE**

 <b>North American Electric, Inc.</b>												<b>PREMIUM EFFICIENT EXPLOSION PROOF MOTOR</b>						<b>CONNECTION DIAGRAMS</b>					
CAT NO: PEXP215T-10-4			FRAME 215T			PHASE 3			<b>208V-230V</b>														
DE BRG 6308-ZZ		ODE BRG 6308-ZZ		CONN. 9 Lead 2Δ/Δ																			
MAX AMB. 40° C		INS. CLASS F		RATING CONT		WEIGHT 262																	
USABLE ON 208V 60HZ AT 27.0			MAX AMPS			SER																	
DIVISION 1 CLASS I GROUP C D CLASS II GROUP F G						OPER TEMP CODE T3C																	
<b>60 HERTZ DATA</b>						HP 10		RPM 1772		HP 10		RPM 1477		<b>50 HERTZ DATA</b>									
						VOLTS 208-230/460				VOLTS 190/380													
						F.L. AMPS 27 - 24.4 / 12.2				F.L. AMPS 29.5/14.8													
						S.F. AMPS 14.0				S.F. AMPS 29.5/14.8													
						S.F. 1.15 DESIGN B CODE H				S.F. 1.0 DESIGN B CODE H													
						NEMA NOM.EFF. 91.7 % P.F. 0.86				NEMA NOM.EFF. 90.4 % P.F. 0.86													
						NEMA MIN.EFF. 90.2 %				NEMA MIN.EFF. 88.5 %													
MAX. KVAR 3				LUB. Mobil Polyrex EM																			
<small>General purpose use on industrial machinery installed in damp, dusty or dirty environments. These motors are designed for use in hazardous locations defined by class and group.</small>												   <span style="float: right;">CC 041B</span>											
Hernando, Mississippi																							

	<b>ELECTRIC MOTORS FOR HAZARDOUS LOCATIONS</b> CLASS I DIVISION I GROUP C D, CLASS II DIVISION I GROUP F G NO. CCXXXXX E310089
---	--

**APPLICATIONS:**

General purpose use on pumps, fans, blowers, compressors, conveyors, material handling and other industrial machinery installed in damp, dusty or dirty environments. These motors are designed to be used in hazardous locations as defined by class and group.