

PR182T5M2A-ODP

GENERAL PURPOSE ELECTRIC MOTOR
NEMA PREMIUM EFFICIENCY
OPEN DRIP PROOF ENCLOSURE
ROLLED STEEL CONSTRUCTION
INVERTER RATED (10:1 VT; 5:1 CT)

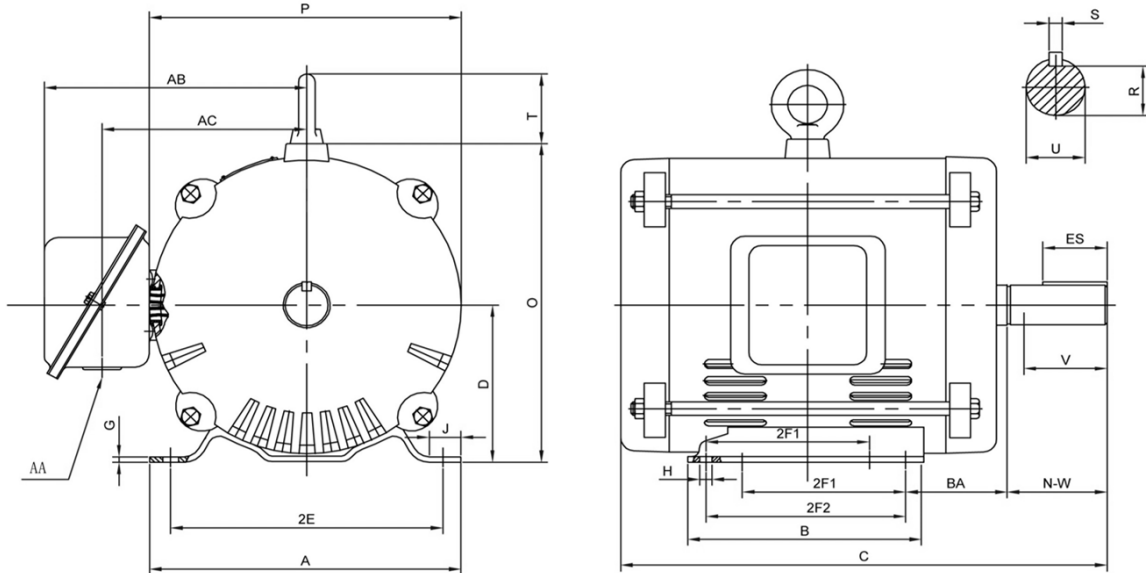

DIMENSIONS

HP	RPM	Frame	MOUNTING														
			A	B	C	D	G	H	J	E	2E	2F1	2F2	O	P	T	BA
5	3600	182T	8.50	6.50	13.80	4.50	0.16	0.43	0.95	3.75	7.50	4.50	5.50	9.25	8.66	2.00	2.75

Shaft Extension, Key Set						Conduit Box		Bearings		Mount
U	V	R	S	ES	N-W	AA	AB	DE	ODE	
1.13	2.50	0.99	0.25	1.75	2.75	1.10	7.30	6206	6206	

BEARING LUBRICATION: The bearings come lubricated with Mobil Polyrex EM Polyurea Grease.



PR182T5M2A-ODP

GENERAL PURPOSE ELECTRIC MOTOR
NEMA PREMIUM EFFICIENCY
OPEN DRIP PROOF ENCLOSURE
ROLLED STEEL CONSTRUCTION
INVERTER RATED (10:1 VT; 5:1 CT)

PERFORMANCE DATA

HP	RPM	Frame	Voltage	Frequency (Hz)	Full Load S.F.	Insulation Class	NEMA Design	Slip (%)	NEMA Code	Enclosure Type	IP Rating	Max. Ambient
5	3510	182T	208-230/460	60	1.15	F	B	0.025	G	ODP	IP23	40°C

Amps (460V)		Efficiency (%)			Power Factor			Torque (ft-lb)			DE Bearing	ODE Bearing	Connection	Weight (lbs.)
FLA	LRA	100%	75%	50%	100%	75%	50%	FLT	LRT %	BDT %				
6.4	38.1	88.2	88.6	87.5	0.84	0.79	0.69	10.16	178	263	6206-2RZC3	6206-2RZC3	9 Lead Y	71

NAME PLATE													
North American Electric, Inc.						GENERAL PURPOSE NEMA Premium OPEN DRIP PROOF							
THREE PHASE ELECTRIC MOTOR													
MODEL	HP	5		RPM	3510		FRAME	182T					
PR182T5M2A-ODP	ENCL	ODP		HZ	60		PHASE	3					
VOLT	208-230/460		AMPS	13.6-12.4/6.2		S.F.	1.15		DESIGN	B			
S.F. AMPS	15.6-14.3/7.1		CLASS	F		CODE	G		LBS	0			
DE BEARING	6206-2RZC3												
ODE BEARING	6206-2RZC3												
RATING	CONT	MAX AMB. 40°C											
SER													
<div style="display: flex; justify-content: space-around; align-items: center;"> <div style="text-align: center;"> <p>230V LINE</p> </div> <div style="text-align: center;"> <p>460V LINE</p> </div> </div>													
Hernando, MS www.naemotors.com													

APPLICATIONS:

General purpose use on pumps, fans, blowers, compressors, conveyors, material handling and other industrial machinery where contaminants are minimal.