

**PE449T-250-4C**

GENERAL PURPOSE ELECTRIC MOTOR

HIGH EFFICIENCY / EISA COMPLIANT

TOTALLY ENCLOSED FAN COOLED

INVERTER DUTY 10:1 CT; 20:1 VT - NEMA MG1 PART 31

Factory Certified for T2B Class I, Division II, Groups A,B,C & D and Class II, Division II, Groups F & G

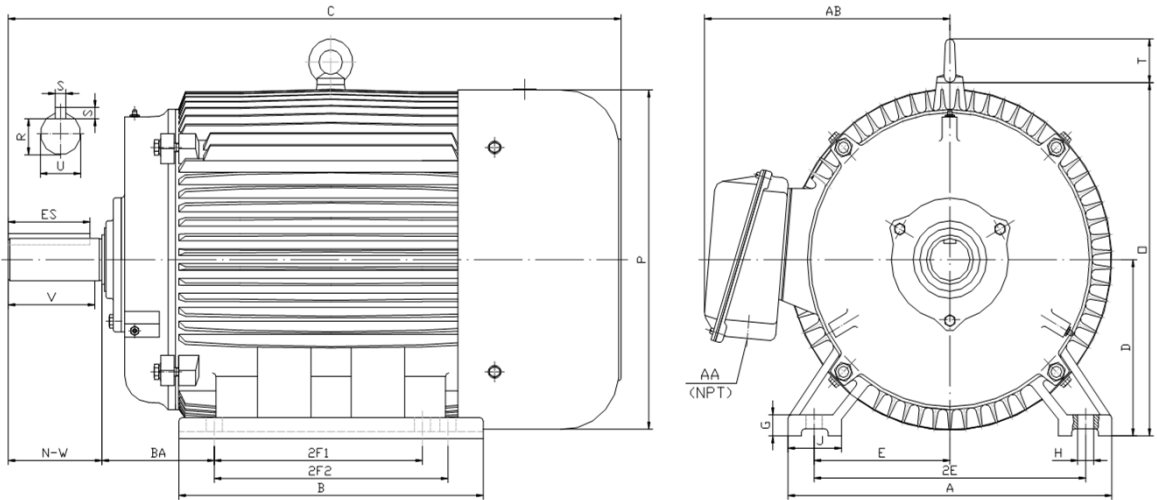

**DIMENSIONS**

HP	RPM	Frame	MOUNTING														
			A	B	C	D	G	H	J	E	2E	2F1	2F2	O	P	T	BA
250	1800	449T	21.70	31.40	52.80	11.00	1.35	0.81	3.35	9.00	18.00	20.00	25.00	23.00	23.40	3.00	7.50

Shaft Extension, Key Set						Conduit Box		Bearings		Mount
U	V	R	S	ES	N-W	AA	AB	DE	ODE	
3.38	8.25	2.88	0.88	6.91	8.50	3.00	19.90	NU319	6318	F1

**BEARING LUBRICATION:** The bearings come lubricated with Mobil Polyrex EM Polyurea Grease. It is recommended that you add some additional lubrication when the motor is installed.

Three options (brands) for suitable lubrication include, but are not limited to, the following:

- 1.) Mobil Polyrex EM
- 2.) Citco Polyurea MP
- 3.) Conoco Phillips Polytac EP





## PE449T-250-4C

**GENERAL PURPOSE ELECTRIC MOTOR**

**HIGH EFFICIENCY / EISA COMPLIANT**

**TOTALLY ENCLOSED FAN COOLED**

**INVERTER DUTY 10:1 CT; 20:1 VT - NEMA MG1 PART 31**

Factory Certified for T2B Class I, Division II, Groups A,B,C & D and Class II, Division II, Groups F & G

### PERFORMANCE DATA

HP	RPM	Frame	Voltage	Frequency (Hz)	Full Load S.F.	Insulation Class	NEMA Design	Slip (%)	NEMA Code	Enclosure Type	IP Rating	Max. Ambient
250	1790	449T	460	60	1.15	F	C	0.6	G	TEFC	55	40° C

Amps (460V)		Efficiency (%)				Power Factor			Torque (ft-lb)			DE Bearing	ODE Bearing	Connection	Weight (lbs.)
FLA	LRA	100%	75%	50%	Min.	100%	75%	50%	FLT	LRT %	BDT %				
283.0	1825	95.0	94.5	94.0	94.1	0.87	0.86	2.83	738.0	200	230	NU319	6318	6 Lead Δ	2120

### NAME PLATE

<p><b>North American Electric, Inc.</b></p> <p><b>HIGH EFFICIENCY EISA COMPLIANT</b></p> <p>INVERTER DUTY 20:1 VT; 10:1 CT</p>										<p><b>CONNECTION DIAGRAMS (460V)</b></p>		
<p>CAT NO: PE449T-250-4C      FRAME 449T      PHASE 3</p>										<p>ACROSS THE LINE</p>		
HZ 60	S.F. 1.15	HZ 50	S.F. 1.0	ENCL TEFC	IP 55				<p>PWS START</p>			
HP 250	RPM 1790	HP 250	RPM 1488	DUTY CONT	DES C				<p>PWS RUN</p>			
VOLTS 460		VOLTS 380		AMB 40° C	INS F							
FLA 283.0		FLA 348		DE BEARING NU319								
CODE G	P.F. 0.87	CODE D	P.F. 0.87	ODE BEARING 6318								
EFF 95.0	MIN 94.1	EFF 93.5	MIN 92.4	LUB: Mobil Polyrex EM								
MOTOR WEIGHT 2120 LBS		CONNECTION 6 Lead Δ			SER NO							
<p>General purpose use on industrial machinery installed in damp, dusty or dirty environments.</p> <p>Hernando, Mississippi</p>										<p>ISO9001 CERTIFIED      CE      SP US      CC 082A</p>		

### APPLICATIONS:

General purpose use on pumps, fans, blowers, compressors, conveyors, material handling and other industrial machinery installed in damp, dusty or dirty environments.