

PE184T-5-2

GENERAL PURPOSE ELECTRIC MOTOR

NEMA PREMIUM EFFICIENCY

TOTALLY ENCLOSED FAN COOLED

INVERTER DUTY 10:1 CT; 20:1 VT - NEMA MG1 PART 31

Factory Certified for T2B Class I, Division II, Groups A,B,C & D and Class II, Division II, Groups F & G

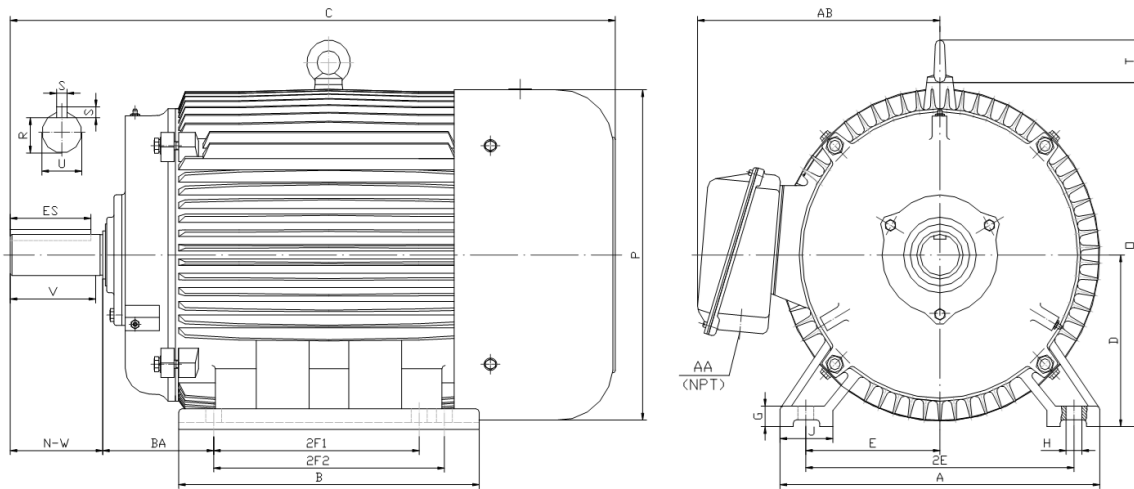

DIMENSIONS

| HP | RPM | Frame | MOUNTING | | | | | | | | | | | | | | |
|----|------|-------|----------|------|-------|------|------|------|------|------|------|------|------|------|------|------|------|
| | | | A | B | C | D | G | H | J | E | 2E | 2F1 | 2F2 | O | P | T | BA |
| 5 | 3600 | 184T | 9.50 | 8.30 | 17.10 | 4.50 | 0.60 | 0.41 | 2.00 | 3.75 | 7.50 | 4.50 | 5.50 | 9.10 | 8.70 | 1.60 | 2.75 |

| Shaft Extension, Key Set | | | | | | Conduit Box | | Bearings | | Mount |
|--------------------------|------|-------|-------|------|------|-------------|------|----------|---------|-------|
| U | V | R | S | ES | N-W | AA | AB | DE | ODE | |
| 1.125 | 2.50 | 0.986 | 0.250 | 1.78 | 2.75 | 0.75 | 7.50 | 6306-ZZ | 6306-ZZ | F1 |

BEARING LUBRICATION: The bearings come lubricated with Mobil Polyrex EM Polyurea Grease.





PE184T-5-2

GENERAL PURPOSE ELECTRIC MOTOR

NEMA PREMIUM EFFICIENCY

TOTALLY ENCLOSED FAN COOLED

INVERTER DUTY 10:1 CT; 20:1 VT - NEMA MG1 PART 31







Factory Certified for T2B Class I, Division II, Groups A,B,C & D and Class II, Division II, Groups F & G

PERFORMANCE DATA

| HP | RPM | Frame | Voltage | Frequency (Hz) | Full Load S.F. | Insulation Class | NEMA Design | Slip (%) | NEMA Code | Enclosure Type | IP Rating | Max. Ambient |
|----|------|-------|-------------|----------------|----------------|------------------|-------------|----------|-----------|----------------|-----------|--------------|
| 5 | 3515 | 184T | 208-230/460 | 60 | 1.15 | F | B | 2.4 | J | TEFC | 55 | 40° C |

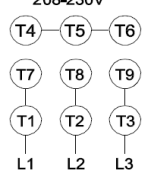
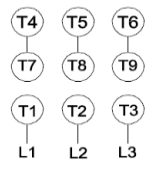
| Amps (460V) | | Efficiency (%) | | | | Power Factor | | | Torque (ft-lb) | | | DE Bearing | ODE Bearing | Connection | Weight (lbs.) |
|-------------|-----|----------------|------|------|------|--------------|-------|-------|----------------|-------|-------|------------|-------------|-------------|---------------|
| FLA | LRA | 100% | 75% | 50% | Min. | 100% | 75% | 50% | FLT | LRT % | BDT % | | | | |
| 5.8 | 46 | 88.5 | 88.0 | 86.5 | 86.5 | 0.900 | 0.850 | 0.750 | 7.5 | 170 | 285 | 6306-ZZ | 6306-ZZ | 9 Lead 2Y/Y | 102 |

NAME PLATE

| | | | | | | | | | | | | | | | | | |
|--|-----------------|-------------|------------|------|-------------|------|---------|-------------|-------|---|-----|---|--|---|--|---------|--|
|  North American Electric, Inc. | | | | | | | | | |  | | | | | CONNECTION DIAGRAMS 208-230V  | | |
| INVERTER DUTY 20:1 VT; 10:1 CT | | | | | | | | | | | | | | | | | |
| CAT NO: | | PE184T-5-2 | | | FRAME | | 184T | | PHASE | | 3 | | 460V  | | | | |
| HZ | 60 | S.F. | 1.15 | HZ | 50 | S.F. | 1.0 | ENCL | TEFC | IP | 55 | | | | | | |
| HP | 5 | RPM | 3515 | HP | 5 | RPM | 2900 | DUTY | CONT | DES | B | | | | | | |
| VOLTS | | 208-230/460 | | | VOLTS | | 190/380 | | AMB | 40° C | INS | F | | | | | |
| FLA | 13 - 11.6 / 5.8 | | | FLA | 14/7 | | | DE BEARING | | 6306-ZZ | | | | | | | |
| CODE | J | P.F. | 0.90 | CODE | F | P.F. | 0.92 | ODE BEARING | | 6306-ZZ | | | | | | | |
| EFF | 88.5 | MIN | 86.5 | EFF | 86.5 | MIN | 84.5 | LUB: | | Mobil Polyrex EM | | | | | | | |
| MOTOR WEIGHT | 102 | LBS | CONNECTION | | 9 Lead 2Y/Y | | | SER NO | | | | | | | | | |
| General purpose use on industrial machinery installed in damp, dusty or dirty environments. Hernando, Mississippi | | | | | | | | | |  | |  | |  | | CC 082A | |

APPLICATIONS:

General purpose use on pumps, fans, blowers, compressors, conveyors, material handling and other industrial machinery installed in damp, dusty or dirty environments.