

# Product Information Packet

November 7, 2016

Data shown is for the current revision model #. Ensure your nameplate model # matches.

<b>Model Number:</b>	<b>5KS324ATE205RG3</b>
<b>Catalog Number:</b>	<b>E7072</b>
<b>Instruction Manual:</b>	GEI-M1023
<b>Connection Diagram:</b>	GEM2034E-FIG10
<b>Outline Drawing:</b>	358B6218AE

Accessory Connection Diagrams			
<b>Bearing Thermocouple:</b>	None	<b>Heater:</b>	None
<b>RTD:</b>	None	<b>Thermistor:</b>	None
<b>Thermostat:</b>	None	<b>Winding Thermocouple:</b>	None
<b>Bearing RTD:</b>	None		

Table of Contents	
Specification	01
Performance Characteristics	02
Outline Drawing	03
Connection Drawing(s)	04

**Marks:**

<b>MODEL NUMBER:</b>	<b>5KS324ATE205RG3</b>	<b>Estimated Weight:</b>	650 Lbs
<b>Outline Drawing:</b>	358B6218AE	<b>Time Rating:</b>	CONT
<b>Connection Diagram:</b>	GEM2034E-FIG10	<b>Enclosure:</b>	DP
<b>Instruction Book:</b>	GEI-M1023	<b>Encl Construction:</b>	OPEN
<b>Design Code:</b>	32AD1005A	<b>Ambient Max(°C):</b>	40
<b>Type:</b>	KS	<b>Alt Ambient Max(°C):</b>	--
<b>Frame:</b>	324T	<b>Insulation Class:</b>	F
<b>Phases:</b>	3	<b>NEMA Design:</b>	A
<b>Poles:</b>	4	<b>Nominal Efficiency:</b>	94.1 %
<b>Output Power:</b>	40HP 29.6KW	<b>Guaranteed Efficiency:</b>	93.0
<b>RPM:</b>	1780	<b>3/4 Load Efficiency:</b>	94.3
<b>Voltage:</b>	230/460	<b>KVA Code:</b>	H
<b>Hertz:</b>	60	<b>Max KVAR:</b>	12.6
<b>Amps - FL:</b>	97/48.5	<b>Power Factor:</b>	82
<b>Service Factor:</b>	1.15	<b>Bearing - DE:</b>	6312
<b>Alt Service Factor:</b>	--	<b>Bearing - ODE:</b>	6312

Enclosure is Dripproof

---

**Stamped Nameplate Notes:****Additional Information:**

MADE FROM MODEL 5KS324ATE205  
 ADD AEGIS GROUND RING  
 MOD AMSTUTZ 15-NOV-2011

**Performance Characteristics**

1st Winding 1st Connection

**Design: 32AD1005A**

**Marks:**

LOAD %	125.0	115.0	100.0	75.0	50.0	25.0	0.0
% EFF	93.71	93.95	94.42	94.34	93.66	90.23	0.00
% PF	84.92	84.75	84	80.8	72.62	51.72	5.53
AMPS	58.81	54.07	47.2	36.84	27.52	20.06	16.3

<b>TORQ(FL)#FT</b>	117.97	<b>TORQ(LR)%FL</b>	201.02	<b>TORQ(BD)%FL</b>	301.44
<b>AMPS(LR)</b>	344.29	<b>PF AT START</b>	0.32		

This motor is capable of two cold or one hot start with a maximum connected load inertia of 1163 Lb-Ft Sq (48.96 Kg-meter Sq)at 100% voltage, where the load torque varies with the square of the speed. Acceleration time with maximum inertia and the above load type is 38 seconds. Safe stall time at 100% voltage is 64 seconds cold, 54 seconds hot. Rotor inertia is 7.11 Lb-Ft Sq (0.3 Kg-meter Sq).

<b>Open Circuit A-C:</b>	0.683	<b>Short Circuit D-C:</b>	0.023
<b>Short Circuit A-C:</b>	0.03	<b>X/R Ratio:</b>	8.671
<b>Stator Slots:</b>	48	<b>Rotor Slots:</b>	40

**Speed Torque Current Curve (First Connection, First Speed)**

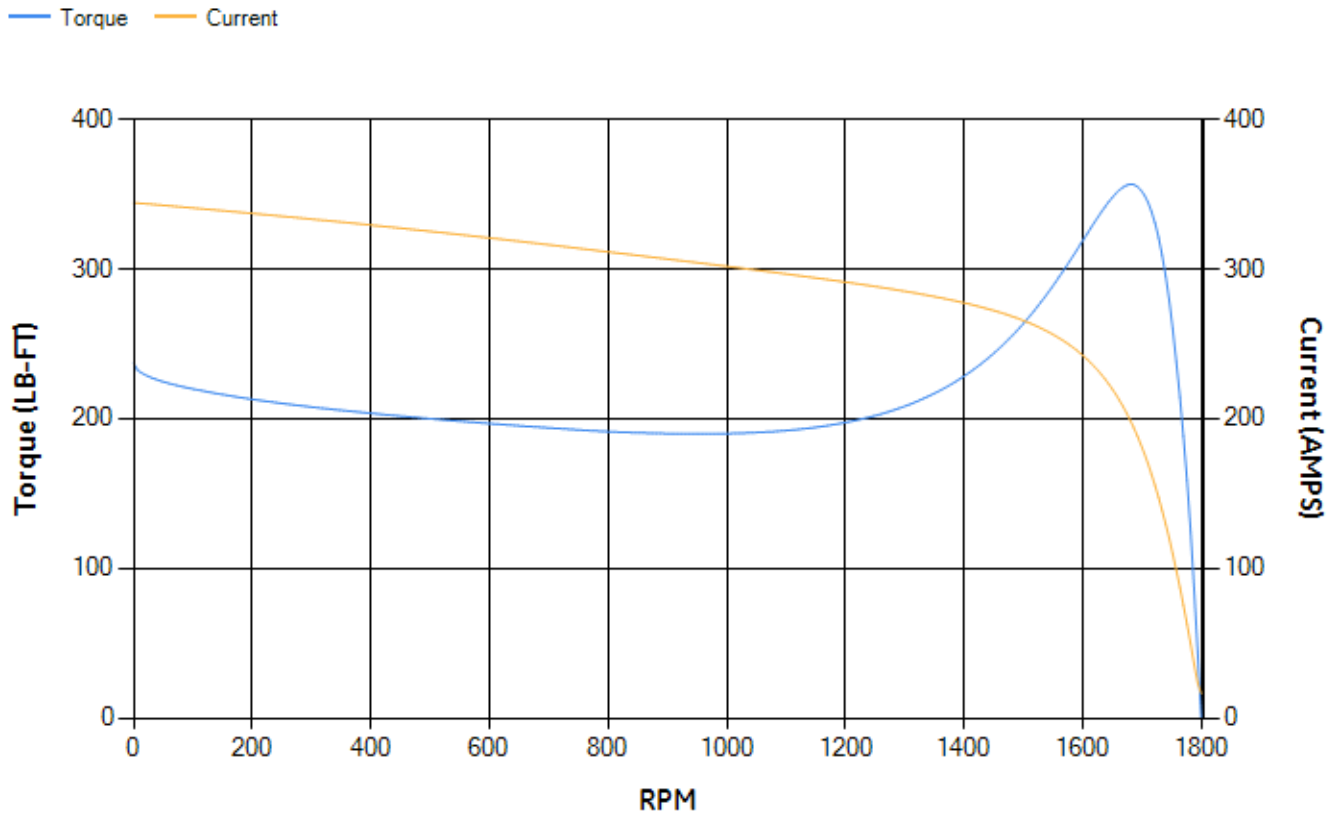

Marks:

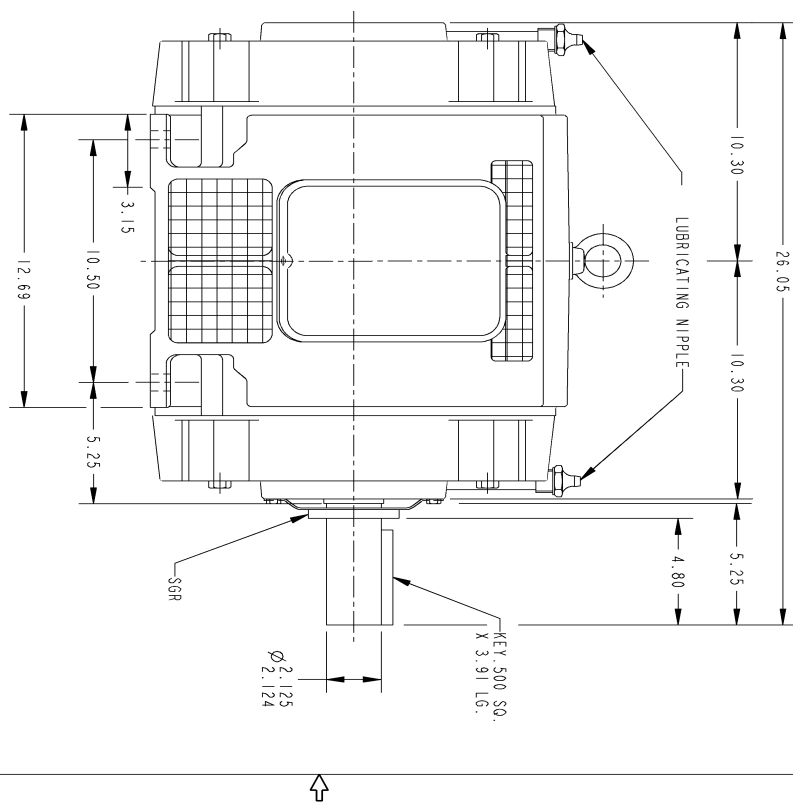
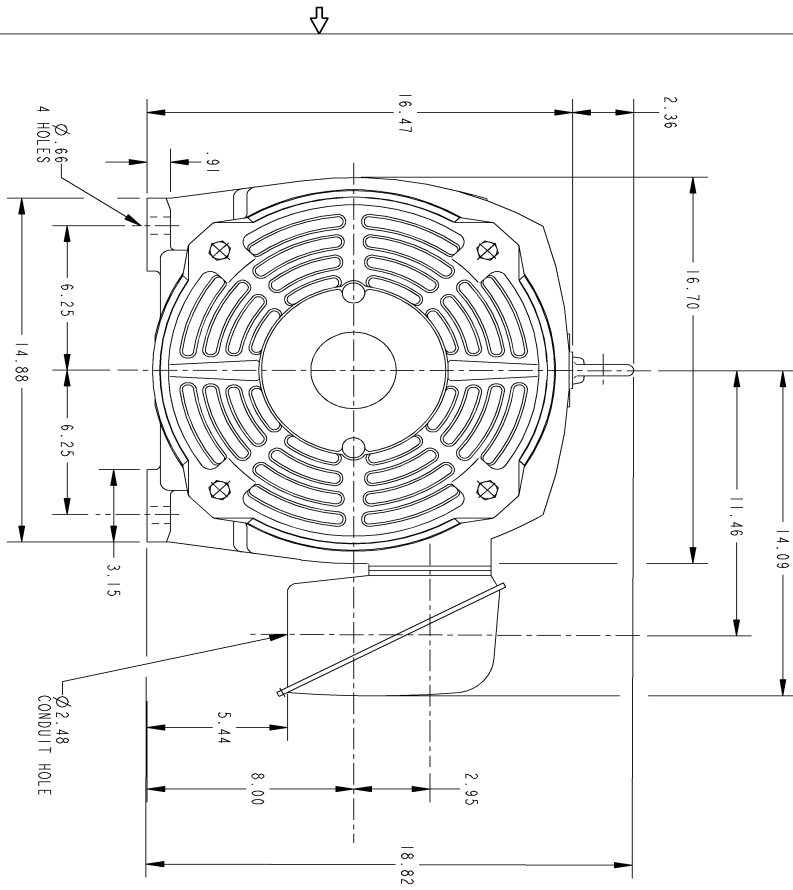

- NOTES :
1. CONDUIT BOX MAY BE PLACED WITH THE ENTRANCE DOWN, UP OR ON EITHER SIDE.
  2. F-1 ASW AS SHOWN.
  3. F-2 ASW - HAS CONDUIT BOX ON OPPOSITE SIDE.

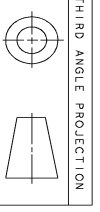

SIZE DRAWING NO. B		REV SHEET 1 1	
<b>358B6218AE</b>			
REVISIONS			
REV.	DESCRIPTION	DATE	APPROVED
1	ISAAC 15-0375	04/22/15	HARIKIRAN

SIGNATURES		DATE	
MODEL	VENKAT 01/04/12	<p><b>GENERAL ELECTRIC COMPANY</b></p> <p><b>OUTLINE</b></p> <p>324T - DRIPPROOF WITH SGR</p>	
DETAIL	VENKAT 01/04/12		
CHECKED	VENKAT J 01/04/12		
ENGR	VENKAT J 01/04/12		
QC			
QUALITY	VENKAT 01/04/12	SIZE DRAWING	B
ISSUED		SCALE: DRAWING SCALE	
SOLD MODEL	MODEL NAME	<b>358B6218AE</b>	REV 1
		SHEET 1	1

Marks:

**Connection Diagram**  
**GEM2034E-FIG10**

