

# Product Information Packet

November 7, 2016

Data shown is for the current revision model #. Ensure your nameplate model # matches.

|                            |                        |
|----------------------------|------------------------|
| <b>Model Number:</b>       | <b>5KS284ATE205AF2</b> |
| <b>Catalog Number:</b>     | <b>E7027</b>           |
| <b>Instruction Manual:</b> | GEI-M1023              |
| <b>Connection Diagram:</b> | GEM2034E-FIG10         |
| <b>Outline Drawing:</b>    | 358B6217AA             |

| Accessory Connection Diagrams |      |                              |      |
|-------------------------------|------|------------------------------|------|
| <b>Bearing Thermocouple:</b>  | None | <b>Heater:</b>               | None |
| <b>RTD:</b>                   | None | <b>Thermistor:</b>           | None |
| <b>Thermostat:</b>            | None | <b>Winding Thermocouple:</b> | None |
| <b>Bearing RTD:</b>           | None |                              |      |

| Table of Contents           |    |
|-----------------------------|----|
| Specification               | 01 |
| Performance Characteristics | 02 |
| Outline Drawing             | 03 |
| Connection Drawing(s)       | 04 |



**Marks:**

|                            |                        |                               |         |
|----------------------------|------------------------|-------------------------------|---------|
| <b>MODEL NUMBER:</b>       | <b>5KS284ATE205AF2</b> | <b>Estimated Weight:</b>      | 450 Lbs |
| <b>Outline Drawing:</b>    | 358B6217AA             | <b>Time Rating:</b>           | CONT    |
| <b>Connection Diagram:</b> | GEM2034E-FIG10         | <b>Enclosure:</b>             | DP      |
| <b>Instruction Book:</b>   | GEI-M1023              | <b>Encl Construction:</b>     | OPEN    |
| <b>Design Code:</b>        | 28AD1010A              | <b>Ambient Max(°C):</b>       | -20/40  |
| <b>Type:</b>               | KS                     | <b>Alt Ambient Max(°C):</b>   | --      |
| <b>Frame:</b>              | 284T                   | <b>Insulation Class:</b>      | F       |
| <b>Phases:</b>             | 3                      | <b>NEMA Design:</b>           | A       |
| <b>Poles:</b>              | 4                      | <b>Nominal Efficiency:</b>    | 93.6 %  |
| <b>Output Power:</b>       | 25HP 18.5KW            | <b>Guaranteed Efficiency:</b> | 92.4    |
| <b>RPM:</b>                | 1775                   | <b>3/4 Load Efficiency:</b>   | 94.0    |
| <b>Voltage:</b>            | 230/460                | <b>KVA Code:</b>              | H       |
| <b>Hertz:</b>              | 60                     | <b>Max KVAR:</b>              | 11.4    |
| <b>Amps - FL:</b>          | 66.2/33.1              | <b>Power Factor:</b>          | 75.5    |
| <b>Service Factor:</b>     | 1.15                   | <b>Bearing - DE:</b>          | 6312ZZ  |
| <b>Alt Service Factor:</b> | --                     | <b>Bearing - ODE:</b>         | 6310ZZ  |

Enclosure is Dripproof

---

**Stamped Nameplate Notes:****Additional Information:**

4 POLE DP  
 LRA: 443.6/221.8  
 NO. OF MOTOR LEADS: 12  
 CONDUIT BOX VOLUME (IN<sup>3</sup>): 244  
 CONDUIT BOX MTL: STAMPED STEEL  
 GREASE TYPE: SHELL ALVANIA R3 LITHIUM GREASE  
 USABLE AT 200V @ 25HP, 69.7 AMPS @1.0 SF  
 50HZ DATA; 25HP, 200/400V, 76.2/38.1 AMPS AT 1.0SF, 1475 RPM  
 SOUND POWER: 74.5  
 DMK, 06/04, DATA UPDATED 11/2004  
 INVERTER DUTY PER NEMA MG1 PART 31  
 FOR VARIABLE TORQUE LOADS

**Performance Characteristics**

1st Winding 1st Connection

**Design: 28AD1010A**

**Marks:**

| LOAD % | 125.0 | 115.0 | 100.0 | 75.0  | 50.0  | 25.0  | 0.0   |
|--------|-------|-------|-------|-------|-------|-------|-------|
| % EFF  | 93.64 | 93.82 | 94.2  | 93.95 | 93.02 | 88.98 | 0.00  |
| % PF   | 80.83 | 80.04 | 78.24 | 72.74 | 61.67 | 40.03 | 4.49  |
| AMPS   | 38.64 | 35.83 | 31.75 | 25.68 | 20.4  | 16.42 | 14.54 |

|             |        |             |        |             |        |
|-------------|--------|-------------|--------|-------------|--------|
| TORQ(FL)#FT | 73.77  | TORQ(LR)%FL | 252.22 | TORQ(BD)%FL | 287.66 |
| AMPS(LR)    | 211.89 | PF AT START | 0.37   |             |        |

This motor is capable of two cold or one hot start with a maximum connected load inertia of 995 Lb-Ft Sq (41.89 Kg-meter Sq)at 100% voltage, where the load torque varies with the square of the speed. Acceleration time with maximum inertia and the above load type is 43 seconds. Safe stall time at 100% voltage is 73 seconds cold, 65 seconds hot. Rotor inertia is 3.85 Lb-Ft Sq (0.16 Kg-meter Sq).

|                    |       |                    |       |
|--------------------|-------|--------------------|-------|
| Open Circuit A-C:  | 0.463 | Short Circuit D-C: | 0.023 |
| Short Circuit A-C: | 0.027 | X/R Ratio:         | 8.718 |
| Stator Slots:      | 48    | Rotor Slots:       | 40    |

**Speed Torque Current Curve (First Connection, First Speed)**

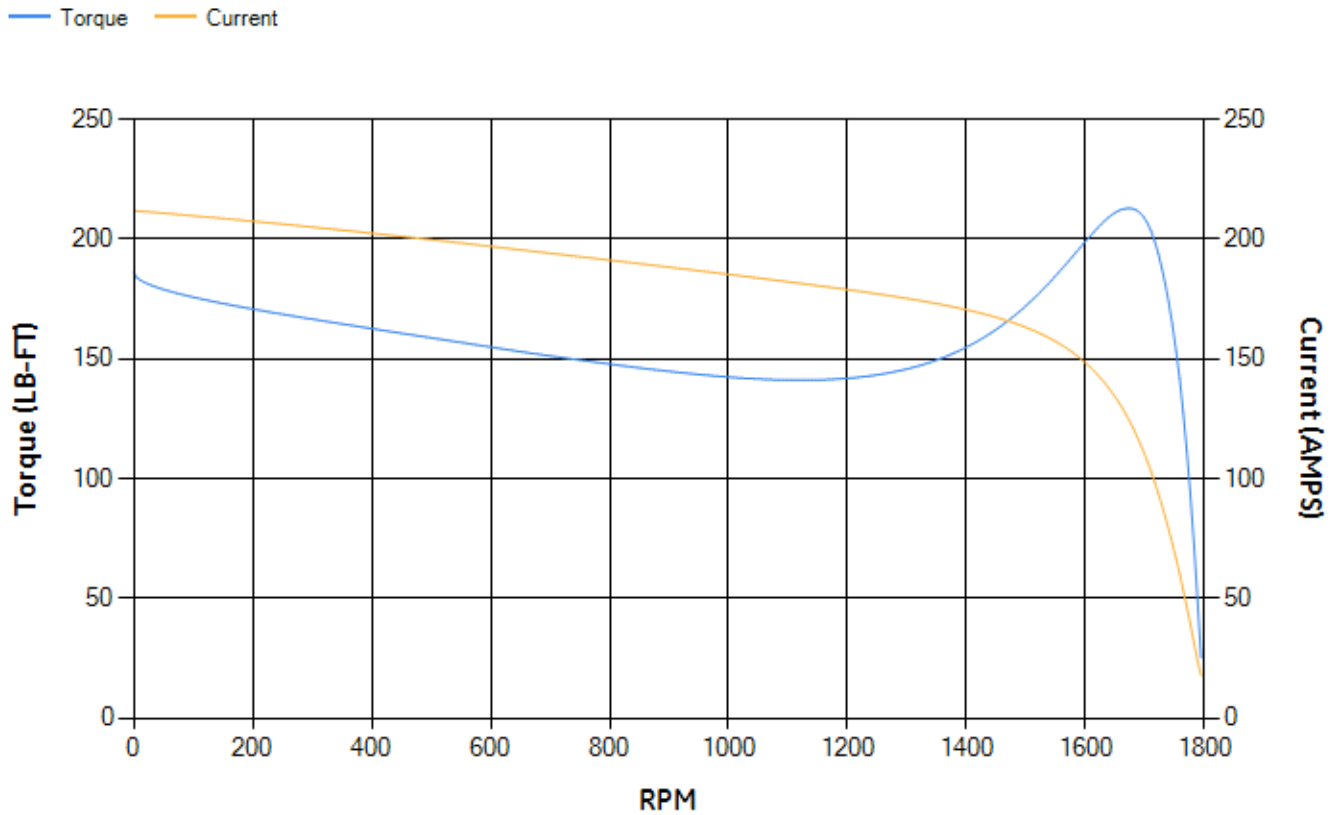

NAME:501452442 OBJECT:358B6217AA DATE:15-May-07 15:32:08

Marks:

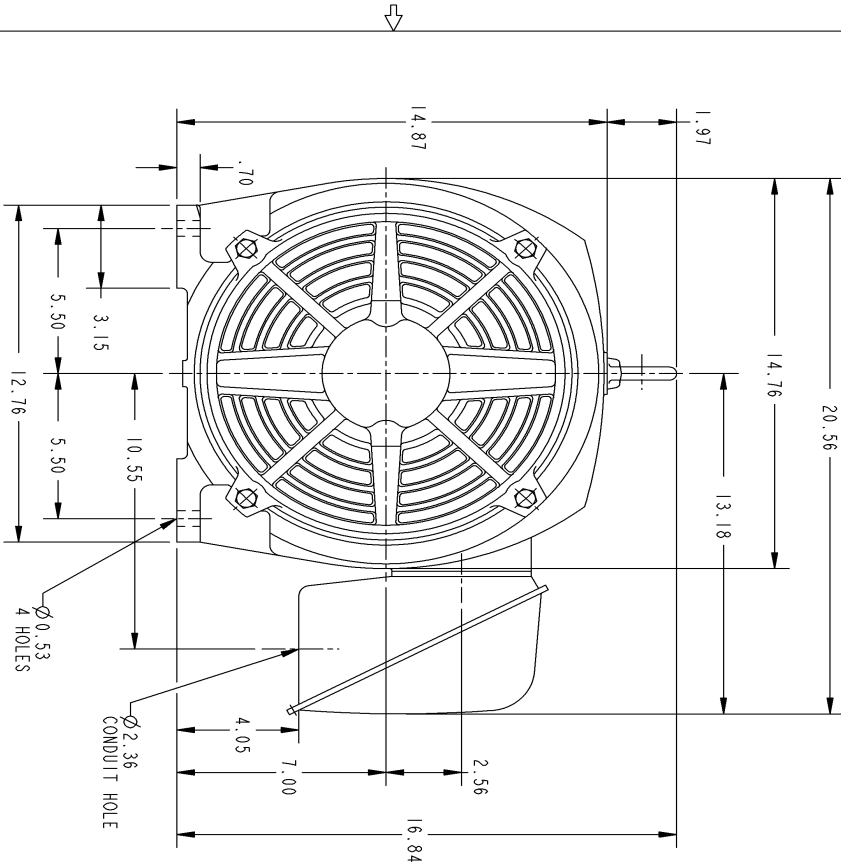

NOTES :

1. CONDUIT BOX MAY BE PLACED WITH THE ENTRANCE DOWN, UP OR ON EITHER SIDE.
2. F-1 ASW AS SHOWN.
3. F-2 ASW - HAS CONDUIT BOX ON OPPOSITE SIDE.

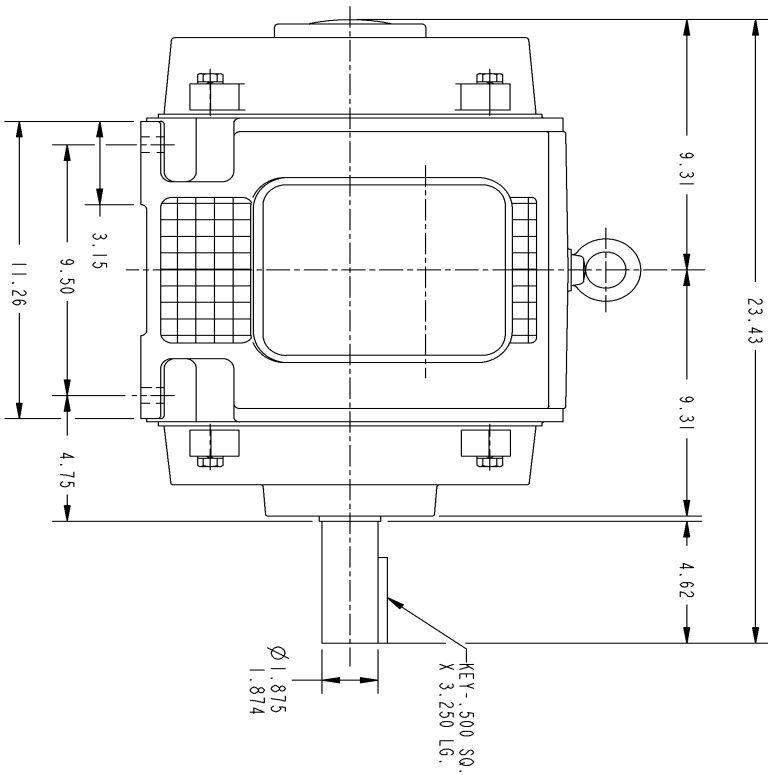
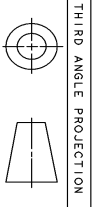

SIZE DRAWING FOR  
**358B6217AA**  
 GE PROPRIETARY INFORMATION

| REV. | DESCRIPTION   | DATE     | APPROVED |
|------|---------------|----------|----------|
| 1    | ISAAC 07-0770 | 05/03/07 | R. KOHNE |

|                             |  |                          |  |                     |  |
|-----------------------------|--|--------------------------|--|---------------------|--|
| UNLESS OTHERWISE SPECIFIED: |  | SIGNATURES               |  | DATE                |  |
| DIMENSIONS ARE IN INCHES    |  | DRAWN                    |  | P. RAJU 03/27/03    |  |
| TOLERANCE ON:               |  | CHECKED                  |  | PRADHAKAR 03/27/03  |  |
| 2 PL. DECIMALS ± .          |  | ENGRS                    |  | ENGRS               |  |
| 3 PL. DECIMALS ± .          |  | ISSUED                   |  | PRADHAKAR 03/27/03  |  |
| ANGLES ± 1°                 |  | APPLIED PRACTICES        |  | APPLIED PRACTICES   |  |
| MATERIAL:                   |  | SIZE DRAWING             |  | REV.                |  |
|                             |  | B                        |  | 1                   |  |
| SCALE: DRAWING SCALE        |  | GENERAL ELECTRIC COMPANY |  | Fort Wayne, Indiana |  |
|                             |  | Systems                  |  | OUTLINE             |  |
|                             |  | 284T - OPEN DRIP PROOF   |  | 358B6217AA          |  |
| DISTRIBUTION:               |  | SHEET 1 OF 1             |  |                     |  |

Marks:

**Connection Diagram**  
**GEM2034E-FIG10**

