

034964ME

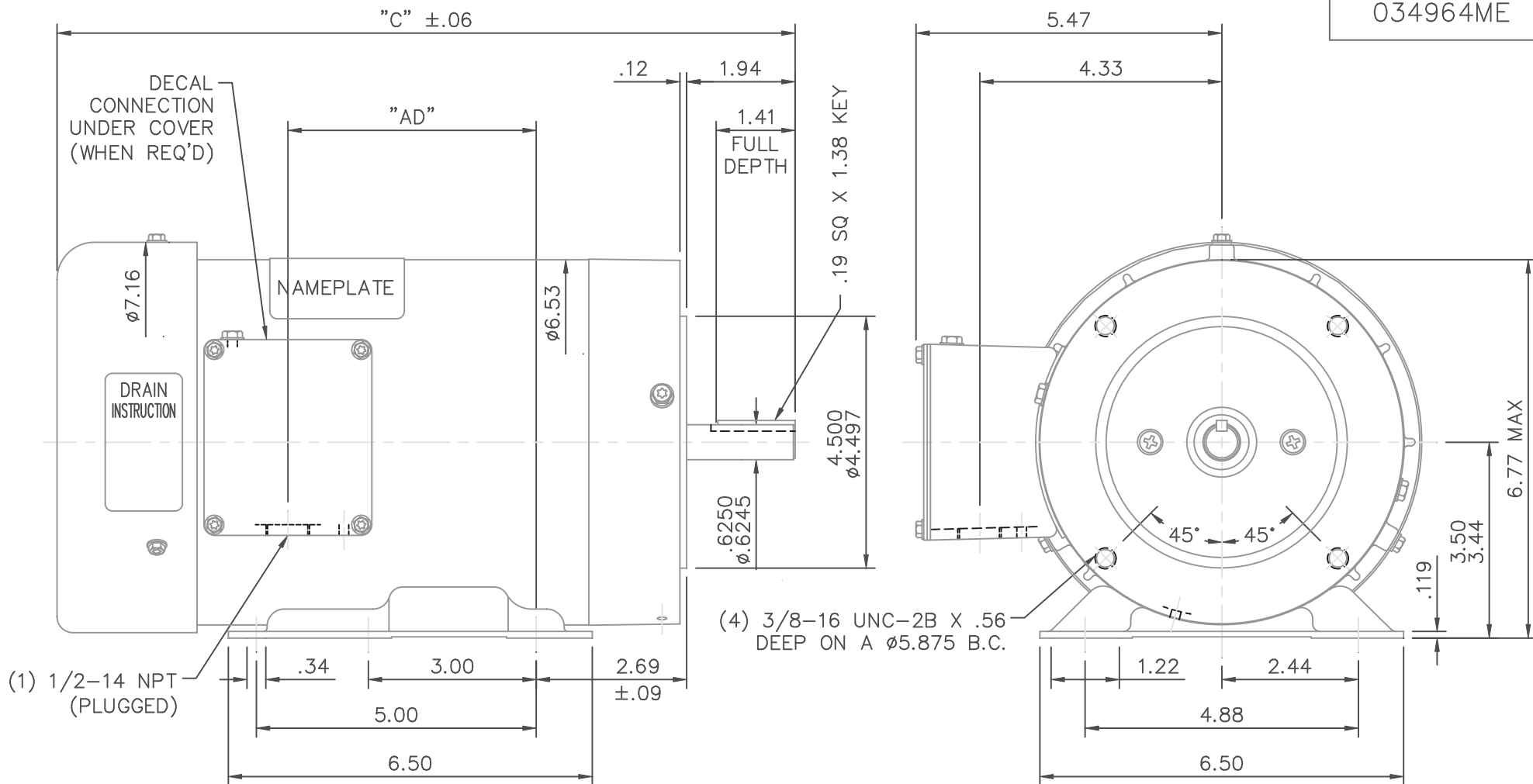

SPECIAL FEATURES:

- 1) SHAFT SEALS & V-RING
- 2) DRAIN HOLES IN BOTH ENDBELLS & CONDUIT BOX
- 3) GASKETS THROUGHOUT
- 4) STAINLESS STEEL SHAFT, HARDWARE & NAMEPLATE

DASH NO.	"C"	"AD"
700	13.19	4.44
750	13.69	4.94
800	14.19	5.44

MAXIMUM FACE RUNOUT .004 T.I.R.
 MAXIMUM PILOT ECCENTRICITY .004 T.I.R.
 PERMISSIBLE SHAFT RUNOUT .002 T.I.R.

NO.			REVISION		BY & DATE		TOLERANCES UNLESS SPECIFIED		MARATHON ELECTRIC		DRAWN R/LW 1/6/05	
							DEC. INCHES				CHK	
							.X ±.1				APPD	
							.XX ±.03		TITLE		SCALE 3=8	
							.XXX ±.005		OUTLINE - 56HC FRAME		REF 034894	
							.XXXX ±.0005		TEFC - RIGID "C"		FMF	
							ANG ±1/2'		MAT'L. WASHGUARD		PREV	
							RFP		CAD FILE 034964ME		SIZE DRAWING NO.	
							DIST				A 034964ME	
											REV.	

THIS DRAWING IN DESIGN AND DETAIL IS OUR PROPERTY AND MUST NOT BE USED EXCEPT IN CONNECTION WITH OUR WORK ALL RIGHTS OF DESIGN AND INVENTION ARE RESERVED THIS IS AN ELECTRONICALLY GENERATED DOCUMENT - DO NOT SCALE THIS PRINT