

Product Information Packet

November 7, 2016

Data shown is for the current revision model #. Ensure your nameplate model # matches.

Model Number:	5KS143ATE205RG3
Catalog Number:	E7050
Instruction Manual:	GEI-M1023
Connection Diagram:	GEM2034E-FIG3
Outline Drawing:	358B6213AC

Accessory Connection Diagrams			
Bearing Thermocouple:	None	Heater:	None
RTD:	None	Thermistor:	None
Thermostat:	None	Winding Thermocouple:	None
Bearing RTD:	None		

Table of Contents	
Specification	01
Performance Characteristics	02
Outline Drawing	03
Connection Drawing(s)	04



Marks:

MODEL NUMBER:	5KS143ATE205RG3	Estimated Weight:	41 Lbs
Outline Drawing:	358B6213AC	Time Rating:	CONT
Connection Diagram:	GEM2034E-FIG3	Enclosure:	DP
Instruction Book:	GEI-M1023	Encl Construction:	OPEN
Design Code:	14AD1003A	Ambient Max(°C):	40
Type:	KS	Alt Ambient Max(°C):	--
Frame:	143T	Insulation Class:	F
Phases:	3	NEMA Design:	B
Poles:	4	Nominal Efficiency:	85.5 %
Output Power:	1HP 0.7KW	Guaranteed Efficiency:	82.5
RPM:	1735	3/4 Load Efficiency:	87.9
Voltage:	230/460	KVA Code:	N
Hertz:	60	Max KVAR:	.5
Amps - FL:	2.8/1.4	Power Factor:	77.5
Service Factor:	1.15	Bearing - DE:	6205ZZ
Alt Service Factor:	--	Bearing - ODE:	6205ZZ

Enclosure is Dripproof

Stamped Nameplate Notes:**Additional Information:**

4 POLE DP
 LRA: 20.4/10.2
 NO. OF MOTOR LEADS: 9
 CONDUIT BOX VOLUME (IN³): 30.2
 CONDUIT BOX MTL: STAMPED STEEL
 GREASE TYPE: SHELL ALVANIA R3 LITHIUM GREASE
 USABLE AT 200V @ 1 HP, 3.1 AMPS @ 1.0 SF
 50 HZ DATA: 3/4 HP, 200/400V, 2.6 / 1.3 AMPS @1.0SF, 1450 RPM
 SOUND POWER: 50.96
 DMK, 06/04, DATA UPDATE 11/2004
 INVERTER DUTY PER NEMA MG1 PART 31
 FOR VARIABLE TORQUE LOADS
 MADE FROM MODEL 5KS143ATE205
 W/ SHAFT GROUNDING RING, P/N 235A4970AG12
 BAM 2/12

Performance Characteristics

1st Winding 1st Connection

Design: 14AD1003A

Marks:

LOAD %	125.0	115.0	100.0	75.0	50.0	25.0	0.0
% EFF	86.48	87	87.81	87.95	86.7	80.31	0.00
% PF	82.44	81.36	79.1	72.78	61.04	39.99	7.73
AMPS	1.64	1.52	1.35	1.1	0.88	0.73	0.65

TORQ(FL)#FT	3.01	TORQ(LR)%FL	255.49	TORQ(BD)%FL	317.27
AMPS(LR)	9.58	PF AT START	0.53		

This motor is capable of two cold or one hot start with a maximum connected load inertia of 64 Lb-Ft Sq (2.69 Kg-meter Sq)at 100% voltage, where the load torque varies with the square of the speed. Acceleration time with maximum inertia and the above load type is 49 seconds. Safe stall time at 100% voltage is 117 seconds cold, 93 seconds hot. Rotor inertia is 0.1 Lb-Ft Sq (0 Kg-meter Sq).

Open Circuit A-C:	0.156	Short Circuit D-C:	0.007
Short Circuit A-C:	0.008	X/R Ratio:	2.723
Stator Slots:	36	Rotor Slots:	28

Speed Torque Current Curve (First Connection, First Speed)

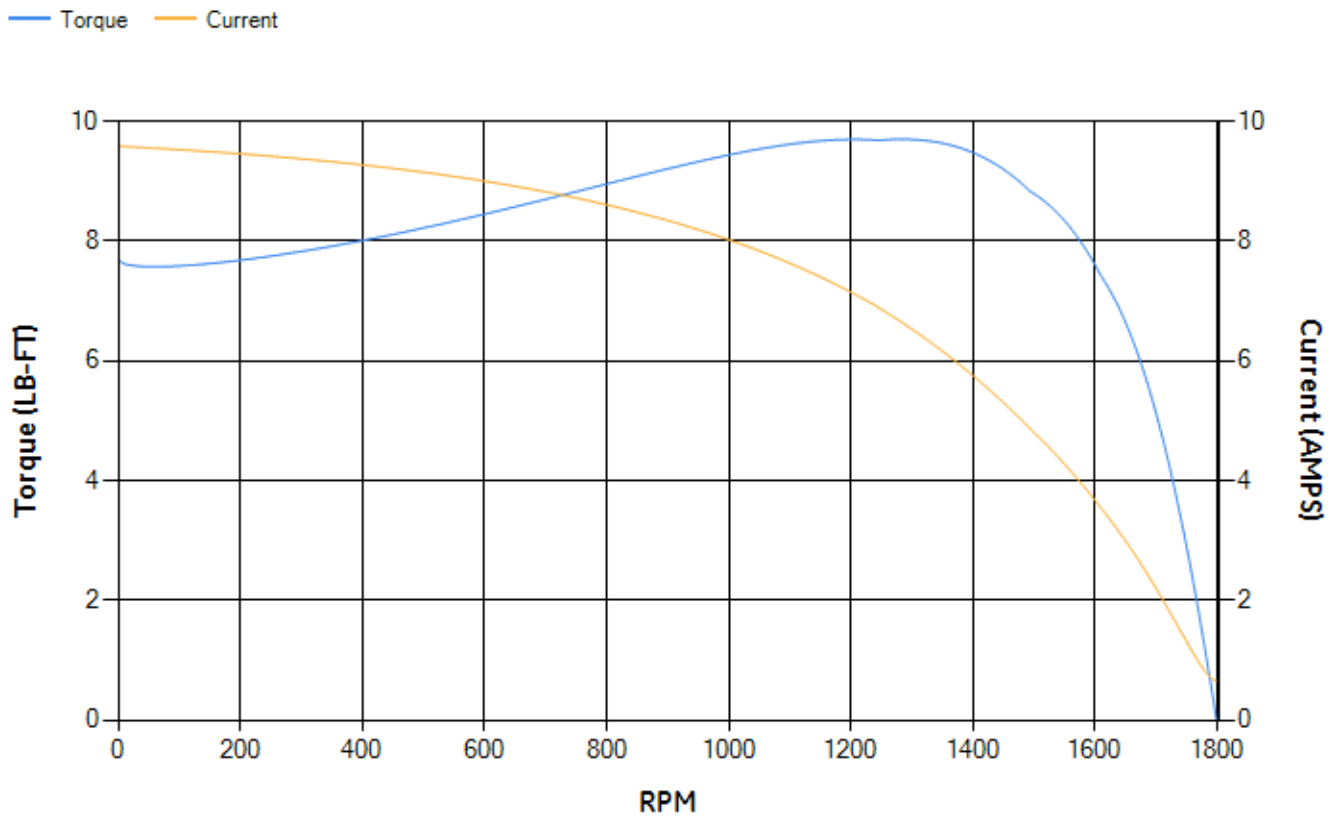

Marks:

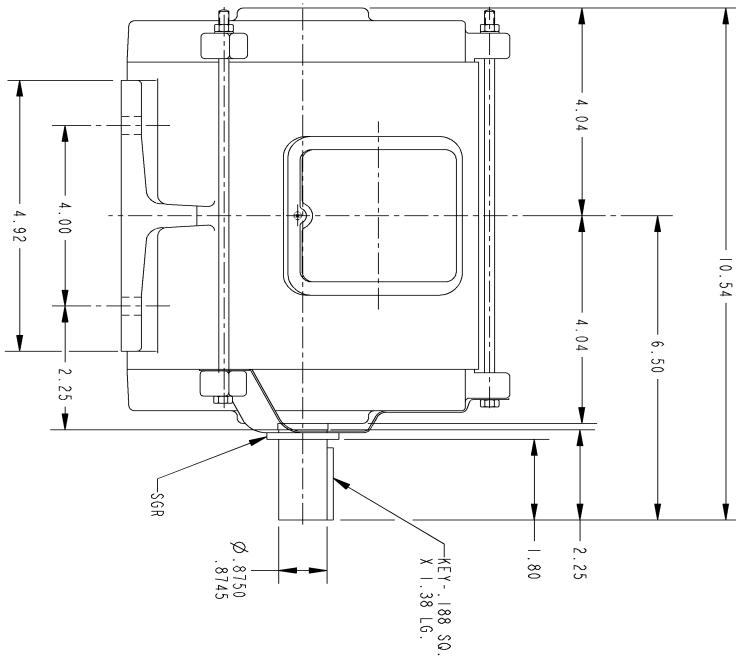
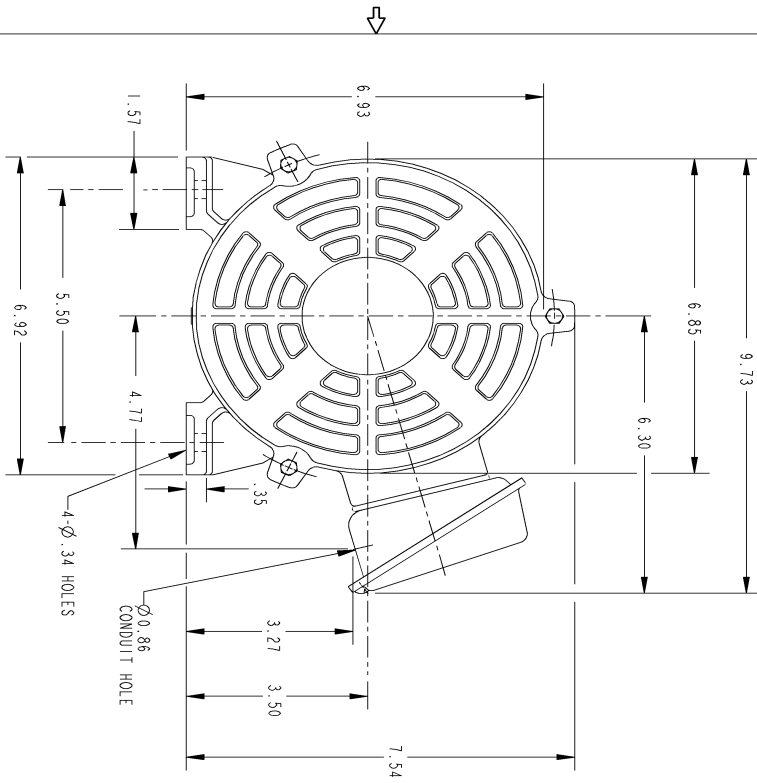

- NOTES:
1. CONDUIT BOX MAY BE PLACED WITH THE ENTRANCE DOWN, UP OR ON EITHER SIDE.
 2. F-1 ASM AS SHOWN.
 3. F-2 ASM - HAS CONDUIT BOX ON OPPOSITE SIDE.

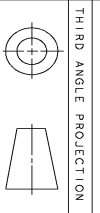

GE PROPRIETARY INFORMATION
 This document is the property of General Electric Company ("GE") and contains proprietary information of GE. This document is issued on the express condition that recipient thereof shall not disseminate, distribute, or otherwise make available the information contained herein, shall be stored in any information system, or be used by the recipient for any purpose not expressly authorized by GE. This document shall be returned to GE upon its request. This document is subject to standard restrictions under U.S. export control laws and regulations.

REV.	DESCRIPTION	DATE	APPROVED

SIGNATURES	DATE
MODEL: SHANKAR	07/14/11
DETAIL: VENKAT J	07/14/11
CHECKED: VENKAT J	07/14/11
ENGR: VENKAT J	07/14/11
ISSUED: SHANKAR	07/14/11
SOLID MODEL: MODEL NAME	

GE Motors GENERAL ELECTRIC COMPANY

TITLE: **OUTLINE**

143T - OPEN DRIP PROOF WITH SGR

SCALE: DRAWING SCALE

358B6213AC REV 0

SHEET 1 of 1

DISTRIBUTION:

Marks:

Connection Diagram
GEM2034E-FIG3

