

| TYPE | OUTPUT | | POLE | TIME RATING | VOLTAGE V | Hz | SYN SPEED R.P.M |
|------|--------|-----|------|-------------|-----------|----|-----------------|
| | HP. | KW. | | | | | |
| ASHH | 500 | 373 | 4 | CDNT. | 460 | 60 | 1800 |

DRIP PROOF TYPE, SQUIRREL-CAGE ROTOR

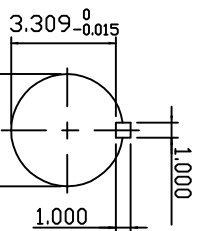
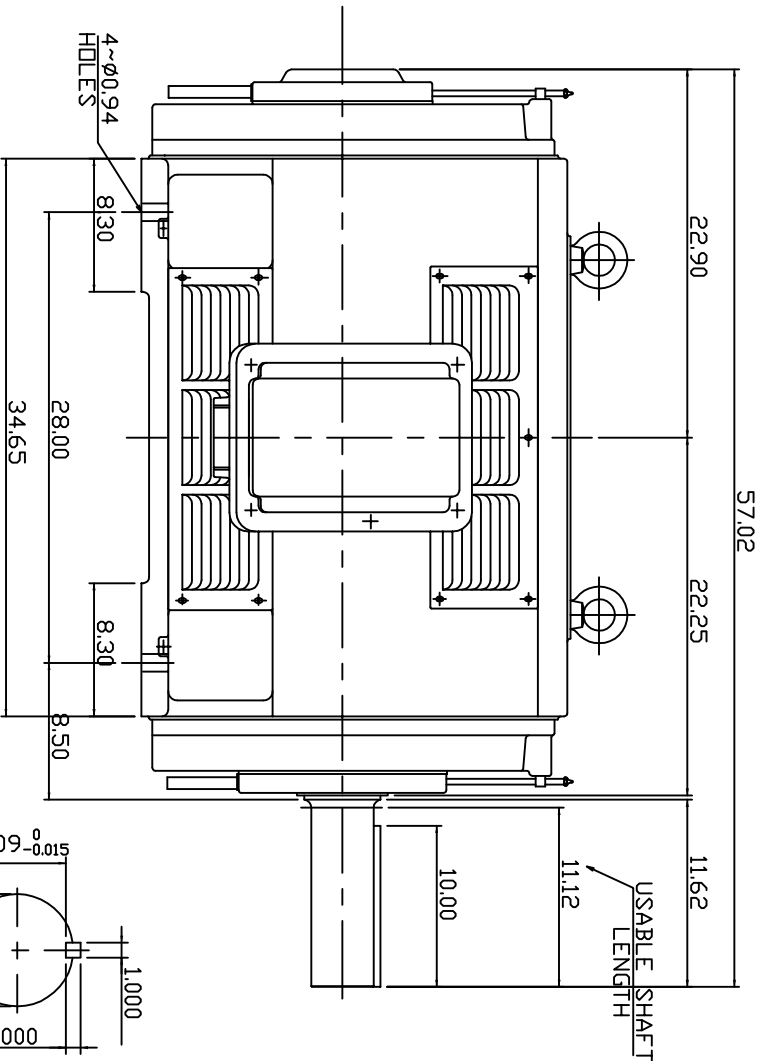
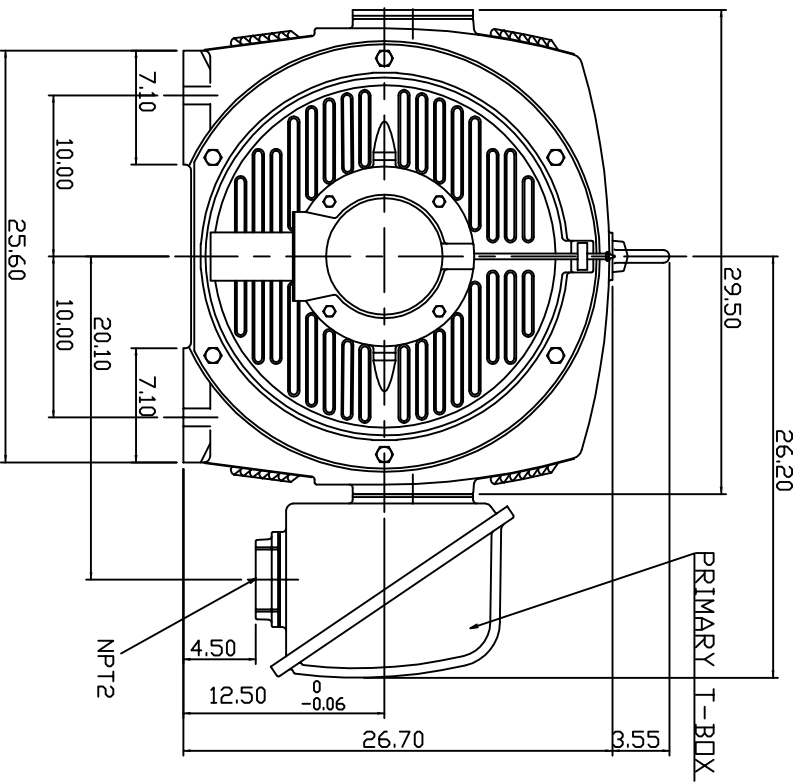

- NOTE:
 1. DIMENSIONS IN INCH
 2. FRAME NO. 5009B
 3. F CLASS INSULATION
 4. FOR DIRECT FLEXIBLE COUPLING
 5. ENCLOSURE: IP22
 6. BEARING SIZE: DPP, DRIVE END 6324
 7. MOTOR APPROX. WEIGHT: 3790 LBS

TW-56C

| | | |
|-------|---------|---------------|
| DWN. | HCHEN | JUL. 05. 2010 |
| CHKD. | W.WENG | JUL. 05. 2010 |
| APPD. | T.HSIAD | JUL. 05. 2010 |

| | | |
|-------------------------|--------------|--------------------|
| DATE | JULY 9, 2010 | OUTLINE DIMENSIONS |
| CATALOG NO. | DHP5004 | |
| 3-PHASE INDUCTION MOTOR | | |



DWG NO. 3A049DTA0013-9
 REV: 00