

Product Information Packet

November 7, 2016

Data shown is for the current revision model #. Ensure your nameplate model # matches.

Model Number:	5KS404ATE308A
Catalog Number:	E7029
Instruction Manual:	GEI-M1023
Connection Diagram:	GEM2034E-FIG8
Outline Drawing:	358B6203AA

Accessory Connection Diagrams			
Bearing Thermocouple:	None	Heater:	None
RTD:	None	Thermistor:	None
Thermostat:	None	Winding Thermocouple:	None
Bearing RTD:	None		

Table of Contents	
Specification	01
Performance Characteristics	02
Outline Drawing	03
Connection Drawing(s)	04

Marks:

MODEL NUMBER:	5KS404ATE308A	Estimated Weight:	1150 Lbs
Outline Drawing:	358B6203AA	Time Rating:	CONT
Connection Diagram:	GEM2034E-FIG8	Enclosure:	DP
Instruction Book:	GEI-M1023	Encl Construction:	OPEN
Design Code:	40AD3002A	Ambient Max(°C):	40
Type:	KS	Alt Ambient Max(°C):	--
Frame:	404T	Insulation Class:	F
Phases:	3	NEMA Design:	A
Poles:	6	Nominal Efficiency:	94.5 %
Output Power:	60HP 44.4KW	Guaranteed Efficiency:	93.6
RPM:	1185	3/4 Load Efficiency:	94.8
Voltage:	460	KVA Code:	G
Hertz:	60	Max KVAR:	18.3
Amps - FL:	71.2	Power Factor:	81.5
Service Factor:	1.15	Bearing - DE:	6317
Alt Service Factor:	--	Bearing - ODE:	6313

Enclosure is Dripproof

Stamped Nameplate Notes:**Additional Information:**

6 POLE DP
 LRA: @ 460 VOLTS: 447.7
 NO. OF MOTOR LEADS: 6
 CONDUIT BOX VOLUME (IN³): 1240
 CONDUIT BOX MTL: STAMPED STEEL
 GREASE TYPE: CHEVRON SRI-2 POLYUREA GREASE
 NOT USABLE AT 200V
 50 HZ DATA: 60HP, 400V, 83.3 AMPS AT 1.0SF @985 RPM
 SOUND POWER: 78.7
 DMK, 06/04, UPDATED 2/2005
 INVERTER DUTY PER NEMA MG1 PART 31
 FOR VARIABLE TORQUE LOADS

Performance Characteristics

1st Winding 1st Connection

Design: 40AD3002A

Marks:

LOAD %	125.0	115.0	100.0	75.0	50.0	25.0	0.0
% EFF	93.64	93.98	94.6	94.8	94.56	92.11	0.00
% PF	84.34	84.27	83.65	80.57	72.36	51.07	4.19
AMPS	88.88	81.54	70.97	55.14	41.03	29.85	24.46

TORQ(FL)#FT	265.92	TORQ(LR)%FL	217.65	TORQ(BD)%FL	234.12
AMPS(LR)	445.7	PF AT START	0.38		

This motor is capable of two cold or one hot start with a maximum connected load inertia of 4175 Lb-Ft Sq (175.77 Kg-meter Sq)at 100% voltage, where the load torque varies with the square of the speed. Acceleration time with maximum inertia and the above load type is 42 seconds. Safe stall time at 100% voltage is 72 seconds cold, 56 seconds hot. Rotor inertia is 29.05 Lb-Ft Sq (1.22 Kg-meter Sq).

Open Circuit A-C:	0.592	Short Circuit D-C:	0.024
Short Circuit A-C:	0.032	X/R Ratio:	9.186
Stator Slots:	72	Rotor Slots:	58

Speed Torque Current Curve (First Connection, First Speed)

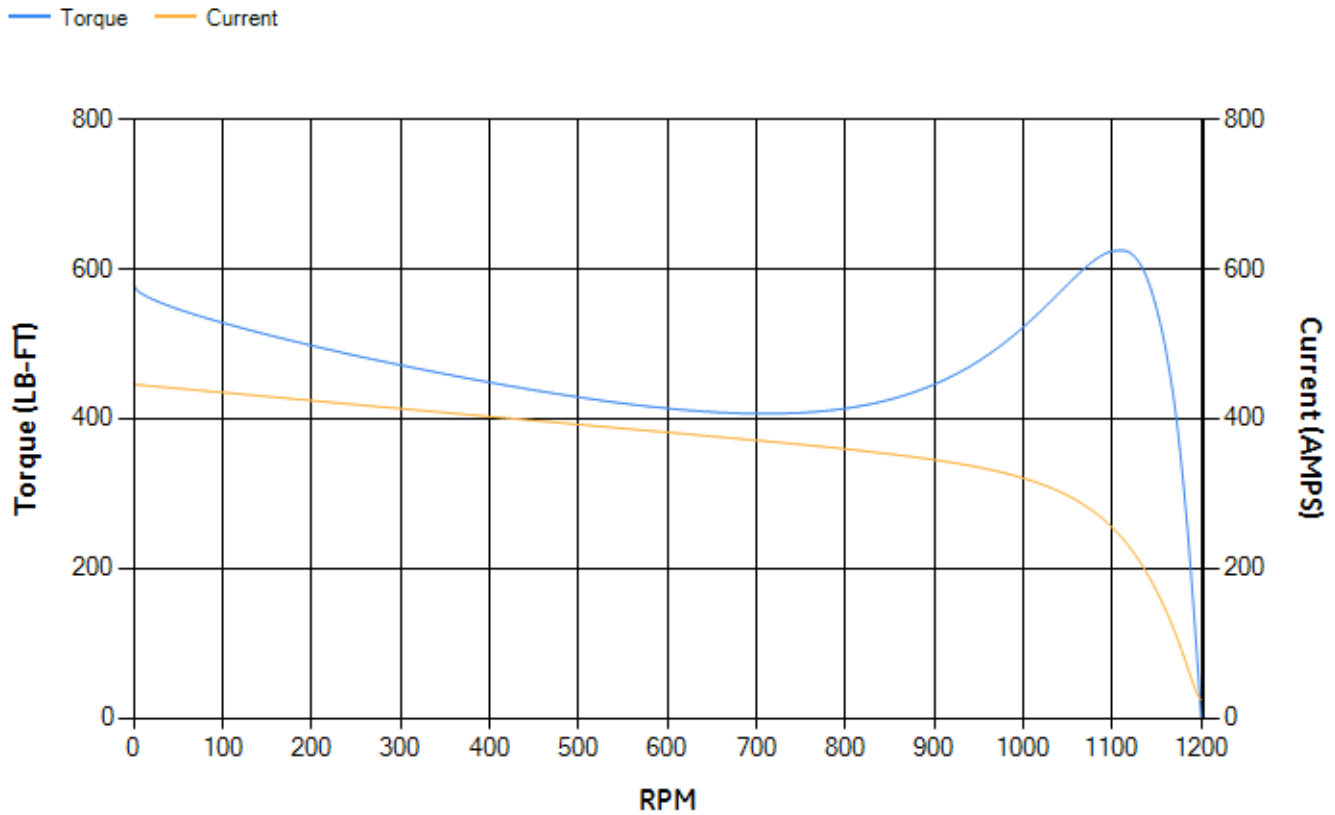

NAME:500903578 OBJECT:358B6203AA DATE:04-May-07 10:52:23

Marks:

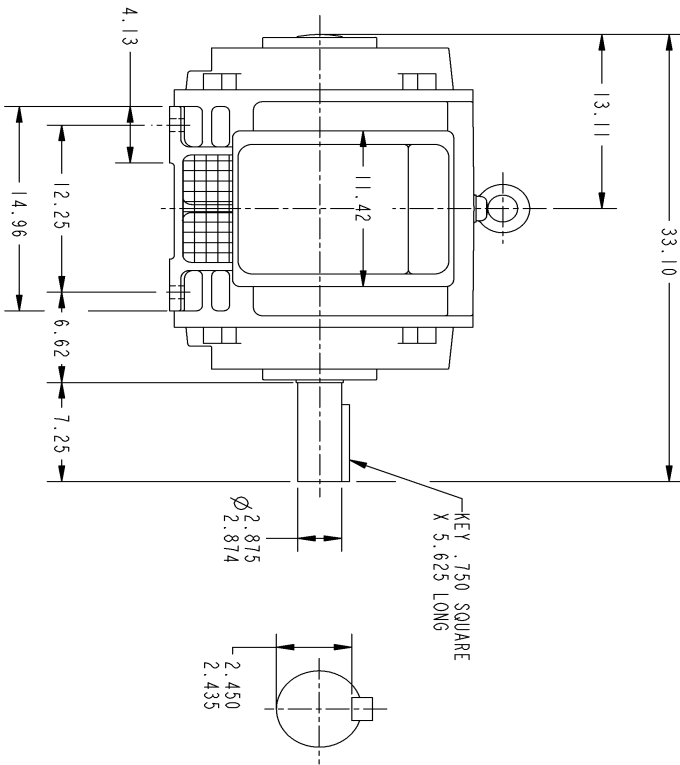
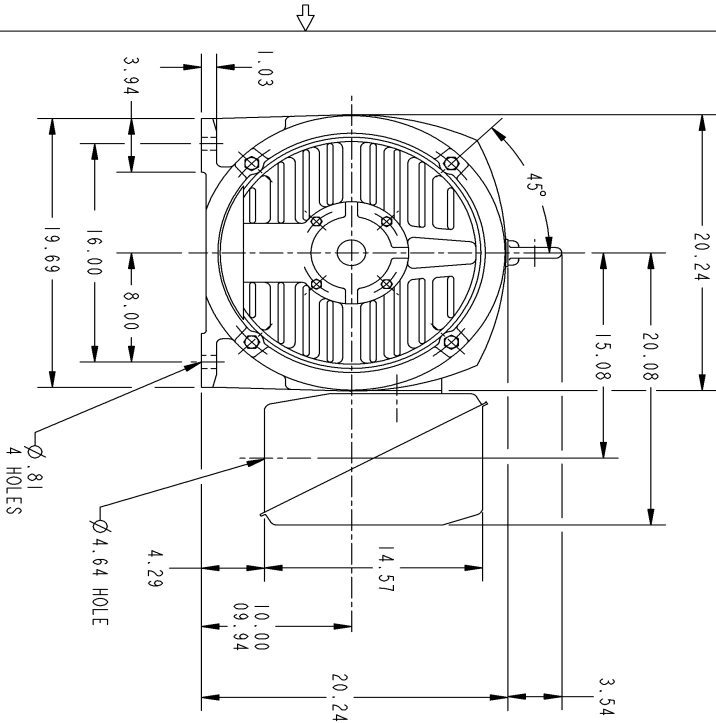

GE PROPRIETARY AND CONFIDENTIAL INFORMATION		REV	1	SHEET	1
<p>This document is the property of General Electric Company (GE) and contains proprietary information of GE. This document is loaned on the express condition that neither it nor the information contained therein shall be disclosed to any other person or organization without the express written approval of GE. This information shall be used only for the specific project or application for which it was prepared. This document shall be returned to GE upon its request. This document is not to be copied, reproduced, or distributed without the express written approval of GE. GE reserves the right to modify this document without notice.</p>					
REV.	DESCRIPTION	DATE	APPROVED		
1	ISAAC 07-0770	05/02/07	R. KOHNE		

NOTES :

1. CONDUIT BOX MAY BE PLACED WITH THE ENTRANCE DOWN, UP OR ON EITHER SIDE.
2. F-1 ASW AS SHOWN.
3. F-2 ASW - HAS CONDUIT BOX ON OPPOSITE SIDE.

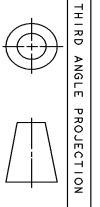

FOR ADDITIONAL INFO REFER TO:	SIGNATURES	DATE	GENERAL ELECTRIC COMPANY		
APPLIED PRACTICES	MODEL		OUTLINE 404T - CAST IRON ODP FOOTED 358B6203AA		
DIMENSIONS ARE IN INCHES	REVIEW		SIZE	DRAWING	REV
TOLERANCE ON:	DESIGNED	12/12/02	B		1
1 PL DECIMALS ± .	SUPPLIERS	12/12/02	SCALE:	DRAWING SCALE	
2 PL DECIMALS ± .	ENGINEER	12/12/02			
3 PL DECIMALS ± .	WKS				
ANGLES ± .	QUALITY				
FRACTIONS ± .	ISSUED	12/13/02			
FINISH	SOLID MODEL				
MATERIAL	SOLID MODEL				

Marks:

Connection Diagram
GEM2034E-FIG8

