

Product Information Packet

November 8, 2016

Data shown is for the current revision model #. Ensure your nameplate model # matches.

Model Number:	5KS182STE104A
Catalog Number:	M7503
Instruction Manual:	GEI-M1031
Connection Diagram:	GEM2034E-FIG1
Outline Drawing:	358B6270AA

Accessory Connection Diagrams			
Bearing Thermocouple:	None	Heater:	None
RTD:	None	Thermistor:	None
Thermostat:	None	Winding Thermocouple:	None
Bearing RTD:	None		

Table of Contents	
Specification	01
Performance Characteristics	02
Outline Drawing	03
Connection Drawing(s)	04

Marks:

MODEL NUMBER:	5KS182STE104A	Estimated Weight:	82 Lbs
Outline Drawing:	358B6270AA	Time Rating:	CONT
Connection Diagram:	GEM2034E-FIG1	Enclosure:	TEFC
Instruction Book:	GEI-M1031	Encl Construction:	SD
Design Code:	18AD0011B	Ambient Max(°C):	40
Type:	KS	Alt Ambient Max(°C):	--
Frame:	182T	Insulation Class:	F
Phases:	3	NEMA Design:	B
Poles:	2	Nominal Efficiency:	86.5 %
Output Power:	3HP 2.2KW	Guaranteed Efficiency:	84.0
RPM:	3525	3/4 Load Efficiency:	90.9
Voltage:	575	KVA Code:	K
Hertz:	60	Max KVAR:	0.7
Amps - FL:	2.9	Power Factor:	91.0
Service Factor:	1.15	Bearing - DE:	6207ZZC3
Alt Service Factor:	--	Bearing - ODE:	6206ZZC3

Enclosure is Totally Enclosed Fan-Cooled

Stamped Nameplate Notes:**Additional Information:**

2 POLE, TEFC, LRA: 23.8 AMPS.
 SOUND POWER : 88.0 DBA
 GREASE: SHELL ALVANIA R3 LITHIUM GREASE
 NO. OF MOTOR LEADS: 3
 CONDUIT BOX VOLUME (CU IN): 47.1
 CONDUIT BOX MATERIAL: CAST IRON
 SUITABLE FOR USE IN CLASS I DIVISION 2 LOCATIONS
 CLASS I DIVISION 2 GROUPS A,B,C,D T3C
 CLASS I ZONE 2 IIC T3C

Performance Characteristics

1st Winding 1st Connection

Design: 18AD0011B

Marks:

LOAD %	125.0	115.0	100.0	75.0	50.0	25.0	0.0
% EFF	89.35	89.81	90.59	90.9	90.32	85.96	0.00
% PF	92.42	92.1	91.32	88.66	82.09	63.3	10.4
AMPS	3.4	3.12	2.72	2.09	1.51	1.03	0.76

TORQ(FL)#FT	4.47	TORQ(LR)%FL	204.54	TORQ(BD)%FL	353.82
AMPS(LR)	23.01	PF AT START	0.45		

This motor is capable of two cold or one hot start with a maximum connected load inertia of 30 Lb-Ft Sq (1.26 Kg-meter Sq)at 100% voltage, where the load torque varies with the square of the speed. Acceleration time with maximum inertia and the above load type is 36 seconds. Safe stall time at 100% voltage is 86 seconds cold, 68 seconds hot. Rotor inertia is 0.15 Lb-Ft Sq (0.01 Kg-meter Sq).

Open Circuit A-C:	0.452	Short Circuit D-C:	0.007
Short Circuit A-C:	0.012	X/R Ratio:	2.777
Stator Slots:	36	Rotor Slots:	28

Speed Torque Current Curve (First Connection, First Speed)

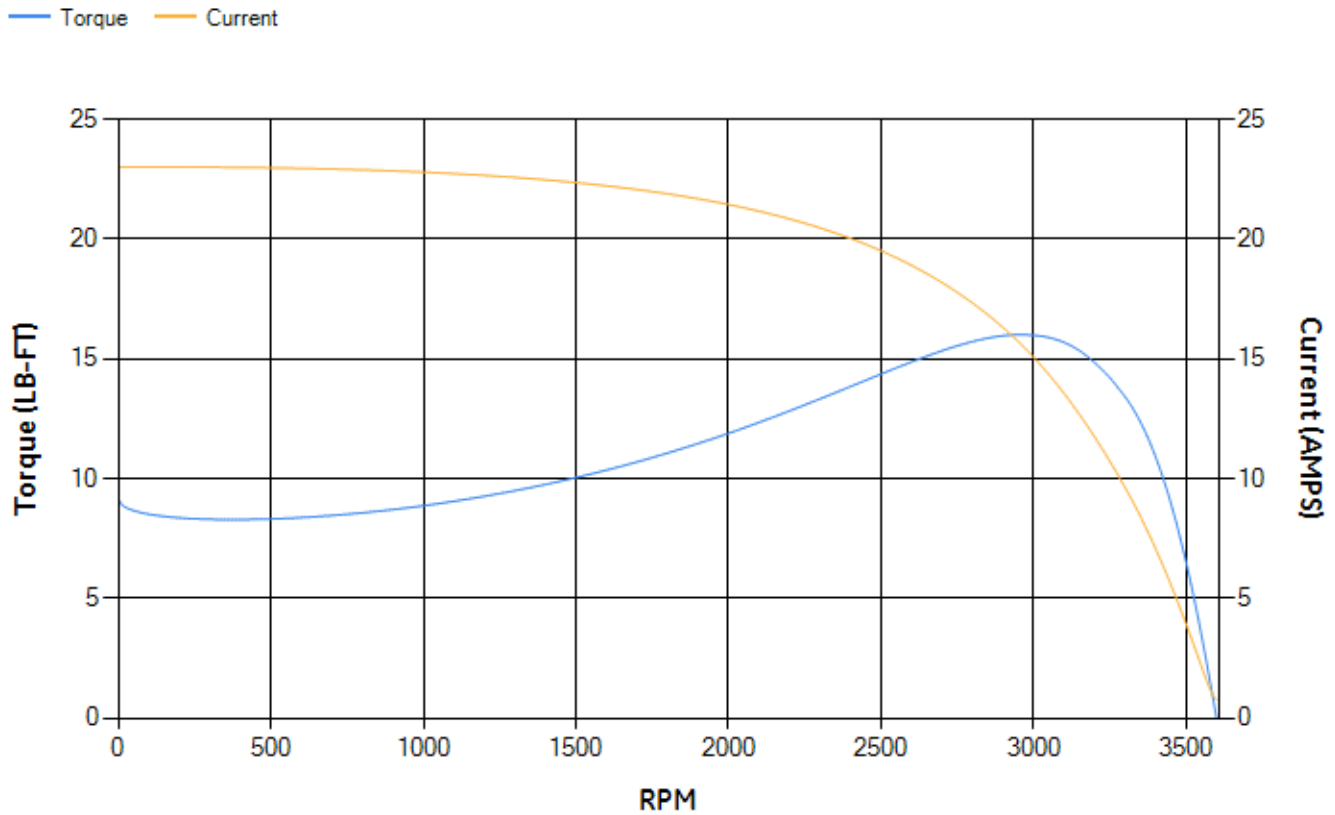

NAME:501291659 OBJECT:358B6270AA DATE:05-Dec-07 10:03:11

Marks:

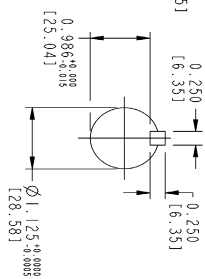
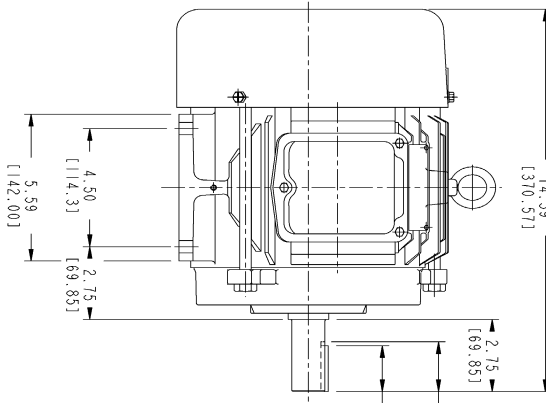
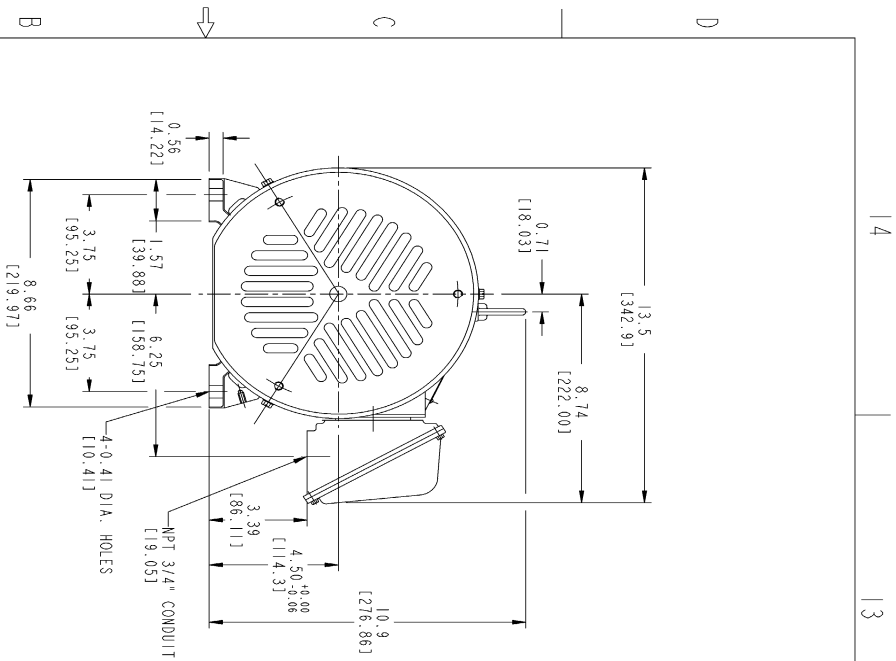

- NOTES :
1. DIMENSIONS ARE IN INCHES
 2. F-1 ASM AS SHOWN
 3. F-2 ASM - HAS CONDUIT BOX ON OPPOSITE SIDE
 4. BRACKETED DIMENSIONS ARE METRIC (MILLIMETERS)
 5. IC411, IP94, IMB34 APPLY

GE PROPRIETARY AND CONFIDENTIAL INFORMATION	
This document is the property of General Electric Company. It is not to be distributed, copied, or otherwise used without the written permission of General Electric Company. It is to be used only for the purpose for which it was prepared and is not to be used for any other purpose. It is to be returned to General Electric Company when it is no longer needed. It is to be stored in a secure location and is to be protected from unauthorized access. It is to be destroyed when it is no longer needed. It is to be disposed of in accordance with the applicable laws and regulations.	
REV.	DESCRIPTION
DATE	APPROVED
358B6270AA	0

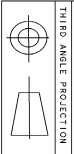

THIRD ANGLE PROJECTION

Part must conform to SI 900000 Sect. 4, Toxicity Procedure

FOR ADDITIONAL INFO REFER TO:	SIGNATURES	DATE
REFLECTED DIMENSIONS	MODEL	11/05/07
UNREFLECTED DIMENSIONS	QUANTITY	11/05/07
TOLERANCE ON:	SKETCH	11/05/07
2 PL DECIMALS ±	ENGINE	11/05/07
3 PL DECIMALS ±	WEIGHT	
ANGLES ±	QUALITY	
FRACTIONS ±	ISSUED	11/05/07
FINISH	QUANTITY	
SOLID MODEL	MODEL NAME	
SCALE:	SCALE:	

GE Consumer & Industrial
OUTLINE
 FTD - 182T TERC CE MARK
 471 CU IN CONDUIT BOX
 358B6270AA
 SHEET 1 OF 1

Marks:

Connection Diagram
GEM2034E-FIG1

