

Product Information Packet

January 12, 2017

Data shown is for the current revision model #. Ensure your nameplate model # matches.

Model Number:	5KS324ATE305A
Catalog Number:	E7019
Instruction Manual:	GEI-M1023
Connection Diagram:	GEM2034E-FIG10
Outline Drawing:	358B6218AA

Accessory Connection Diagrams			
Bearing Thermocouple:	3027JE-4	Heater:	None
RTD:	None	Thermistor:	None
Thermostat:	None	Winding Thermocouple:	None
Bearing RTD:	None		

Table of Contents	
Specification	01
Performance Characteristics	02
Outline Drawing	03
Connection Drawing(s)	04

Marks:

MODEL NUMBER:	5KS324ATE305A	Estimated Weight:	600 Lbs
Outline Drawing:	358B6218AA	Time Rating:	CONT
Connection Diagram:	GEM2034E-FIG10	Enclosure:	DP
Instruction Book:	GEI-M1023	Encl Construction:	OPEN
Design Code:	32AD3003A	Ambient Max(°C):	40
Type:	KS	Alt Ambient Max(°C):	--
Frame:	324T	Insulation Class:	F
Phases:	3	NEMA Design:	A
Poles:	6	Nominal Efficiency:	93 %
Output Power:	25HP 18.5KW	Guaranteed Efficiency:	91.7
RPM:	1185	3/4 Load Efficiency:	93.6
Voltage:	230/460	KVA Code:	H
Hertz:	60	Max KVAR:	10
Amps - FL:	64.2/32.1	Power Factor:	78.5
Service Factor:	1.15	Bearing - DE:	6312
Alt Service Factor:	--	Bearing - ODE:	6312

Enclosure is Dripproof

Stamped Nameplate Notes:**Additional Information:**

6 POLE DP
 LRA: 404.4/202.2
 NO. OF MOTOR LEADS: 12
 CONDUIT BOX VOLUME (IN³): 253
 CONDUIT BOX MTL: STAMPED STEEL
 GREASE TYPE: CHEVRON SRI-2 POLYUREA GREASE
 USABLE AT 200V @ 25HP, 70.6 AMPS @ 1.0 SF
 50 HZ DATA: 25HP, 200/400V, 73.2/36.6 AMPS AT 1.0SF, 985 RPM
 SOUND POWER: 74.4
 DMK, 06/04, DATA UPDATE 11/2004
 INVERTER DUTY PER NEMA MG1 PART 31
 FOR VARIABLE TORQUE LOADS

Performance Characteristics

1st Winding 1st Connection

Design: 32AD3003A

Marks:

LOAD %	125.0	115.0	100.0	75.0	50.0	25.0	0.0
% EFF	92.69	92.99	93.55	93.6	93.02	89.52	0.00
% PF	81.95	81.3	79.74	74.72	64.14	42.32	4.43
AMPS	38.51	35.59	31.37	25.09	19.61	15.44	13.43

TORQ(FL)#FT	110.65	TORQ(LR)%FL	254.94	TORQ(BD)%FL	264.04
AMPS(LR)	201.99	PF AT START	0.43		

This motor is capable of two cold or one hot start with a maximum connected load inertia of 1550 Lb-Ft Sq (65.26 Kg-meter Sq) at 100% voltage, where the load torque varies with the square of the speed. Acceleration time with maximum inertia and the above load type is 31 seconds. Safe stall time at 100% voltage is 74 seconds cold, 60 seconds hot. Rotor inertia is 9.21 Lb-Ft Sq (0.39 Kg-meter Sq).

Open Circuit A-C:	0.514	Short Circuit D-C:	0.015
Short Circuit A-C:	0.029	X/R Ratio:	5.577
Stator Slots:	72	Rotor Slots:	58

Speed Torque Current Curve (First Connection, First Speed)

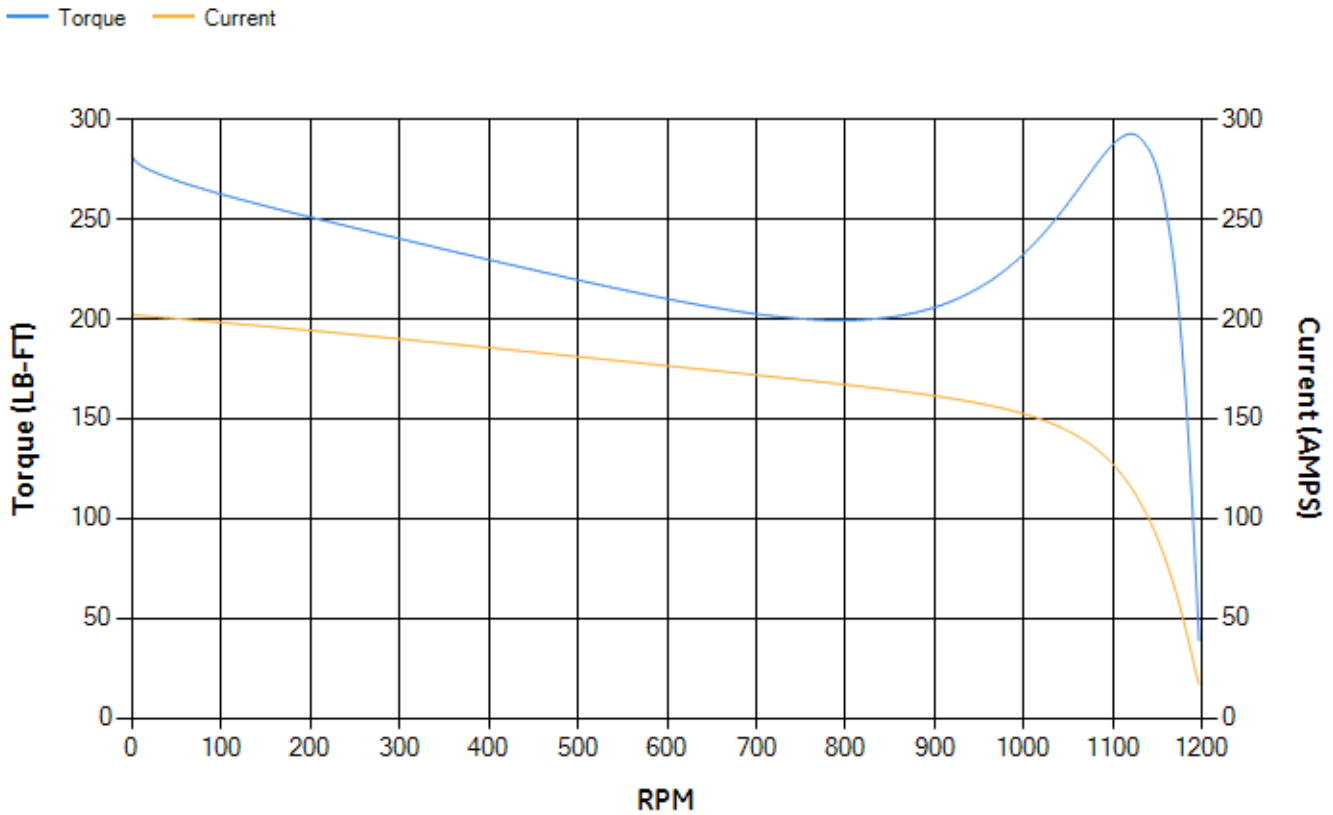

Marks:

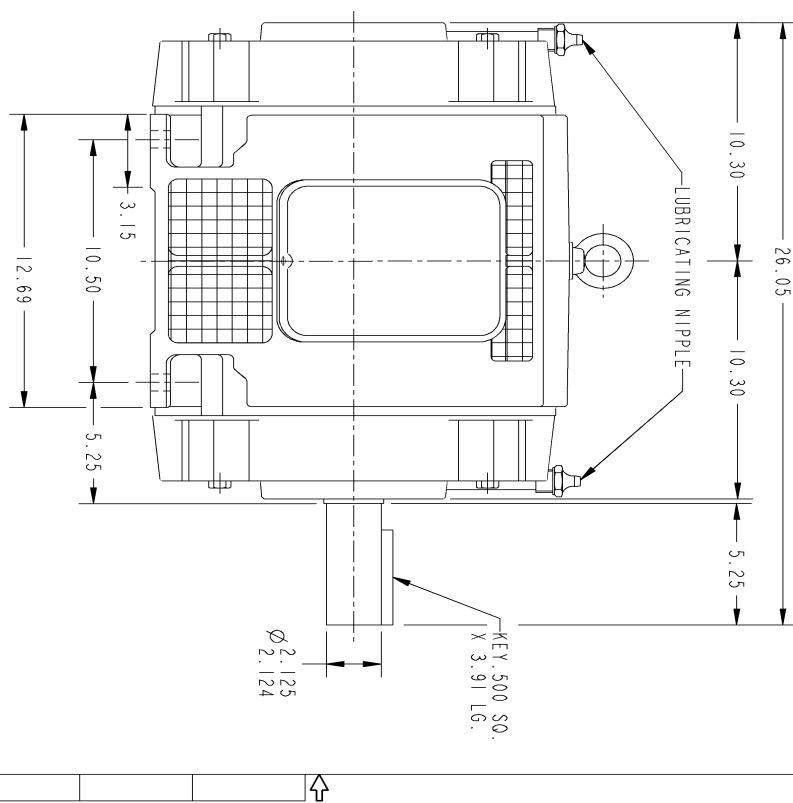
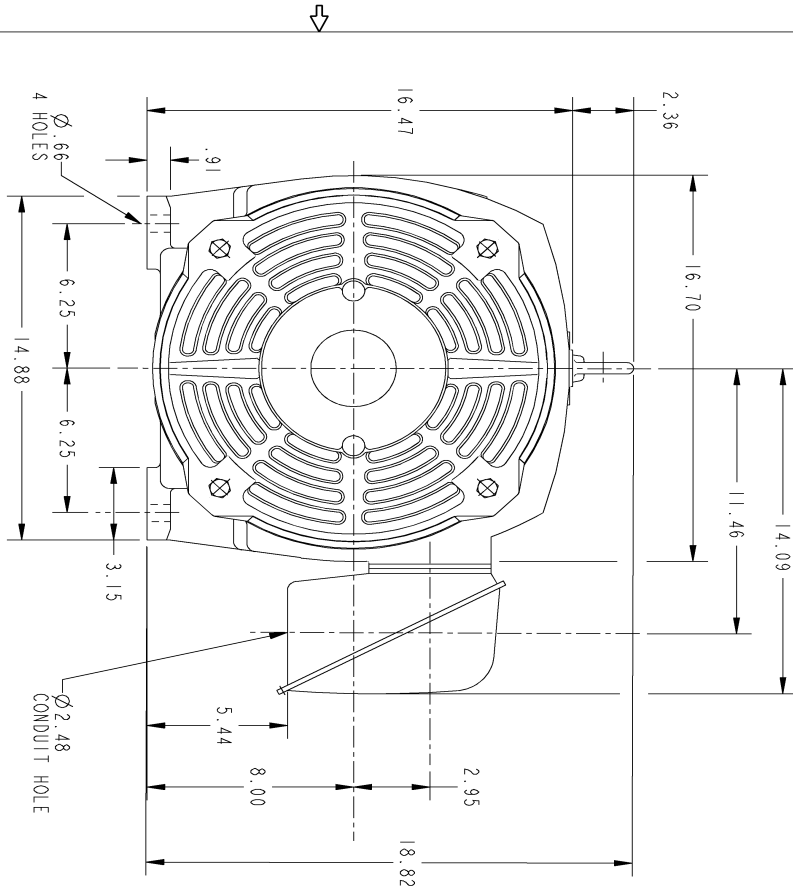

GE PROPRIETARY INFORMATION

358B6218AA

REV.	DESCRIPTION	DATE	APPROVED
1	ISAAC 07-0770	05/03/07	R. KOHNE
2	ISAAC 15-0375	04/22/15	HARIKIRAN

NOTES :

1. CONDUIT BOX MAY BE PLACED WITH THE ENTRANCE DOWN, UP OR ON EITHER SIDE.
2. F-1 ASW AS SHOWN.
3. F-2 ASW - HAS CONDUIT BOX ON OPPOSITE SIDE.

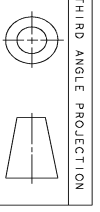

UNLESS OTHERWISE SPECIFIED:		SIGNATURES		DATE	
DIMENSIONS ARE IN INCHES	DRAWN	P. RAJU	03/07/03		
TOLERANCES ARE:	CHECKED	M. FUTTER	03/04/03		
2 PL DECIMALS ± 0.02	ENGR				
3 PL DECIMALS ± 0.005	ISSUED	PRADHAKAR	03/04/03		
ANGLES ± 0.5	APPLIED PRACTICES				
MATERIAL:		SCALE: DRAWING SCALE		SHEET 1 OF 1	

GE Industrial Systems
GENERAL ELECTRIC COMPANY
 Fort Wayne, Indiana

OUTLINE
 324T - DRIPPOOF
358B6218AA

Marks:

Connection Diagram
GEM2034E-FIG10

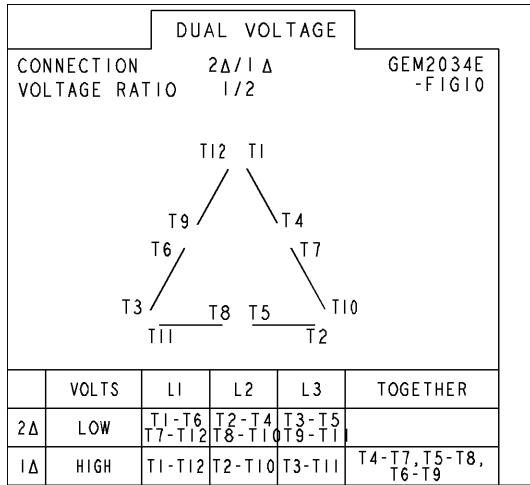

Bearing Thermocouple
3027JE-4

FIG. 4
BEARING THERMOCOUPLE
CONN.

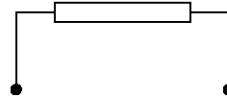

TERMINALS ARE UNMARKED