

# Product Information Packet

November 7, 2016

Data shown is for the current revision model #. Ensure your nameplate model # matches.

<b>Model Number:</b>	<b>5KS284ATE204A</b>
<b>Catalog Number:</b>	<b>E7652</b>
<b>Instruction Manual:</b>	GEI-M1023
<b>Connection Diagram:</b>	GEM2034E-FIG7
<b>Outline Drawing:</b>	358B6217AA

Accessory Connection Diagrams			
<b>Bearing Thermocouple:</b>	None	<b>Heater:</b>	None
<b>RTD:</b>	None	<b>Thermistor:</b>	None
<b>Thermostat:</b>	None	<b>Winding Thermocouple:</b>	None
<b>Bearing RTD:</b>	None		

Table of Contents	
Specification	01
Performance Characteristics	02
Outline Drawing	03
Connection Drawing(s)	04

**Marks:**

<b>MODEL NUMBER:</b>	<b>5KS284ATE204A</b>	<b>Estimated Weight:</b>	450 Lbs
<b>Outline Drawing:</b>	358B6217AA	<b>Time Rating:</b>	CONT
<b>Connection Diagram:</b>	GEM2034E-FIG7	<b>Enclosure:</b>	DP
<b>Instruction Book:</b>	GEI-M1023	<b>Encl Construction:</b>	OPEN
<b>Design Code:</b>	28AD1010B	<b>Ambient Max(°C):</b>	40
<b>Type:</b>	KS	<b>Alt Ambient Max(°C):</b>	--
<b>Frame:</b>	284T	<b>Insulation Class:</b>	F
<b>Phases:</b>	3	<b>NEMA Design:</b>	A
<b>Poles:</b>	4	<b>Nominal Efficiency:</b>	93.6 %
<b>Output Power:</b>	25HP 18.5KW	<b>Guaranteed Efficiency:</b>	92.4
<b>RPM:</b>	1775	<b>3/4 Load Efficiency:</b>	93.9
<b>Voltage:</b>	575	<b>KVA Code:</b>	H
<b>Hertz:</b>	60	<b>Max KVAR:</b>	11.4
<b>Amps - FL:</b>	25.6	<b>Power Factor:</b>	75.5
<b>Service Factor:</b>	1.15	<b>Bearing - DE:</b>	6312ZZ
<b>Alt Service Factor:</b>	--	<b>Bearing - ODE:</b>	6211ZZ

Enclosure is Dripproof

---

**Stamped Nameplate Notes:****Additional Information:**

4 POLE DRIP PROOF  
 CONDUIT BOX MATERIAL: STAMPED STEEL  
 CONDUIT BOX VOL: 244 CU IN  
 NO. OF MOTOR LEADS: 3  
 NOT USEABLE AT 200 VOLTS  
 GREASE TYPE: SHELL ALVANIA R3 LITHIUM  
 SOUND POWER DATA: 74.5  
 INVERTER DUTY PER NEMA MG1 PART 31  
 FOR VARIABLE TORQUE LOADS

**Performance Characteristics**

1st Winding 1st Connection

**Design: 28AD1010B**

**Marks:**

LOAD %	125.0	115.0	100.0	75.0	50.0	25.0	0.0
% EFF	93.61	93.8	94.18	93.93	93.01	88.96	0.00
% PF	80.84	80.05	78.25	72.75	61.68	40.04	4.5
AMPS	30.92	28.67	25.4	20.54	16.32	13.14	11.63

<b>TORQ(FL)#FT</b>	73.77	<b>TORQ(LR)%FL</b>	251.98	<b>TORQ(BD)%FL</b>	287.42
<b>AMPS(LR)</b>	169.43	<b>PF AT START</b>	0.37		

This motor is capable of two cold or one hot start with a maximum connected load inertia of 995 Lb-Ft Sq (41.89 Kg-meter Sq)at 100% voltage, where the load torque varies with the square of the speed. Acceleration time with maximum inertia and the above load type is 43 seconds. Safe stall time at 100% voltage is 73 seconds cold, 65 seconds hot. Rotor inertia is 3.85 Lb-Ft Sq (0.16 Kg-meter Sq).

<b>Open Circuit A-C:</b>	0.463	<b>Short Circuit D-C:</b>	0.023
<b>Short Circuit A-C:</b>	0.027	<b>X/R Ratio:</b>	8.627
<b>Stator Slots:</b>	48	<b>Rotor Slots:</b>	40

**Speed Torque Current Curve (First Connection, First Speed)**

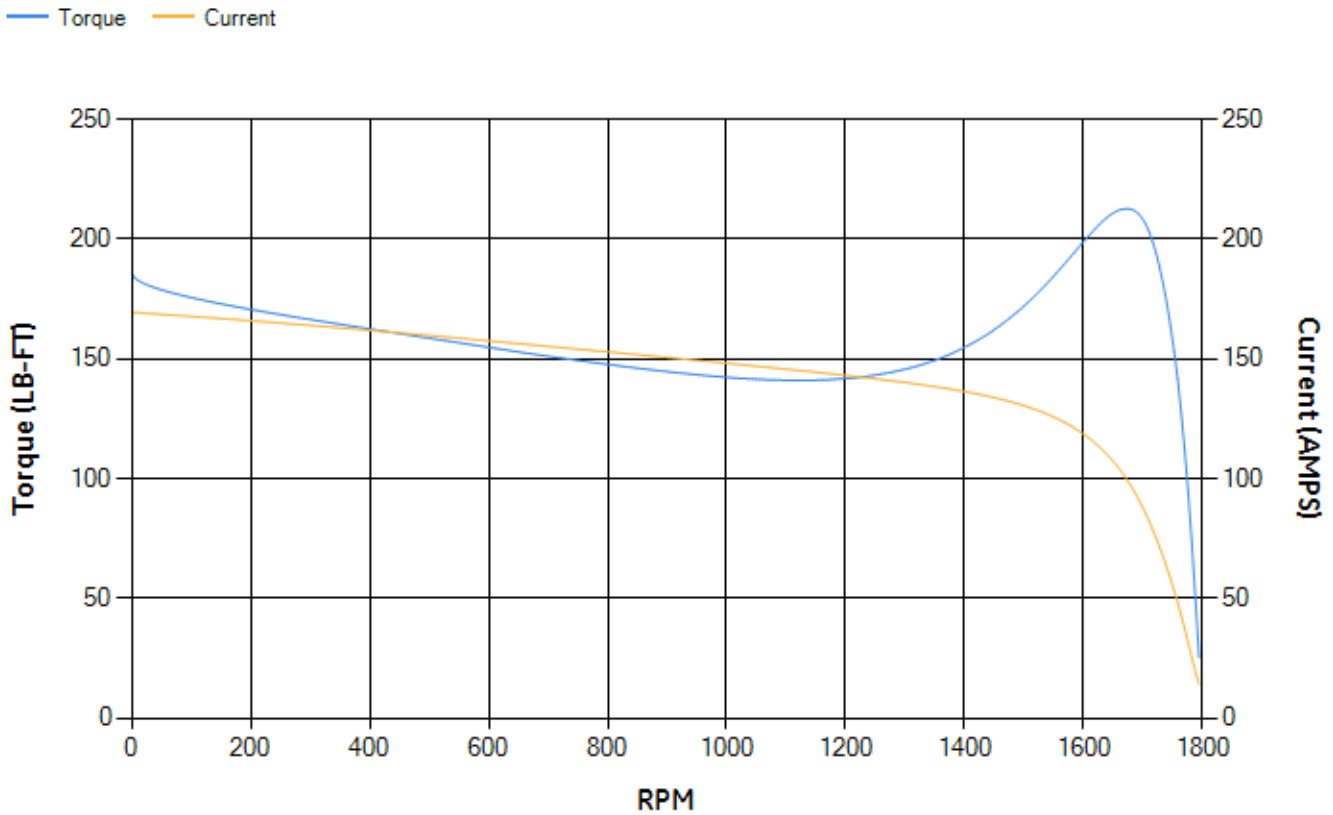

NAME:501452442 OBJECT:358B6217AA DATE:15-May-07 15:32:08

Marks:

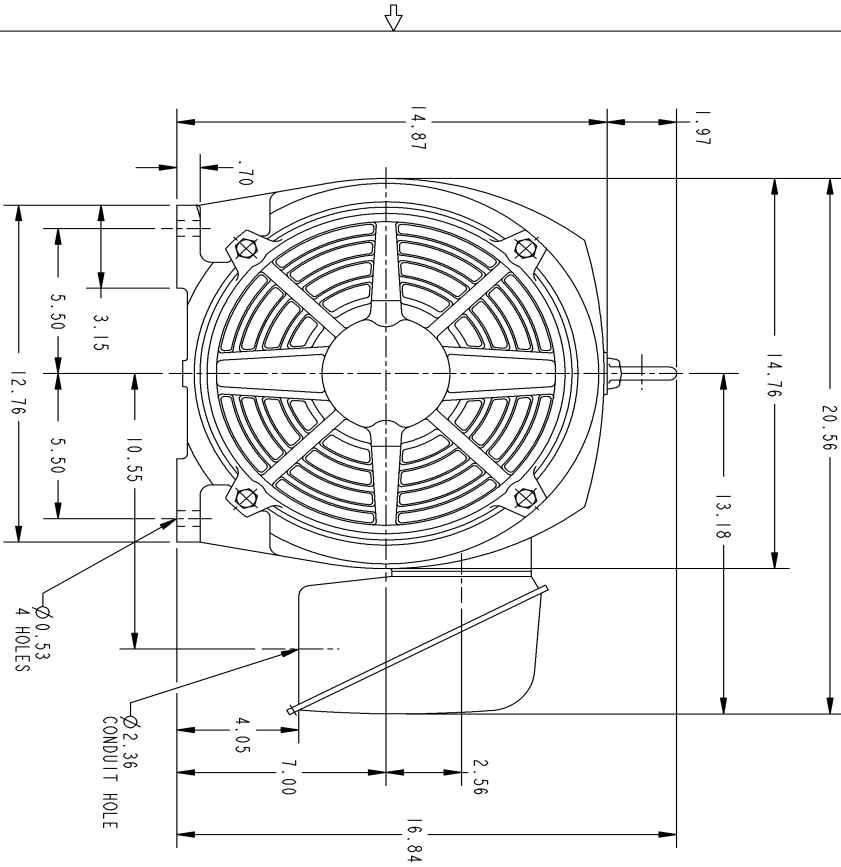

- NOTES :
1. CONDUIT BOX MAY BE PLACED WITH THE ENTRANCE DOWN, UP OR ON EITHER SIDE.
  2. F-1 ASW AS SHOWN.
  3. F-2 ASW - HAS CONDUIT BOX ON OPPOSITE SIDE.

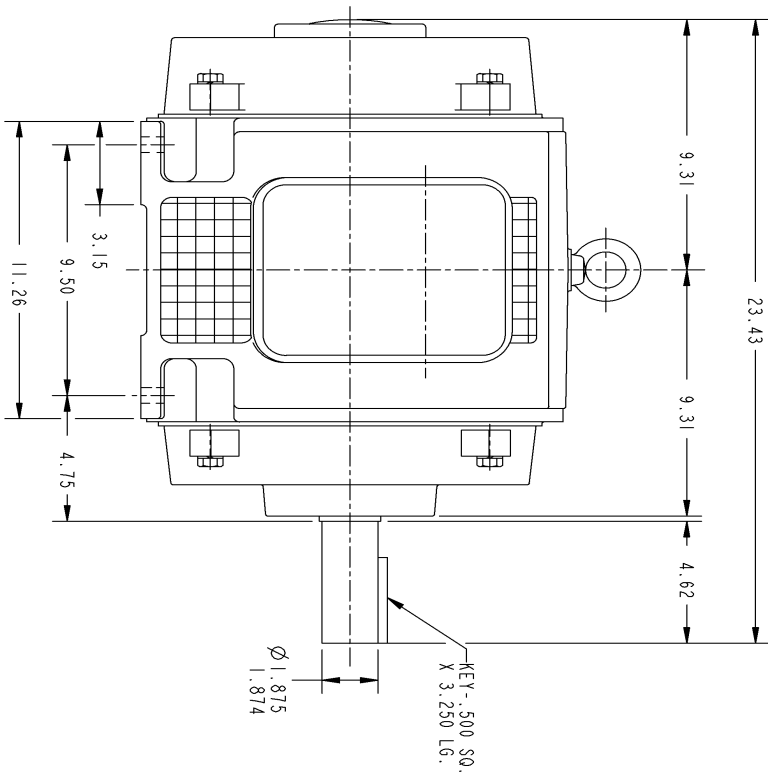

THIS DRAWING IS THE PROPERTY OF GENERAL ELECTRIC COMPANY (GEC) AND CONTAINS PROPRIETARY INFORMATION. IT IS TO BE KEPT IN CONFIDENCE AND IS NOT TO BE REPRODUCED OR TRANSMITTED IN ANY FORM OR BY ANY MEANS, ELECTRONIC OR MECHANICAL, INCLUDING PHOTOCOPYING, RECORDING, OR BY ANY INFORMATION STORAGE AND RETRIEVAL SYSTEM. THIS DRAWING SHALL BE RETURNED TO GEC UPON 15 MONTHS AFTER THE DATE OF ISSUANCE UNLESS OTHERWISE SPECIFIED BY THE CUSTOMER. ANY REPRODUCTION OR TRANSMISSION OF THIS DRAWING WITHOUT THE WRITTEN PERMISSION OF GEC IS STRICTLY PROHIBITED.

SIZE: DRAWING FOR  
B 358B6217AA

REVISIONS

REV.	DESCRIPTION	DATE	APPROVED
1	ISAAC 07-0770	05/03/07	R. KOHNE

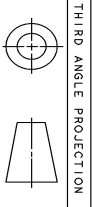

THIRD ANGLE PROJECTION

SIGNATURES	DATE
DRWN: P. RAJU 03/27/03	
CHECKED: PRADHAKAR 03/27/03	
ENGR: ENGR	
ISSUED: PRADHAKAR 03/27/03	

UNLESS OTHERWISE SPECIFIED:  
DIMENSIONS ARE IN INCHES  
TOLERANCE ON:  
2 PL. DECIMALS ± .01  
3 PL. DECIMALS ± .005  
ANGLES ± 1°

GE Industrial Systems  
GENERAL ELECTRIC COMPANY  
Fort Wayne, Indiana

OUTLINE

284T - OPEN DRIP PROOF

SIZE: DRAWING B  
358B6217AA

SCALE: DRAWING SCALE

REV. 1  
SHEET 1 OF 1

DISTRIBUTION:

Marks:

**Connection Diagram**  
**GEM2034E-FIG7**

