

Product Information Packet

November 7, 2016

Data shown is for the current revision model #. Ensure your nameplate model # matches.

Model Number:	5KS145ATE305A
Catalog Number:	E708
Instruction Manual:	GEI-M1023
Connection Diagram:	GEM1000A-FIG3
Outline Drawing:	358B6213AB

Accessory Connection Diagrams			
Bearing Thermocouple:	None	Heater:	None
RTD:	None	Thermistor:	None
Thermostat:	None	Winding Thermocouple:	None
Bearing RTD:	None		

Table of Contents	
Specification	01
Performance Characteristics	02
Outline Drawing	03
Connection Drawing(s)	04



Marks:

MODEL NUMBER:	5KS145ATE305A	Estimated Weight:	64 Lbs
Outline Drawing:	358B6213AB	Time Rating:	CONT
Connection Diagram:	GEM1000A-FIG3	Enclosure:	DP
Instruction Book:	GEI-M1023	Encl Construction:	OPEN
Design Code:	14AD3001A	Ambient Max(°C):	40
Type:	KS	Alt Ambient Max(°C):	--
Frame:	145T	Insulation Class:	F
Phases:	3	NEMA Design:	B
Poles:	6	Nominal Efficiency:	82.5 %
Output Power:	1HP 0.7KW	Guaranteed Efficiency:	80.0
RPM:	1140	3/4 Load Efficiency:	83.7
Voltage:	230/460	KVA Code:	N
Hertz:	60	Max KVAR:	.8
Amps - FL:	3.4/1.7	Power Factor:	65
Service Factor:	1.15	Bearing - DE:	6205ZZ
Alt Service Factor:	--	Bearing - ODE:	6205ZZ

Enclosure is Dripproof

Stamped Nameplate Notes:**Additional Information:**

6 POLE DP
 LRA:18.6 / 9.3
 NO. OF MOTOR LEADS: 9
 CONDUIT BOX VOLUME (IN^3): 30.2
 CONDUIT BOX MTL: STAMPED STEEL
 GREASE TYPE: SHELL ALVANIA R3 LITHIUM GREASE
 USABLE AT 200V @ 1HP, 3.6 AMPS @ 1.0 SF
 50 HZ DATA: 3/4 HP, 200/400V, 3.2/1.6 AMPS @ 1.0 SF, 955 RPM
 SOUND POWER: 59.6
 DMK, 06/04, DATA UPDATE 11/2004
 INVERTER DUTY PER NEMA MG1 PART 31
 FOR VARIABLE TORQUE LOADS

Performance Characteristics

1st Winding 1st Connection

Design: 14AD3001A

Marks:

LOAD %	125.0	115.0	100.0	75.0	50.0	25.0	0.0
% EFF	81.38	82.21	83.35	83.75	82.22	74.28	0.00
% PF	72.82	70.91	67.28	58.64	45.83	28.23	6.5
AMPS	1.97	1.85	1.67	1.43	1.24	1.12	1.05

TORQ(FL)#FT	4.58	TORQ(LR)%FL	233.43	TORQ(BD)%FL	280.69
AMPS(LR)	8.64	PF AT START	0.5		

This motor is capable of two cold or one hot start with a maximum connected load inertia of 153 Lb-Ft Sq (6.44 Kg-meter Sq)at 100% voltage, where the load torque varies with the square of the speed. Acceleration time with maximum inertia and the above load type is 61 seconds. Safe stall time at 100% voltage is 144 seconds cold, 99 seconds hot. Rotor inertia is 0.13 Lb-Ft Sq (0.01 Kg-meter Sq).

Open Circuit A-C:	0.082	Short Circuit D-C:	0.007
Short Circuit A-C:	0.008	X/R Ratio:	2.808
Stator Slots:	36	Rotor Slots:	46

Speed Torque Current Curve (First Connection, First Speed)

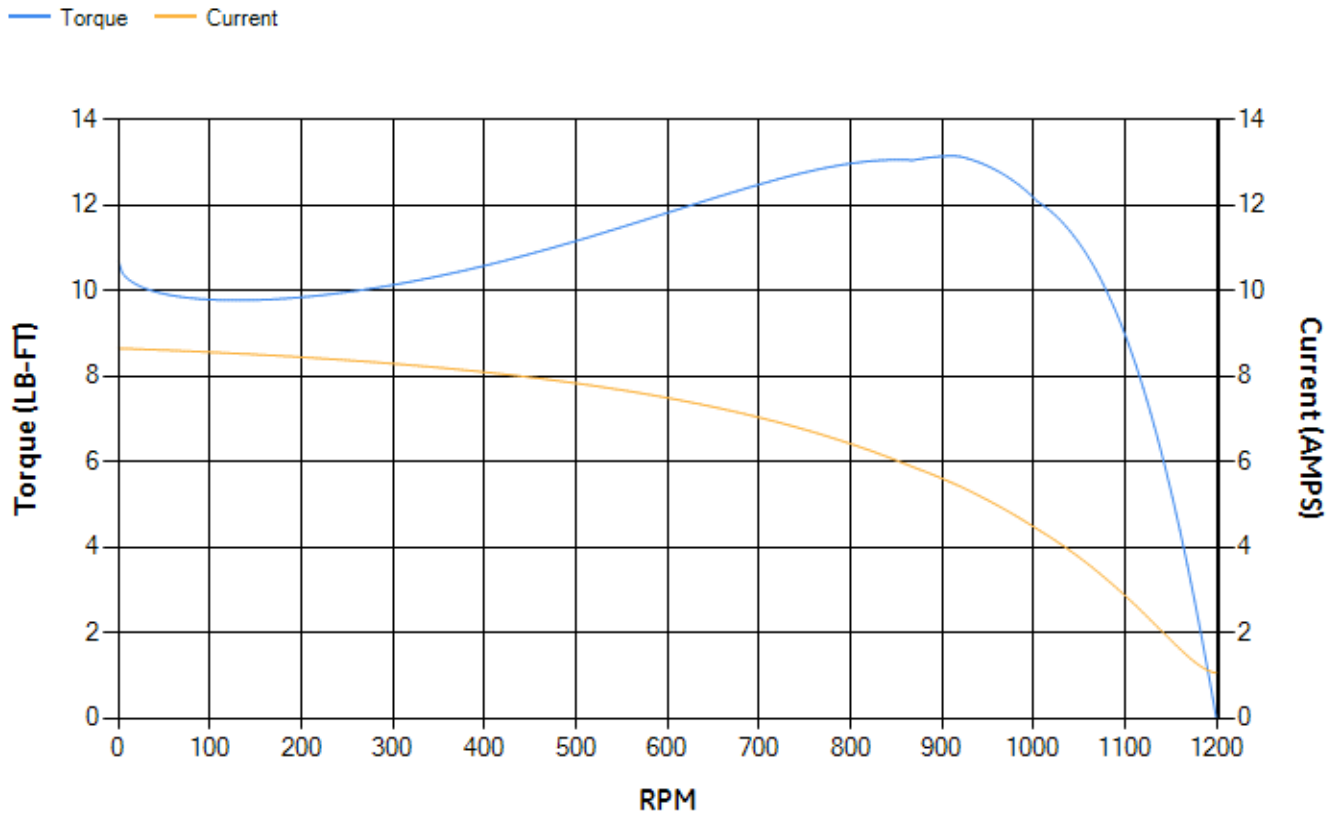

NAME:501452442 OBJECT:358B6213AB DATE:23-May-07 23:06:41

Marks:

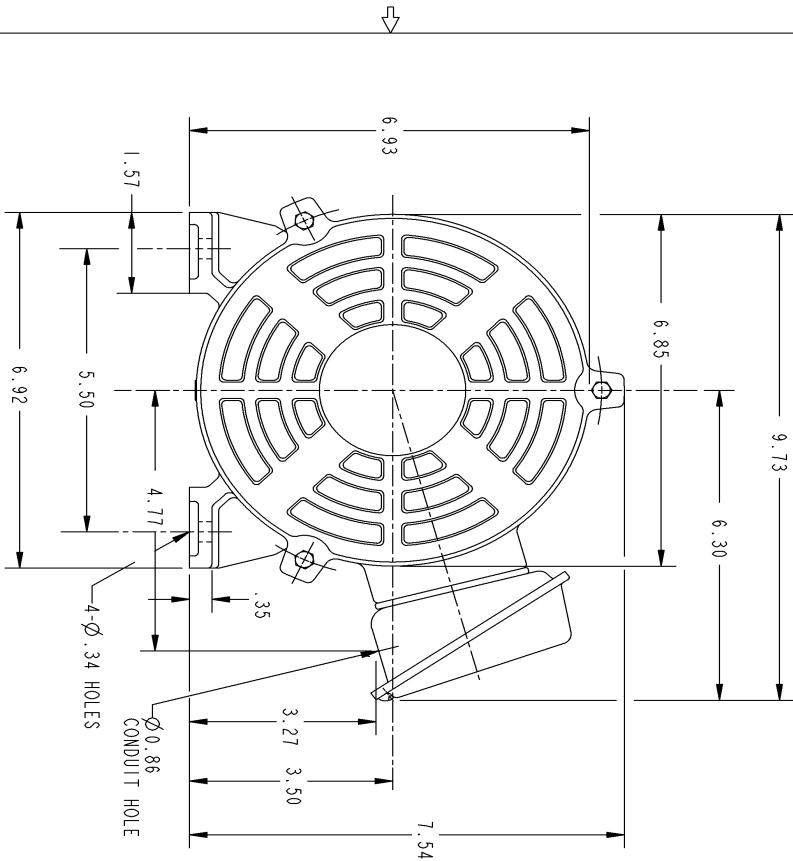

NOTES :

1. CONDUIT BOX MAY BE PLACED WITH THE ENTRANCE DOWN, UP OR ON EITHER SIDE.
2. F-1 ASM AS SHOWN.
3. F-2 ASM - HAS CONDUIT BOX ON OPPOSITE SIDE.

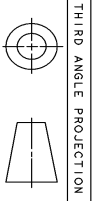

THIRD ANGLE PROJECTION

SIZE: DRAWING FOR
358B6213AB
 GE PROPRIETARY INNOVATION

REV.	DESCRIPTION	DATE	APPROVED
1	ISAAC 07-0770	05/02/07	R. KOHNE

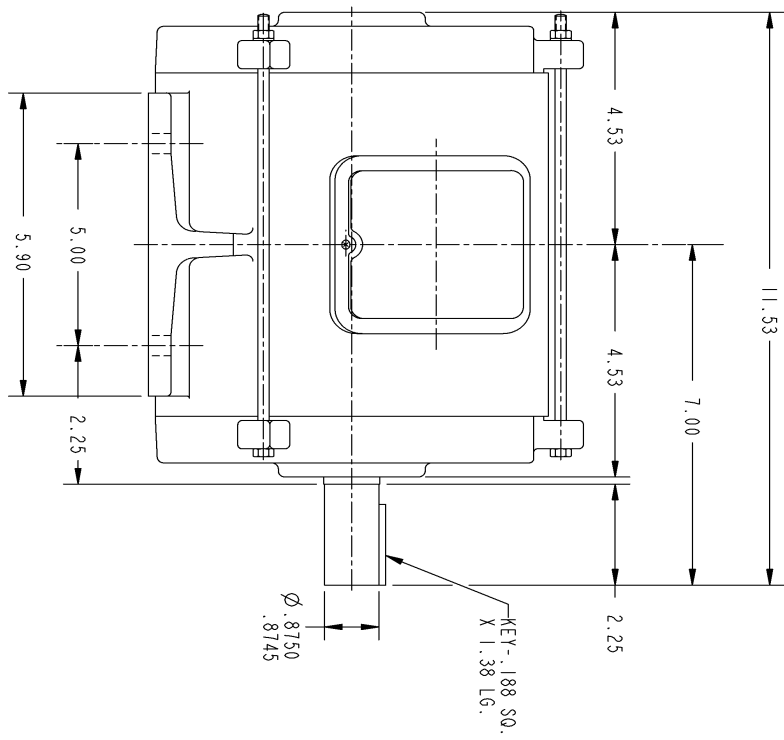

UNLESS OTHERWISE SPECIFIED:		SIGNATURES		DATE	
DIMENSIONS ARE IN INCHES		DRAWN		P. RAJU 03/28/03	
TOLERANCE ON:		CHECKED		PRABHAKAR 03/27/03	
2 PL DECIMALS ±		ENGR		PRABHAKAR 03/27/03	
3 PL DECIMALS ±		ISSUED		PRABHAKAR 03/27/03	
ANGLES ± 1°		APPLIED PRACTICES		SCALE: DRAWING SCALE	
MATERIAL:		SIZE/DRAWING		REV.	
		B		1	
		358B6213AB			
		OUTLINE			
		145T - OPEN DRIP PROOF			
		GENERAL ELECTRIC COMPANY			
		Fort Wayne, Indiana			
		GE Industrial Systems			
		DISTRIBUTION:			

DISTRIBUTION:

Marks:

Connection Diagram
GEM1000A-FIG3

TWO-SPEED

THREE-PHASE, ONE-WINDING,
VARIABLE TORQUE

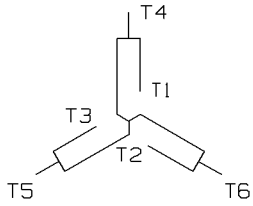

SPEED	L1	L2	L3	OPEN	TOGETHER
1 LOW	T1	T2	T3	ALL OTHERS	
2 HIGH	T6	T4	T5		T1, T2, T3