

Product Information Packet

January 12, 2017

Data shown is for the current revision model #. Ensure your nameplate model # matches.

Model Number:	5KS284CAA204D1
Catalog Number:	E9630
Instruction Manual:	GEI-56128
Connection Diagram:	GEM2034E-FIG1
Outline Drawing:	4002B5828RAP5201

Accessory Connection Diagrams			
Bearing Thermocouple:	None	Heater:	None
RTD:	None	Thermistor:	None
Thermostat:	3027JE-2A	Winding Thermocouple:	None
Bearing RTD:	None		

Table of Contents

Specification	01
Performance Characteristics	02
Outline Drawing	03
Connection Drawing(s)	04
Spare parts	05



Marks:

MODEL NUMBER:	5KS284CAA204D1	Estimated Weight:	460 Lbs
Outline Drawing:	4002B5828RAP5201	Time Rating:	CONT
Connection Diagram:	GEM2034E-FIG1	Enclosure:	TEFC
Instruction Book:	GEI-56128	Encl Construction:	XP
Design Code:	28BD1162B	Ambient Max(°C):	40
Type:	KS	Alt Ambient Max(°C):	--
Frame:	284T	Insulation Class:	F
Phases:	3	NEMA Design:	B
Poles:	4	Nominal Efficiency:	93.6 %
Output Power:	25HP 18.5KW	Guaranteed Efficiency:	92.4
RPM:	1780	3/4 Load Efficiency:	94.1
Voltage:	575	KVA Code:	G
Hertz:	60	Max KVAR:	7.1
Amps - FL:	23.3	Power Factor:	86.0
Service Factor:	1.00	Bearing - DE:	6310ZC3
Alt Service Factor:	--	Bearing - ODE:	6310ZC3

Enclosure is Totally Enclosed Fan-Cooled

Stamped Nameplate Notes:

EXPLOSION PROOF MOTOR
TEMP CODE T3C
THERMOSTAT LEADS TB1-TB2
STAMP NP249A5571AD "CL I (C & D) CL II (F & G)"

Additional Information:

4P - T EXTN
STANDARD FLOOR MOUNT
C/BOX 250 CU IN-2.00 NPT
F1 CONDUIT BOX MOUNTING
AUX LEADS EXIT WITH MOTOR LEADS
CL I C & D CL II F & G EXPLOSION PROOF MOTOR

Performance Characteristics

1st Winding 1st Connection

Design: 28BD1162B

Marks:

LOAD %	125.0	115.0	100.0	75.0	50.0	25.0	0.0
% EFF	92.56	92.97	93.7	94.09	94.02	91.66	0.00
% PF	86.93	86.68	85.84	82.54	74.2	52.62	4.41
AMPS	29.08	26.71	23.26	18.08	13.42	9.7	7.91

TORQ(FL)#FT	73.83	TORQ(LR)%FL	183.15	TORQ(BD)%FL	289.17
AMPS(LR)	143.98	PF AT START	0.38		

This motor is capable of two cold or one hot start with a maximum connected load inertia of 892 Lb-Ft Sq (37.55 Kg-meter Sq)at 100% voltage, where the load torque varies with the square of the speed. Acceleration time with maximum inertia and the above load type is 56 seconds. Safe stall time at 100% voltage is 100 seconds cold, 67 seconds hot. Rotor inertia is 4.93 Lb-Ft Sq (0.21 Kg-meter Sq).

Open Circuit A-C:	0.626	Short Circuit D-C:	0.016
Short Circuit A-C:	0.028	X/R Ratio:	5.867
Stator Slots:	48	Rotor Slots:	40

Speed Torque Current Curve (First Connection, First Speed)

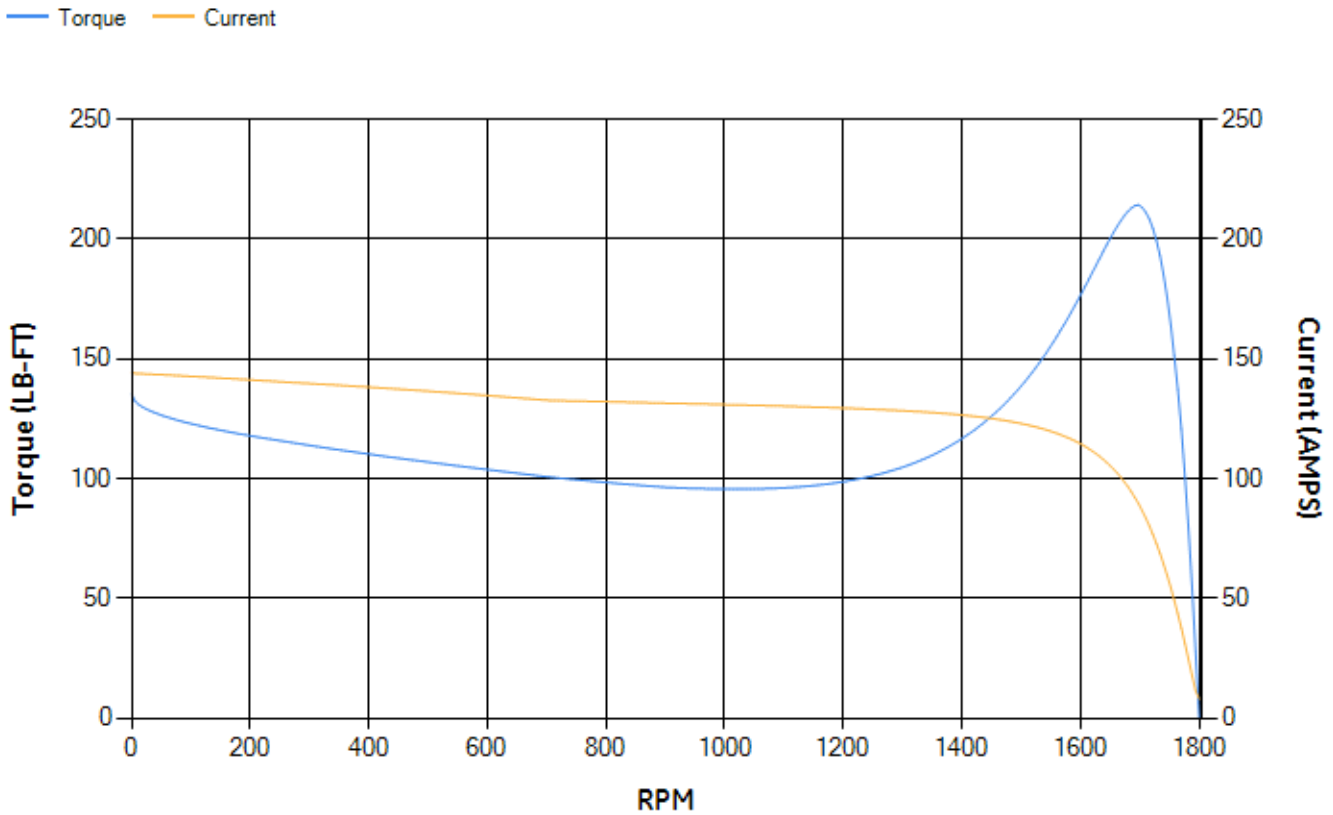

NAME:320002276 OBJECT:4002B5828RAP5201 DATE:19-Feb-09 13:17:55

Marks:

NOTE 1 : CONDUIT BOX MAY BE ASSEMBLED WITH ENTRANCE UP, DOWN OR TO EITHER SIDE.
 NOTE 2 : F1 ASSEMBLY AS SHOWN. F2 ASSEMBLY CONDUIT BOX ON OPPOSITE SIDE FROM SHOWN LOCATION.

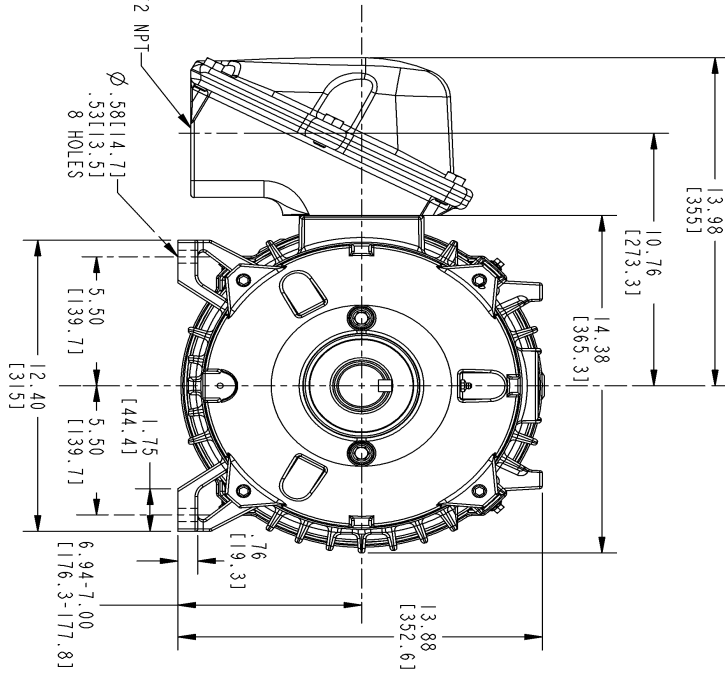
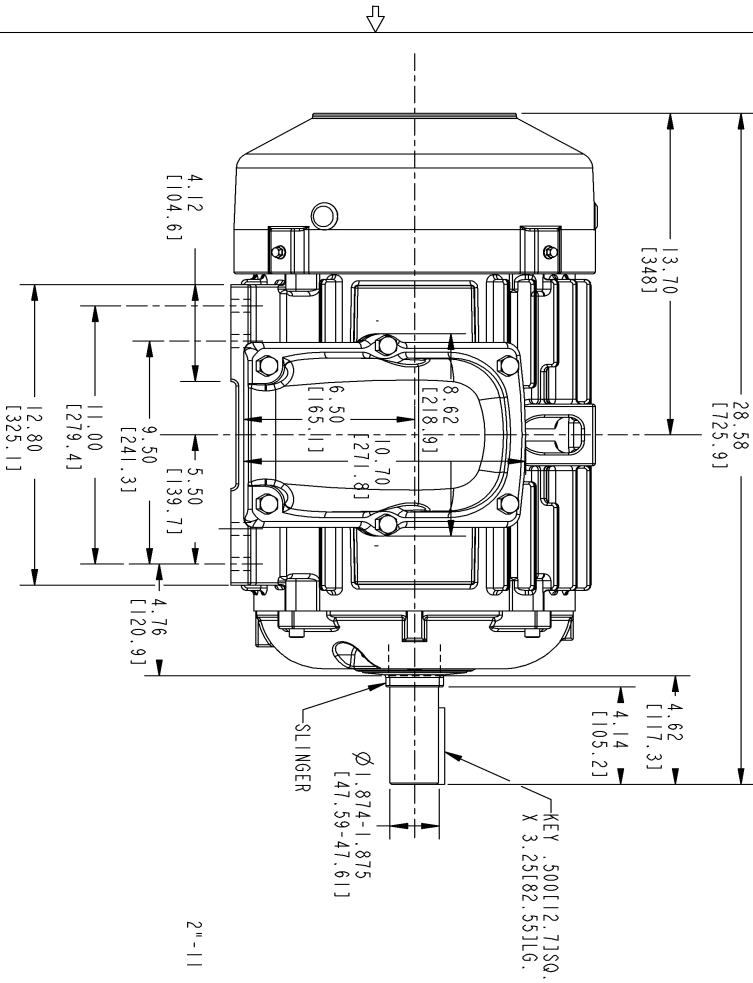

SIZE DRAWING NO. 4002B5828RAP5201

SH 2 REV

REVISIONS

REV.	DESCRIPTION	DATE	APPROVED
1	AS PER ISAC-07-1243	09/07/07	ROOPA
2	ISAC NO: #09-0164 ATUL	02/19/09	RAGHUNATH

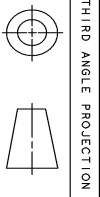

SIGNATURES	DATE	GE Industrial Systems	GENERAL ELECTRIC COMPANY
DRWN: GAT WARRNER	FEB 19/02		Fort Wayne, Indiana
CHECKED: GAT WARRNER	FEB 21/02		
ENGR: GAT WARRNER	MAY 03/02		
ISSUED: GAT WARRNER	MAY 03/02		
APPLIED PRACTICES:			
SIZE DRAWING: B	SCALE: 0.225	REF. NO.: 4002B5828RAP5201	SHEET 1 OF 1
INDUCTION MOTOR OUTLINE		STANDARD CONSTRUCTION	
FME: FR280T		FCXP XSD ULTRA	
4002B5828RAP5201		REV. 2	

DISTRIBUTION: PMP-18K15

Marks:

Connection Diagram
GEM2034E-FIG1

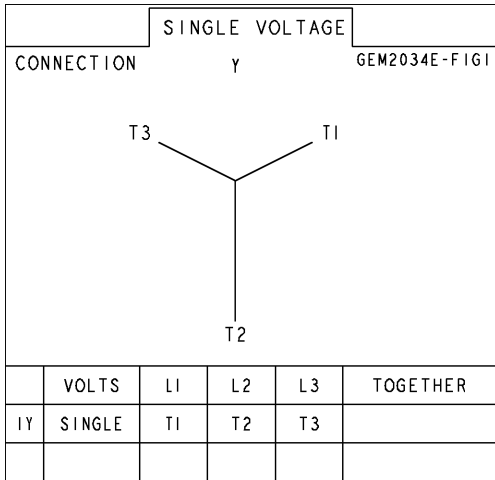

Thermostat Connection
3027JE-2A



End shield Assembly		
Part Description	DE Side Part#	ODE Side Part#
End Shield	4004D5274PA1	4004D5274SA1
Bearing		
Slinger/Inproseal		

Fan & Fan Cover Assembly	
Part Description	Part#
Fan	159C6700G02
Fan Cover	

Conduit & Accessories Box Assembly	
Part Description	Part#
Conduit Box	4002B5732RA-G01

Mechanical Accessories	
Part Description	Part#
Brake	
Tachometer	