

Product Information Packet

January 12, 2017

Data shown is for the current revision model #. Ensure your nameplate model # matches.

Model Number:	5KS184CAA204B
Catalog Number:	E9614
Instruction Manual:	GEI-56128
Connection Diagram:	GEM2034E-FIG1
Outline Drawing:	4002B5818RAP5201

Accessory Connection Diagrams			
Bearing Thermocouple:	None	Heater:	None
RTD:	None	Thermistor:	None
Thermostat:	3027JE-2A	Winding Thermocouple:	None
Bearing RTD:	None		

Table of Contents	
Specification	01
Performance Characteristics	02
Outline Drawing	03
Connection Drawing(s)	04

Marks:

MODEL NUMBER:	5KS184CAA204B	Estimated Weight:	101 Lbs
Outline Drawing:	4002B5818RAP5201	Time Rating:	CONT
Connection Diagram:	GEM2034E-FIG1	Enclosure:	TEFC
Instruction Book:	GEI-56128	Encl Construction:	XP
Design Code:	18BD1001B	Ambient Max(°C):	40
Type:	KS	Alt Ambient Max(°C):	--
Frame:	184T	Insulation Class:	F
Phases:	3	NEMA Design:	B
Poles:	4	Nominal Efficiency:	89.5 %
Output Power:	5HP 3.7KW	Guaranteed Efficiency:	87.5
RPM:	1755	3/4 Load Efficiency:	90.4
Voltage:	575	KVA Code:	J
Hertz:	60	Max KVAR:	2.0
Amps - FL:	5.3	Power Factor:	79.5
Service Factor:	1.00	Bearing - DE:	6206ZC3
Alt Service Factor:	--	Bearing - ODE:	6206ZC3

Enclosure is Totally Enclosed Fan-Cooled

Stamped Nameplate Notes:

EXPLOSION PROOF MOTOR
TEMP CODE T3C
THERMOSTAT LEADS TB1-TB2
STAMP NP249A5571AC "CL I (C & D) CL II (F & G)"

Additional Information:

4P - T EXTN
STANDARD FLOOR MOUNT
C/BOX 26 CU IN-0.75 NPT
F1 CONDUIT BOX MOUNTING
AUX LEADS EXIT WITH MOTOR LEADS
CL I C & D CL II F & G EXPLOSION PROOF MOTOR

Performance Characteristics

1st Winding 1st Connection

Design: 18BD1001B

Marks:

LOAD %	125.0	115.0	100.0	75.0	50.0	25.0	0.0
% EFF	88.08	88.75	89.78	90.42	90.09	85.98	0.00
% PF	81.62	81.01	80.84	74.28	63.44	41.72	5.8
AMPS	6.51	5.99	5.16	4.18	3.28	2.61	2.19

TORQ(FL)#FT	14.97	TORQ(LR)%FL	228.21	TORQ(BD)%FL	298.12
AMPS(LR)	32.8	PF AT START	0.51		

This motor is capable of two cold or one hot start with a maximum connected load inertia of 181 Lb-Ft Sq (7.62 Kg-meter Sq)at 100% voltage, where the load torque varies with the square of the speed. Acceleration time with maximum inertia and the above load type is 35 seconds. Safe stall time at 100% voltage is 78 seconds cold, 51 seconds hot. Rotor inertia is 0.35 Lb-Ft Sq (0.01 Kg-meter Sq).

Open Circuit A-C:	0.237	Short Circuit D-C:	0.008
Short Circuit A-C:	0.012	X/R Ratio:	3.136
Stator Slots:	36	Rotor Slots:	28

Speed Torque Current Curve (First Connection, First Speed)

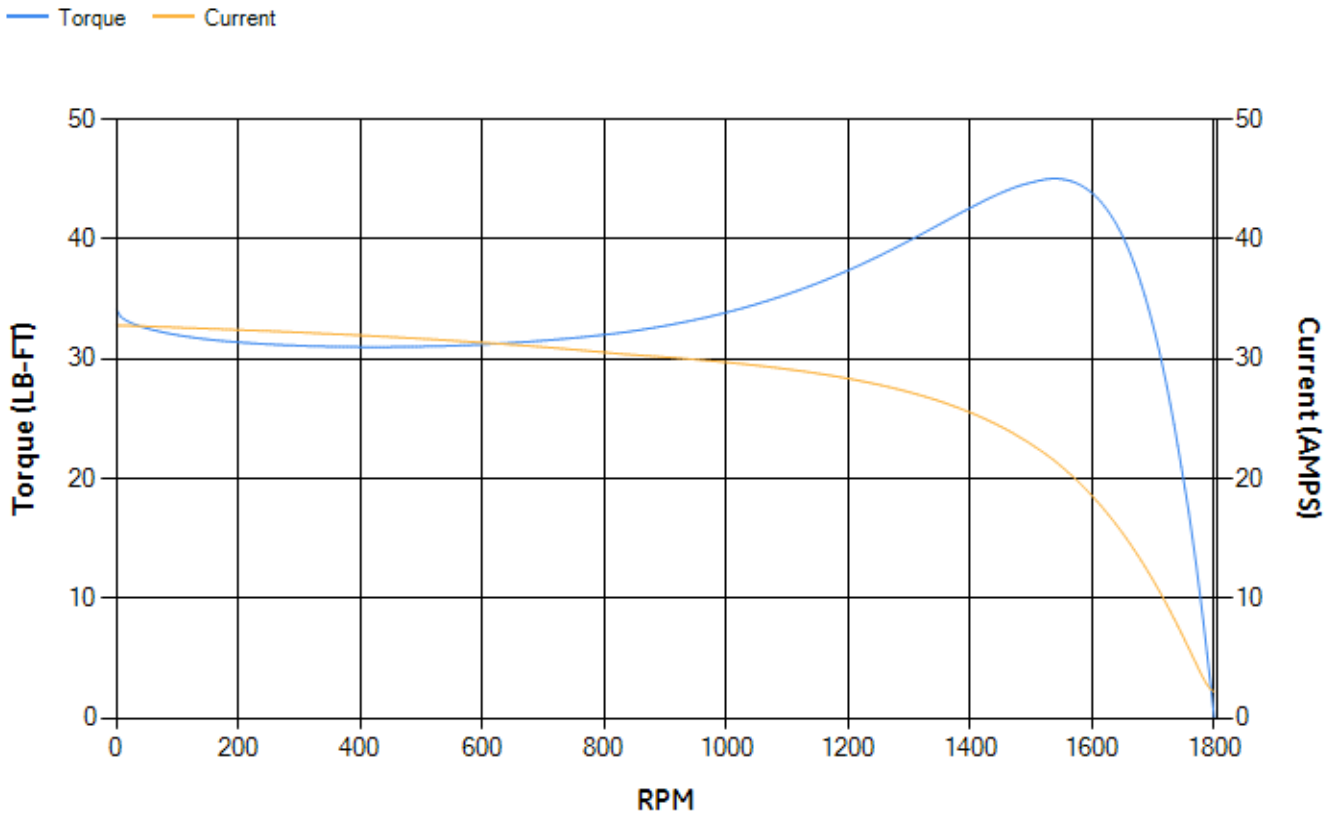

Marks:

NOTE 1: CONDUIT BOX MAY BE ASSEMBLED WITH ENTRANCE UP, DOWN OR TO EITHER SIDE.
 NOTE 2: F1 ASSEMBLY AS SHOWN. F2 ASSEMBLY CONDUIT BOX ON OPPOSITE SIDE FROM SHOWN LOCATION.

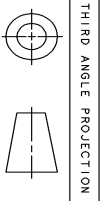
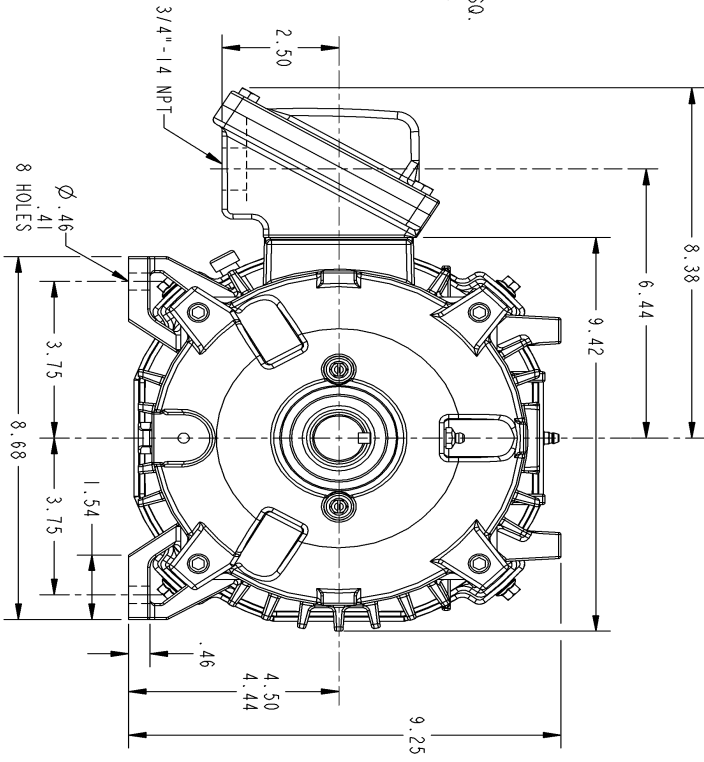
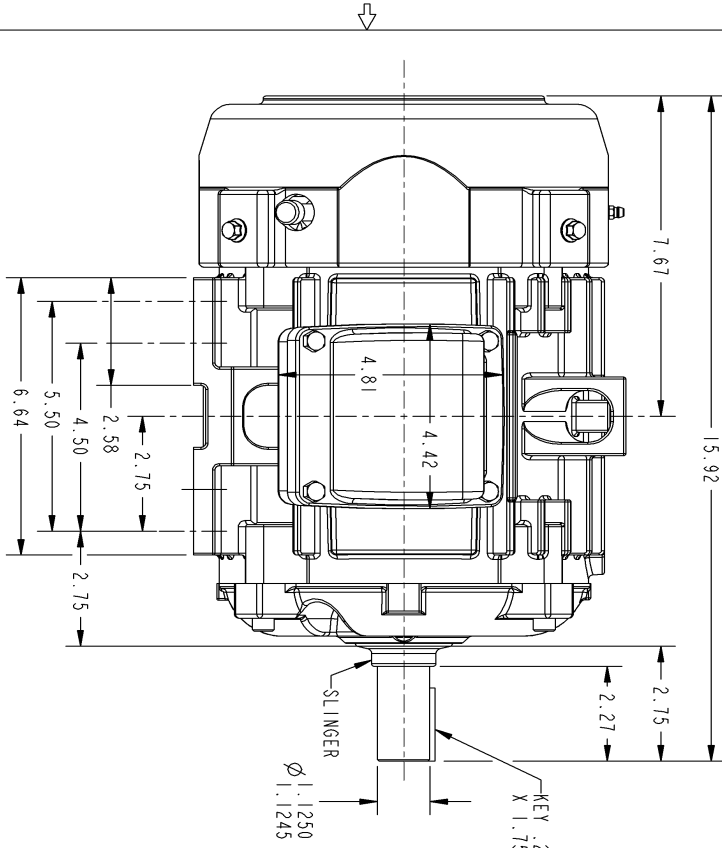

THIRD ANGLE PROJECTION

SIZE 0
 4002B5818RAP5201

SM 0
 REV

REVISIONS			
REV.	DESCRIPTION	DATE	APPROVED

SIGNATURES	DATE	GE Logo	GENERAL ELECTRIC COMPANY
DRWN: GARY WARRNER	APR 24/02	Systems	Fort Wayne, Indiana
CHEK: GARY WARRNER	MAY 01/02		
ENGR: GARY WARRNER	MAY 02/02		
ISSUED: GARY WARRNER	MAY 02/02		
APPLIED PRACTICES			
SIZE: DRAWING	B		
SCALE: 0.400	REF. NO: 4002B5818RAP5201		
			SHEET 1 OF 1

INDUCTION MOTOR OUTLINE
 STANDARD CONSTRUCTION
 FME: FR180T FCXP XSD ULTRA

4002B5818RAP5201 REV 0

DISTRIBUTION: PMP-18K15

Marks:

Connection Diagram
GEM2034E-FIG1

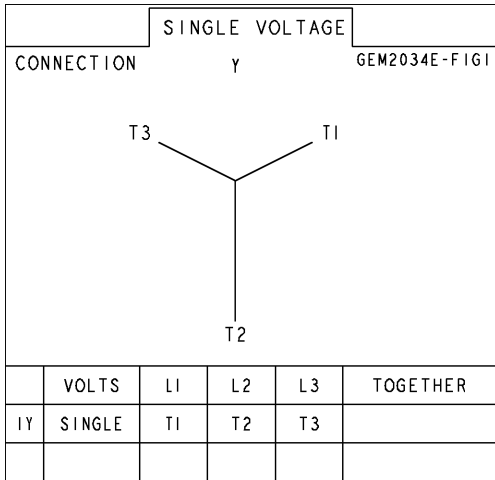

Thermostat Connection
3027JE-2A

