

Product Information Packet

January 12, 2017

Data shown is for the current revision model #. Ensure your nameplate model # matches.

Model Number:	5KS447SAG120A
Catalog Number:	E9520
Instruction Manual:	GEI-56128
Connection Diagram:	GEM2034E-FIG1
Outline Drawing:	225B6500KL

Accessory Connection Diagrams			
Bearing Thermocouple:	None	Heater:	None
RTD:	235A3027RY	Thermistor:	None
Thermostat:	None	Winding Thermocouple:	None
Bearing RTD:	None		

Table of Contents	
Specification	01
Performance Characteristics	02
Outline Drawing	03
Connection Drawing(s)	04

Marks:

MODEL NUMBER:	5KS447SAG120A	Estimated Weight:	2490 Lbs
Outline Drawing:	225B6500KL	Time Rating:	CONT
Connection Diagram:	GEM2034E-FIG1	Enclosure:	TEFC
Instruction Book:	GEI-56128	Encl Construction:	X\$D
Design Code:	49ED0007EA	Ambient Max(°C):	40
Type:	KS	Alt Ambient Max(°C):	XX
Frame:	447TS	Insulation Class:	F
Phases:	3	NEMA Design:	B
Poles:	2	Nominal Efficiency:	93.0 %
Output Power:	125HP 92.5KW	Guaranteed Efficiency:	92.4
RPM:	3565	3/4 Load Efficiency:	92.9
Voltage:	2300	KVA Code:	G
Hertz:	60	Max KVAR:	14.1
Amps - FL:	26.9	Power Factor:	93.5
Service Factor:	1.15	Bearing - DE:	6314ZC3
Alt Service Factor:	XX	Bearing - ODE:	6314ZC3

Enclosure is Totally Enclosed Fan-Cooled

Stamped Nameplate Notes:

MAX INT AND EXT SURFACE TEMP FOR NORM OPER
 AT RATED COND 200 DEG C
 VIBRATION LIMIT = 0.055 IPS
 GREASE POLYREX EM
 TEMP CONT HTR LDS H 115V 125W
 STAMP NP249A5564P009 AS FOLLOWS:
 MAXIMUM SPACE HEATER SURFACE
 TEMPERATURE FOR NORMAL OPERATION
 AT RATED CONDITIONS 160 DEG C

Additional Information:

2 POLE, TS SHAFT EXTN
 FORMED COIL
 TEMP CONTRL 115V HEATER LEADS TO ACC BOX
 100 OHM WINDING RTD LEADS TO ACC BOX
 700 Cu. In. CBOX

Performance Characteristics

1st Winding 1st Connection

Design: 49ED0007EA

Marks:

LOAD %	125.0	115.0	100.0	75.0	50.0	25.0	0.0
% EFF	92.56	92.79	93.2	92.94	91.84	87.16	0.00
% PF	92.6	93.03	93.48	93.55	91.94	83.58	19.9
AMPS	34.12	31.17	26.86	20.18	13.86	8.03	3.93

TORQ(FL)#FT 184
AMPS(LR) 171.24

TORQ(LR)%FL 168.11
PF AT START 0.31

TORQ(BD)%FL 217.6

This motor is capable of two cold or one hot start with a maximum connected load inertia of 419 Lb-Ft Sq (17.64 Kg-meter Sq) at 100% voltage, where the load torque varies with the square of the speed. Acceleration time with maximum inertia and the above load type is 33 seconds. Safe stall time at 100% voltage is 79 seconds cold, 40 seconds hot. Rotor inertia is 41.15 Lb-Ft Sq (1.73 Kg-meter Sq).

Open Circuit A-C: 2.03

Short Circuit D-C: 0.024

Short Circuit A-C: 0.052

X/R Ratio: 8.886

Stator Slots: 48

Rotor Slots: 40

Speed Torque Current Curve (First Connection, First Speed)

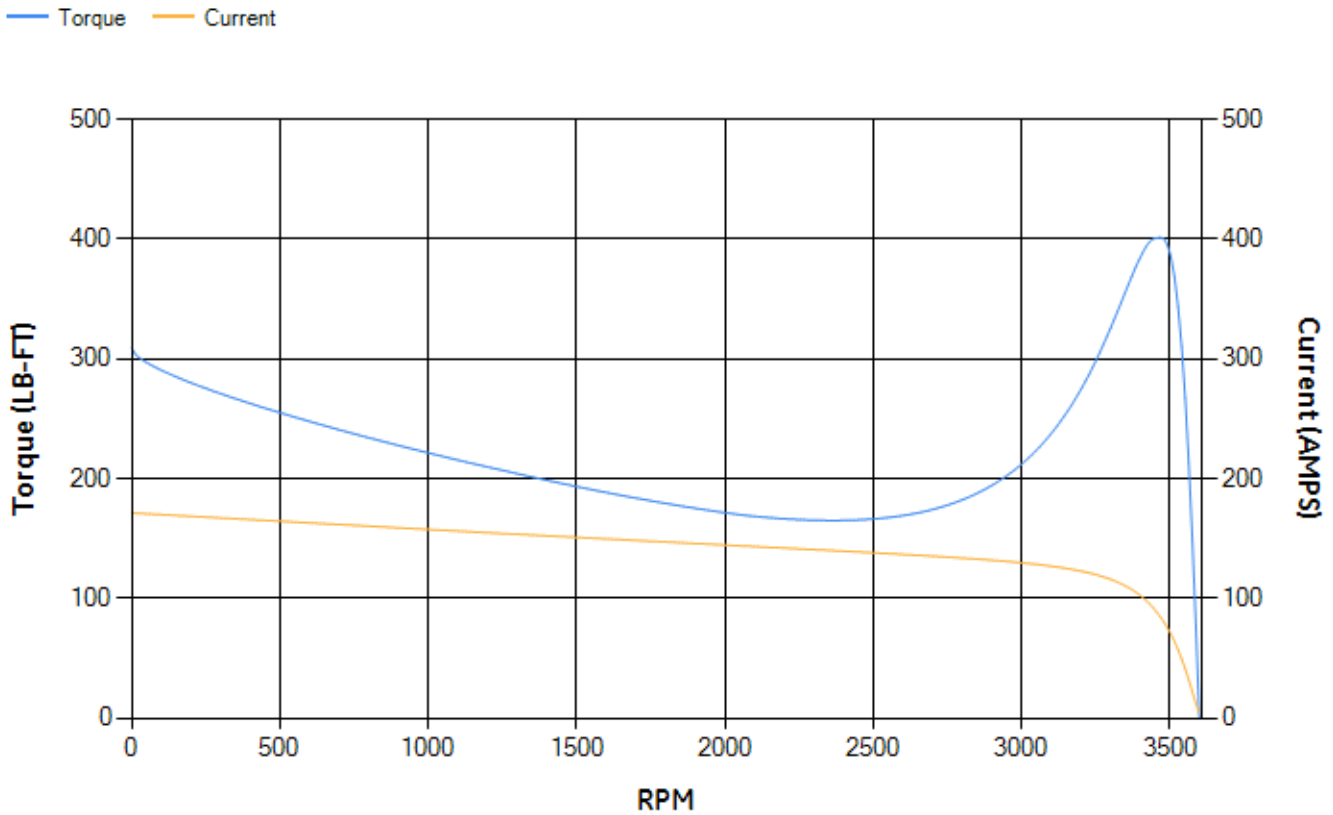

Marks:

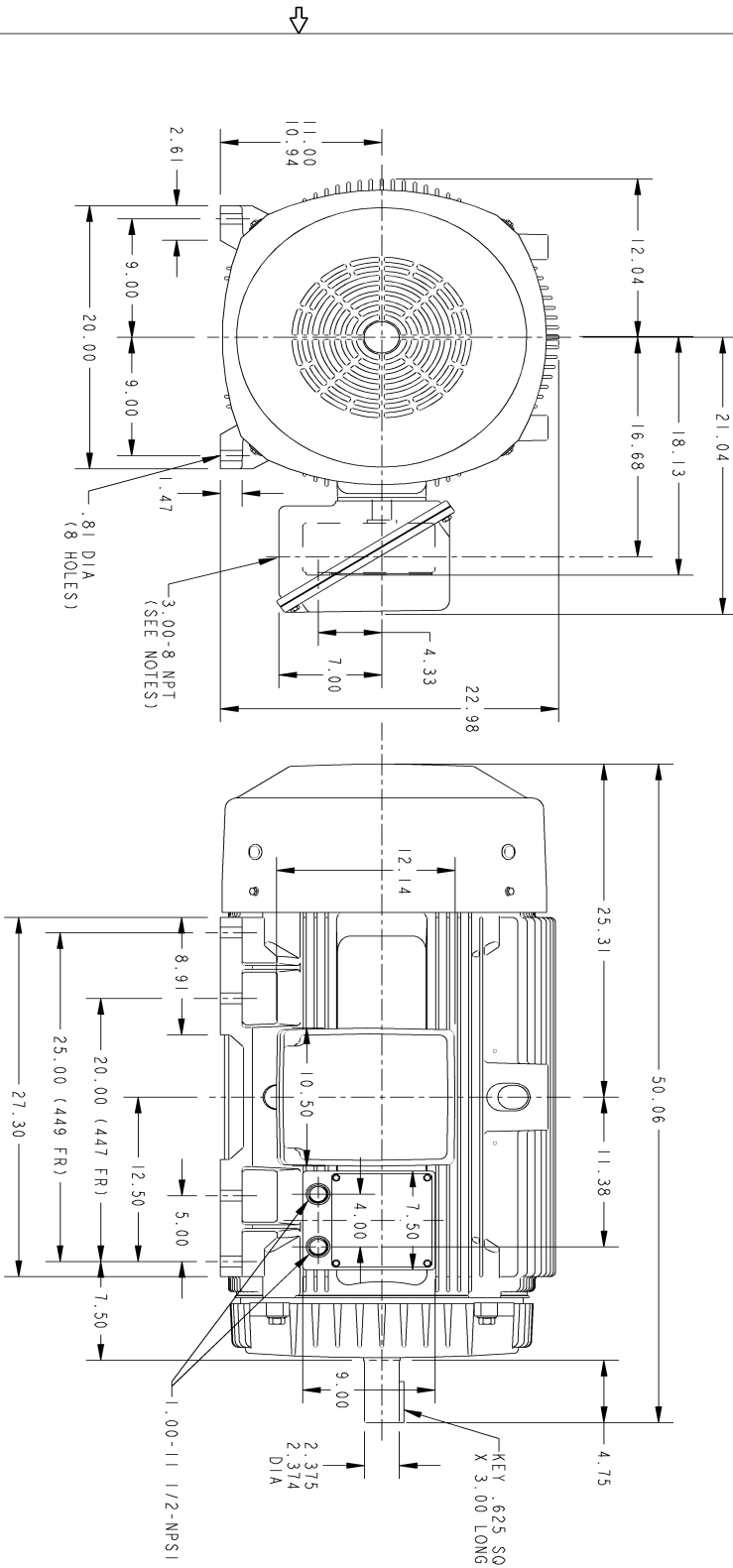

SIZE B DRAWING NO. 225B6500KL

REVISIONS			
REV.	DESCRIPTION	DATE	APPROVED
1	ISAC #12-0301	SRANANTHI 03/22/2012	V JAY

THIRD ANGLE PROJECTION

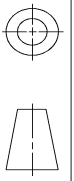

NOTES:

1. CONDUIT BOX MAY BE PLACED WITH THE ENTRANCE DOWN, UP OR TOWARD OPPOSITE DRIVE END.
2. F-1 ASSEMBLY AS SHOWN.
3. F-2 ASSEMBLY HAS CONDUIT BOX ON OPPOSITE SIDE & ACC BOX DIAGONALLY OPPOSITE.

SIGNATURES	DATE	GE Industrial Systems GENERAL ELECTRIC COMPANY Fort Wayne, Indiana
DRAWN M.R. BUIKIM CHECKED M.R. B ENGR ISSUED APPLIED PRACTICES	02/05/98 02/05/98 02/05/98	
SIZE DRAWING 700 CU. IN. BOX & ACC BOX 225B6500KL		REV. 1 SHEET 1 OF 1

DISTRIBUTION:

Marks:

Connection Diagram
GEM2034E-FIG1





SH 1 REV 3	THIRD ANGLE PROJECTION	REVISIONS			
		REV	DESCRIPTION	DATE	APPROVED
		2	ISAAC 02-3381 NRS	12/20/02	
		3	P6 CONNECTED NARAYANAN	05/30/06	BHASKAR

DNG NO 235A3027RY

SIZE A

GE MOTORS & INDUSTRIAL SYSTEMS

PROPRIETARY AND CONFIDENTIAL
This document is the property of General Electric Company and contains proprietary and confidential information of General Electric Company. This document is loaned on the express condition that neither it nor the information contained therein shall be disclosed to others without the express consent of GE Motors & Industrial Systems and that the information shall be used by the recipient only as approved expressly by GE Motors & Industrial Systems. Also, this document shall be returned to the Company upon its request.

GE MOTORS & INDUSTRIAL SYSTEMS

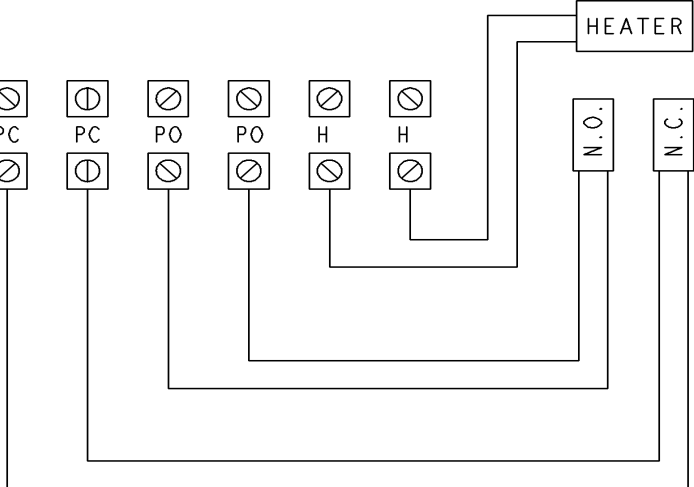
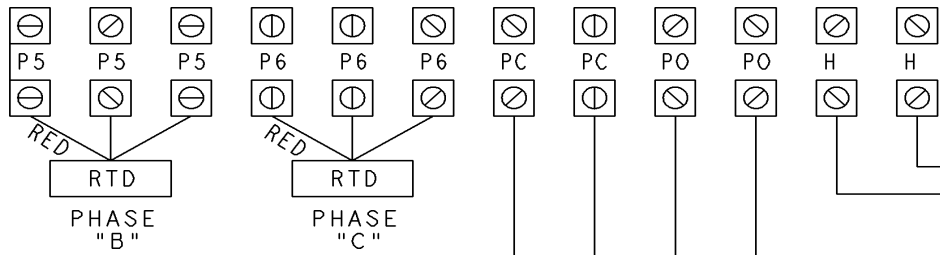
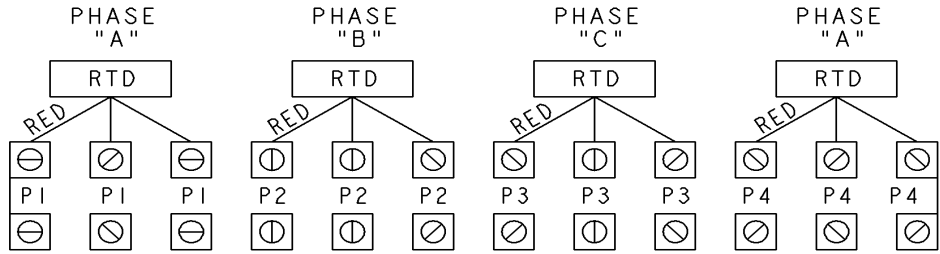
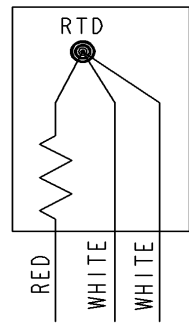

- NOTE 1: TERMINAL LABELS ARE PROVIDED FOR ACCESSORIES THAT MAY OR MAY NOT BE INCLUDED WITH THE MOTOR.
- NOTE 2: SPARE RTDS (P7 & P8) FURNISHED IN CASE OF FAILURE IN OTHER RTDS (P1-P6). PHASE LOCATION WILL DEPEND UPON NUMBER OF POLES WINDING CONFIGURATION.
- NOTE 3: IT IS RECOMMENDED THAT RTDS BE GROUNDED AT EITHER THE MACHINE OR CONNECTED TO A GROUNDED CONTROL CIRCUIT. FOR PROPER OPERATION DO NOT GROUND AT THE MACHINE IF CONNECTED TO A GROUND CIRCUIT AT THE CONTROL.

UNLESS OTHERWISE SPECIFIED DIMENSIONS ARE IN INCHES TOLERANCES ON: 2 PL DECIMALS ± 3 PL DECIMALS ± ANGLES ± FRACTIONS ± MATERIAL: APPLIED PRACTICES:	SIGNATURES		DATE	
	DRAWN	R.D.COE	09/21/01	
	CHECKED	R.D.C.	09/21/01	
	ISSUED		09/24/01	
CAD NO.	235A3027RY		SIZE	A
		FSCM NO	DWG NO 235A3027RY	
		SCALE	.95	SHEET 1 OF 1

GE Motors & Industrial Systems
 Fort Wayne, Indiana

CONNECTION DIAGRAM
WINDING RTD'S & T'STATS & HEATERS

SIZE	A	FSCM NO		DWG NO	235A3027RY
SCALE	.95			SHEET	1 OF 1

DISTR TO

