

# Product Information Packet

November 7, 2016

Data shown is for the current revision model #. Ensure your nameplate model # matches.

<b>Model Number:</b>	<b>5KS256ATE206A</b>
<b>Catalog Number:</b>	<b>E7754</b>
<b>Instruction Manual:</b>	GEI-M1023
<b>Connection Diagram:</b>	GEM2034E-FIG7
<b>Outline Drawing:</b>	358B6216AB

Accessory Connection Diagrams			
<b>Bearing Thermocouple:</b>	None	<b>Heater:</b>	None
<b>RTD:</b>	None	<b>Thermistor:</b>	None
<b>Thermostat:</b>	None	<b>Winding Thermocouple:</b>	None
<b>Bearing RTD:</b>	None		

Table of Contents	
Specification	01
Performance Characteristics	02
Outline Drawing	03
Connection Drawing(s)	04

**Marks:**

<b>MODEL NUMBER:</b>	<b>5KS256ATE206A</b>	<b>Estimated Weight:</b>	188 Lbs
<b>Outline Drawing:</b>	358B6216AB	<b>Time Rating:</b>	CONT
<b>Connection Diagram:</b>	GEM2034E-FIG7	<b>Enclosure:</b>	DP
<b>Instruction Book:</b>	GEI-M1023	<b>Encl Construction:</b>	OPEN
<b>Design Code:</b>	25AD1006C	<b>Ambient Max(°C):</b>	40
<b>Type:</b>	KS	<b>Alt Ambient Max(°C):</b>	--
<b>Frame:</b>	256T	<b>Insulation Class:</b>	F
<b>Phases:</b>	3	<b>NEMA Design:</b>	A
<b>Poles:</b>	4	<b>Nominal Efficiency:</b>	93 %
<b>Output Power:</b>	20HP 14.8KW	<b>Guaranteed Efficiency:</b>	91.7
<b>RPM:</b>	1765	<b>3/4 Load Efficiency:</b>	93.7
<b>Voltage:</b>	200	<b>KVA Code:</b>	G
<b>Hertz:</b>	60	<b>Max KVAR:</b>	5.9
<b>Amps - FL:</b>	54.8	<b>Power Factor:</b>	83.5
<b>Service Factor:</b>	1.15	<b>Bearing - DE:</b>	6310ZZ
<b>Alt Service Factor:</b>	--	<b>Bearing - ODE:</b>	6208ZZ

Enclosure is Dripproof

---

**Stamped Nameplate Notes:****Additional Information:**

4 POLE ODP  
 LRA: 359.1 AMPS  
 NO OF MOTOR LEADS: 3  
 CONDUIT BOX VOLUME (IN<sup>3</sup>): 110.9  
 CONDUIT BOX MTL: STAMPED STEEL  
 GREASE TYPE: SHELL ALVANIA R3 LITHIUM GREASE  
 50 HZ DATA: 20 HP, 200V, 61.3 AMPS @ 1.0 SF, 1470 RPM  
 SOUND POWER: 72.3  
 INVERTER DUTY PER NEMA MG1 PART 31  
 FOR VARIABLE TORQUE LOADS

**Performance Characteristics**

1st Winding 1st Connection

**Design: 25AD1006C**

**Marks:**

LOAD %	125.0	115.0	100.0	75.0	50.0	25.0	0.0
% EFF	92.1	92.54	93.29	93.65	93.44	90.64	0.00
% PF	85.12	85.02	84.39	81.38	73.42	52.59	5.21
AMPS	68.65	62.93	54.69	42.37	31.38	22.58	18.16

<b>TORQ(FL)#FT</b>	59.43	<b>TORQ(LR)%FL</b>	261.13	<b>TORQ(BD)%FL</b>	252.72
<b>AMPS(LR)</b>	350.68	<b>PF AT START</b>	0.43		

This motor is capable of two cold or one hot start with a maximum connected load inertia of 683 Lb-Ft Sq (28.75 Kg-meter Sq) at 100% voltage, where the load torque varies with the square of the speed. Acceleration time with maximum inertia and the above load type is 37 seconds. Safe stall time at 100% voltage is 64 seconds cold, 56 seconds hot. Rotor inertia is 2.27 Lb-Ft Sq (0.1 Kg-meter Sq).

<b>Open Circuit A-C:</b>	0.433	<b>Short Circuit D-C:</b>	0.018
<b>Short Circuit A-C:</b>	0.019	<b>X/R Ratio:</b>	6.931
<b>Stator Slots:</b>	48	<b>Rotor Slots:</b>	40

**Speed Torque Current Curve (First Connection, First Speed)**

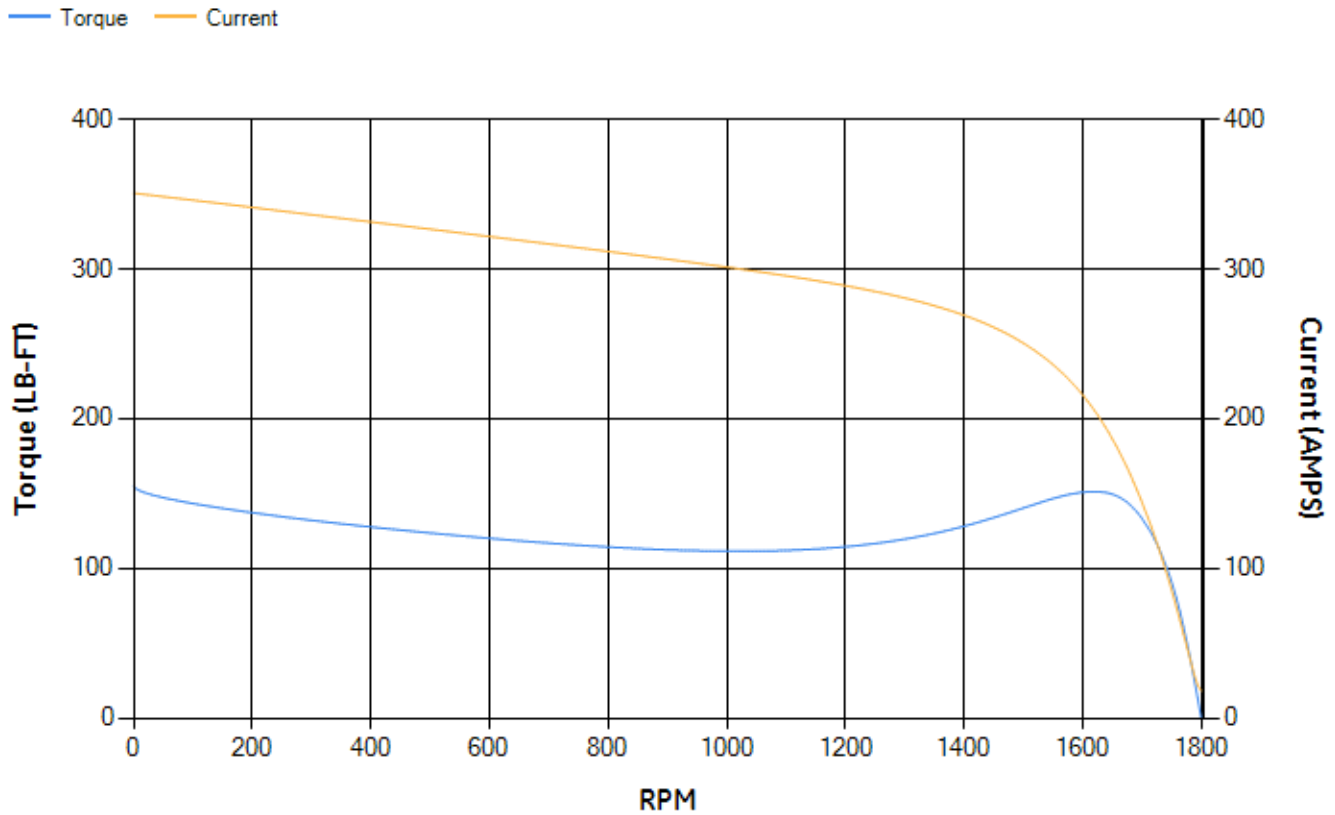

NAME:501452442 OBJECT:358B6216AB DATE:23-May-07 23:53:38

Marks:

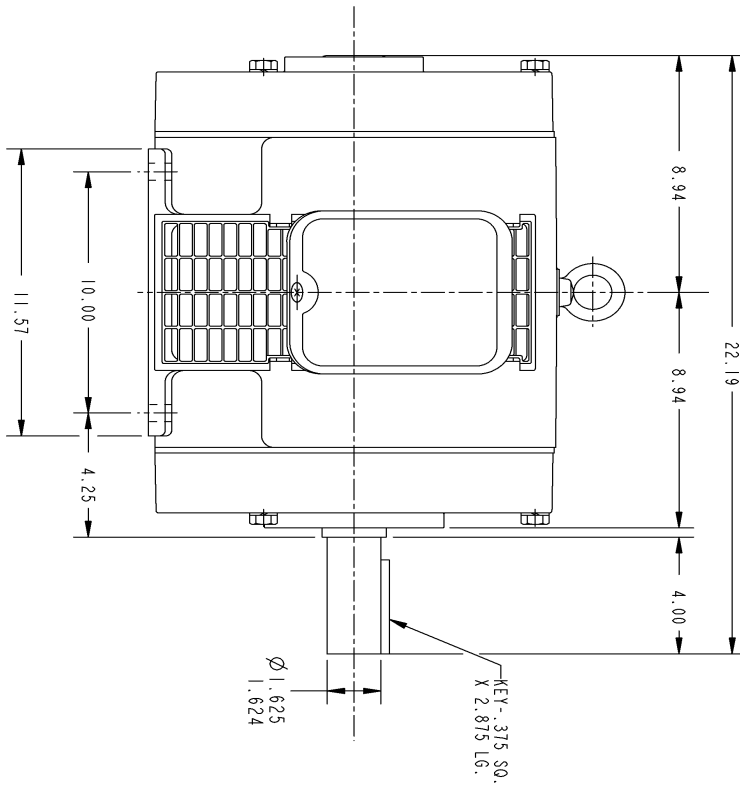
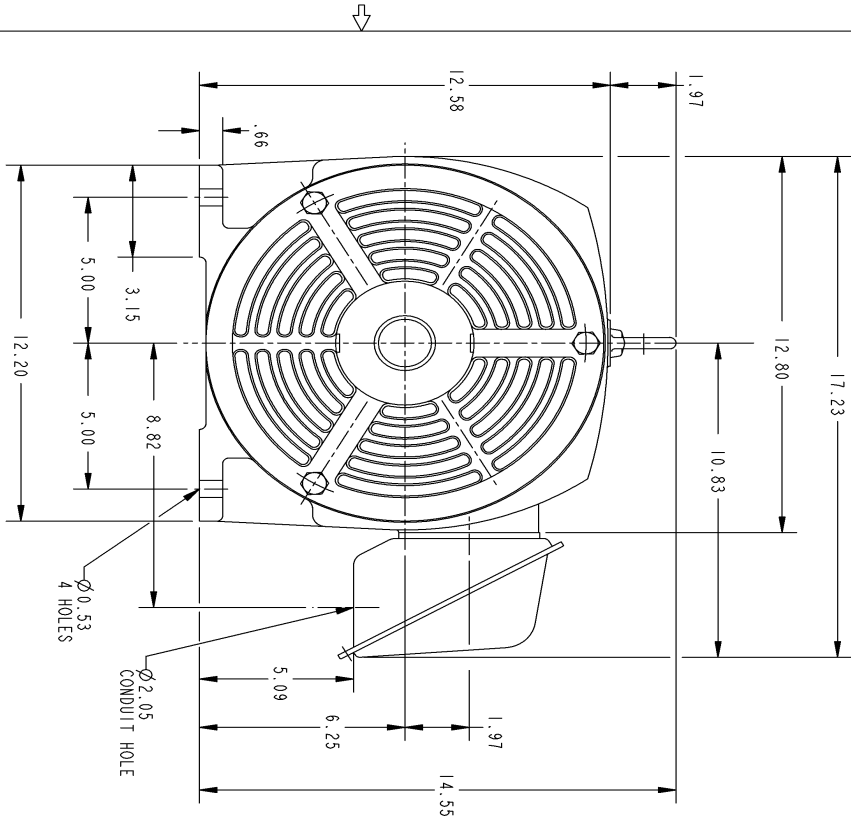

THIS DRAWING IS THE PROPERTY OF GENERAL ELECTRIC COMPANY (GEC) AND CONTAINS PROPRIETARY INFORMATION. IT IS TO BE USED ONLY FOR THE PURPOSES SPECIFIED IN THE ORDER. IT IS TO BE KEPT IN CONFIDENTIALITY AND NOT TO BE REPRODUCED OR TRANSMITTED IN ANY FORM OR BY ANY MEANS, ELECTRONIC OR MECHANICAL, INCLUDING PHOTOCOPYING, RECORDING, OR BY ANY INFORMATION STORAGE AND RETRIEVAL SYSTEM. THIS DRAWING SHALL BE RETURNED TO GEC UPON 15 MONTHS AFTER THE DATE OF ISSUANCE OR AS SOON AS PRACTICABLE THEREAFTER. GEC ACCEPTS NO LIABILITY FOR ANY DAMAGE OR LOSS OF PROFITS, BUSINESS, OR REVENUE, OR FOR ANY SPECIAL, INCIDENTAL, OR CONSEQUENTIAL DAMAGES, INCLUDING LOST PROFITS, ARISING OUT OF OR FROM THE USE OF THIS DRAWING.

SIZE: DRAWING NO: **358B6216AB**

GE PROPRIETARY INFORMATION

REVISIONS

REV.	DESCRIPTION	DATE	APPROVED
1	ISAAC 07-0770	05/02/07	R. KOHNE

NOTES :

1. CONDUIT BOX MAY BE PLACED WITH THE ENTRANCE DOWN, UP OR ON EITHER SIDE.
2. F-1 ASM AS SHOWN.
3. F-2 ASM - HAS CONDUIT BOX ON OPPOSITE SIDE.

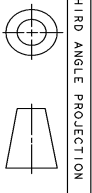

THIRD ANGLE PROJECTION

UNLESS OTHERWISE SPECIFIED:	SIGNATURES	DATE
DIMENSIONS ARE IN INCHES	P. RAJU	03/27/03
TOLERANCE ON:	CHECKED	PRABHAKAR
2 PL DECIMALS ± .	ENGR	03/27/03
3 PL DECIMALS ± .	ISSUED	PRABHAKAR
ANGLES ± 1°	APPLIED PRACTICES	03/27/03

**GE Industrial Systems**  
**GENERAL ELECTRIC COMPANY**  
 Fort Wayne, Indiana

**OUTLINE**  
**256T - OPEN DRIP PROOF**

**358B6216AB**

SCALE: DRAWING SCALE  
 SHEET 1 OF 1

DISTRIBUTION:

Marks:

**Connection Diagram**  
**GEM2034E-FIG7**

